

[Manuals.plus](#) /

› [VEVOR](#) /

› VEVOR Ladder Stabilizer KH-WD04 Instruction Manual

VEVOR KH-WD04

VEVOR Ladder Stabilizer Instruction Manual

Model: KH-WD04

Brand: VEVOR

1. INTRODUCTION

This manual provides essential instructions for the safe and effective use of your VEVOR Ladder Stabilizer, Model KH-WD04. Please read all instructions carefully before installation and operation to ensure personal safety and proper product function. Retain this manual for future reference.

The VEVOR Ladder Stabilizer is designed to enhance stability and safety when working at height, particularly for tasks involving roof gutters or walls. It features adjustable feet, anti-slip rubber pads, and a robust carbon steel construction.

2. PRODUCT OVERVIEW

The VEVOR Ladder Stabilizer (Model KH-WD04) is a heavy-duty accessory designed to provide additional stability for extension ladders. Key features include:

- **Broad Compatibility:** Fits ladders with an outer width of 11.81" to 17.32". Compatible with wood, fiberglass, and aluminum ladders.
- **Safety Design:** Features anti-slip rubber feet, a tool tray for convenience, and a D-ring locking mechanism to prevent detachment.
- **Exceptional Quality:** Constructed from high-quality carbon steel for durability, resistance to deformation, and twisting.
- **High Load Capacity:** Supports up to 330 lbs (150 kg), ensuring robust safety.

CONSIDERATE SAFETY DESIGN

Secure Ladder for Safe High-Altitude Work

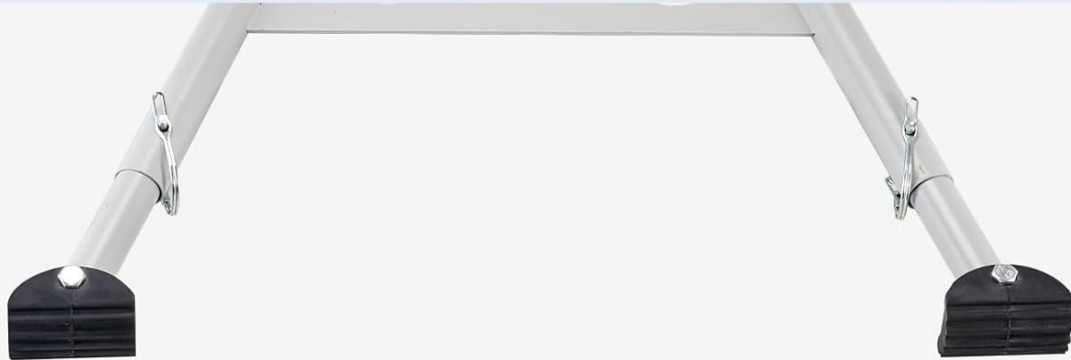

Anti-Slip Rubber Feet:

- Prevents Slipping

Tool Tray:

- Holds Commonly Used Tools

D-Ring:

- Secures the Foot Length

Image 2.1: Ladder Stabilizer showing compatibility range and dimensions. The stabilizer fits ladders with outer widths from 11.81" to 17.32". Footboard depth ranges from 20.55" to 27.95" and span ranges from 26.18" to 32.1".

EXCEPTIONAL QUALITY

A Double Trustworthy Choice for Safety

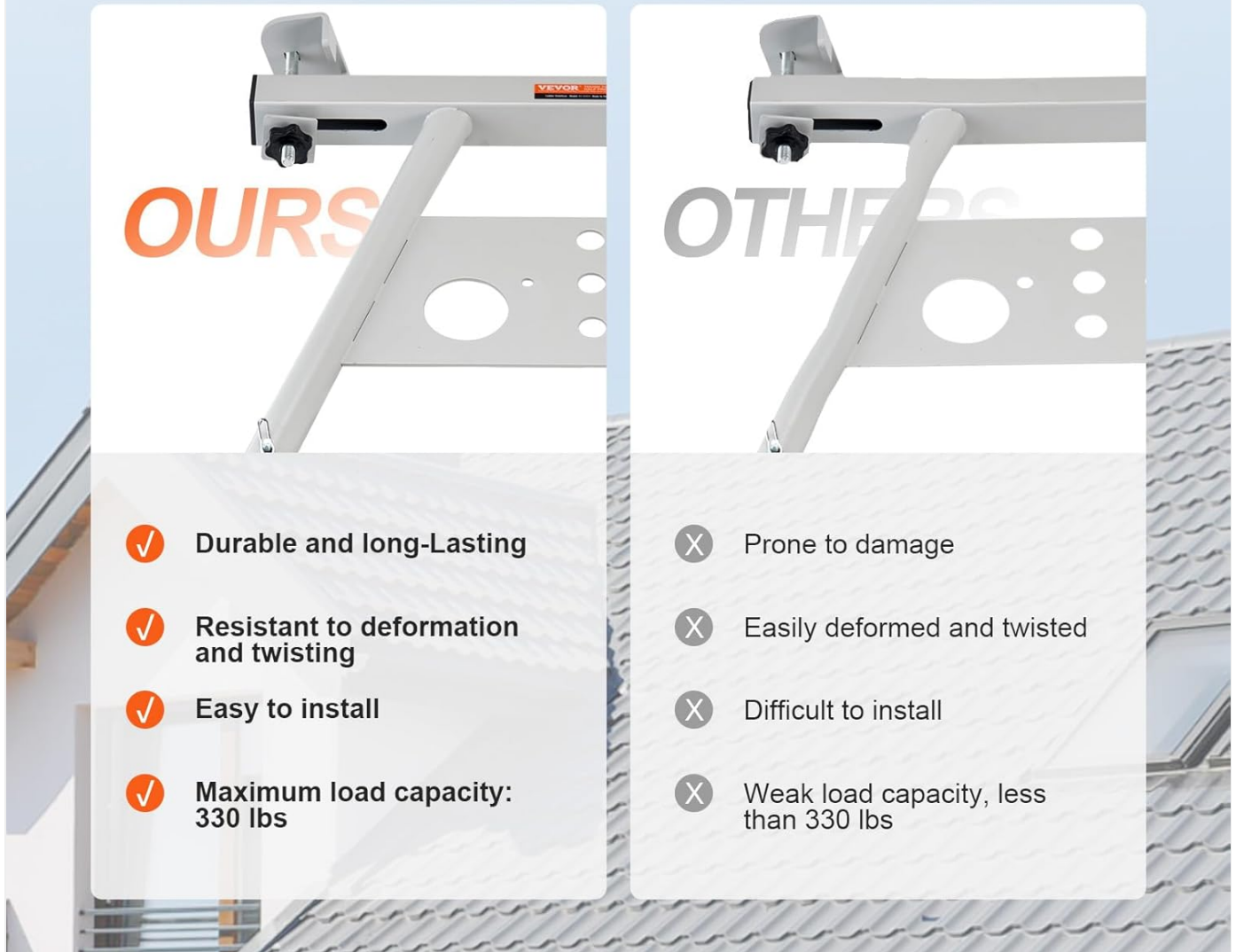

Image 2.2: Close-up of the Ladder Stabilizer highlighting its safety features, including anti-slip rubber feet, an integrated tool tray, and a D-ring for secure locking.

3. SPECIFICATIONS

Feature	Detail
Item Model Number	KH-WD04
Main Material	Carbon Steel
Color	Matte Silver
Net Weight	9.96 lbs / 4.52 kg \pm 3%
Rated Load Capacity	330 lbs / 150 kg

Feature	Detail
Item Dimensions (L x W x H)	32.1 x 27.95 x 2.17 inches / 665 x 522 x 55 mm
Compatible Ladder Outer Width	11.81" to 17.32"

Package Content:

- Ladder Stabilizer x 1
- D-Ring Lock $\phi 6$ x 2
- M8 Anti-Loosening Hex Nuts x 2
- M8 x 50 External Hex Screws x 2
- Open-End Wrenches x 2
- Rubber Feet x 2
- Locking Screws x 2
- User Manual x 1



Image 3.1: Diagram illustrating the dimensions and components of the VEVOR Ladder Stabilizer, Model KH-WD04, along with a list of included package contents.

4. SAFETY INFORMATION

Always prioritize safety when using ladders and ladder accessories. Failure to follow these safety guidelines may result in serious injury or property damage.

- **Inspect Before Use:** Before each use, inspect the ladder stabilizer and your ladder for any damage, wear, or loose components. Do not use if damaged.
- **Ensure Compatibility:** Verify that your ladder's outer width falls within the stabilizer's compatible range (11.81" to 17.32").
- **Secure Installation:** Always ensure the stabilizer is securely attached to the ladder and all locking mechanisms (D-rings, screws, bolts) are tightened before climbing.
- **Stable Surface:** Position the ladder and stabilizer on a firm, level, and non-slippery surface. The anti-slip rubber feet are designed for stability, but caution is still required on wet or uneven ground.
- **Proper Angle:** Set up your ladder at the correct angle (approximately 75 degrees from the horizontal) for maximum stability.

- **Weight Capacity:** Do not exceed the maximum load capacity of 330 lbs (150 kg) for the stabilizer. This includes the user's weight, tools, and materials.
- **Maintain Three Points of Contact:** Always maintain three points of contact (two hands and one foot, or two feet and one hand) when climbing or descending the ladder.
- **Avoid Overreaching:** Do not overreach while on the ladder. Reposition the ladder and stabilizer as needed.
- **Weather Conditions:** Avoid using the ladder and stabilizer in strong winds, rain, or icy conditions.
- **Electrical Hazards:** Be aware of overhead power lines and other electrical hazards. Maintain a safe distance.
- **Not Recommended for Vented Ridges:** This stabilizer is not recommended for use on roofs with vented ridges.

5. SETUP AND INSTALLATION

Follow these steps for quick and secure installation of the VEVOR Ladder Stabilizer onto your extension ladder.



Image 5.1: Visual guide for the 4-step installation process of the VEVOR Ladder Stabilizer.

1. Step 1: Position the Crossbar

Place the stabilizer's crossbar against the ladder's stiles at the desired height. Ensure it is centered and level.

2. Step 2: Secure the L-shaped Lock

Using the provided screws and bolts, secure the L-shaped locking mechanisms to the crossbar, clamping it firmly to the ladder stiles. Ensure a tight fit to prevent movement.

3. Step 3: Adjust Stabilizer Legs

Insert and adjust the stabilizer legs to the desired position. The legs have five-level adjustable lengths to adapt to various slopes and distances from the working surface.

4. Step 4: Secure with D-ring

Once the legs are in the desired position, secure them using the D-ring locks. This prevents the stabilizer legs from detaching or shifting during use.

After installation, gently shake the ladder to confirm the stabilizer is securely attached and stable before climbing.

6. OPERATING INSTRUCTIONS

The VEVOR Ladder Stabilizer is designed to provide a safe standoff distance from walls or gutters, allowing for easier access and increased stability.

- **Positioning:** Once installed, position the ladder so that the stabilizer's rubber feet rest firmly against the wall, roof edge, or gutter. The adjustable legs allow you to achieve the optimal standoff distance.
- **Adjusting for Slopes:** The five-level adjustable leg length enables adaptation to various surface angles and distances. Adjust each leg independently if necessary to ensure both feet are making full contact with the surface.
- **Tool Tray Use:** Utilize the integrated tool tray to keep essential tools within easy reach, reducing the need to climb up and down frequently. Ensure tools are placed securely to prevent them from falling.
- **Working on Roofs/Gutters:** The stabilizer creates a safe working space by keeping the ladder away from the structure, preventing damage to gutters and providing better access for tasks like cleaning or repairs.



Image 6.1: An example of the ladder stabilizer in use, providing a safe standoff from a roof gutter for maintenance work.



Image 6.2: A person using a ladder equipped with the stabilizer to safely access a roof for snow removal.

7. MAINTENANCE

Regular maintenance ensures the longevity and continued safe operation of your ladder stabilizer.

- **Cleaning:** Clean the stabilizer with a damp cloth after each use, especially if exposed to dirt, mud, or other debris. Avoid harsh chemicals that could damage the finish or rubber components.
- **Inspection:** Periodically inspect all components for signs of wear, corrosion, or damage. Pay close attention to the rubber feet, D-rings, screws, and bolts. Replace any worn or damaged parts immediately.
- **Storage:** Store the ladder stabilizer in a dry, clean place, away from extreme temperatures and direct sunlight, when not in use.
- **Lubrication:** Lightly lubricate moving parts, such as the adjustable leg mechanisms, if they become stiff. Use a silicone-based lubricant.

8. TROUBLESHOOTING

This section addresses common issues you might encounter with your ladder stabilizer.

Problem	Possible Cause	Solution
Stabilizer does not fit the ladder.	Ladder outer width is outside the compatible range (11.81" to 17.32").	Measure your ladder's outer width. If it falls outside the specified range, the stabilizer is not compatible. Do not attempt to force fit.
Stabilizer feels unstable after installation.	Loose screws/bolts, D-rings not secured, uneven ground, or incorrect ladder angle.	<ul style="list-style-type: none">• Ensure all screws, bolts, and D-rings are fully tightened.• Verify the ladder is placed on a firm, level surface.• Adjust the ladder to the correct angle (approx. 75 degrees).• Ensure both stabilizer feet are making full contact with the surface.
Adjustable legs are stiff or difficult to move.	Dirt/debris in the mechanism, lack of lubrication, or minor corrosion.	Clean the adjustable mechanisms thoroughly. Apply a light amount of silicone-based lubricant to the moving parts.
Rubber feet show signs of wear or damage.	Normal wear and tear, or damage from sharp objects/rough surfaces.	Replace worn or damaged rubber feet immediately to maintain anti-slip properties and safety. Contact VEVOR support for replacement parts.

9. WARRANTY INFORMATION

VEVOR products are manufactured to high-quality standards. For specific warranty details regarding your KH-WD04 Ladder Stabilizer, please refer to the warranty card included with your purchase or visit the official VEVOR website. Keep your purchase receipt as proof of purchase for any warranty claims.

10. CUSTOMER SUPPORT

If you have any questions, require technical assistance, or need to order replacement parts for your VEVOR Ladder Stabilizer, please contact VEVOR customer support. You can find contact information on the official VEVOR website or through the retailer where you purchased the product.

Official VEVOR Website: www.vevor.com

