

Yaheetech Adirondack Chair-615271

Yaheetech Adirondack Chair with Retractable Ottoman User Manual

Model: Adirondack Chair-615271

1. PRODUCT OVERVIEW

The Yaheetech Adirondack Chair with Retractable Ottoman is designed for ultimate outdoor relaxation and durability. Crafted from high-density polyethylene (HDPE), this chair is built to withstand various weather conditions, offering a comfortable and long-lasting seating solution for your patio, garden, poolside, or beach. Its thoughtful design includes convenient features like a retractable ottoman, integrated cup and phone holders, and a space-saving foldable structure.



Figure 1: Yaheetech Adirondack Chair with Retractable Ottoman.

2. KEY FEATURES

- **Textured Design:** The HDPE material features a wood-like grain texture, enhancing both the comfort and aesthetic appeal of the outdoor chair, making it a stylish addition to your outdoor space.
- **Enhanced Comfort:** Featuring a spacious seat, high backrest, and wide armrests, this Adirondack chair ensures extra comfort, letting you unwind and relax for hours outdoors.

- **Hands-free Relaxation:** Equipped with a cup holder on one side and a wine glass holder and phone holder on the other, this foldable Adirondack chair lets you enjoy your drinks and entertainment without efforts.
- **Retractable Ottoman:** This outdoor foldable chair features a retractable ottoman, allowing you to fully stretch out your legs and relax in complete comfort, whether in your backyard or at the beach.
- **Space-Saving Design:** Equipped with pins on both sides, this Adirondack chair can be easily folded for compact storage, ensuring portability and convenience when not in use.



Figure 2: Detailed view of chair features.

All-Weather HDPE Withstand the Elements



Waterproof



UV-Resistant



Windproof



Snowproof



Figure 3: All-Weather HDPE material withstands the elements.

Your browser does not support the video tag.

Video 1: Overview of the HDPE Adirondack Chair's features, including its foldable design, retractable ottoman, slatted design, wide armrests, convenient cup holder, and wine glass/phone holder.

3. SETUP AND ASSEMBLY

The Yaheetech Adirondack Chair is designed for easy assembly with 80% pre-assembled parts. Follow the steps below for a quick setup.

EASY ASSEMBLY

80% Pre-assembled Parts



8 PARTS

8 STEPS

30 MINS

Figure 4: Easy Assembly Overview.

For detailed visual instructions, please refer to the official installation video and the provided PDF manual:

- [Installation Manual \(PDF\)](#)

- Your browser does not support the video tag.

Video 2: HDPE Adirondack Chair with Ottoman Installation Video. This video provides a step-by-step guide for assembling your chair.

General Assembly Steps:

1. Unpack all components and verify against the parts list in the manual.
2. Attach the side panels to the main seat frame using the provided hardware. Ensure all connections are secure but do not overtighten.
3. Connect the backrest to the seat and side panels.
4. Install the armrests, ensuring the cup and phone holders are correctly oriented.
5. Assemble the retractable ottoman mechanism and attach it to the chair frame.
6. Insert the stability pins on both sides of the chair to secure the folding mechanism.
7. Once all parts are assembled, gently tighten all screws and bolts to ensure stability.

4. OPERATING INSTRUCTIONS

Your Yaheetech Adirondack Chair is designed for ease of use and versatility.

4.1 Retracting and Extending the Ottoman

To extend the ottoman, simply pull it forward from beneath the seat until it locks into place. To retract, gently lift the front edge of the ottoman slightly and push it back under the seat until it is fully stowed.

4.2 Using the Integrated Holders

The chair features a convenient cup holder on one armrest and a wine glass holder/phone stand on the other. These are designed to securely hold your beverages and mobile device for hands-free relaxation.

4.3 Folding for Storage

To fold the chair for compact storage, first retract the ottoman. Then, locate the stability pins on both sides of the chair (typically near the base of the armrests). Remove these pins, and the chair can then be folded flat. Reinsert the pins into their storage holes to keep them secure.



Figure 5: Folding the chair for easy storage.

5. MAINTENANCE

To ensure the longevity and appearance of your Yaheetech Adirondack Chair, follow these simple maintenance guidelines:

- **Cleaning:** The HDPE material is easy to clean. Simply wipe down the chair with a damp cloth and mild soap. Avoid harsh chemicals or abrasive cleaners, as these can damage the surface.
- **Weather Resistance:** This chair is designed to be all-weather resistant. However, for prolonged periods of extreme weather (e.g., heavy snow, prolonged direct sunlight in intense climates), consider covering the chair or storing it indoors to maximize its lifespan.
- **Hardware:** Periodically check all screws and bolts to ensure they remain tight. Retighten if necessary to maintain stability.
- **Storage:** When not in use, especially during off-seasons, fold the chair and store it in a dry, protected area to prevent unnecessary wear and tear.



Figure 6: Benefits of HDPE material for durability and easy maintenance.

6. TROUBLESHOOTING

Most issues with your Adirondack chair can be resolved with simple checks. If you encounter problems, consider the following:

- **Chair feels wobbly:** Ensure all assembly screws and bolts are securely tightened. Refer to the assembly instructions (Section 3) and the installation video to confirm correct assembly.
- **Ottoman not extending/retracting smoothly:** Check for any obstructions in the sliding mechanism. Ensure the chair is on a flat, stable surface. Lubricate the sliding parts if necessary with a silicone-based spray.
- **Difficulty folding the chair:** Verify that the retractable ottoman is fully stowed. Ensure the stability pins are completely removed from their locked position before attempting to fold.
- **Discoloration or fading:** While HDPE is fade-resistant, prolonged exposure to intense UV rays can cause minor changes over many years. Regular cleaning and occasional covering during peak sun hours can help preserve its color.

If problems persist, please contact Yaheetech customer support for further assistance.

7. SPECIFICATIONS





Attribute	Detail
Brand	Yaheetech
Model Name	Adirondack Chair
Item Model Number	Adirondack Chair-615271
Color	Navy Blue
Product Dimensions	52"D x 29"W x 36"H
Material	HDPE, Stainless Steel
Item Weight	44.7 pounds
Special Features	with Cup Holder, Ergonomic, Foldable, Head Support, Retractable Ottoman
Room Type	Poolside, Garden, Beach, Patio Garden
Included Components	Installation instructions
Country of Origin	China

8. WARRANTY AND SUPPORT

Your Yaheetech Adirondack Chair is backed by reliable support and a clear return policy.

- **Return Policy:** This product is eligible for a 30-day easy return policy, allowing for a refund or replacement.
- **Customer Support:** For any questions, concerns, or assistance with your product, please contact Yaheetech customer support. You can find contact information on the official Yaheetech store page or through your purchase platform.
- **Protection Plans:** Additional protection plans may be available for purchase to extend coverage beyond the standard return policy. Please check the product listing for details on 2-Year or 3-Year Protection Plans.

Related Documents - Adirondack Chair-615271

 <p>615271</p>	<p>Bennir Solid Wood Folding Adirondack Chair Assembly Instructions</p> <p>Comprehensive assembly instructions for the Bennir Solid Wood Folding Adirondack Chair by Yaheetech, including a detailed parts list and step-by-step guidance for assembly.</p>
 <p>614812/614813</p>	<p>Yaheetech Ergonomic Gaming Chair Installation Guide</p> <p>Step-by-step instructions and parts list for assembling your Yaheetech ergonomic gaming chair, featuring massage lumbar support and adjustable footrest. Ensure proper setup for optimal comfort and performance.</p>
 <p>592032</p>	<p>Yaheetech 592032 Office Chair Assembly Instructions</p> <p>Comprehensive assembly instructions for the Yaheetech 592032 office chair, including parts list, step-by-step assembly guidance, and maintenance tips. Available in English, German, Spanish, French, and Italian.</p>
 <p>592328</p>	<p>Yaheetech 592328 Ergonomic Office Chair Assembly and Maintenance Guide</p> <p>Comprehensive assembly instructions, maintenance tips, and user guide for the Yaheetech 592328 ergonomic office chair. Learn how to assemble, care for, and adjust your chair for optimal comfort and longevity.</p>
 <p>592506(Black)</p>	<p>Yaheetech 592506 Black Office Chair Assembly Instructions</p> <p>Comprehensive guide for assembling the Yaheetech 592506 Black ergonomic office chair, including parts identification, step-by-step instructions, and maintenance tips.</p>

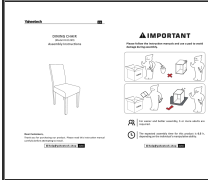

[Yaheetech Dining Chair Assembly Instructions \(Model 611269\)](#)

Step-by-step assembly guide for the Yaheetech Dining Chair, Model 611269. Includes safety precautions, parts identification, and detailed instructions for building your chair.