

TOALLIN SC100U

TOALLIN SC100U 4K Webcam Instruction Manual

UHD 4K Webcam for Streaming, Conferencing, and Video Calls

1. OVERVIEW

The TOALLIN SC100U 4K Webcam is designed for high-quality video streaming, conferencing, and online education. Featuring a 4K 1/2.5" Ultra large CMOS sensor, it delivers clear images and smooth videos with up to 12 Million Pixels resolution. This webcam includes advanced functionalities such as Phase Detection Auto Focus (PDAF), dual noise-reduction microphones, and a feature-rich remote control for enhanced usability.

Key Features:

- **4K UHD Resolution:** Captures video at Ultra HD 4K, providing exceptional clarity.
- **12 Megapixel Sensor:** Equipped with a 12MP 1/2.5" CMOS sensor for detailed imaging, especially in bright environments.
- **PDAF Auto-Focus:** Phase Detection Auto Focus ensures faster and more precise focusing on subjects.
- **Lockable Auto-Focus Distance:** Allows users to lock the focus at a specific distance to keep objects sharp while blurring others.
- **Dual Noise-Reduction Microphones:** Built-in microphones with noise reduction algorithm for clear audio capture.
- **5X Digital Zoom:** Provides digital zoom capabilities for adjusting framing.
- **Feature-Rich Remote Control:** Offers convenient control over various camera settings and functions.
- **Image Mirroring Mode:** Supports horizontal and vertical mirror flip for multi-angle shooting, suitable for document camera use and live streaming.
- **Removable Privacy Cover:** A physical cover to protect privacy when the webcam is not in use.

2. WHAT'S IN THE BOX

Verify that all items are present in the package:

- TOALLIN SC100U 4K Webcam
- USB Cable
- USB A-C Adapter
- Remote Control
- User Manual

3. PRODUCT DIAGRAM

Familiarize yourself with the components of your TOALLIN SC100U 4K Webcam:

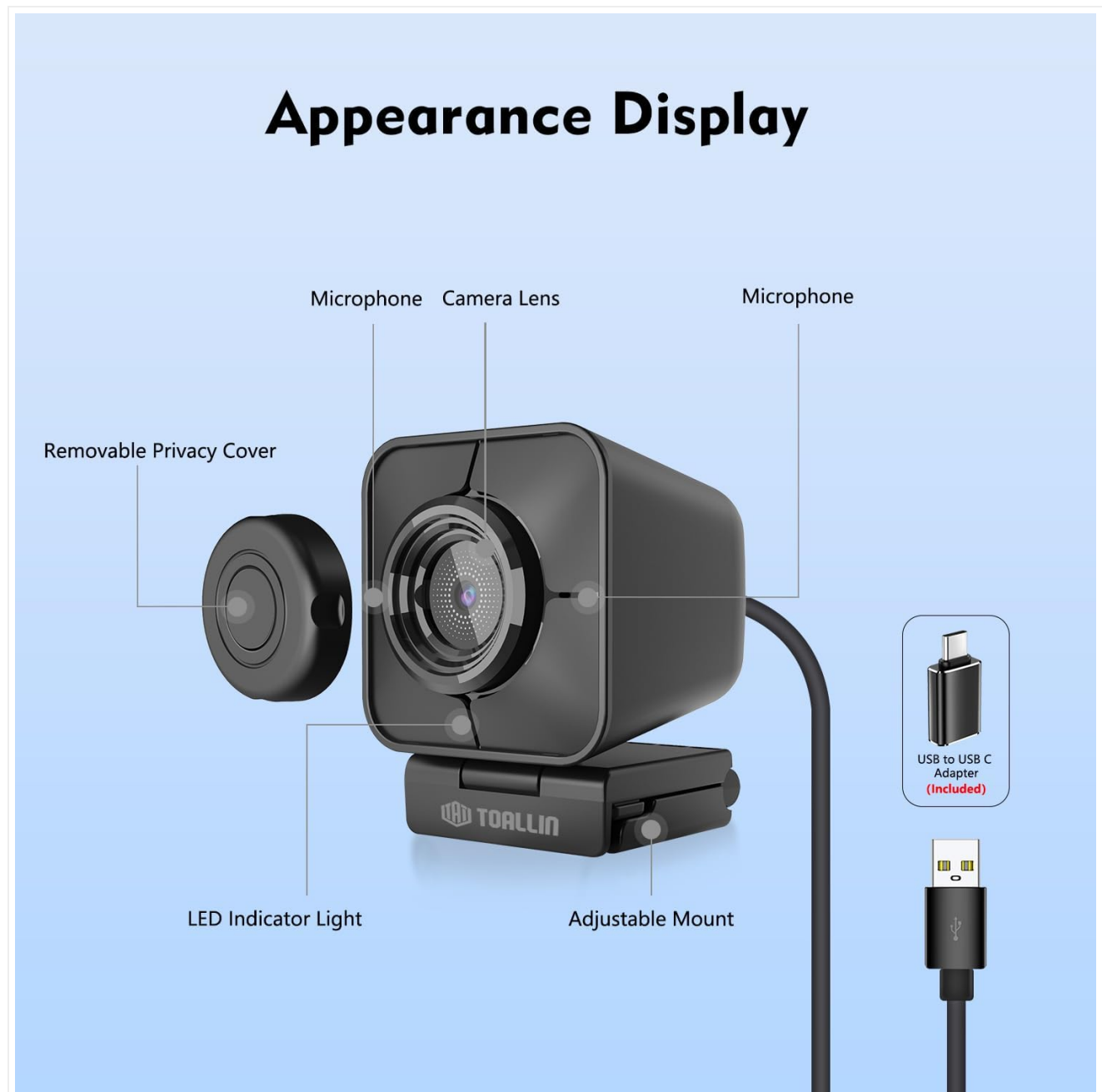

Image: Detailed view of the TOALLIN SC100U 4K Webcam, highlighting its key parts including the removable privacy cover, camera lens, microphones, LED indicator light, adjustable mount, and the USB-C port with included adapter and cable.

4. SETUP

4.1 Connecting the Webcam

1. Connect the provided USB cable to the USB-C port on the back of the webcam.
2. Plug the USB-A end of the cable into an available USB port on your computer. If your computer only has USB-C ports, use the included USB A-C adapter.
3. The webcam is plug-and-play and should be automatically recognized by your operating system.

Stream and Video Call In Ultra 4K HD

Large 1/2.5" CMOS sensor, up to 12 Mega Pixels high resolution outputs



Image: The TOALLIN SC100U 4K Webcam mounted on a monitor, connected to a computer, ready for use in streaming or video calls.

4.2 Mounting the Webcam

The webcam features an adjustable mount that can be securely placed on top of a monitor or laptop screen. It also includes a standard 1/4-inch threaded mount on the bottom for attachment to a tripod (not included).

4.3 Remote Control Pairing

The remote control is pre-paired. If the remote control fails to pair with the camera, press and hold the "Switch camera on/off" button on the remote for 5 seconds to re-pair it.

Feature-Rich Remote Control



Image: The remote control for the TOALLIN SC100U 4K Webcam, showing all its buttons and their respective functions for camera adjustment.

5. OPERATING INSTRUCTIONS

5.1 Basic Operation

- Once connected, open your preferred video conferencing or streaming application.
- Select the "TOALLIN 4K HD Camera" as your video input device.
- Select the webcam's built-in microphone as your audio input device.

5.2 Using the Remote Control

The remote control provides comprehensive adjustments for your webcam:

- **Auto-Focus (AF):** Press the 'AF' button to toggle auto-focus.
- **Lockable Auto-Focus:** After the camera focuses, you can lock the current focus distance to maintain sharpness on specific objects.
- **Mirror/Flip:** Use the 'Mirror' button for horizontal image flip and the 'Flip' button for vertical image flip. This is useful for document camera applications or specific streaming needs.

Mirror Flip Mode(Remote Control)

Supports horizontal and vertical mirror flip, facilitating multi-angle shooting. This makes it ideal for use as a document camera and live streaming camera

Horizontal Mirror (Flip the image along the horizontal line)



Mirror Vertically (Flip the image along the vertical axis)



Image: Demonstration of the webcam's mirror and flip functions, showing how the image can be horizontally or vertically inverted using the remote control.

- **Digital Zoom:** Use the '+' and '-' zoom buttons to adjust the 5X digital zoom. Note: Zoom functions may only work below 2K pixels resolution.
- **Image Adjustments:** Adjust backlight compensation, brightness, contrast, and saturation using the dedicated buttons.
- **Frequency Switching:** Toggle between 50Hz and 60Hz to match your local power frequency and avoid flickering.
- **Microphone Mute:** Use the microphone icon button to mute or unmute the built-in dual microphones.

Your browser does not support the video tag.

Video: An official product video demonstrating the TOALLIN Ultra HD 4K Webcam's features, including PDAF auto-focus, remote control functions like mirror and flip modes, and its plug-and-play connectivity with a laptop. The video highlights the ease of use and various adjustments available.

6. MAINTENANCE

6.1 Cleaning

To maintain optimal performance, regularly clean the webcam lens and body. Use a soft, dry, lint-free cloth. Avoid using harsh chemicals or abrasive materials that could damage the lens or surface.

6.2 Privacy Cover

Always use the removable privacy cover when the webcam is not in use to protect your privacy and the lens from dust and scratches.

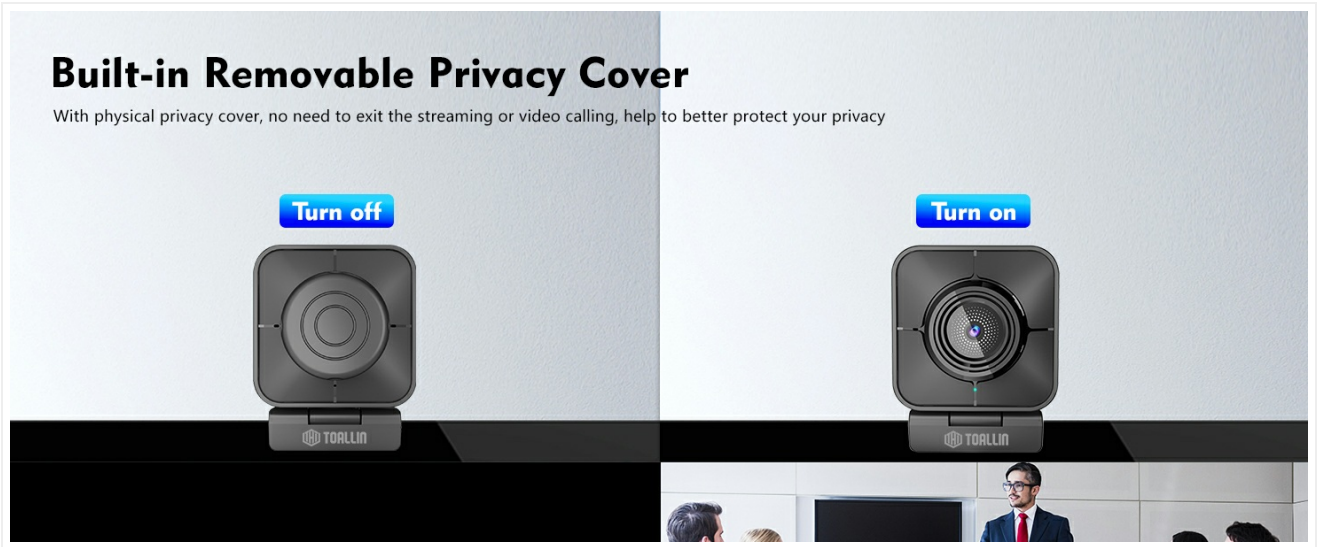

Image: The webcam with its removable privacy cover, illustrating how to cover and uncover the lens for privacy and protection.

7. TROUBLESHOOTING

7.1 Remote Control Not Responding

If the remote control is not responding, ensure it has a working battery. If issues persist, try re-pairing it by pressing and holding the "Switch camera on/off" button for 5 seconds.

7.2 Video Flickering

If you experience video flickering, try connecting the webcam to a different USB port on your computer, preferably a rear port if using a desktop. Some front USB ports may not provide stable power or data transfer, leading to flickering. Also, ensure the correct frequency (50Hz/60Hz) is selected via the remote control to match your region's electrical frequency.

7.3 No Image/Audio

- Verify the USB cable is securely connected to both the webcam and your computer.
- Ensure the webcam is selected as the primary video and audio input device in your application settings.
- Restart your computer and the application.

8. SPECIFICATIONS

Feature	Detail
Brand	TOALLIN
Model Number	SC100U
Item Weight	11.3 ounces

Feature	Detail
Package Dimensions	4.76 x 4.06 x 3.31 inches
Batteries	1 C battery required (included for remote)
Special Features	PDAF Auto-Focus, Remote Control, Image Mirroring
Photo Sensor Technology	CMOS
Video Capture Resolution	4K
Maximum Focal Length	30 Millimeters
Maximum Aperture	1.7 f
Flash Memory Type	CompactFlash
Video Capture Format	MPEG
Supported Audio Format	PCM
Screen Size	2 inches
Connectivity Technology	USB

9. WARRANTY AND SUPPORT

TOALLIN provides 7*24-hours customer support for the SC100U 4K Webcam. If you encounter any problems with the product or require assistance, please do not hesitate to contact our support team.

Contact Support: tai_support@163.com