

Manuals+

[Q & A](#) | [Deep Search](#) | [Upload](#)

manuals.plus /

- › [Kidde](#) /
- › [Kidde Carbon Monoxide Detector KN-COB-DP2 Instruction Manual](#)

Kidde KN-COB-DP2

Kidde Carbon Monoxide Detector KN-COB-DP2 Instruction Manual

Model: KN-COB-DP2 | Brand: Kidde

1. INTRODUCTION

The Kidde Carbon Monoxide Detector (Model KN-COB-DP2) is designed to detect carbon monoxide (CO) gas in your home and alert you with an 85-decibel alarm. This device utilizes electrochemical sensor technology for reliable detection. It operates by plugging into a standard 120V AC power outlet and includes two AA alkaline batteries for backup power during outages. Key features include a test-hush button, peak level memory, and an end-of-life alarm.



Image 1: Kidde Carbon Monoxide Alarm highlighting LED operation, test/reset button, event memory, low battery backup, end of unit life alarm, and 10-year limited warranty.

2. IMPORTANT SAFETY INFORMATION

WARNING: Carbon monoxide is an invisible, odorless, and tasteless gas that can be fatal. This alarm is designed to detect carbon monoxide from any source of combustion. It is not designed to

detect smoke or fire.

- Never ignore a CO alarm. Act immediately.
- If the alarm sounds, move to fresh air immediately. Call 911 or your local emergency services.
- Do not paint the unit.

3. PRODUCT FEATURES

- **Electrochemical Sensor:** Advanced technology for accurate CO detection.
- **Plug-in Operation:** Easily connects to any standard 120V AC wall outlet.
- **AA Battery Backup:** Provides continuous protection during power outages (2 AA alkaline batteries included).
- **85-Decibel Alarm:** Loud audible alert when carbon monoxide is detected.
- **Test-Hush Button:** Allows for easy testing of the alarm's functionality and temporary silencing of nuisance alarms.
- **Peak Level Memory:** Records the highest CO concentration detected since the last reset or power cycle.
- **End of Unit Life Alarm:** Alerts you when the unit needs to be replaced, typically after 10 years of operation.
- **Tamper Resist Feature:** Helps prevent unauthorized removal of the unit.

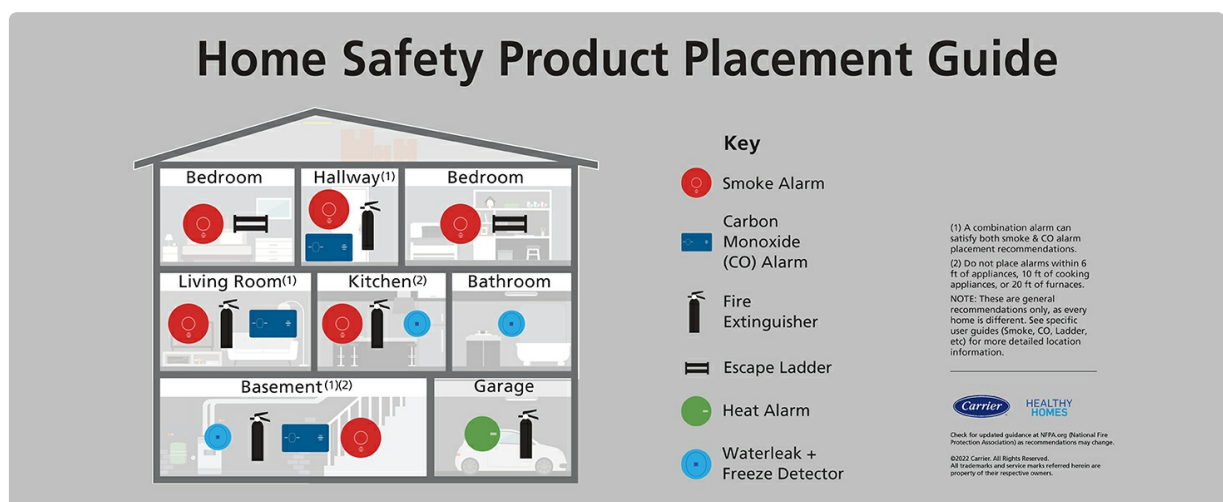

Image 2: Visual representation of the detector's key features, including CO detection, event memory, tamper resistance, battery backup, UL certification, and the test/reset button.

4. INSTALLATION

1. **Unpack the Unit:** Carefully remove the carbon monoxide detector from its packaging.
2. **Activate Battery Backup:** The unit comes with two AA alkaline batteries pre-installed. A yellow pull tab may need to be removed to activate the battery backup. Ensure the battery compartment is securely closed.
3. **Plug into Outlet:** Insert the detector into a standard, unswitched 120V AC wall outlet. The unit is designed to allow access to the second outlet if it's a dual outlet.
4. **Verify Operation:** Once plugged in, the green LED indicator should illuminate, signifying proper operation.

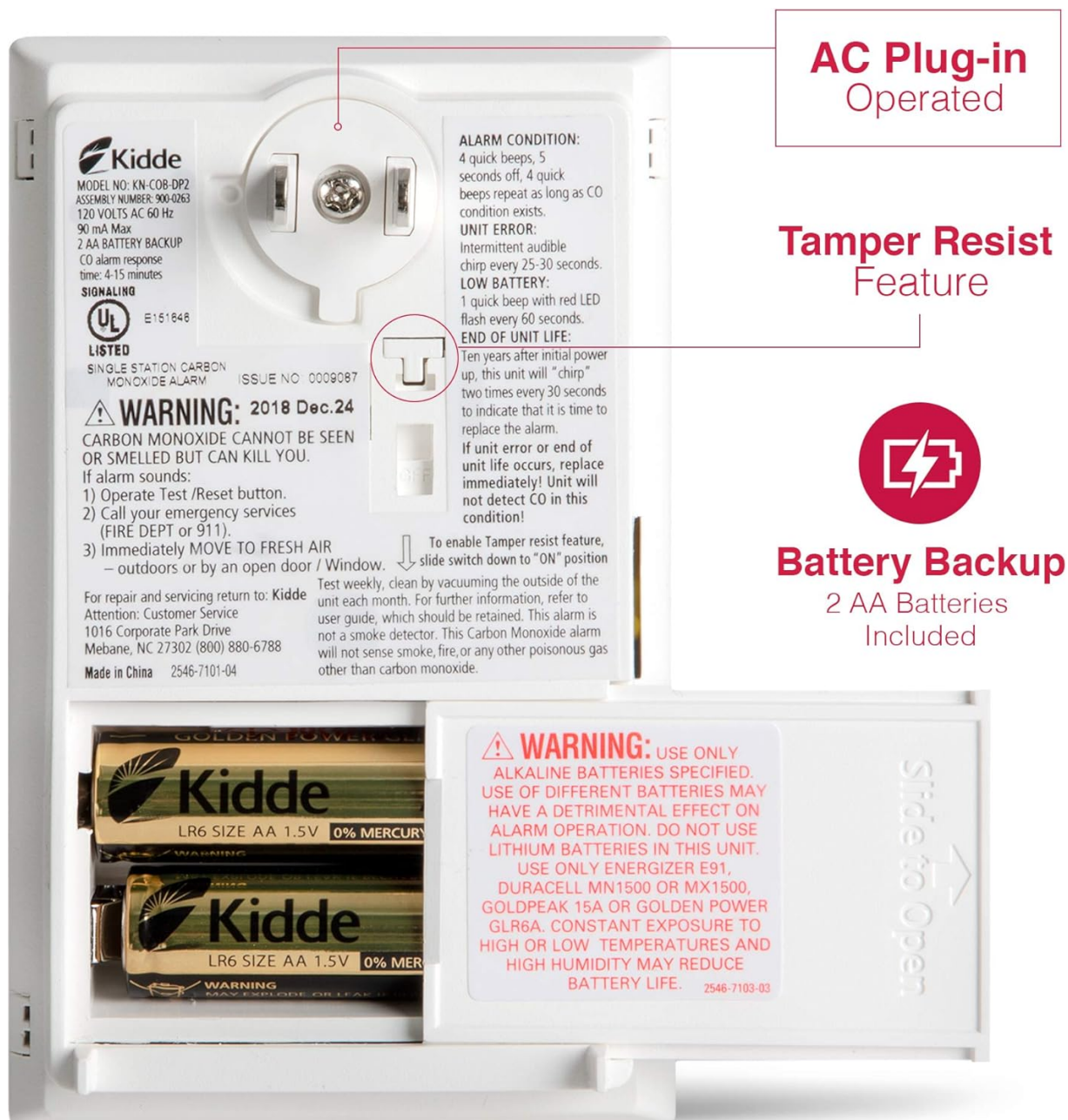

Image 3: The rear of the detector, illustrating the AC plug and the battery compartment for backup power.



Image 4: Diagram detailing the AC plug-in, tamper resist switch, and the inclusion of 2 AA batteries for backup.

5. OPERATING INSTRUCTIONS

LED Indicators:

- **Green LED:** Flashes every 60 seconds, indicating normal operation.
- **Red LED:** Flashes with an audible alarm, indicating CO detection.

Test/Hush Button:

Press and hold the **Test/Reset** button to test the alarm's electronic circuitry and horn. The alarm will sound if functioning correctly. To silence a nuisance alarm (e.g., from cooking fumes), press the **Test/Reset** button. This will temporarily silence the alarm for approximately 8 minutes.

Peak Level Memory:

The detector records the highest CO concentration detected. To view the peak level, press the **Test/Reset** button. The display (if applicable to your model) will show the recorded level. This feature also records the last time the unit was tested.



Image 5: The front of the detector, displaying the operational indicators and the test/reset button.

6. MAINTENANCE

Weekly Testing:

Test the alarm weekly by pressing and holding the **Test/Reset** button until the alarm sounds. This confirms the unit is functioning properly.

Battery Replacement:

The unit will chirp once every 60 seconds with a red LED flash when the batteries are low. Replace the two AA alkaline batteries immediately. Refer to Image 3 for battery compartment location.

Cleaning:

Clean the detector regularly by vacuuming the outside of the unit with a soft brush attachment. Do not use cleaning solvents or spray directly into the unit.

End of Unit Life:

The unit has a 10-year operational life. After 10 years, the unit will chirp every 30 seconds to indicate it needs to be replaced. This chirp cannot be silenced and will continue until the unit is replaced.

7. PLACEMENT GUIDELINES

For optimal protection, install carbon monoxide detectors on every level of your home, including the basement. Place a detector near sleeping areas and in rooms where fuel-burning appliances are located. Avoid placing detectors:

- Within 6 feet of cooking appliances.
- Within 20 feet of furnaces.
- In garages, kitchens, or furnace rooms (unless specifically recommended by local codes).
- In direct sunlight or near heating/cooling vents.

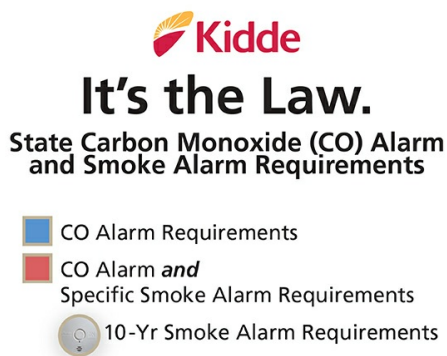

All adopted statewide codes include requirements of smoke alarms, except TX and MO are based on local requirements.

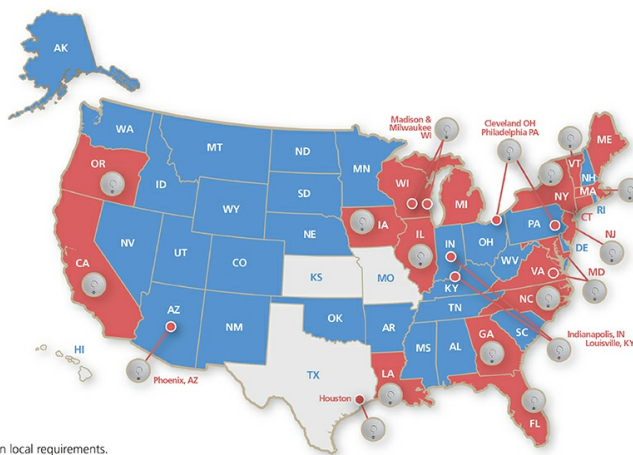

Image 6: A Kidde Carbon Monoxide Alarm installed in a typical home environment, demonstrating its discreet design.

8. TROUBLESHOOTING

| Condition | Indicator/Sound | Action |
|------------|---|------------------------------|
| CO Alarm | 4 quick beeps, 5 seconds off, repeats. Red LED flashes. | Move to fresh air. Call 911. |
| Unit Error | Intermittent audible chirp every 25-30 seconds. | Replace the unit. |

| Condition | Indicator/Sound | Action |
|------------------|---|--------------------------------|
| Low Battery | 1 quick beep with red LED flash every 60 seconds. | Replace batteries immediately. |
| End of Unit Life | 1 chirp every 30 seconds. | Replace the unit. |

9. SPECIFICATIONS

| Feature | Detail |
|--------------------|--|
| Model Number | KN-COB-DP2 |
| Power Source | 120V AC Plug-in with 2 AA Alkaline Battery Backup |
| Alarm Sound Level | 85 Decibels |
| Sensor Technology | Electrochemical |
| Product Dimensions | 2.32"D x 2.83"W x 4.72"H |
| Item Weight | 10.9 ounces (0.31 Kilograms) |
| Operating Humidity | 10 to 95% relative humidity (RH), non-condensing |
| Certifications | UL Certified (Meets UL 2034, NFPA72, NFPA101, FHA, HUD requirements) |
| Color | White |

 **Kidde** Over 100 Years Of Innovation



Loud 85 Decibel Alarm
Alerts of Deadly CO Gas

Image 7: Side view of the detector with approximate dimensions, highlighting its compact design.

10. WARRANTY AND SUPPORT

This Kidde Carbon Monoxide Detector comes with a **10-year limited manufacturer's warranty**. For warranty claims, technical support, or further information, please refer to the contact details provided in the product packaging or visit the official Kidde website.