

Manuals+

[Q & A](#) | [Deep Search](#) | [Upload](#)

[manuals.plus](#) /

› [Aheaplus](#) /

› [Aheaplus YH02 21.3-inch Closet System with 4 Drawers and Open Shelves Instruction Manual](#)

Aheaplus YH02

Aheaplus YH02 21.3-inch Closet System with 4 Drawers and Open Shelves Instruction Manual

Model: YH02 | Brand: Aheaplus

INTRODUCTION

Thank you for choosing the Aheaplus YH02 Closet System. This manual provides detailed instructions for the assembly, operation, and maintenance of your new storage unit. Please read this manual thoroughly before beginning assembly to ensure correct installation and safe use. Retain this manual for future reference.

SAFETY INFORMATION

WARNING: Failure to follow these safety instructions may result in injury or damage to the product.

- Ensure proper assembly to prevent tipping.
- Always use the included anti-tip kits to secure the unit to a wall.
- Do not allow children to climb on the unit.
- Distribute weight evenly across shelves and drawers.
- Keep small parts away from children during assembly.
- Use appropriate tools as specified in the assembly instructions.

PRODUCT FEATURES

The Aheaplus YH02 Closet System is designed for efficient storage and organization. Key features include:

- **Four Wooden Drawers:** Durable wooden construction with smooth sliders and metal handles, suitable for personal belongings, underwear, socks, or folded garments.
- **Three Open Shelves:** Provides accessible storage for decorative items, folded clothes, or frequently used essentials.
- **Wall-Friendly Structure:** The upper section is designed to be slightly deeper to accommodate baseboards, allowing the unit to sit flush against the wall.

- **Sturdy Construction:** Made from premium wood board for stability and durability.
- **Anti-Tip Kits:** Includes two anti-tip kits for enhanced safety and stability.
- **Waterproof Surface:** The surface is designed to be resistant to water.
- **Dimensions:** 21.3"L x 15.8"W x 80"H.



Four Pull-out Wood Drawers



2 Adjustable Storage Shelves

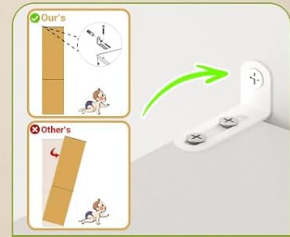

Anti-tip Kits to Ensure Safety



Waterproof Surface

Image: Key features of the Aheaplus YH02 Closet System, highlighting its four wooden drawers, adjustable shelves, anti-tip mechanism, and waterproof surface.

PACKAGE CONTENTS

Before assembly, verify that all components are present and undamaged. If any parts are missing or damaged, please contact customer service.

- Wood panels for frame and shelves
- Four wooden drawer components
- Metal drawer handles
- Drawer sliders
- Assembly hardware (screws, dowels, cam locks, etc.)
- Two anti-tip kits
- Instruction manual

- Necessary tools (usually an Allen wrench, screwdriver may be required)

ASSEMBLY INSTRUCTIONS

Assembly is required for this product. It is recommended to have two people for easier and safer assembly. All parts are clearly labeled. Follow the steps below carefully.

Step 1: Unpack and Identify Components

Carefully unpack all items from the box. Lay out all wood panels and hardware. Match each component to the corresponding label in the instruction diagram. Ensure all pieces are accounted for before proceeding.



Image: Product dimensions and individual drawer components, illustrating the size and parts of the closet system.

Step 2: Assemble the Main Frame

Connect the side panels to the top and bottom panels using the provided hardware (dowels, screws, and cam locks). Ensure all connections are secure and the frame is stable. Pay attention to the orientation of the panels, especially the deeper upper section designed for baseboards.

Step 3: Install Shelves

Insert the shelf pins into the pre-drilled holes at your desired height for the adjustable shelves. Place the

shelves onto the pins, ensuring they are level and secure. The fixed shelves should be installed according to the diagrams.

Step 4: Assemble Drawers

Assemble each of the four wooden drawers by connecting the side, front, and back panels. Slide the bottom panel into the grooves. Attach the metal handles to the front of each drawer. Install the drawer sliders onto the sides of the drawers and the corresponding tracks within the main frame.

Step 5: Install Anti-Tip Kits

For safety, attach the anti-tip kits to the top rear of the closet system and secure them to a wall stud using appropriate wall anchors and screws. This step is crucial to prevent accidental tipping.

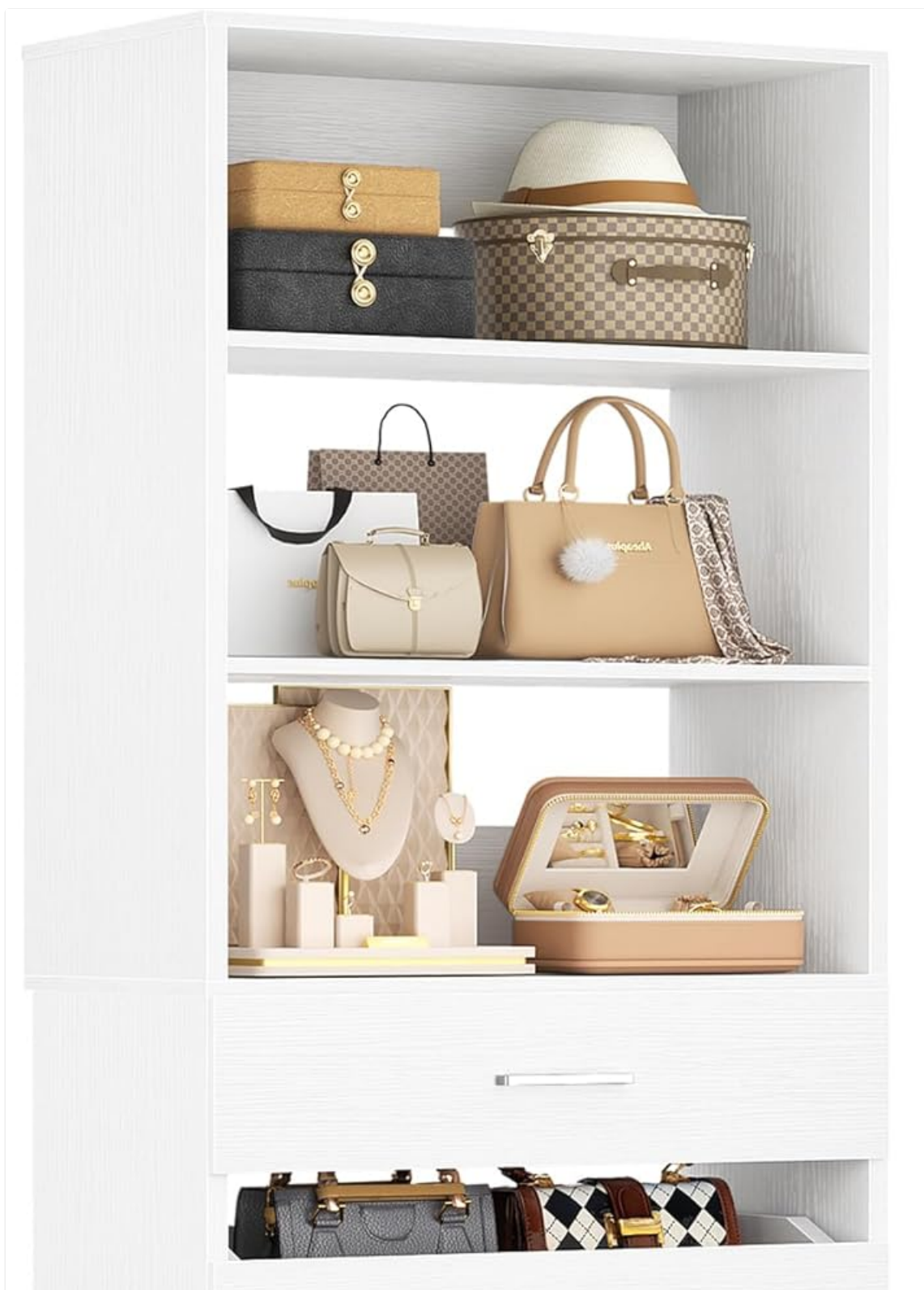



Image: The Aheaplus YH02 Closet System fully assembled and in use, showcasing its storage capabilities for various items.

OPERATING INSTRUCTIONS

Once assembled and secured, your Aheaplus YH02 Closet System is ready for use.

- **Drawers:** Gently pull the metal handles to open the drawers. Push them back in until they are fully closed. Avoid forcing drawers if they feel stiff; check for obstructions.
- **Shelves:** Place items on the open shelves. Ensure heavier items are placed on lower shelves for stability. Do not overload shelves beyond their weight capacity (approximately 100 lbs total for the unit, distribute evenly).
- **Adjustable Shelves:** To adjust shelf height, remove all items from the shelf, lift the shelf, remove the pins, reposition the pins to new holes, and then replace the shelf.

MAINTENANCE

Regular maintenance will help prolong the life of your closet system.

- **Cleaning:** Wipe surfaces with a soft, damp cloth. Avoid harsh chemicals or abrasive cleaners, which can damage the finish.
- **Spills:** Due to the waterproof surface, spills can be wiped away easily. Clean immediately to prevent potential damage.
- **Hardware:** Periodically check all screws and connections to ensure they remain tight. Retighten if necessary.
- **Drawer Sliders:** If drawers become stiff, a small amount of silicone-based lubricant can be applied to the sliders.

TROUBLESHOOTING

If you encounter issues with your Aheaplus YH02 Closet System, refer to the following common solutions:

Problem	Possible Cause	Solution
Unit wobbles or feels unstable	Loose connections; not secured to wall; uneven floor.	Ensure all screws are tightened. Install or check anti-tip kits. Place shims under the base if the floor is uneven.
Drawers do not slide smoothly	Misaligned sliders; obstructions; dry sliders.	Check that drawer sliders are correctly installed and aligned. Remove any obstructions. Apply silicone lubricant to sliders.
Missing parts during assembly	Packaging error.	Double-check all packaging materials. If still missing, contact Aheaplus customer service with your purchase details.

If you experience issues not covered here, please contact Aheaplus customer support for assistance.

SPECIFICATIONS

Attribute	Detail
Brand	Aheaplus
Model Name	YH02
Product Dimensions	15.8"D x 21.3"W x 80"H
Color	White
Material	Engineered Wood
Number of Drawers	4
Number of Shelves	3 (open)
Special Features	Anti-Tipping, Stackable, Adjustable Shelf, Wall-Friendly Structure, Waterproof Surface
Assembly Required	Yes

WARRANTY AND SUPPORT

For warranty information or customer support, please refer to the documentation included with your purchase or visit the official Aheaplus website. If your item arrives damaged, scratched, or with missing parts, contact our customer service team for assistance within 24 hours of receipt.

