

[Manuals.plus](#) /

> [CHITA](#) /

> CHITA Super Large Luxury L Shape Convertible Sectional Modular Sofa User Manual

CHITA L Shape Sofa

CHITA Super Large Luxury L Shape Convertible Sectional Modular Sofa User Manual

Model: L Shape Sofa

Brand: CHITA

INTRODUCTION

Welcome to your new CHITA Super Large Luxury L Shape Convertible Sectional Modular Sofa. This manual provides comprehensive instructions for assembly, operation, maintenance, and troubleshooting to ensure you get the most out of your new furniture.



An overhead view of the assembled CHITA L-Shape Modular Sofa in Linen color, showcasing its spacious design and modular components.

SAFETY INFORMATION

All foam and upholstered surfaces meet flammability standards. Keep away from open flames or high heat sources. Supervise children and pets to avoid entrapment risks.

PACKAGE CONTENTS & DIMENSIONS

Your CHITA modular sofa comes in five separate packages, which may arrive on different dates. Please ensure all boxes are present before beginning assembly.

- Box 1: Arms
- Box 2: Left Chair Seat & Backrest
- Box 3: Right Chair Seat & Backrest
- Box 4: Armless chair
- Box 5: Ottoman



A detailed line drawing illustrating the various dimensions of the CHITA L-Shape Modular Sofa, including overall width, depth, and height, as well as seat depth and height. Also shown are the five shipping boxes.

Product Dimensions

Feature	Measurement
Overall Dimensions (D x W x H)	72.8"D x 117.7"W x 33.1"H
Individual Seat Dimension (W x D x H)	35"W x 23.6"D x 19.7"H
Seat Depth	58.7 inches
Seat Height	19.7 Inches
Minimum Door Width for Delivery	16 Inches
Weight Capacity (per seat)	350 lbs

SETUP & ASSEMBLY

The CHITA modular sofa is designed for minimum tool-free assembly. Each step is intuitive.

1. Unpack all components from the five boxes. Ensure all parts are present before starting.
2. Begin with the Arms Box (Box 1) and follow the detailed instructions provided within.
3. Connect the modular pieces using the integrated connectors.
4. Once assembled, fluff the cushions to help them expand fully.

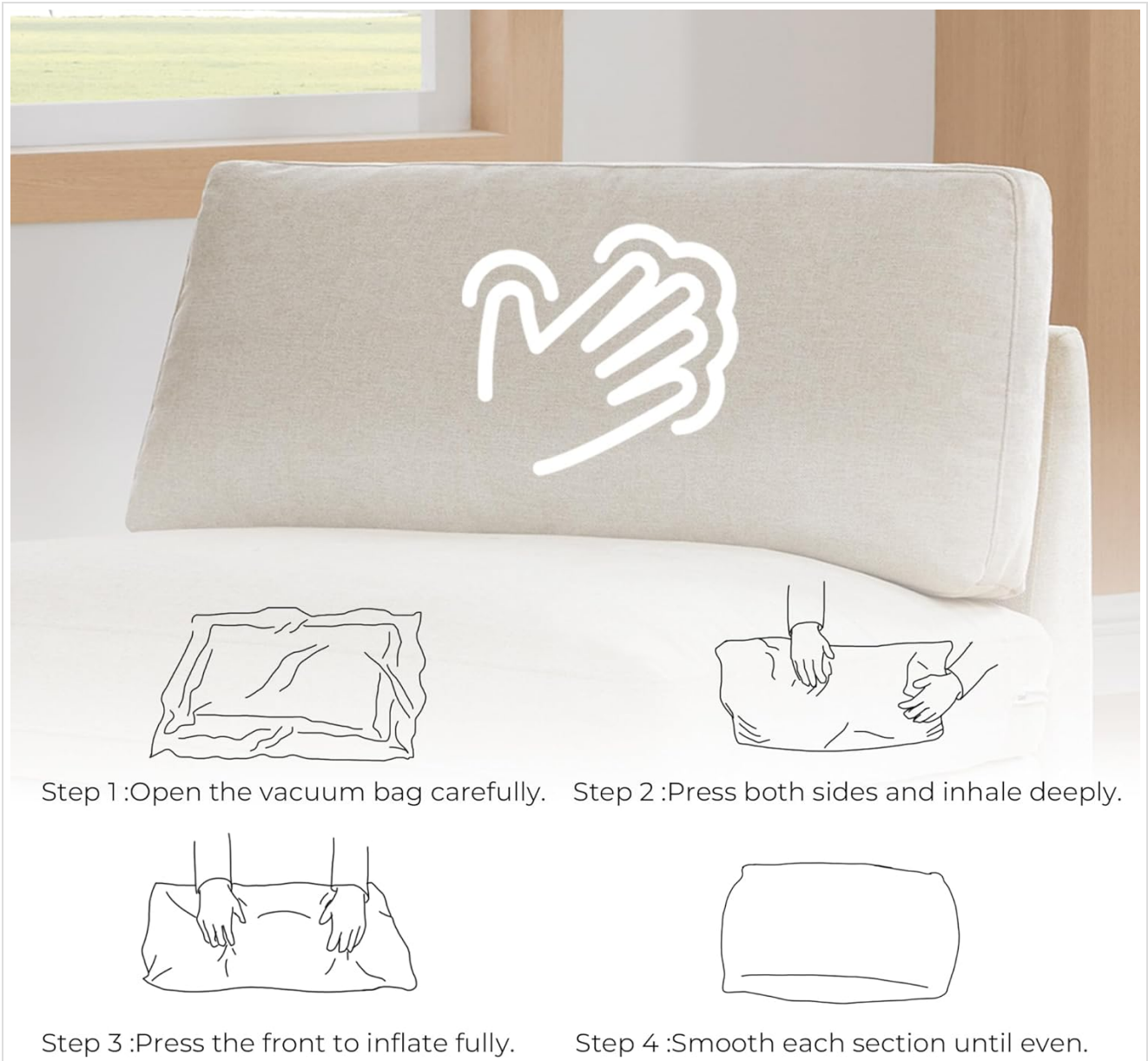

A visual guide demonstrating the four steps to properly fluff the sofa cushions after unpacking: open vacuum bag, press sides, press front, and smooth each section.

OPERATING YOUR MODULAR SOFA

The modular design allows for versatile arrangements to suit your living space.

Modularity

The individual pieces can be easily moved and rearranged to create different configurations, from a large L-shape sectional to separate seating units. This flexibility allows you to adapt the sofa to various room layouts and needs.



A view of the CHITA L-Shape Modular Sofa in a living room, demonstrating its adaptable design and spacious seating.

Comfort Features

- **Deep Seats:** Enjoy extra deep seats (23.6 inches) for maximum comfort and lounging.
- **Feather-Blend Cushions:** Seat cushions are filled with 2.0 high-density foam and sterilized feathers, providing a medium firmness (3 out of 5). Back cushions are filled with soft fiber and sterilized feathers.
- **Solid Wood Plinth Base:** The exposed kiln-dried solid wood frame adds durability and a stylish touch, while the high-leg design allows for easy cleaning underneath.

MAINTENANCE & CARE

Cleaning Instructions

The linen-like fabric is durable and easy to clean. Cushions are loose with zip-off covers for convenient maintenance.

- For general cleaning, wipe with a dry cloth.
- For spills, promptly clean the affected area. The fabric is engineered to withstand heavy use.

- Cushion covers are removable and can be washed. Refer to the care label for specific washing instructions to prevent shrinking or pilling.
- Regularly fluff cushions to maintain their shape and appearance.

TROUBLESHOOTING

This section addresses common inquiries and minor issues you might encounter with your CHITA modular sofa.

Cushions appear flat or wrinkled:

This is normal after shipping due to vacuum packaging. Follow the cushion fluffing instructions in the "Setup & Assembly" section. Regular fluffing will help maintain their fullness.

Modular pieces are not staying together:

Ensure the integrated connectors on the underside of each module are properly aligned and engaged. Push the modules firmly together until they lock into place.

Fabric stains or marks:

The fabric is designed for durability and easy cleaning. For most spills, a dry cloth can be used. For tougher stains, remove the zip-off cover and follow the care label instructions for washing. Test any cleaning solution on an inconspicuous area first.

PRODUCT SPECIFICATIONS

Attribute	Detail
Brand	CHITA
Model	L Shape Sofa
Color	Linen
Material Type	Soft and Durable Textured Fabric, Wood
Frame Material Type	Solid Engineered Wood and Hard Wood (Kiln-dried)
Seat Fill Material	2.0 High-Density Foam and Sterilized Feathers
Seat Back Fill Material	Soft Fiber and Sterilized Feathers
Cushion Construction	Hybrid foam and feather fill with zip-off covers
Item Firmness Description	Medium (3 out of 5)
Number of Pieces	4 (plus ottoman)
Assembly Required	Yes (Tool-Free)
Warranty Type	Extended
Certifications	CertiPUR-US, EPA TSCA Title VI compliant, OEKO-TEX® STANDARD 100

WARRANTY AND SUPPORT

Warranty Information

This CHITA sofa comes with an extended warranty. Please refer to your purchase documentation for specific terms and conditions.

Customer Support

For any questions, assistance, or to report issues, please contact CHITA customer support.

Visit the official CHITA Store: [CHITA LIVING Store](#)

Enjoy 30-day easy returns.