

HOMCOM 83A-068V80GY

HOMCOM 71" Kitchen Pantry Cabinet Instruction Manual

Brand: HOMCOM | Model: 83A-068V80GY

1. INTRODUCTION

Thank you for choosing the HOMCOM 71" Kitchen Pantry Cabinet. This freestanding kitchen hutch is designed to provide ample storage and organization solutions for your kitchen, dining room, or living area. Featuring a microwave stand, two drawers, adjustable shelves, and both glass and recessed doors, this cabinet combines functionality with an elegant design. Please read this manual carefully before assembly and use to ensure safe operation and proper maintenance.

2. SAFETY INFORMATION

Your safety is paramount. Please adhere to the following safety guidelines:

- **Anti-Tipping Mechanism:** It is crucial to securely attach the cabinet to the wall using the provided anti-tipping mechanism. Failure to do so can result in serious injury or property damage.
- **Weight Limits:** Do not exceed the specified weight limits for each component:
 - Countertop: Maximum 55 lbs (25 kg)
 - Each Drawer: Maximum 8.8 lbs (4 kg)
 - Large Shelves: Maximum 18 lbs (8.2 kg)
 - Small Shelves: Maximum 8.8 lbs (4 kg)
- **Children and Pets:** Keep children and pets away from the cabinet during assembly and ensure it is stable and secure at all times.
- **Placement:** Place the cabinet on a flat, stable, and level surface to prevent wobbling or tipping.
- **Assembly:** Follow all assembly instructions precisely. Do not skip steps or use unauthorized parts.

ADJUSTABLE HINGE

Adjust the hinges so that your door gaps can be flush

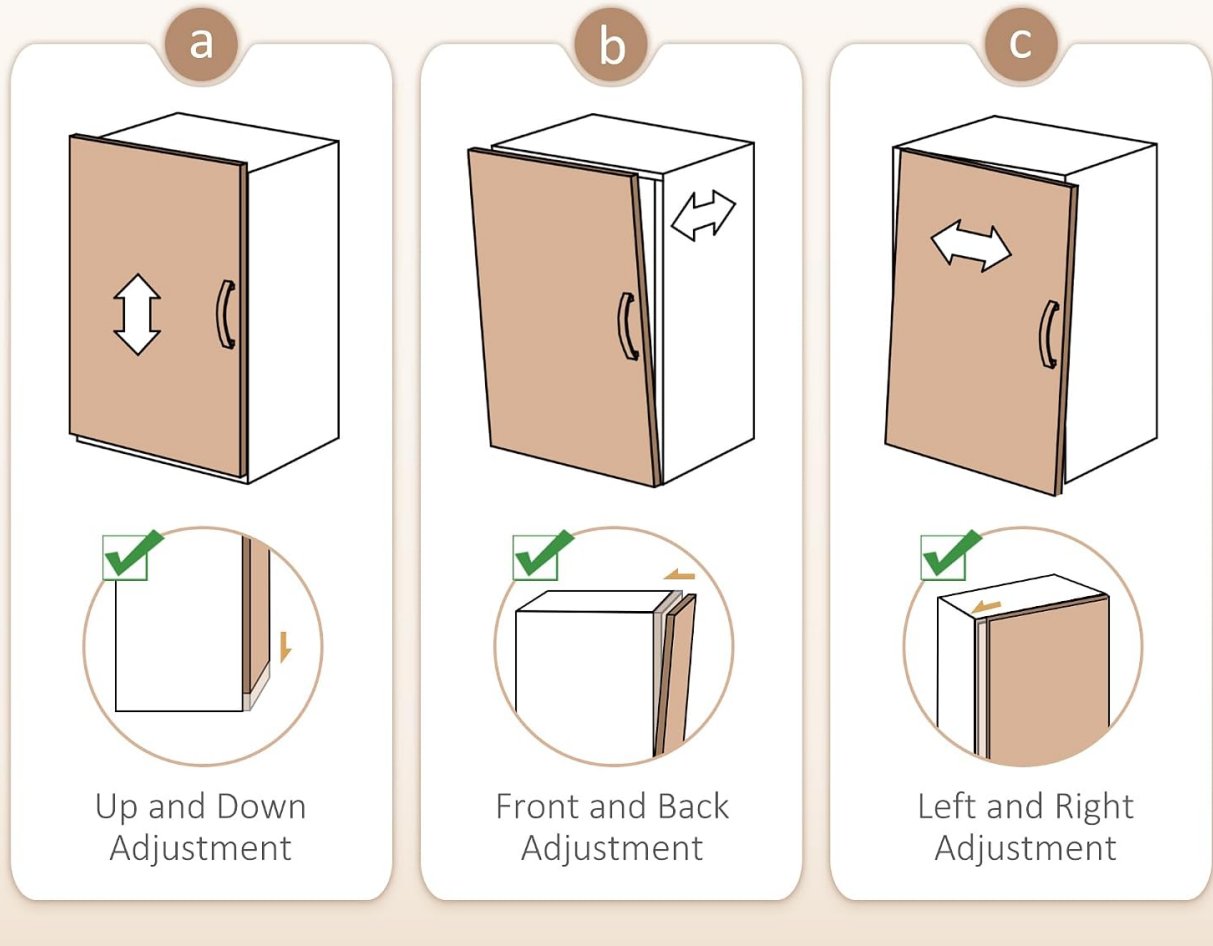

Image: Anti-tipping hardware for secure wall attachment.

This image illustrates the anti-tipping mechanism, which is essential for securing the cabinet to the wall and preventing accidental tipping.

3. PACKAGE CONTENTS

Before beginning assembly, please verify that all components and hardware are present and undamaged. Refer to the parts list included with your product packaging for a complete inventory.



Image: Product packaging indicating one package.

This image shows the typical packaging for the HOMCOM cabinet, indicating that the product is shipped in a single package.

4. SETUP AND ASSEMBLY

Assembly of this cabinet is required. Please follow the step-by-step instructions provided in the separate assembly guide included with your product. Ensure you have all necessary tools before you begin. It is recommended to assemble the cabinet with at least two people for safety and ease.

- **Preparation:** Clear a spacious area for assembly. Lay out all parts and hardware on a soft, clean surface to prevent scratches.
- **Step-by-Step:** Follow the numbered steps in the assembly manual carefully. Pay close attention to diagrams and part orientations.
- **Anti-Tipping Installation:** As noted in the safety section, install the anti-tipping hardware as the final step to secure the cabinet to a wall stud.

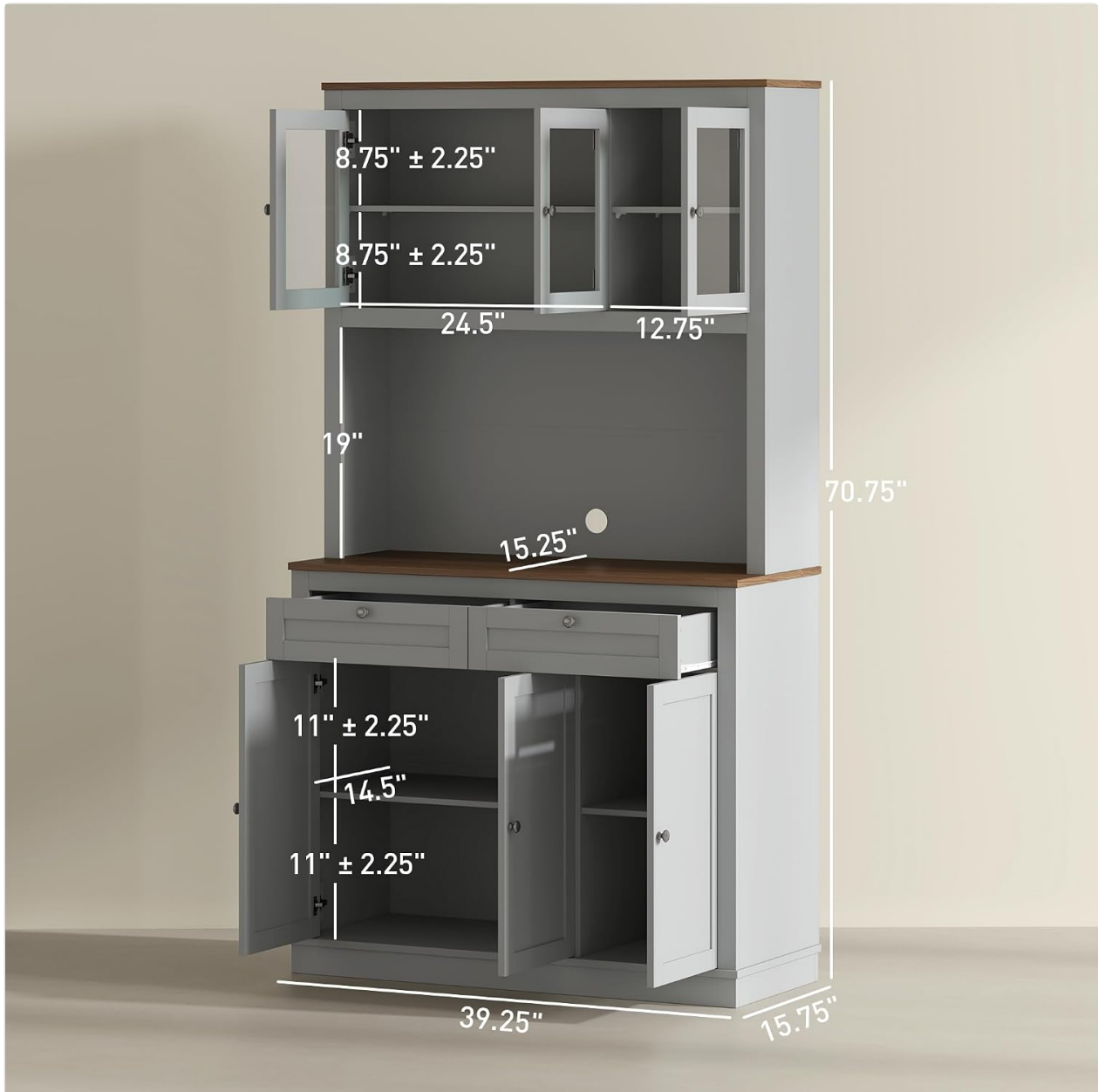

Image: Detailed dimensions of the HOMCOM Kitchen Pantry Cabinet.

This diagram provides precise measurements of the cabinet, including shelf depths, drawer heights, and overall dimensions, which are helpful during assembly and placement.

Your browser does not support the video tag.

Video: Overview of the HOMCOM 83A-068V80GY Kitchen Pantry.

This video provides a visual demonstration of the cabinet's features and potential uses, which can assist in understanding its

5. OPERATING INSTRUCTIONS

The HOMCOM Kitchen Pantry Cabinet is designed for versatile storage in various home environments. Here's how to maximize its utility:

- **Utilizing Storage Compartments:** The cabinet features eight compartments and two drawers. Use the upper glass-fronted cabinets for displaying items or storing frequently accessed goods. The lower recessed-door cabinets are ideal for larger items like dishes, pots, and pantry staples.
- **Adjustable Shelves:** The shelves within the cabinets are adjustable. To reposition a shelf, carefully remove it, adjust the shelf pins to the desired height, and reinsert the shelf. This allows you to customize storage for items of varying sizes, such as tall pitchers or small spice jars.
- **Microwave Stand:** The spacious countertop area is specifically designed to house a microwave or other small kitchen appliances. A cable hole is provided for convenient wire management, keeping your countertop tidy.
- **Drawers:** The two drawers are perfect for organizing smaller items like utensils, napkins, or silverware.



Image: Large storage space with cable management.

This image highlights the extensive storage capacity of the cabinet, including the open countertop area with a cable

management hole, and the various compartments for kitchen essentials.

PROTECT YOUR FAMILY

Anti-tipping hardware to prevent the cabinet from tipping over

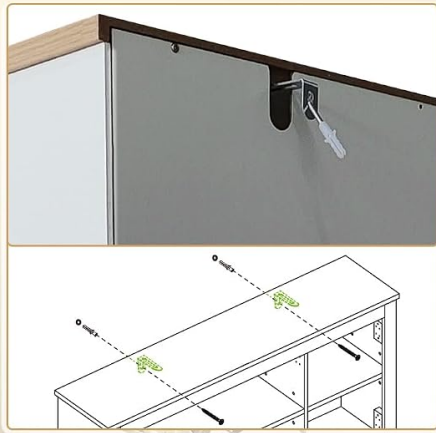

Image: Adjustable shelves feature.

This visual demonstrates how the shelves can be adjusted or removed to accommodate items of different heights, enhancing the cabinet's versatility.



Image: Close-up of the cabinet drawers.

This image provides a detailed view of the two drawers, illustrating their capacity for storing smaller kitchen items like cutlery and plates.

6. MAINTENANCE

Proper care will extend the life and appearance of your HOMCOM Kitchen Pantry Cabinet:

- **Cleaning:** The melamine-coated shelves and cabinet surfaces are easy to clean. Use a soft, damp cloth with mild soap and water. Avoid abrasive cleaners or harsh chemicals, as they can damage the finish.
- **Spills:** Wipe up spills immediately to prevent staining or moisture damage.
- **Hardware:** Periodically check all screws and fasteners to ensure they are tight. Tighten if necessary to maintain stability.
- **Sunlight and Heat:** Avoid prolonged exposure to direct sunlight or extreme heat, which can cause fading or warping.

7. TROUBLESHOOTING

If you encounter any issues with your cabinet, refer to the following common solutions:

- **Wobbly Cabinet:** Ensure the cabinet is placed on a level surface. Check that all assembly screws are securely tightened. Verify the anti-tipping mechanism is properly installed and anchored to the wall.
- **Doors Not Aligning:** The cabinet features adjustable hinges. Refer to the hinge adjustment diagram to fine-tune the door alignment (up/down, front/back, left/right).
- **Drawers Sticking:** Check for any obstructions in the drawer slides. Ensure the drawer slides are properly aligned and lubricated if necessary.
- **Damaged Parts:** If any parts are damaged or missing upon arrival, do not proceed with assembly. Contact customer support for replacement parts.



Image: Adjustable hinge guide.

This diagram provides instructions on how to adjust the cabinet hinges to ensure doors are flush and properly aligned.

8. SPECIFICATIONS

Feature	Detail
Brand	HOMCOM
Model Number	83A-068V80GY

Color	Grey
Product Dimensions	15.7"D x 39.4"W x 43.5"H
Overall Height	70.9" (approx. 180 cm)
Weight Limit (Total)	302 lbs
Weight Limit (Countertop)	55 lbs
Weight Limit (Each Drawer)	8.8 lbs
Weight Limit (Large Shelves)	18 lbs
Weight Limit (Small Shelves)	8.8 lbs
Material	Engineered Wood
Door Style	Glass Front, Recessed Doors
Special Features	Adjustable Shelf, Anti-Tipping, Cable Hole, Scratch Resistant
Assembly Required	Yes
Item Weight	114 Pounds
UPC	196393227640

9. WARRANTY AND SUPPORT

For information regarding product warranty, returns, or technical support, please refer to the documentation included with your purchase or visit the official HOMCOM website. HOMCOM offers customer support and typically provides a 30-day easy return policy. Please retain your proof of purchase for any warranty claims or support inquiries.

For direct assistance, you may contact Aosom Direct, the manufacturer, through their official channels.