

Manuals+

[Q & A](#) | [Deep Search](#) | [Upload](#)

[manuals.plus](#) /

› [DOOCK](#) /

› [DOOCK Night Vision Goggles User Manual](#)

DOOCK B06-US-1

The DOOCK logo is displayed in white, bold, sans-serif capital letters within a black rectangular box.

DOOCK Night Vision Goggles

USER MANUAL

Introduction

Thank you for choosing the DOOCK Night Vision Goggles. These advanced binoculars are designed to provide exceptional visibility in low-light and complete darkness, featuring 4K Ultra HD video recording, 52MP image capture, and an 8X digital zoom. With a powerful 5200mAh rechargeable battery and adjustable IR illuminators, they are ideal for a variety of outdoor activities including camping, hunting, wildlife observation, and security operations. This manual will guide you through the setup, operation, and maintenance of your device to ensure optimal performance and longevity.

Package Contents

Please verify that all items listed below are included in your package:

- 4K Night Vision Goggles x1
- Carrying Case x1
- Neck Strap x1
- 32GB Memory Card x1
- Type-C Cable x1



Image: The DOOCK Night Vision Goggles along with the carrying case, neck strap, 32GB memory card, and Type-C charging cable.

Key Features

Advanced Night Vision Capability

Equipped with 5-level adjustable 3W 850nm IR illuminators, these night vision goggles deliver crystal-clear visibility in total darkness. The 35mm objective lens aperture and high-sensitivity CMOS sensor provide a 2x wider field of view and superior image clarity compared to conventional models, ensuring exceptional low-light performance for tactical precision.



Adjustable 5 IR Levels

Adjust IR levels based
on ambient light and distance



8X Digital Zoom

See clearly for long-distance
observation

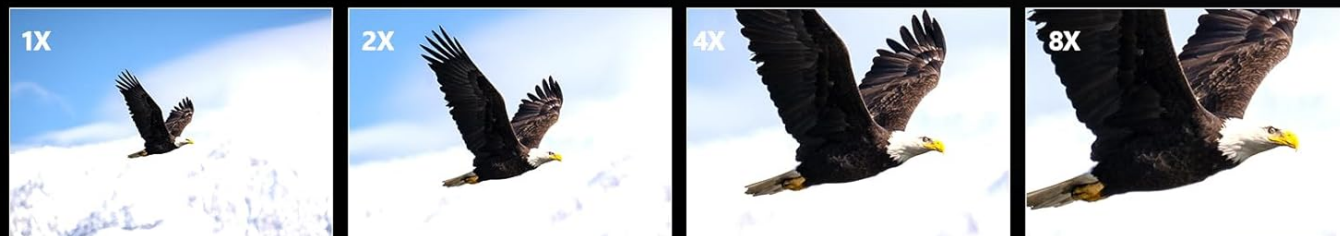

Image: Illustration of 5 adjustable IR levels and 8X digital zoom capability.

High Quality 35MM Glass Lens

The larger the lens, the clearer the image



35MM

VS

25MM



Ours:

Lens Diameter: 35MM
Greater eye comfort



Others:

Lens Diameter: 25MM
Eyes get tired easily



Image: Comparison highlighting the larger 35mm lens for clearer images and greater eye comfort.

4K Ultra HD Imaging & Audio

Capture night adventures in stunning detail with 52MP photos and 4K video recording. The built-in microphone preserves authentic ambient sound while the 3" HD display enables instant playback. Seamlessly share content via social media or showcase expeditions through vivid visual documentation.

Digital Night Vision Device

• Portable • Rechargeable • Minimalism

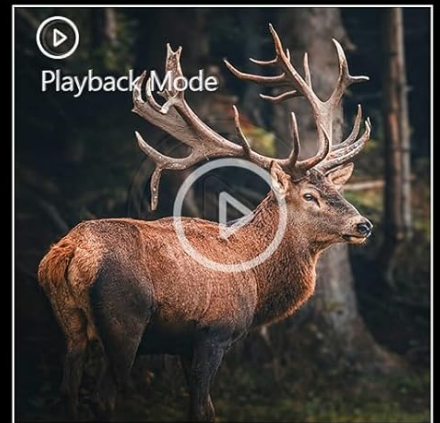
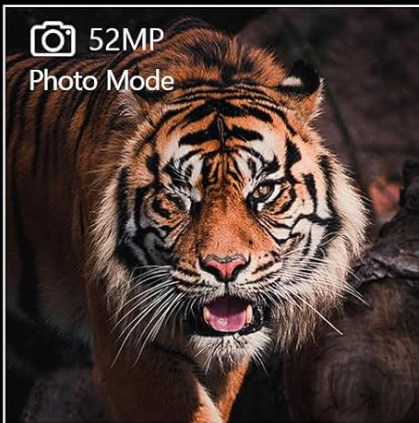

Image: The digital night vision device showcasing its photo, video, and playback modes.

Full-Color in Low Light

With advanced full-color technology, you can vividly capture and observe your surroundings in bright, vibrant colors, even at night.



Image: Demonstrating the full-color capability in low light conditions.

Low-Light Color Accuracy & 8x Zoom

Experience true-to-life color reproduction and intricate detail retention even in minimal light. The 8x digital zoom allows versatile framing of distant subjects and close-up shots, complemented by 5-level adjustable screen brightness for customized viewing across environments.

Tactical Ergonomic Design

Operate discreetly with backlit buttons and auto-screen dimming to maintain situational awareness. The ruggedized, weather-resistant chassis features anti-slip grip textures for secure handling in harsh conditions. Compact and lightweight, it's engineered for extended mobile use.

Extended Power Performance

A 5200mAh rechargeable lithium battery delivers 5+ hours runtime with IR active (12hrs standby). Ideal for extended outdoor activities including night hunting, surveillance, wildlife observation, and security operations. Includes USB-C fast charging and low-power alerts.

Enjoy Super Long-Distance Viewing



Image: The internal 5200mAh rechargeable battery and Type-C charging port.

Getting Started (Setup)

1. **Charging the Device:** Before first use, fully charge the night vision goggles using the provided USB-C cable. Connect the cable to the Type-C port on the device and a compatible USB power adapter (not included) or computer. The charging indicator will show the charging status.
2. **Inserting the Memory Card:** Locate the memory card slot. Insert the included 32GB TF memory card into the slot until it clicks into place. Ensure the card is inserted in the correct orientation. The device supports up to 128GB memory cards.
3. **Attaching the Neck Strap:** Securely attach the adjustable neck strap to the designated attachment points on the goggles for convenient and safe carrying during use.

Enjoy Super Long-Distance Viewing



6.56-1640ft in complete darkness



6.56ft-infinity in daytime

Image: The Type-C charging port on the device, illustrating how to connect for power.

Operation Guide

1. **Power On/Off:** Press and hold the power button (usually marked with a power symbol) to turn the device on or off. The 3-inch HD display will illuminate.
2. **Mode Selection:** Use the mode button (often labeled with an 'M' or mode icon) to cycle through available modes: Photo Mode, Video Mode, and Playback Mode.
3. **Adjusting Digital Zoom:** In Photo or Video mode, use the zoom buttons (often '+' and '-' or directional arrows) to adjust the 8X digital zoom.
4. **Adjusting IR Levels:** In low-light or complete darkness, activate the infrared (IR) illuminators. Use the IR adjustment buttons (often marked with an IR symbol or up/down arrows) to select one of the 5 IR levels based on ambient light and distance for optimal visibility.
5. **Capturing Photos:** In Photo Mode, press the shutter button (often marked with a camera icon) to take a 52MP image.

6. **Recording Videos:** In Video Mode, press the record button (often marked with a red dot or video camera icon) to start recording 4K UHD video. Press again to stop recording.
7. **Playback:** In Playback Mode, use the navigation buttons to browse through your captured photos and videos. Press the OK/Play button to view or play selected media.
8. **Screen Brightness:** Adjust the screen brightness through the settings menu to suit your viewing preference and environment.



Image: Overview of the device's control buttons for photo, video, and playback functions.

Built-in Rechargeable Lithium

No Bulky AA batteries, convenient and powerful!

5200mAh



Image: Demonstrates the device's capability for long-distance viewing in both complete darkness and daytime.

Care and Maintenance

- **Cleaning Lenses:** Use a soft, lint-free cloth specifically designed for optical lenses to gently wipe the objective and eyepiece lenses. Avoid using abrasive materials or harsh chemicals.
- **Cleaning Body:** Wipe the body of the device with a soft, damp cloth. Do not submerge the device in water.
- **Storage:** When not in use, store the goggles in their carrying case in a cool, dry place away from direct sunlight and extreme temperatures.
- **Battery Care:** To prolong battery life, avoid fully discharging the battery frequently. Charge the device regularly, even if not in use for extended periods.

Troubleshooting

Problem	Possible Cause	Solution
Image lacks clarity or is blurry	Incorrect focus; insufficient IR illumination; dirty lens.	Adjust the focus wheel; increase IR level (1-5); clean the objective lens.
Device does not power on	Battery is depleted; power button not held long enough.	Charge the device fully; press and hold the power button for 3-5 seconds.
Cannot record video or take photos	Memory card full or not inserted correctly; incorrect mode selected.	Check memory card insertion and ensure it has free space; format the memory card if necessary; switch to Photo or Video mode.
Night vision and zoom buttons conflict	Shared button functionality.	Be precise with button presses. If night vision activates when trying to zoom, turn it off and re-adjust zoom. The device may default to night vision in dark conditions.
Short battery life	High IR level usage; frequent recording; cold environment.	Reduce IR level if possible; limit continuous recording; ensure full charge before use.

Technical Specifications

Feature	Specification
Product Dimensions	5.28 x 4.88 x 2.28 inches
Item Weight	15.3 ounces
Model Number	B06-US-1
Batteries	1 Lithium Ion battery (included), 5200mAh
Objective Lens Diameter	35 Millimeters
Magnification Maximum	8 x (Digital Zoom)
IR Illuminator	3W 850nm, 5-level adjustable
Image Resolution	Up to 52MP
Video Resolution	Up to 4K Ultra HD
Display Screen	3-inch HD LCD
Memory Card Support	32GB TF card included, supports up to 128GB
Connectivity	USB-C
Country of Origin	China

Warranty and Customer Support





DOOCK offers a **1-year manufacturer service** for this product. For any product quality issues encountered within one year of purchase, we provide a replacement service rather than repairs. Please contact our official after-sales support for assistance.

Software Updates: We regularly update the product's software to enhance the user experience. To obtain the latest software updates, please contact our after-sales support team.

Contact Support: For all inquiries regarding warranty, replacements, software updates, or general support, please reach out to our official after-sales team at support@doock.life.

© 2025 DOOCK. All rights reserved.

Related Documents - B06-US-1

<div>User Manual</div> <div></div>	<div>BlazeVideo MNBVND-1 Night Vision Binoculars User Manual</div> <div>Comprehensive user manual for the BlazeVideo MNBVND-1 night vision binoculars, covering product overview, specifications, operation, settings, and maintenance.</div>
<div>Benutzerhandbuch</div> <div></div>	<div>BlazeVideo Night Vision Binoculars User Manual</div> <div>User manual for BlazeVideo night vision binoculars, covering product overview, specifications, basic operation, photo and video recording, night vision function, playback, and PC connectivity.</div>
<div></div>	<div>Reolink CX820 Operational Instructions</div> <div>Comprehensive operational instructions for the Reolink CX820 security camera, covering setup, installation, troubleshooting, specifications, and safety guidelines.</div>
<div></div>	<div>Kingstar KW-B06 Smartwatch: User Manual, Features, and Specifications</div> <div>Comprehensive user manual for the Kingstar KW-B06 Smartwatch, detailing its features, functions, specifications, charging, troubleshooting, and FCC compliance.</div>

Caddx Gazer
Quick Start Guide

V1.0

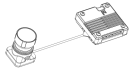

■ Product Introduction

- The main features of the Caddx Gazer ultra-low light night vision camera are as follows:
 - Ultra-low light night vision: The camera can see clearly in the dark without the need for an external light source.
 - AI image enhancement: The camera uses AI technology to enhance the image quality, making it clearer and more detailed.
 - Detachable filter: The camera has a detachable filter that can be removed to allow for normal vision or to use the night vision function.
 - 3x zoom: The camera has a 3x zoom function that allows you to zoom in on the image to see more details.
 - Wide-angle view: The camera has a wide-angle view that allows you to see a larger area.

■ Installation Direction

- 1. Connect the camera to the power source and the computer.
- 2. Turn on the camera and the computer.



■ Control Mode

- 1. Press the power button to turn on the camera.
- 2. Press the zoom button to zoom in on the image.
- 3. Press the filter button to toggle between normal vision and night vision.
- 4. Press the AI button to toggle between AI image enhancement and standard image.
- 5. Press the wide-angle button to toggle between wide-angle view and standard view.

■ Connection

- 1. Connect the camera to the power source.
- 2. Connect the camera to the computer.
- 3. Connect the camera to the monitor.



■ Debugging Procedure

- 1. Check the power source and the computer connection.
- 2. Check the camera connection.
- 3. Check the monitor connection.
- 4. Check the camera settings.
- 5. Check the monitor settings.



1. Check the power source and the computer connection.

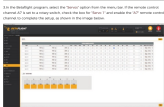

■ Specifications

Model	Caddx Gazer
Resolution	1080P
Frame rate	30FPS
Zoom	3x
Filter	Detachable
AI	AI Image Enhancement
Wide-angle	Wide-angle View
Power	5V/1A
Size	40mm x 40mm x 40mm
Weight	10g
Material	ABS
Color	Black
Package	1 x Camera, 1 x Power Source, 1 x Computer, 1 x Monitor, 1 x Cable
Warranty	1 Year

[Caddx Gazer Quick Start Guide - Full-Color Night Vision Analog Camera](#)

Quick start guide for the Caddx Gazer analog camera, featuring ultra-low light full-color night vision, detachable filter, AI image enhancement, and adjustable 3x zoom. Includes installation, control mode, connection, debugging, and specifications.



Comprehensive user manual for the Triton StarStrike Night Vision Optics, covering NV100 and NV101 models. Includes specifications, setup instructions, operation details, and digital magnification.