

Manuals.plus /

› Dasbecan /

› Dasbecan 56327 4-Way Trailer Hitch Wiring Harness Kit for Ford Transit-150, Transit-250, Transit-350, E-Transit (2015-2024) - Instruction Manual

## Dasbecan 56327

# Dasbecan 56327 4-Way Trailer Hitch Wiring Harness Kit

## INSTRUCTION MANUAL

### Introduction

This manual provides detailed instructions for the installation, operation, and maintenance of your Dasbecan 56327 4-Way Trailer Hitch Wiring Harness Kit. Please read this manual thoroughly before installation and use to ensure proper function and safety. This kit is designed for specific Ford Transit and E-Transit models to provide a standard 4-way flat connector for trailer lighting.

### Product Overview

The Dasbecan 56327 wiring harness is a plug-and-play solution that adapts your vehicle's taillight system to provide a standard 4-way flat trailer connector. It includes a taillight converter to manage separate brake and turn signals, ensuring proper trailer light synchronization.

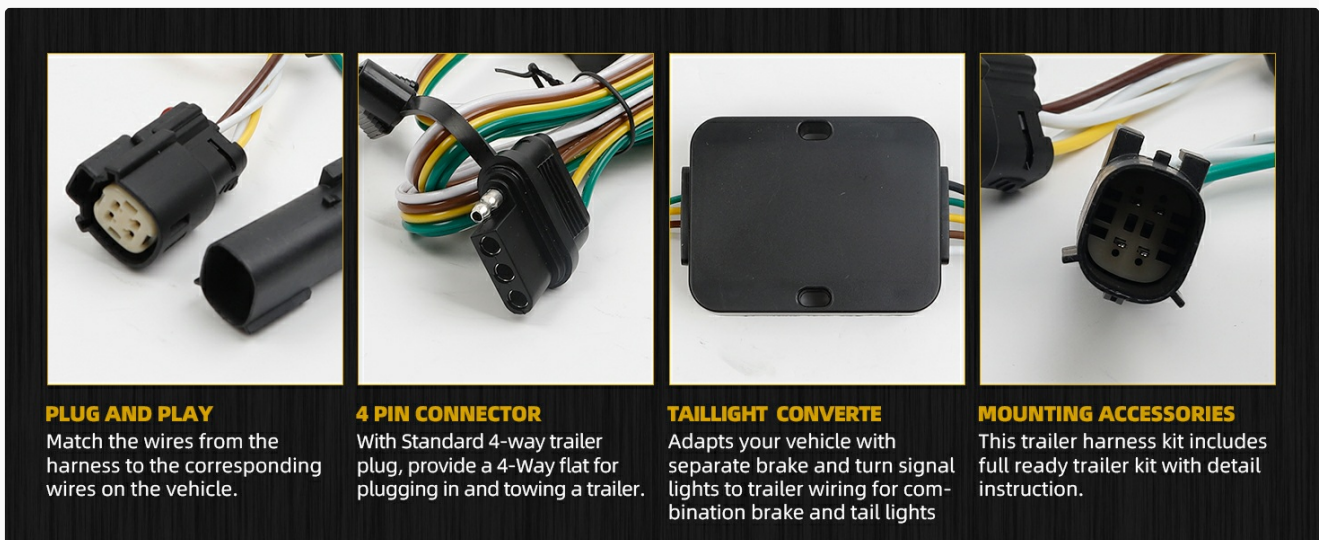

Image: Overview of the Dasbecan 56327 Trailer Hitch Wiring Harness Kit components.

### What's in the Box

- 1x Trailer Wiring Harness

## Key Features

- **Manufacturer Part Number:** 56327
- **4 Pin Connector:** Provides a standard 4-way flat for trailer plugging and towing.
- **Easy to Install:** Simple plug-and-play design eliminates the need for cutting or splicing.
- **Dust Cover:** Included to keep the connector clean when not in use, extending service life.
- **Taillight Converter:** Adapts vehicle's separate brake and turn signals to combination brake and tail lights for the trailer.

## Compatibility

This wiring harness kit is compatible with the following Ford Transit and E-Transit models:

- 2015-2024 Ford Transit-150
- 2015-2024 Ford Transit-250
- 2015-2024 Ford Transit-350 (Single rear wheels)
- 2022-2024 Ford E-Transit (Excluding dual rear wheels)



Image: Ford Transit van, indicating compatible vehicle models.

## Safety Information

- Always disconnect the vehicle's battery before beginning any electrical installation.
- Ensure all connections are secure and properly insulated to prevent short circuits.
- Route wiring away from hot exhaust components, moving parts, and sharp edges.
- Test all trailer lights thoroughly before towing.

## Setup and Installation

The Dasbecan 56327 wiring harness is designed for a direct plug-and-play installation into your vehicle's existing taillight wiring system. No cutting or splicing of wires is typically required.

### Installation Steps:

1. **Locate Vehicle Taillight Wiring:** Access the taillight wiring on your Ford Transit or E-Transit. This usually

involves removing taillight assemblies or accessing wiring behind interior panels.

2. **Disconnect Existing Connectors:** Unplug the factory wiring harness connectors from the vehicle's taillight assemblies.
3. **Connect Harness:** Plug the vehicle-specific connectors of the Dasbecan wiring harness inline with the factory wiring. Ensure a secure connection.
4. **Mount Taillight Converter:** Securely mount the taillight converter module in a dry, protected location using the provided hardware or zip ties.
5. **Route 4-Way Flat Connector:** Route the 4-way flat connector to the rear of the vehicle, near the hitch receiver. Ensure it is secured and protected from road debris and heat.
6. **Connect Power Wire (if applicable):** If your kit includes a separate power wire, connect it directly to the vehicle's battery following the provided instructions, ensuring an inline fuse is installed.
7. **Test Connections:** Reconnect the vehicle's battery and test all trailer light functions (running lights, brake lights, left turn, right turn) with a test light or by connecting a trailer.

Image: Direct plug-in installation into existing wiring and a vehicle towing a trailer.

Your browser does not support the video tag.

Video: Installation guide for the 2015-2024 Ford Transit 150 250 350 Trailer Wiring Harness. This video demonstrates the installation process for compatible Ford Transit models.

## Operating Instructions

Once installed, the 4-way flat connector provides the necessary electrical signals for standard trailer lighting functions. Connect your trailer's 4-way plug to the vehicle's 4-way flat connector.

### 4-Pin Trailer Connector Functions:

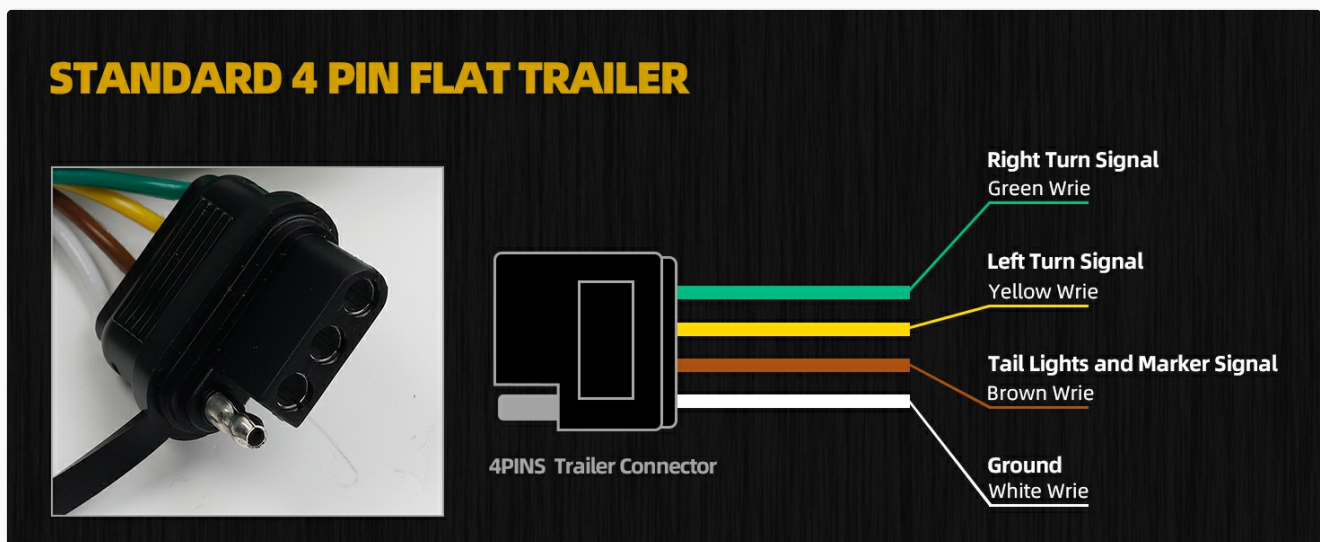

Image: Standard 4-pin flat trailer connector wiring diagram.

- **Green Wire:** Right Turn Signal
- **Yellow Wire:** Left Turn Signal
- **Brown Wire:** Tail Lights and Marker Signal
- **White Wire:** Ground

Ensure the trailer's wiring matches these functions for correct operation.

## Maintenance

- **Keep Connector Clean:** Use the provided dust cover to protect the 4-way flat connector from dirt, moisture, and corrosion when not in use.
- **Inspect Connections:** Periodically check all wiring connections for tightness and signs of wear or damage.
- **Corrosion Prevention:** Apply dielectric grease to the electrical contacts of the 4-way connector to prevent corrosion, especially in harsh weather conditions.

## Troubleshooting

Problem	Possible Cause	Solution
No trailer lights	Loose connection, blown fuse, faulty trailer wiring	Check all connections, inspect vehicle and harness fuses, test trailer wiring independently.
Incorrect light function (e.g., brake lights activate turn signals)	Improper wiring, faulty taillight converter	Verify harness connections are correct, ensure the taillight converter is functioning.
Intermittent light function	Corroded contacts, loose ground wire	Clean and apply dielectric grease to contacts, check ground wire for secure connection.

## Specifications

Attribute	Detail
Model Number	56327
Connector Type	4-pin Trailer Plug
Material	ABS Plastic
Wire Diameter	1.02 Millimeters
Item Weight	1.7 pounds
Package Dimensions	7.1 x 6.25 x 3.1 inches

## Warranty and Support

For warranty information or technical support, please refer to the manufacturer's official website or contact their customer service directly. Keep your purchase receipt for any warranty claims.