

Manuals+

[Q & A](#) | [Deep Search](#) | [Upload](#)

manuals.plus /

› [PULWTOP](#) /

› [PULWTOP 8-in-1 Vertical USB-C Hub and M.2 SSD Enclosure for Mac mini M4/M4 Pro User Manual](#)

PULWTOP 8 IN 1 Mac Mini M4 Dock

PULWTOP 8-in-1 Vertical USB-C Hub and M.2 SSD Enclosure for Mac mini M4/M4 Pro User Manual

Model: 8 IN 1 Mac Mini M4 Dock

INTRODUCTION

The PULWTOP 8-in-1 Vertical USB-C Hub and M.2 SSD Enclosure is designed to expand the connectivity and storage capabilities of your Mac mini M4 or M4 Pro. This device integrates multiple ports and an M.2 SSD slot into a compact, vertical stand, optimizing desk space and improving heat dissipation for your Mac mini.

PRODUCT FEATURES

- **8-in-1 Port Expansion:** Includes 1x USB-C 3.2 (10Gbps), 1x USB-A 3.2 (10Gbps), 2x USB-A 2.0 (480Mbps), 1x Micro/SD Card Reader (104 Mbps), and 1x 3.5mm Audio/Mic jack.
- **M.2 SSD Enclosure:** Supports M.2 PCIe NVMe SSDs (B+M Key/M Key) in sizes 2230/2242/2260/2280, with capacities up to 4TB. **Note: SSD is not included and SATA SSDs are not supported.**
- **High-Speed Data Transfer:** USB-C and USB-A 3.2 ports offer data transfer speeds up to 10Gbps.
- **Vertical Design:** Positions your Mac mini vertically for enhanced airflow and easier access to the power button.
- **Integrated Cable:** Equipped with a 40cm non-detachable TPE USB-C male cable for connection to your Mac mini.

Note: All USB-A ports do not support CD readers or Apple SuperDrive. USB-C/A ports do not support video output or device charging.

PACKAGE CONTENTS

- PULWTOP 8-in-1 Vertical USB-C Hub and M.2 SSD Enclosure
- Screwdriver for SSD installation
- Screws for SSD enclosure
- Heat dissipation silicone pad

SETUP INSTRUCTIONS

1. Connecting the Dock to Mac mini

1. Place your Mac mini M4/M4 Pro vertically into the designated slot on the PULWTOP dock. Ensure it is seated securely.
2. Connect the integrated USB-C cable from the dock to a Thunderbolt/USB-C port on your Mac mini.

2. M.2 SSD Installation

This dock supports M.2 PCIe NVMe SSDs (B+M Key/M Key) up to 4TB. SATA SSDs are not compatible.

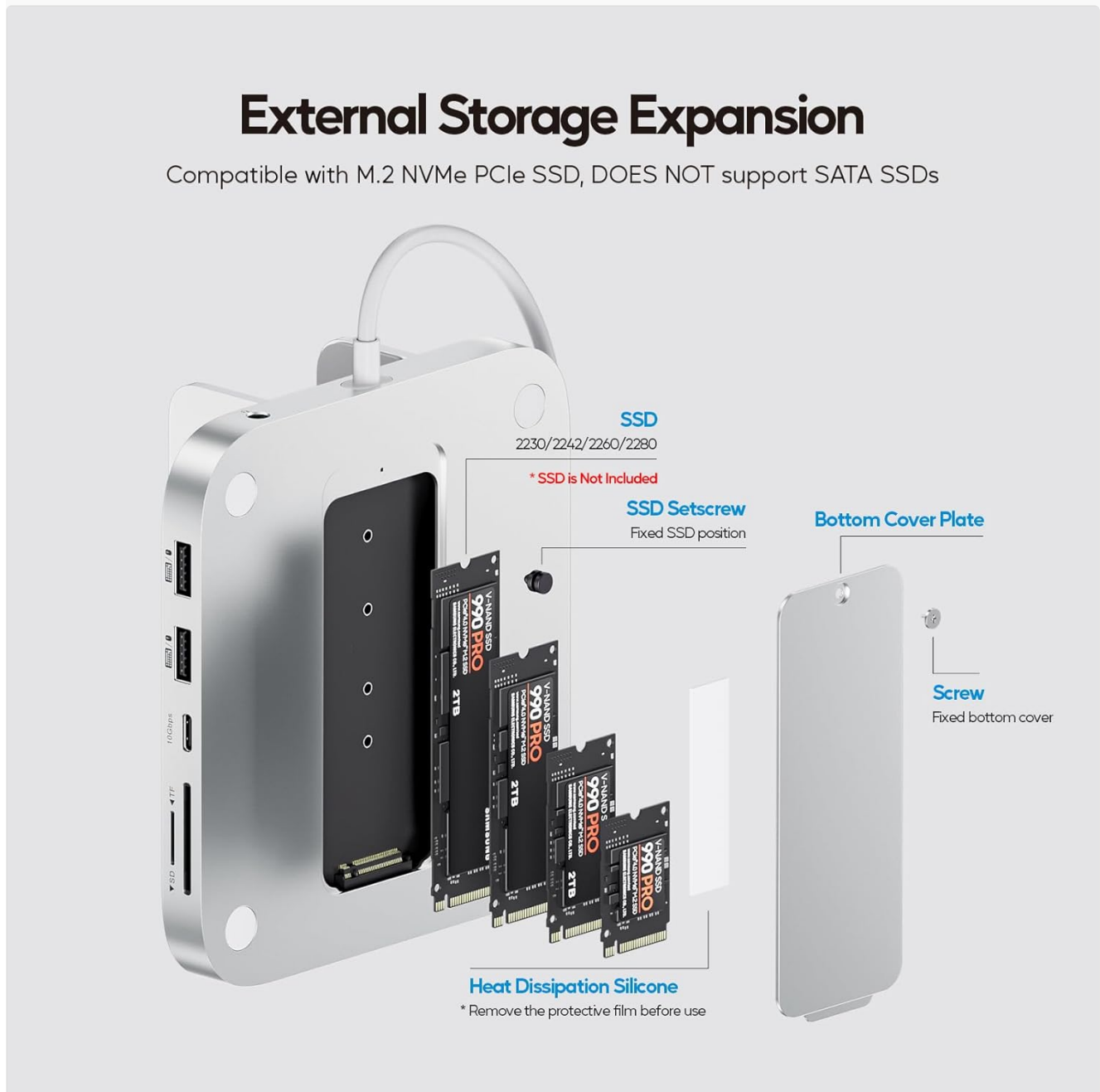

Image: Exploded view of the SSD enclosure components, including the M.2 NVMe SSD, setscrew, bottom cover plate, and securing screw. This illustrates how the SSD fits into the enclosure.

1. Remove the bottom cover plate of the SSD enclosure using the provided screwdriver.
2. Insert the connector end of your M.2 NVMe SSD completely into the SSD card slot.
3. Install the fixed buckle to the end of the SSD and insert it into the right fixed hole to secure the SSD.
4. Tear off the protective film from the heat dissipation silicone pad and stick it onto the SSD.

5. Replace the bottom cover plate and tighten the screw to secure it.

Important: After installing a new SSD, it must be formatted to work with your Mac mini. Please format your new SSD to "exFat" or "APFS" format for proper functionality.

OPERATING INSTRUCTIONS

1. Using the Ports

USB C Dock Stand for Mac Mini M4/M4 Pro

with M.2 NVME SSD Enclosure (2230/2242/2260/2280)

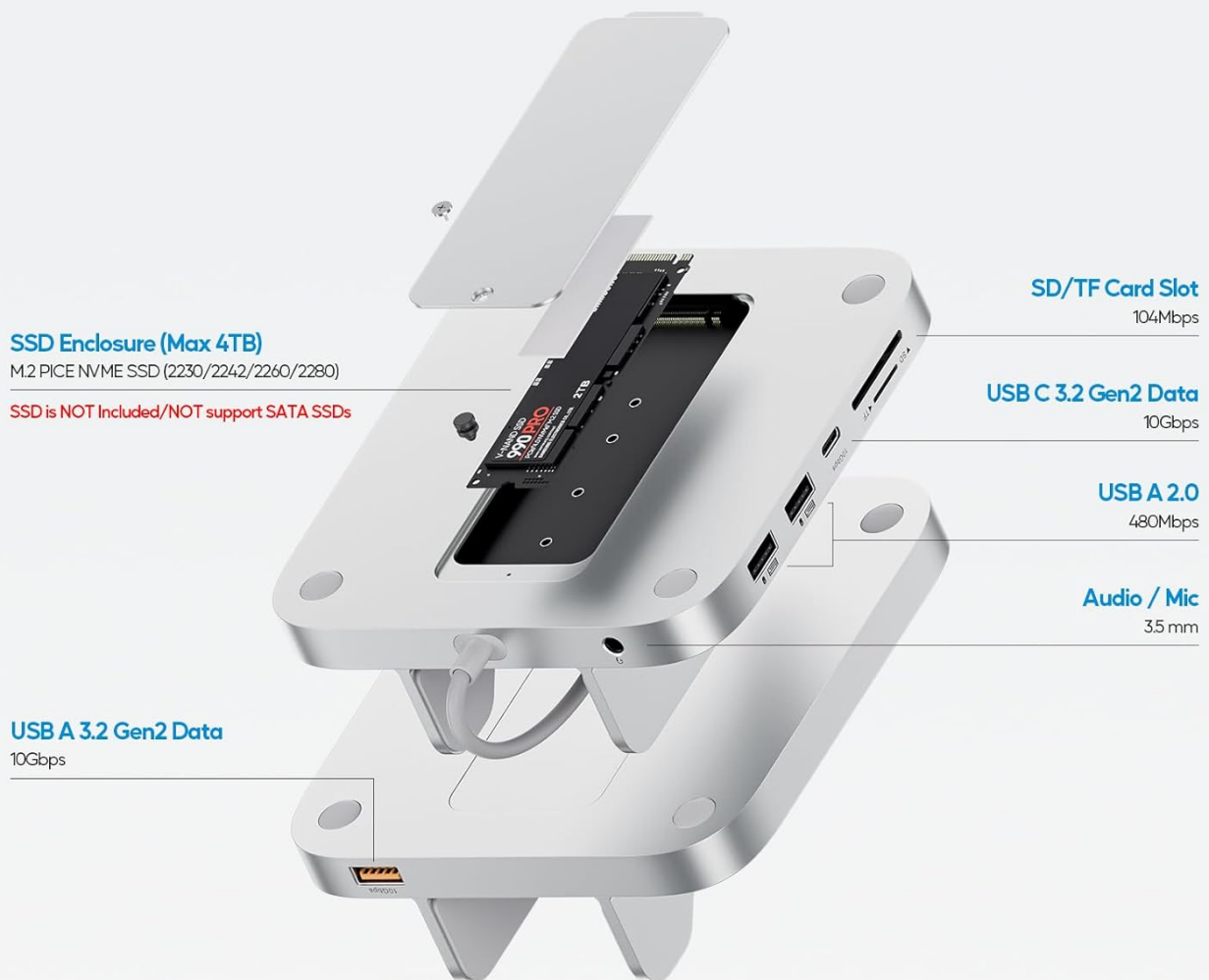

Image: An overhead diagram of the dock with labels pointing to each port and its function, including the SSD enclosure, card slots, USB-C, USB-A, and audio jack.

- **USB-C 3.2 (10Gbps) & USB-A 3.2 (10Gbps):** Connect high-speed peripherals such as external hard drives, SSDs, or other data-intensive devices for rapid file transfers.
- **USB-A 2.0 (480Mbps):** Ideal for connecting standard peripherals like keyboards, mice, printers, or USB flash drives.
- **Micro/SD Card Readers (104 Mbps):** Insert SD or MicroSD cards for quick access to photos and videos. Ensure the SD card is inserted with the label side down and the MicroSD card with the label side up.

- **3.5mm Audio/Mic Jack:** Connect headphones, speakers, or a microphone for audio input/output.

Quickly Connect Your External Devices

2 x USB-A and 1 x Audio/Mic jack for quick connection of external devices
making your work or entertainment easier than ever



Image: A Mac mini positioned in the vertical dock, with headphones and a computer mouse connected to the front-facing USB-A and audio ports, demonstrating quick access for external devices.

2. Data Transfer

Ultra-Fast 10Gbps Data Transfer

 **SSD Enclosure**
M.2 PCIE NVME SSD

 **SD/TF**
104Mbps

 **USB C 3.2**
10Gbps

 **USB A 3.2**
10Gbps

Micro SD Card / TF Card

Label side Up

SD Card

Label side Down

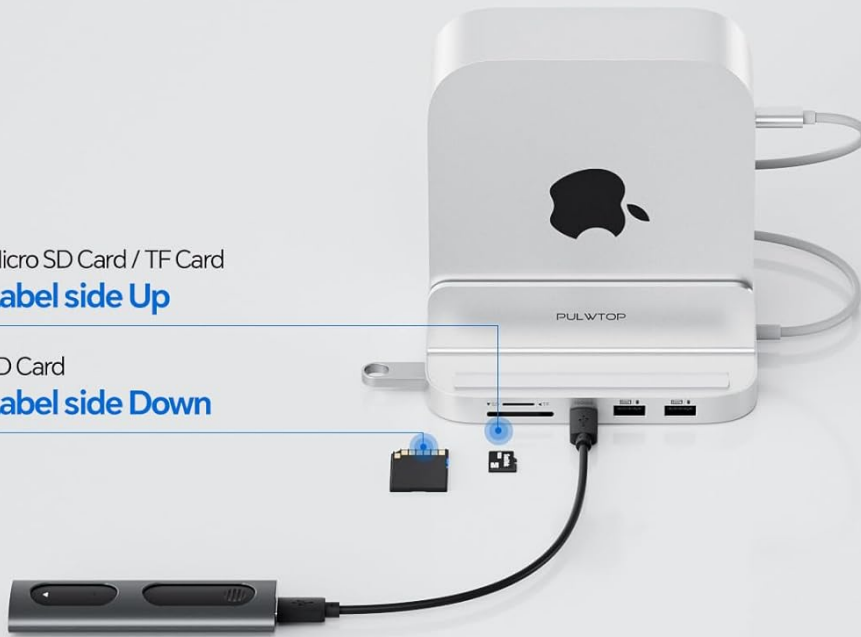

USB 3.2 Gen2
10Gbps



20x than

USB 2.0
480Mbps



Image: A visual comparison of data transfer speeds, highlighting the significant speed advantage of USB 3.2 Gen2 (10Gbps) over USB 2.0 (480Mbps).

The USB-C 3.2 and USB-A 3.2 ports support data transfer speeds of up to 10Gbps, enabling fast transfer of large files. The SD/TF card slots support up to 104 Mbps. USB-A 2.0 ports provide 480Mbps for standard device connections.

3. Heat Dissipation

Prevent Overheating

Perfect for good heat dissipation and easily turning on/off the power button



Image: A visual representation of the dock's design promoting airflow around the Mac mini, indicated by blue light rays, to prevent overheating.

The vertical design of the dock allows for improved airflow around your Mac mini, contributing to better heat dissipation and maintaining optimal operating temperatures.

MAINTENANCE

- Keep the dock clean by wiping it with a soft, dry cloth.
- Avoid exposing the device to liquids or extreme temperatures.
- Ensure proper ventilation around the dock and Mac mini to maintain effective heat dissipation.

TROUBLESHOOTING

- **SSD Not Recognized:** Ensure the SSD is correctly installed and secured. For new SSDs, verify it has been formatted to "exFat" or "APFS" on your Mac mini. Confirm the SSD is an NVMe (B+M Key/M Key) type, as SATA SSDs are not supported.
- **Peripherals Not Working:** Check that the USB cable connecting the dock to the Mac mini is securely

attached. Try connecting the peripheral directly to the Mac mini to rule out device issues.

- **Slow Data Transfer:** Ensure you are using the 10Gbps USB-C or USB-A 3.2 ports for high-speed devices. Older USB 2.0 devices will operate at their maximum speed of 480Mbps.
- **Wi-Fi/Bluetooth Interference:** The vertical design is intended to reduce negative effects on wireless reception. If issues occur, ensure no other devices are causing interference and that the Mac mini is properly seated.
- **USB Ports Not Supporting Video/Charging:** This dock's USB-C and USB-A ports are for data transfer only and do not support video output or device charging.

SPECIFICATIONS

Feature	Detail
Brand	PULWTOP
Model Number	8 IN 1 Mac Mini M4 Dock
Product Dimensions	3.6 x 2.3 x 5.31 inches (9.14 x 5.84 x 13.49 cm)
Item Weight	9.3 ounces (265 Grams)
Number of Ports	8 (4 USB ports, 2 card slots, 1 audio, 1 SSD enclosure)
Total USB Ports	4
Hardware Interface	MicroSD, USB, USB 3.0 (USB-C 3.2, USB-A 3.2, USB-A 2.0)
Compatible Devices	Mac Mini M4/ M4 Pro 2024
SSD Compatibility	M.2 PCIe NVMe (B+M Key/M Key) 2230/2242/2260/2280 up to 4TB (SSD NOT Included, SATA SSDs NOT supported)

WARRANTY AND SUPPORT

PULWTOP products typically come with a standard manufacturer's warranty. For specific warranty details, technical support, or customer service inquiries, please refer to the official PULWTOP website or contact their customer support directly. Keep your purchase receipt for warranty claims.