

## Manuals+

[Q & A](#) | [Deep Search](#) | [Upload](#)

manuals.plus /

- › [Warmiehomymy](#) /
- › [Warmiehomymy 24x24x24 Inch Printer Stand with Storage Instruction Manual](#)

## Warmiehomymy PS015

# Warmiehomymy 24x24x24 Inch Printer Stand with Storage Instruction Manual

Model: PS015

## INTRODUCTION

---

Thank you for choosing the Warmiehomymy 24x24x24 Inch Printer Stand. This versatile 2-tier rolling cart is designed to provide efficient storage and mobility for your office or home. Please read this manual carefully before assembly and use to ensure proper setup and longevity of your product.



*Image: The Warmiehomey 24x24x24 Inch Printer Stand in Rustic Brown, showcasing its two tiers and overall design.*

## COMPONENTS CHECKLIST

Before beginning assembly, please ensure all parts are present and undamaged. Refer to the detailed installation instructions paper included in the package for specific part identification.

The main components include:

- Top and bottom wooden panels
- Metal frame components (legs, crossbars)
- Rolling casters (wheels) with locks
- Fixed foot pads
- Assembly hardware (screws, wrench, Allen key)



*Image: An overhead view of all components for the 2-tier printer stand laid out on a wooden floor, including metal frames, wooden panels, wheels, and tools.*

## SETUP AND ASSEMBLY

---

Assembly of the WarmieHomy printer stand is designed to be straightforward. Follow these general steps, referring to the included paper instructions for detailed diagrams and part numbers.

1. **Unpack Components:** Carefully remove all parts from the packaging. Check against the components checklist to ensure everything is present.
2. **Assemble the Metal Frame:** Connect the metal frame components using the provided screws and tools. Ensure all connections are secure but do not overtighten until the entire frame is assembled. The "X" design crossbars provide structural stability.
3. **Attach Wooden Panels:** Secure the wooden panels to the assembled metal frame. The top panel forms the main countertop, and the lower panel creates the storage shelf.
4. **Install Feet or Casters:** Decide whether you prefer a stationary stand or a mobile cart.
  - **For Mobility:** Attach the four rolling casters to the bottom of the stand. Two of the four casters are lockable to prevent unwanted movement.
  - **For Stability:** Attach the four fixed foot pads to the bottom of the stand. These can be adjusted to level the stand on uneven surfaces.
5. **Final Tightening:** Once all components are in place, carefully tighten all screws to ensure the stand is stable and secure.

## Assembly Video Guide

---

Your browser does not support the video tag.

*Video: A step-by-step guide demonstrating the assembly process of the WarmieHomy 2-Tier Printer Table.*

## OPERATING AND USAGE

---

The WarmieHomy printer stand is designed for versatile use in various environments, including home offices, living rooms, and bedrooms.

### Key Features:

---

- **Oversized Countertop:** The 23.62"L x 23.62"W top surface is suitable for large printers, scanners, or fax machines.
- **Two-Tier Storage:** The lower shelf provides ample space for office supplies such as paper, folders, books, and documents.
- **Mobility and Stability:**
  - When using the rolling casters, the stand can be easily moved. Two of the four wheels are lockable to secure the cart in place.
  - When using fixed foot pads, the stand offers enhanced stability and can be adjusted to compensate for uneven floors.
- **Multi-Functional Design:** Beyond a printer stand, it can serve as a side table, nightstand, or mini-fridge stand.

## Usage Scenarios:

---



*Image: The printer stand in an office, holding a large printer on the top tier and paper on the bottom shelf, demonstrating its primary function.*



*Image: The stand used as a mini-fridge stand in a kitchen, with snacks stored on the lower shelf, highlighting its versatility.*



Image: The stand functioning as a nightstand in a bedroom, holding a lamp, books, and other personal items.

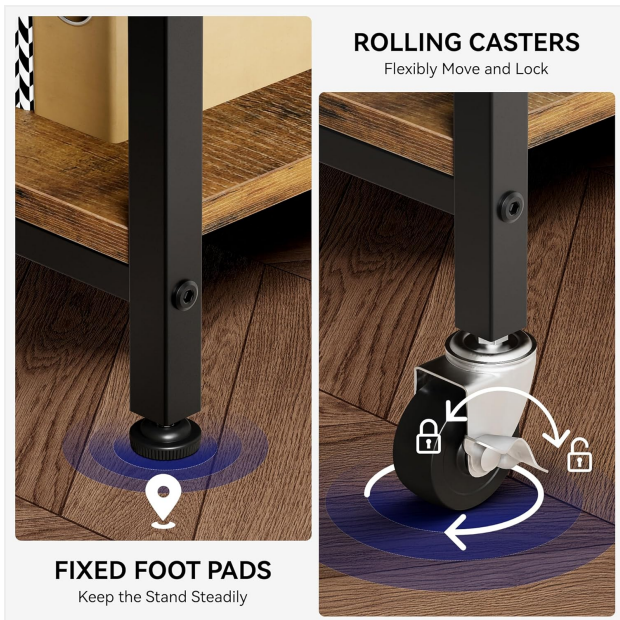

Image: A close-up view illustrating the option between fixed foot pads for stability and rolling casters for mobility, with lockable wheels shown.

## Product in Use Videos

Your browser does not support the video tag.

Video: A demonstration of the printer stand's stability and mobility with its wheels, showcasing its use in an office setting.

Your browser does not support the video tag.

Video: A brief overview highlighting the large storage capacity of the printer stand.

Your browser does not support the video tag.

Video: A visual display of the Warmiehomy 2-Tier Printer Table in various settings, demonstrating its functional design.

## MAINTENANCE AND CARE

To ensure the longevity and appearance of your Warmiehomy printer stand, follow these simple maintenance guidelines:

- **Cleaning:** The wooden panels are waterproof and easy to clean. Use a soft, damp cloth to wipe down surfaces. Avoid harsh chemicals or abrasive cleaners that could damage the finish.
- **Spills:** Wipe up spills immediately to prevent water damage or staining.
- **Weight Capacity:** Do not exceed the maximum weight capacity of 100 pounds per shelf to prevent damage or structural failure.
- **Inspection:** Periodically check all screws and connections to ensure they remain tight. Retighten if necessary.
- **Movement:** When moving the stand, especially over uneven surfaces, lift slightly to reduce stress on the casters. Ensure casters are unlocked before moving.

## High Quality Metal Material



Sturdy "X" design



Waterproof



Scratch Resistant



Not Easy to Deform



Image: A detailed view highlighting the quality features of the stand, including its waterproof and scratch-resistant wooden panels, and the sturdy "X" design metal frame.

## TROUBLESHOOTING

If you encounter any issues with your Warmiehome printer stand, refer to the following common solutions:

- **Wobbling Stand:**

- Ensure all screws are securely tightened.
- If using fixed foot pads, adjust them individually to level the stand on uneven floors.

- **Difficulty Rolling:**

- Check that all caster locks are disengaged.
- Ensure the casters are clean and free of debris.

- **Missing Parts:** If any parts are missing upon arrival, please contact customer support immediately with your purchase details.

## SPECIFICATIONS

Feature	Detail
Product Dimensions	23.62 x 23.61 x 23.62 inches
Item Weight	22 pounds
Model Number	PS015
Brand	Warmiehome
Color	Rustic Brown
Form Factor	Rectangle
Compatible Devices	Printers, Mini Fridge
Mounting Type	Floor Stand
Weight Capacity	Up to 100 pounds per shelf
Material	CARB P2 class manufactured wood, Steel frames

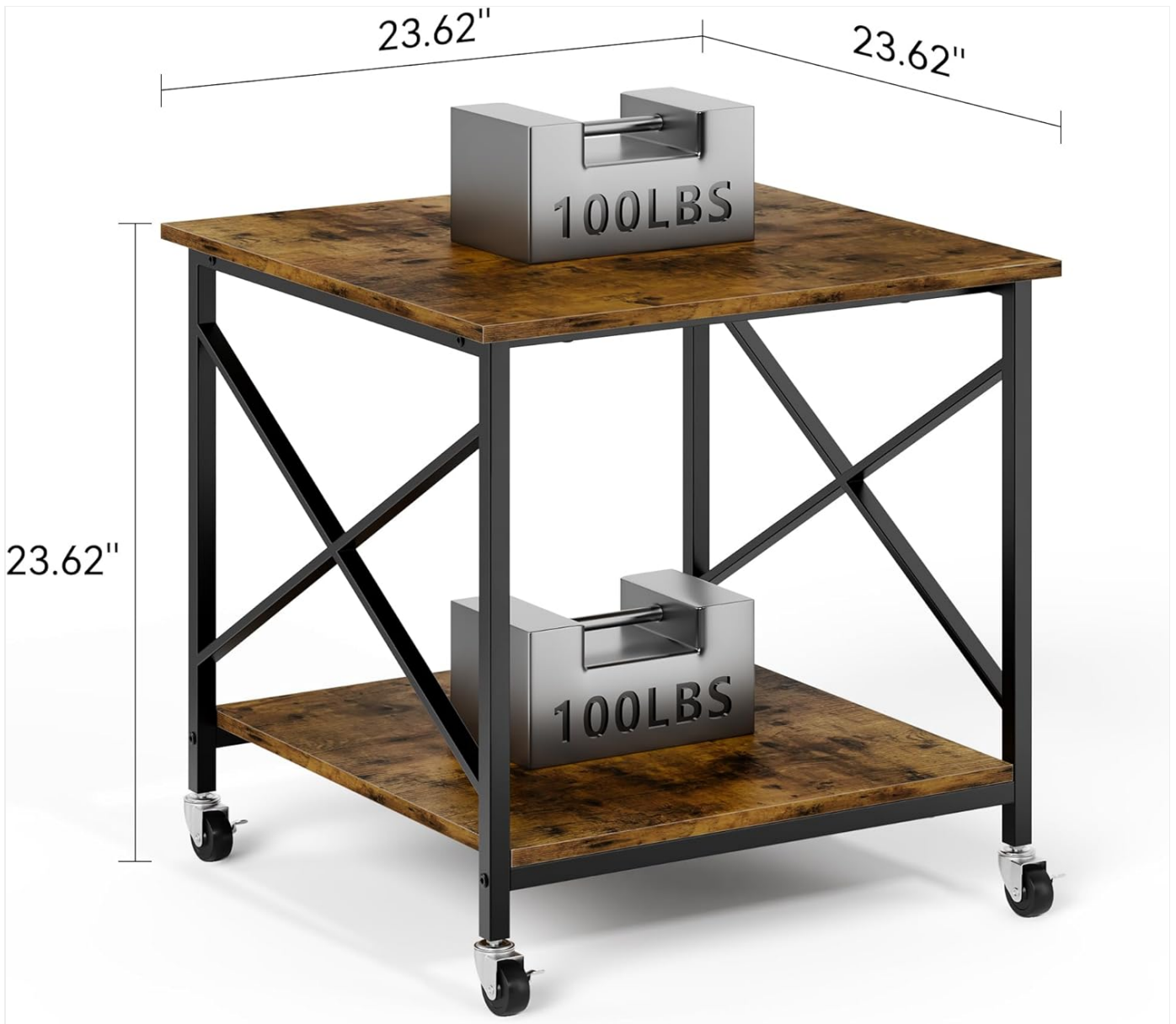

*Image: A diagram illustrating the dimensions (23.62"L x 23.62"W x 23.62"H) and weight capacity (100 lbs per shelf) of the printer stand.*

## **CUSTOMER SUPPORT**

For any questions regarding assembly, operation, or if you encounter any issues with your Warmiehommy printer stand, please do not hesitate to contact our customer support team. We are committed to resolving your concerns within 24 hours.

Please refer to your purchase documentation or the Warmiehommy official website for contact information.

