

MechLands AK680 MAX

MechLands AJAZZ AK680 MAX Wireless Gaming Keyboard User Manual

Model: AK680 MAX

1. INTRODUCTION

This manual provides comprehensive instructions for the MechLands AJAZZ AK680 MAX Wireless Gaming Keyboard. Designed for high-performance gaming and efficient work, this keyboard features an ultra-fast 8K polling rate, rapid trigger magnetic switches, and versatile connectivity options. Please read this manual thoroughly to ensure proper setup and optimal use of your device.



Image 1.1: The MechLands AJAZZ AK680 MAX Wireless Gaming Keyboard, showcasing its 68-key layout with grey, white, and yellow keycaps.

Key Features:

- **Ultra-Fast Input Reaction:** 8K polling rate in wired & wireless modes with 0.125ms latency.
- **Magnetic Switch Precision:** Adjustable Rapid Trigger (RT) range from 0.01mm to 2.00mm with 0.01mm precision.
- **Triple Mode Connectivity:** Supports Bluetooth 5.0, 2.4GHz wireless, and USB-C wired connections.

- **Stable TOP-Mounted Structure:** Durable aluminum alloy positioning plate for enhanced stability and tactile feedback.
- **Compact 68% Layout:** 68-key design for portability and ergonomics, featuring hot-swappable PCB.
- **Customizable RGB Backlight:** South-facing RGB lighting with PBT premium keycaps.



Image 1.2: Visual representation of the keyboard's 8K polling rate and 0.125ms latency, highlighting its speed.

2. PACKAGE CONTENTS

Verify that all items are present in the package before proceeding with setup.

- MechLands AJAZZ AK680 MAX Wireless Gaming Keyboard
- USB-C Cable
- 2.4GHz Wireless Dongle
- Keycap Puller
- Switch Puller
- User Manual



Image 2.1: Contents of the AK680 MAX package, including the keyboard, USB-C cable, 2.4GHz dongle, and tools.

3. SETUP

3.1 Connectivity Modes

The AK680 MAX supports three connection modes: Wired (USB-C), 2.4GHz Wireless, and Bluetooth 5.0. A switch on the back of the keyboard allows selection between these modes.



Image 3.1: The keyboard connected to various devices (PC, laptop, tablet, smartphone) illustrating its multi-system compatibility via Bluetooth, 2.4GHz, and USB-C.

3.1.1 Wired Connection (USB-C)

1. Connect the provided USB-C cable to the keyboard's Type-C port.
2. Connect the other end of the cable to an available USB port on your computer.
3. Ensure the mode switch on the keyboard is set to "Wired" or "USB".
4. The keyboard will be automatically recognized by your system.



Image 3.2: Close-up of the keyboard's Type-C port and the switches for 2.4G, Bluetooth, and Mac/Win modes.

3.1.2 2.4GHz Wireless Connection

1. Locate the 2.4GHz wireless dongle (usually stored in a slot on the keyboard).
2. Plug the dongle into an available USB port on your computer.
3. Set the mode switch on the keyboard to "2.4G".
4. Press **Fn + R** to activate 2.4GHz pairing mode. The indicator light will flash.
5. The keyboard should connect automatically.

3.1.3 Bluetooth Connection

1. Set the mode switch on the keyboard to "BT" (Bluetooth).
2. Press and hold **Fn + Q**, **Fn + W**, or **Fn + E** for 3-5 seconds to enter pairing mode for BT1, BT2, or BT3 respectively. The corresponding indicator light will flash rapidly.
3. On your device (PC, laptop, smartphone), enable Bluetooth and search for "AJAZZ AK680 MAX".
4. Select the keyboard to pair. The indicator light will stop flashing once connected.
5. To switch between paired Bluetooth devices, press **Fn + Q/W/E**.

3.2 Charging the Keyboard

The keyboard is equipped with a 3000mAh battery. Connect the USB-C cable to the keyboard and a USB power source (computer or wall adapter) to charge. The indicator light will show charging status.

3.3 Software Installation (Windows Only)

For advanced customization, including key remapping, macro editing, stroke settings, and backlight settings, download the official software from the MechLands website. This software is compatible with Windows operating systems only.

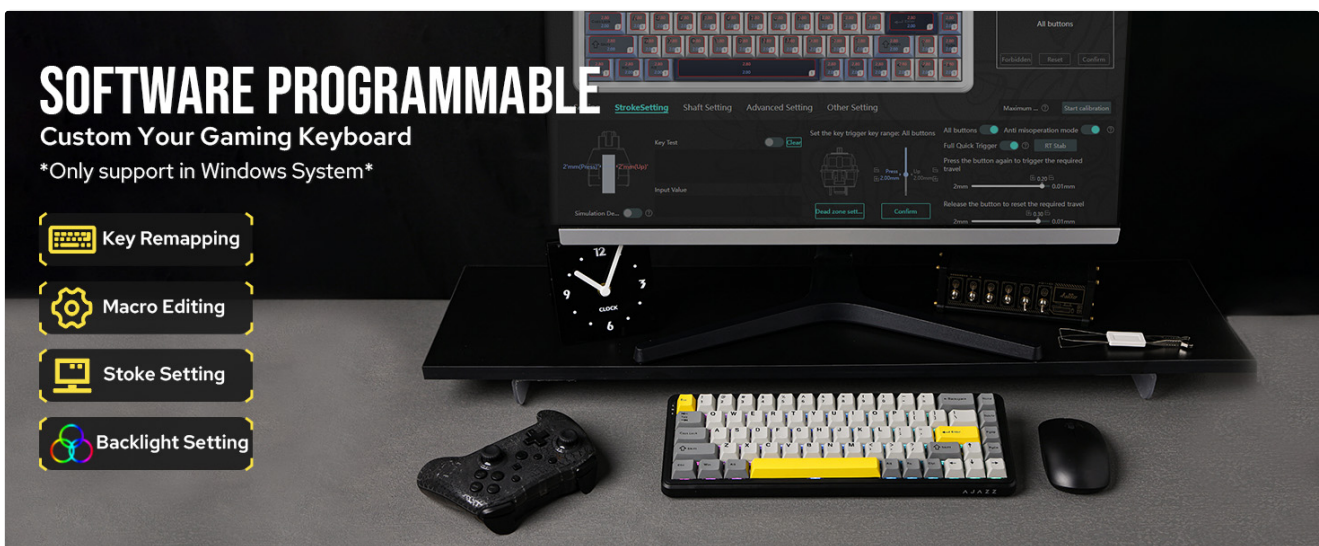

Image 3.3: Screenshot of the keyboard's software interface, showing options for key remapping, macro editing, and backlight settings.

4. OPERATING INSTRUCTIONS

4.1 Basic Key Functions

- **Fn + Left Ctrl**: Toggles the top row between number keys and F-keys (F1-F12).
- **Fn + Win**: Locks/unlocks the Windows key.
- **Mac/Win Switch**: A physical switch on the keyboard allows toggling between Windows and Mac layouts.

4.2 RGB Backlight Control

The AK680 MAX features 16.8 million customizable RGB backlights. Use the following key combinations to control the lighting effects:

- **Fn + **: Toggles through various backlight effects.
- **Fn + X**: Turns the backlight on or off.

- Further customization is available through the software.



Image 4.1: The keyboard displaying its RGB backlighting, with instructions for toggling effects and turning lights on/off.

4.3 Magnetic Switch Features (Rapid Trigger)

The magnetic switches offer advanced features for precise control, especially beneficial for gaming.

- **Dynamic Keystrokes (DKS):** Allows multiple actions on a single key press based on actuation depth.
- **Snap Key (SOCD):** Simultaneous Opposite Cardinal Direction input processing for competitive gaming.
- **Toggle Key (TGL):** Toggles an action on/off with a single key press.
- **Mod-Tap (MT):** Performs different actions based on whether a key is tapped or held.

These features are configurable via the dedicated software, allowing adjustment of actuation points from 0.01mm to 2.00mm with 0.01mm precision.

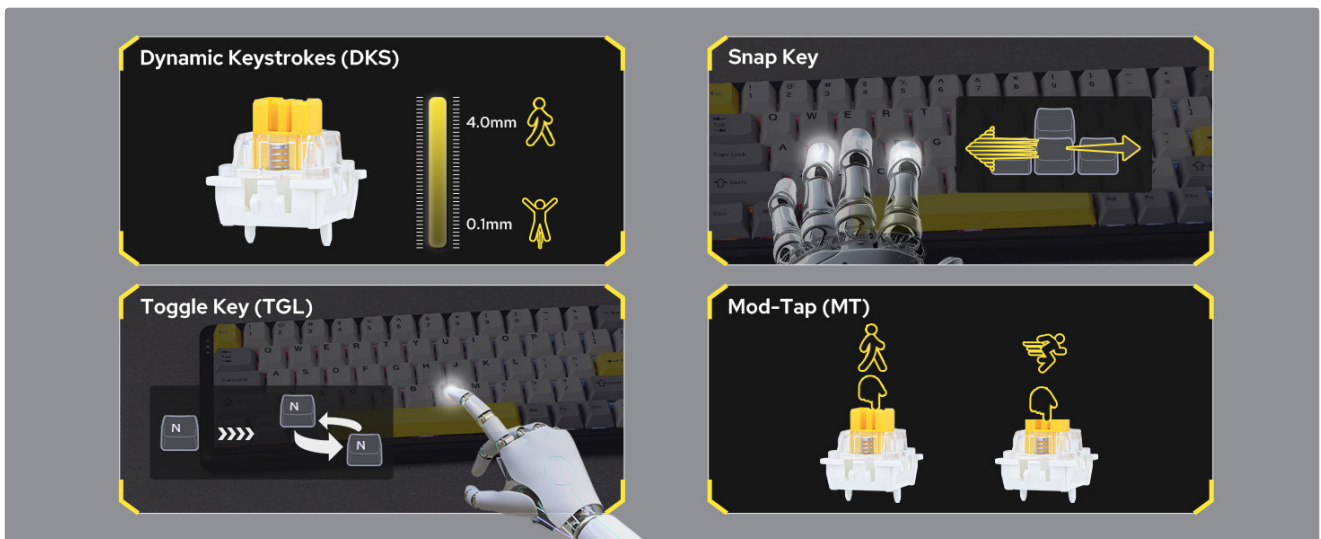

Image 4.2: Detailed explanation of DKS, Snap Key, TGL, and MT functionalities of the magnetic switches.

Your browser does not support the video tag.

Video 4.1: An official video demonstrating the features and rapid trigger capabilities of the AJAZZ AK680 MAX keyboard.

5. MAINTENANCE

5.1 Cleaning

- Disconnect the keyboard from all power sources before cleaning.
- Use a soft, lint-free cloth slightly dampened with water or a mild cleaning solution to wipe the keycaps and chassis.
- For dust and debris between keys, use compressed air or a small brush.
- Avoid harsh chemicals or abrasive materials.

5.2 Hot-Swappable Switches

The AK680 MAX features a hot-swappable PCB, allowing you to change magnetic switches without soldering. This is only compatible with magnetic switches.

1. Use the provided keycap puller to carefully remove the desired keycap.
2. Use the provided switch puller to gently grasp the switch and pull it straight up.
3. Align the pins of the new magnetic switch with the holes on the PCB and press it firmly until it clicks into place.
4. Replace the keycap.
5. After replacing switches, it is recommended to use the software to calibrate the new switches for optimal performance.



Image 5.1: Illustration of the hot-swappable PCB, magnetic switches, and south-facing LEDs, demonstrating how switches can be replaced.

6. TROUBLESHOOTING

6.1 Connectivity Issues

- **Keyboard not connecting (2.4GHz/Bluetooth):**
 - Ensure the mode switch is set correctly (2.4G or BT).
 - For 2.4GHz, ensure the dongle is securely plugged in and try re-pairing (**Fn + R**).

- For Bluetooth, ensure your device's Bluetooth is on and try re-pairing (**Fn + Q/W/E**).
- Check keyboard battery level.

- **Intermittent connection:**

- Move the keyboard closer to the receiver/device.
- Avoid interference from other wireless devices.
- Ensure the keyboard is fully charged.

6.2 Key Not Responding / Double Input

- Ensure the keyboard is properly connected.
- If using magnetic switches, recalibrate them using the software.
- Check for physical obstructions under the keycap or switch.
- Try replacing the switch if the issue persists (refer to Hot-Swappable Switches section).

6.3 Backlight Issues

- Ensure the backlight is not turned off (**Fn + X**).
- Adjust brightness or change effects (**Fn + **).
- Check backlight settings in the software.

7. SPECIFICATIONS

Feature	Detail
Model	AJAZZ AK680 MAX
Layout	68-key (68% Compact)
Connectivity	2.4GHz Wireless, Bluetooth 5.0, USB-C Wired
Polling Rate	8K (Wired & Wireless)
Latency	0.125ms
Switches	Hall Effect Magnetic Switches (Hot-swappable)
Actuation Range	0.01mm - 2.00mm (0.01mm precision)
Battery Capacity	3000mAh
Backlight	RGB (16.8M colors, South-facing LEDs)
Keycaps	PBT
Structure	TOP-Mounted with Aluminum Plate
Compatible Devices	Gaming Console, Laptop, PC, Smartphone, Tablet
Operating System Support	Windows, macOS, Android

Feature	Detail
Dimensions	324mm x 115mm x 42.55mm (approx.)
Weight	1.98 pounds (approx. 720g)



Image 7.1: Technical drawing illustrating the dimensions and weight of the AK680 MAX keyboard.

8. WARRANTY AND SUPPORT

MechLands products are designed for reliability and performance. For warranty information, technical support, or service inquiries, please refer to the official MechLands website or contact their customer service directly. Keep your purchase receipt for warranty claims.

Official MechLands Store: [Visit MechLands Store on Amazon](#)