



Manuals.plus /

› STECEi /

› STECEi HD65 Bluetooth Sport Earbuds User Manual

## STECEi HD65

# STECEi HD65 Bluetooth Sport Earbuds

## USER MANUAL

[Overview](#)   [Setup](#)   [Introduction](#)   [What's in the Box](#)   [Product](#)  
[Operation](#)   [Maintenance](#)   [Troubleshooting](#)   [Specifications](#)   [Warranty & Support](#)

## 1. Introduction

---

Thank you for choosing the STECEi HD65 Bluetooth Sport Earbuds. These wireless earbuds are designed to provide a high-quality audio experience with features tailored for active lifestyles. They offer immersive HiFi stereo sound, clear calls with ENC noise reduction, extended battery life, and a secure, waterproof design. This manual will guide you through the setup, operation, and maintenance of your new earbuds.

## 2. What's in the Box

---

Please check the package contents to ensure all items are present:

- 2 x Wireless Earbuds (Left and Right)
- 1 x Portable Charging Case
- 1 x USB-C Charging Cable
- 1 x User Manual
- 3 x Pairs of Eartips (S, M, L)

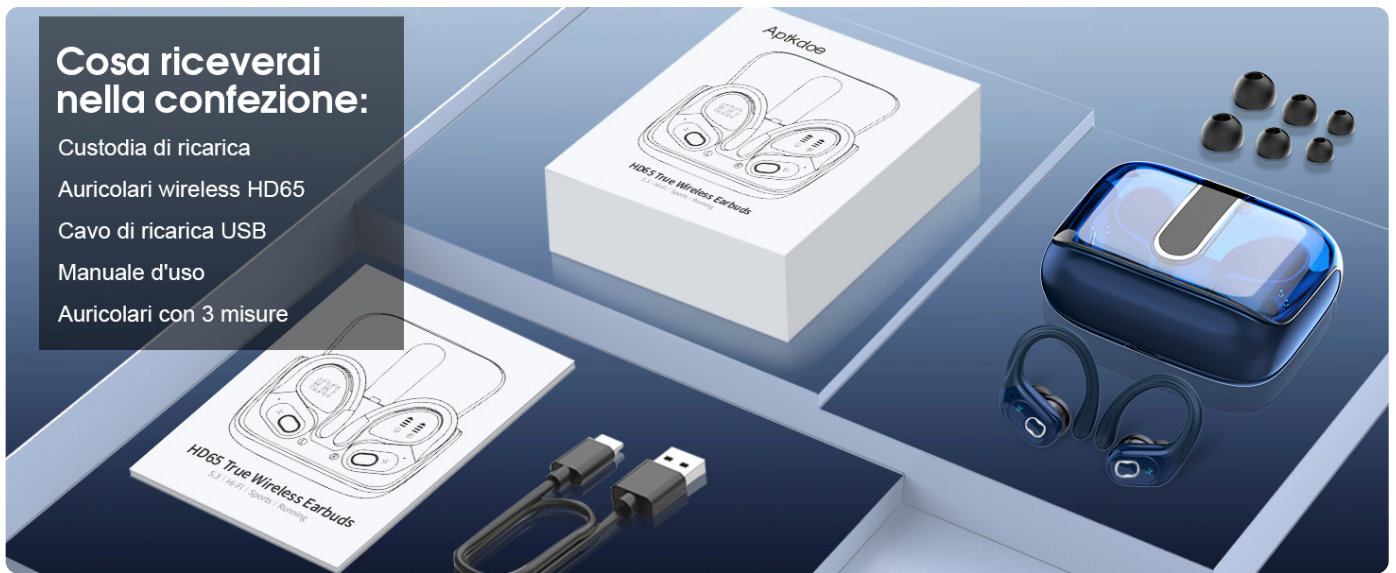

Image: Package contents including earbuds, charging case, USB-C cable, user manual, and three sizes of eartips.

### 3. Product Overview

---

#### 3.1 Earbud Design and Components

The STECEi HD65 earbuds feature an ergonomic design with flexible ear hooks for a secure and comfortable fit, ideal for sports and active use. They are IP7 waterproof, protecting against sweat and rain.

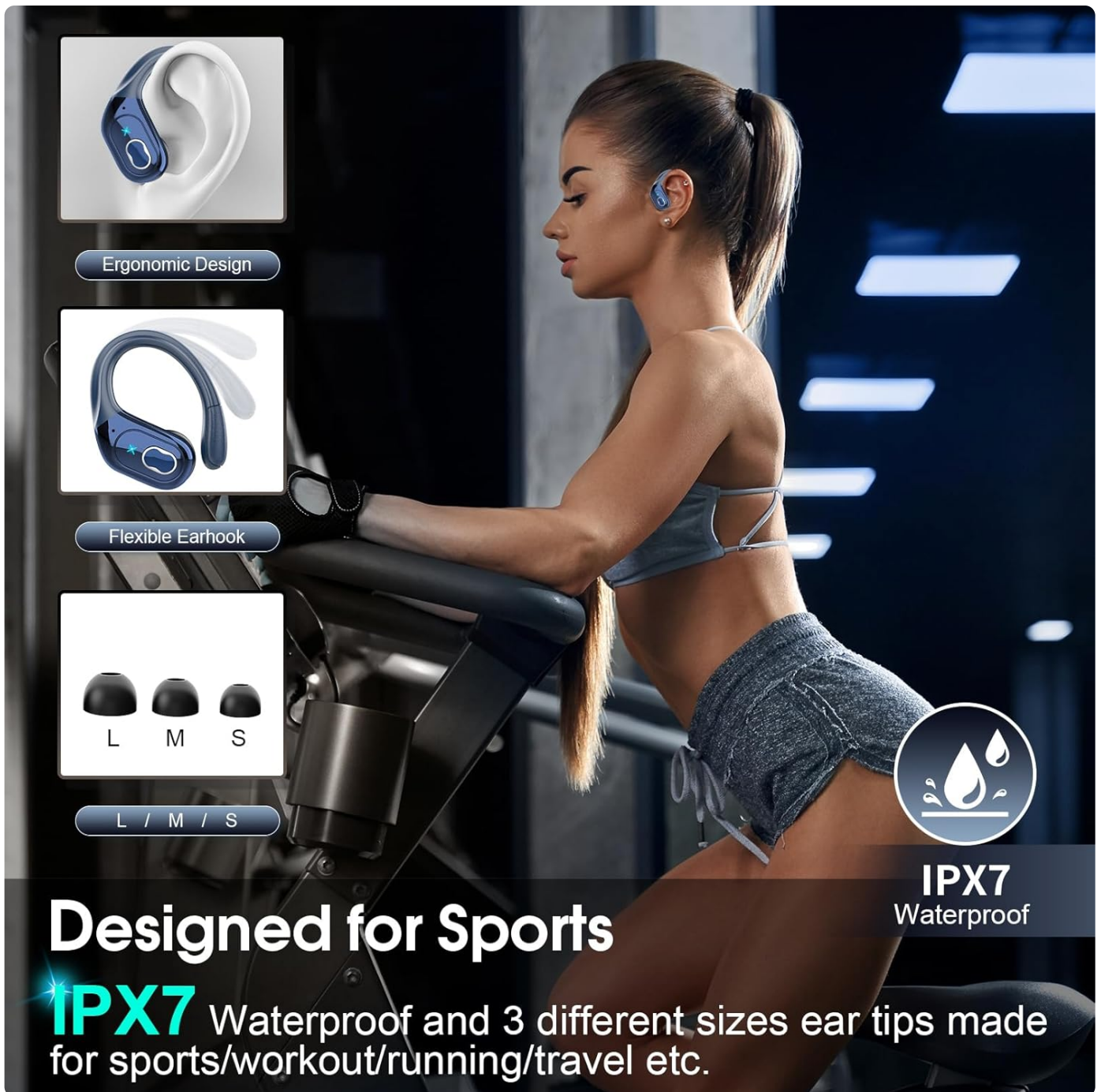

**Ergonomic Design**

**Flexible Earhook**

**L M S**

**L / M / S**

**IPX7 Waterproof**

# Designed for Sports

**IPX7** Waterproof and 3 different sizes ear tips made for sports/workout/running/travel etc.

Image: Detailed view of the ergonomic earbud design, flexible ear hook, and included eartip sizes (S, M, L), emphasizing the IPX7 waterproof feature.

### 3.2 Sound Technology

Equipped with a 14.2mm dynamic driver, these earbuds deliver clear, immersive HiFi stereo sound with rich details across all frequencies. The integrated ENC (Environmental Noise Cancellation) technology ensures clear voice calls by effectively reducing background noise.

# Hi-Fi Stereo Sound

Equipped with 14.2mm graphene diaphragm



Image: Exploded view of the 14.2mm dynamic speaker driver, illustrating its components for high-fidelity audio reproduction.

### 3.3 Charging Case with LED Display

The portable charging case features an LED digital display that shows the remaining battery percentage of the case and the individual charge status of each earbud (Left and Right).



Image: The charging case displaying the battery percentage of the case and the power capacity of the left and right earbuds.

## 4. Setup

### 4.1 Charging the Earbuds and Case

Before first use, fully charge the earbuds and the charging case. Place the earbuds into the charging case. Connect the USB-C charging cable to the case and a power source. The LED display on the case will show the charging progress.

- **Earbud Charging Time:** Approximately 1.5 hours for a single charge.
- **Playback Time (Single Charge):** Up to 15 hours.
- **Total Playback Time (with Charging Case):** Up to 75 hours.

# 75 Hours Long Battery Life

Enjoy longer music time with charging case

12



1.5hrs  
Fast Charging



15hrs  
Single Charge



60hrs  
Charging case



Image: The earbuds in their charging case, highlighting the battery life features and the USB-C charging port.

## 4.2 Bluetooth Pairing

The earbuds utilize Bluetooth 5.4 technology for a stable and fast connection.

1. Open the charging case. The earbuds will automatically enter pairing mode.
2. On your device (smartphone, tablet, etc.), go to Bluetooth settings and turn Bluetooth on.
3. Search for available devices and select "HD65" from the list.
4. Once connected, you will hear a confirmation tone, and the earbuds will be ready for use.

The earbuds will automatically reconnect to the last paired device when removed from the case, provided Bluetooth is enabled on the device.



Image: Visual representation of Bluetooth 5.4 technology and the one-step pairing process with a mobile device.

## 5. Operating Instructions

---

The STECEi HD65 earbuds feature sensitive button controls for easy management of music and calls without needing to access your phone.

# Easy Control with **Physical Buttons**

Music incoming calls can be controlled at any time



Image: Illustration of the earbud's physical button controls and their corresponding functions for music, calls, and voice assistant.

## 5.1 Music Control

- **Play/Pause:** Single tap on either L/R earbud.
- **Next Track:** Double tap on the R earbud.
- **Previous Track:** Double tap on the L earbud.
- **Volume Up:** Press and hold the R earbud for 2 seconds.
- **Volume Down:** Press and hold the L earbud for 2 seconds.

## 5.2 Call Control

- **Answer/End Call:** Single tap on either L/R earbud.
- **Reject Call:** Press and hold either L/R earbud for 2 seconds.

## 5.3 Voice Assistant

- **Activate Voice Assistant (Siri, Google Assistant, etc.):** Triple tap on either L/R earbud.

## 6. Maintenance

---

Proper maintenance ensures the longevity and optimal performance of your STECEi HD65 earbuds.

- **Cleaning:** Regularly clean the earbuds and charging case with a soft, dry, lint-free cloth. Do not use abrasive cleaners or solvents.
- **Eartips:** Remove eartips and clean them with water and mild soap if necessary. Ensure they are completely dry before reattaching.
- **Water Resistance:** The earbuds are IP7 waterproof, meaning they can withstand sweat and rain. However, they are not designed for swimming or prolonged submersion. Ensure the charging port is dry before charging.
- **Storage:** When not in use, store the earbuds in their charging case to protect them from dust and damage. Store in a cool, dry place away from extreme temperatures.

## 7. Troubleshooting

---

If you encounter any issues with your earbuds, please refer to the following common solutions:

Problem	Possible Solution
Earbuds won't turn on.	Ensure the earbuds are charged. Place them in the charging case and check the LED display.
Cannot pair with device.	<ol style="list-style-type: none"><li>1. Ensure Bluetooth is enabled on your device.</li><li>2. Make sure the earbuds are in pairing mode (open the case).</li><li>3. Forget "HD65" from your device's Bluetooth list and try pairing again.</li><li>4. Ensure the earbuds are within 15 meters of your device.</li></ol>
Only one earbud works.	<ol style="list-style-type: none"><li>1. Place both earbuds back into the charging case, close it, then open it again.</li><li>2. Ensure both earbuds are charged.</li><li>3. Try resetting the earbuds (refer to the full manual for specific reset instructions if available).</li></ol>
Poor sound quality or intermittent connection.	<ol style="list-style-type: none"><li>1. Ensure the earbuds are fully charged.</li><li>2. Move closer to your device to reduce interference.</li><li>3. Check for obstructions between the earbuds and your device.</li><li>4. Clean the eartips and earbud mesh.</li></ol>
Charging case not charging.	<ol style="list-style-type: none"><li>1. Ensure the USB-C cable is properly connected to both the case and the power source.</li><li>2. Try a different USB-C cable or power adapter.</li></ol>

## 8. Specifications

---

Feature	Detail
Brand	STECEi
Model Name	HD65
Color	Blue
Ear Placement	In-ear
Form Factor	In-ear
Impedance	32 Ohm
Noise Control	Environmental Noise Cancellation (ENC)
Connectivity Technology	Wireless
Wireless Communication Technology	Bluetooth
Bluetooth Version	5.4
Bluetooth Range	15 Meters
Control Type	Touch
Average Battery Life (Earbuds)	15 Hours (single charge)
Total Battery Life (with Case)	75 Hours
Frequency Range	20 Hz to 20,000 Hz
Audio Driver Type	Dynamic Driver
Audio Driver Size	14.2 Millimeters
Special Features	Noise Cancellation, Water Resistant
Water Resistance Level	IP7 (Impermeable)
Compatible Devices	Mobile Phones, Tablets
Recommended Use	Sport, Listening at Home

## 9. Warranty and Support

---

STECEi offers a comprehensive warranty and support for your product:

- **Refund Policy:** Full refund within 30 days of purchase.
- **Repair Service:** Repair service available within 24 months of purchase.

For further assistance or to claim warranty, please contact STECEi customer support or visit the official **STECEi Store on Amazon**.

## 10. Product Video Overview

---

Your browser does not support the video tag.

Video: A brief overview showcasing the key features of the STECEi HD65 Bluetooth Sport Earbuds, including battery life, Bluetooth 5.4, ergonomic design, and sound quality.