

HIBOITEC CDD-1001

HIBOITEC CDD-1001 Low Voltage Landscape Lighting Kit User Manual

Model: CDD-1001

1. INTRODUCTION

Thank you for choosing the HIBOITEC Low Voltage Landscape Lighting Kit. This comprehensive kit is designed to enhance the beauty and safety of your outdoor spaces, including yards, gardens, paths, and trees. Featuring durable construction, energy-efficient LED technology, and smart control options, this system provides reliable and customizable illumination. Please read this manual thoroughly before installation and operation to ensure proper use and longevity of your product.

2. WHAT'S IN THE BOX

Your HIBOITEC Low Voltage Landscape Lighting Kit includes the following components:

- 8 x 3W Landscape Spotlights (Warm White 2700K)
- 1 x 24W Low Voltage Transformer with Photocell Sensor and Timer
- 68FT ETL Approved Wire (pre-connected between spotlights)
- 8 x Metal Ground Stakes
- 1 x User Manual
- Installation Tools (Allen wrench, screws)



Image: Overview of the HIBOITEC Low Voltage Landscape Lighting Kit, showing 8 spotlights, the transformer, and connecting wires.



Image: A visual representation of the complete HIBOITEC landscape lighting kit, highlighting its all-in-one nature.

3. SETUP AND INSTALLATION

The HIBOITEC landscape lighting kit is designed for easy installation without the need for specialized electrician knowledge. Follow these steps for a successful setup:

1. **Unpack Components:** Carefully remove all items from the packaging. Inspect for any damage.
2. **Attach Ground Stakes:** For each spotlight, attach the metal ground stake to the base of the light fixture. Use the provided Allen wrench to secure the stake firmly.
3. **Position Spotlights:** Determine the desired locations for your spotlights. Place them in the ground by inserting the stakes. Ensure the wire length between lights is sufficient for your layout. The lights are pre-wired with 7.6 feet of wire between each spotlight.
4. **Connect to Transformer:** Connect the main wire from the last spotlight to the low voltage transformer. Ensure all connections are secure and waterproof.
5. **Mount Transformer:** Mount the transformer on a wall or suitable outdoor surface, ensuring it is at least 39 inches (1m-1.5m) above ground. Plug the transformer into a standard outdoor power outlet.
6. **Adjust Light Angle:** Each spotlight features a 270° adjustable head. Adjust the angle of each light to illuminate your desired features, such as trees, walls, or pathways.

Sturdy Aluminum Metal Housing



Image: A single HIBOITEC spotlight with its ground stake, highlighting the 270° adjustable angle and durable aluminum housing.



Image: A visual guide demonstrating the three simple steps for installation: installing spotlights, connecting the transformer and spotlights, and installing the transformer.

Your browser does not support the video tag.

Video: This video demonstrates the easy installation process of the HIBOITEC Low Voltage Landscape Lighting Kit, showing how to place the lights and connect them to the transformer.

4. OPERATING INSTRUCTIONS

The HIBOITEC transformer offers multiple operating modes and features for customized lighting control:

- **ON/OFF:** Manually turn the lights on or off.
- **Photo Auto (Dusk to Dawn):** The built-in photocell sensor automatically turns the lights on at dusk and off at dawn, providing convenient, energy-saving operation.
- **Timer Function:** Set the lights to turn on at dusk and remain on for a specified duration (2H, 3H, 4H, 5H, 6H, 8H, 10H, 12H). After the set time, the lights will automatically turn off.
- **Dimming Function:** Adjust the brightness of the spotlights to one of five levels (15%, 25%, 55%, 75%, 100%) to create the perfect ambiance for any scene.
- **Memory Function:** The transformer remembers your last selected settings even after a power interruption, ensuring consistent operation.

To select a mode, press the 'Mode' button on the transformer. Use the 'Time' button to cycle through timer durations and the 'Dimming' button to adjust brightness levels.

24W Low Voltage Transformer

with Six Functions



Image: Close-up of the 24W low voltage transformer, showing the control buttons for adjusting brightness, photo auto on/off, photo auto on timer off, manual on/off, and memory function.



Image: Illustration of the transformer's auto turn on at dusk and turn off at set time features, demonstrating its smart capabilities.



Image: Visual representation of the five stepless dimming levels (15%, 25%, 55%, 75%, 100%) available for the spotlights.

Your browser does not support the video tag.

Video: This video showcases the various functions of the low voltage transformer, including timer settings and dimming capabilities, and how they control the landscape lights.

5. MAINTENANCE

To ensure optimal performance and longevity of your HIBOITEC landscape lighting kit, follow these maintenance guidelines:

- **Regular Cleaning:** Periodically clean the light fixtures and transformer housing with a soft, damp cloth to remove dirt, dust, and debris. Avoid abrasive cleaners.
- **Inspect Wiring:** Annually inspect all wiring for any signs of damage, fraying, or loose connections. Ensure all waterproof connectors are tightly sealed.
- **Clear Debris:** Keep the area around the spotlights and transformer clear of leaves, mulch, and other plant debris to prevent overheating and ensure proper sensor function.
- **Check Stakes:** Ensure ground stakes remain firmly in place. Re-secure if they become loose due to soil erosion or other factors.
- **Winter Care:** While the lights are designed to be anti-freezing and waterproof (IP65), in areas with heavy snowfall or

extreme cold, consider clearing snow from around the fixtures to maintain light output and prevent excessive stress on components.



Simple Connection

Simple and easy-to-use interface for easy connection of lights and transformer

Image: HIBOITEC spotlights operating effectively in rainy conditions, demonstrating their IP65 waterproof rating.

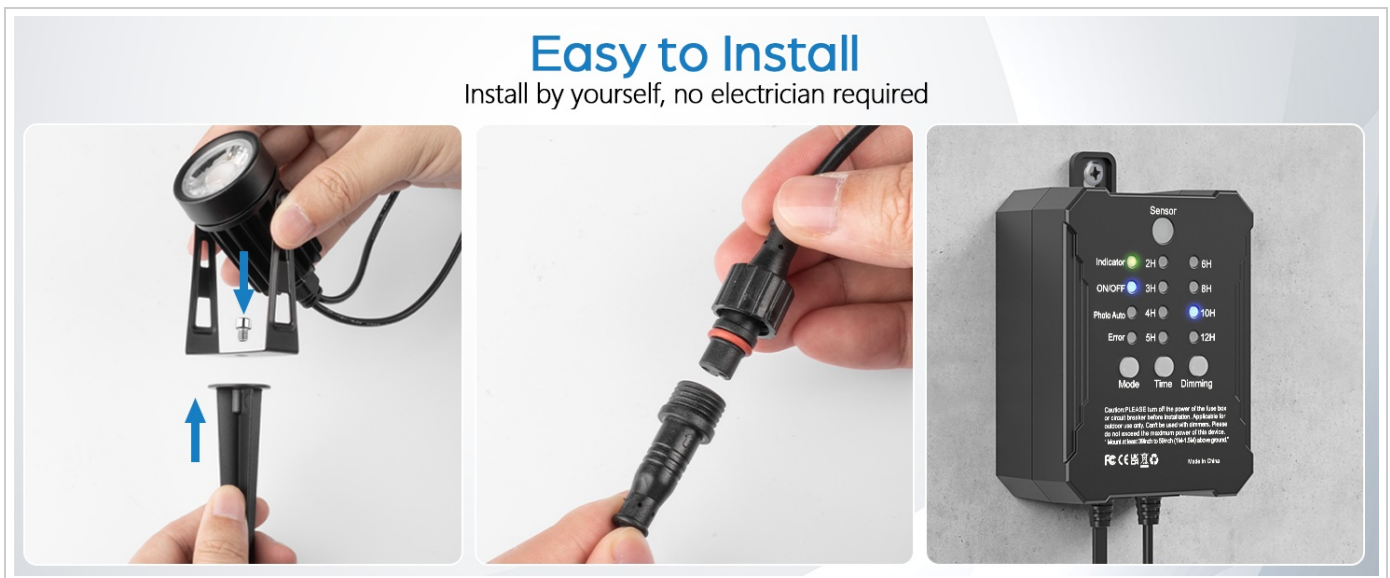

Easy to Install

Install by yourself, no electrician required

Image: HIBOITEC spotlights illuminating a yard during snowy weather, showcasing their ability to function in cold temperatures.

6. TROUBLESHOOTING

If you encounter any issues with your HIBOITEC landscape lighting kit, refer to the following common troubleshooting steps:

Problem	Possible Cause	Solution
Lights not turning on	No power to transformer; loose connections; photocell sensor blocked; incorrect timer setting.	Check power outlet and circuit breaker. Ensure all wire connections are secure. Clear any obstructions from the photocell sensor. Verify timer settings.
Lights are too dim or too bright	Incorrect dimming setting.	Adjust the dimming level using the 'Dimming' button on the transformer.

Problem	Possible Cause	Solution
Lights turn on/off at wrong times	Photocell sensor issue; incorrect timer setting.	Ensure photocell sensor is not blocked or exposed to artificial light. Re-adjust timer settings.
Some lights not working	Loose connection to specific light; damaged light fixture.	Check the connection for the affected light. If damaged, contact customer service for replacement.

7. SPECIFICATIONS

- **Brand:** HIBOITEC
- **Model Number:** CDD-1001
- **Color:** Warm White (2700K)
- **Material:** Metal (Aluminum housing)
- **Light Fixture Form:** Spotlight
- **Power Source:** AC/DC
- **Voltage:** 12 Volts
- **Wattage (per light):** 3 watts
- **Brightness (per light):** 300 Lumen
- **Number of Light Sources:** 8
- **Wire Length:** 68FT (total)
- **Water Resistance Level:** IP65 Waterproof
- **Special Features:** Anti-Rust, Dimmable, Low Voltage, Timer, Photocell Sensor
- **Control Method:** Touch (on transformer)
- **Item Dimensions (L x W x H):** 3"L x 3"W x 10"H
- **Item Weight:** 3.3 Pounds
- **Certifications:** ETL Approved Wire, FCC, UL

8. WARRANTY AND SUPPORT

HIBOITEC provides a **1-year manufacturer's warranty** for this product. Additionally, we offer a **lifelong free replacement service** for any quality problems encountered during use. If you are not satisfied with the product's quality, please contact our customer service for unconditional replacement.

For any questions, concerns, or support needs, please contact HIBOITEC customer service via email at: grant_fan@126.com. Please include your order ID when contacting us so we can better assist you.