

## STONVUE B0DS1P9772

# STONVUE 1080P Magnetic Wireless Backup Camera User Manual

Model: B0DS1P9772

[Introduction](#)   [Safety Information](#)   [Package Contents](#)   [Product Overview](#)   [Setup](#)   [Operating Instructions](#)   [Maintenance](#)   [Troubleshooting](#)   [Specifications](#)   [Warranty & Support](#)

## 1. INTRODUCTION

Thank you for choosing the STONVUE 1080P Magnetic Wireless Backup Camera. This manual provides detailed instructions for the installation, operation, and maintenance of your device. Please read this manual thoroughly before use to ensure proper functionality and safety.

This camera is designed to assist with reversing, hitching, and monitoring for various vehicles such as RVs, trucks, trailers, campers, SUVs, and pickups. It features a strong magnetic base for easy installation, multiple charging options including solar, and stable wireless connectivity to your smartphone or tablet.

## 2. SAFETY INFORMATION

- Always ensure the camera is securely mounted before driving.
- Do not obstruct the camera's view or the solar panel (if applicable).
- This device is an aid and should not replace careful driving and observation. Always check your surroundings manually.
- Keep the device away from extreme temperatures and direct sunlight for prolonged periods when not in use to preserve battery life.
- Do not attempt to disassemble or repair the camera yourself. Contact customer support for assistance.
- Ensure all cables are properly connected and secured to prevent damage or interference.

### 3. PACKAGE CONTENTS

Please check the package for the following items:

- STONVUE 1080P Magnetic Wireless Backup Camera
- USB Charging Cable
- Car Charger
- User Manual
- Mounting Accessories (screws, adhesive pad - if applicable)



Image: The STONVUE 1080P Magnetic Wireless Backup Camera, showing its compact design and magnetic base.

### 4. PRODUCT OVERVIEW

The STONVUE backup camera is equipped with advanced features for reliable performance:

- **1080P HD CMOS Sensor:** Provides clear and lifelike images.
- **IR Night Vision:** Four infrared LEDs for visibility up to 17 ft (5 m) in low light.

- **Strong Magnetic Base:** Allows for easy, drill-free attachment to metal surfaces.
- **Multiple Charging Modes:** Supports solar (with optional STONVUE solar panel), USB, and car charger.
- **Long-Lasting Battery:** 3000mAh rechargeable battery offers up to 7 hours continuous use and up to 365 days standby.
- **Stable WiFi Signal:** Connects to the INSEECam App via a hotspot, with a range up to 197 ft (60m).
- **IP69K Weatherproof:** Designed to withstand harsh weather conditions.
- **150° Wide Angle Lens:** Provides a broad field of view.



Image: Diagram showing the camera's components, including the infrared indicator, battery indicator, microphone, photosensitive sensor, magnetic bracket, charging port, and power reset button.

## 5. SETUP

### 5.1 Charging the Camera

Before first use, fully charge the camera using the provided USB cable or car charger. If you have the STONVUE solar panel (sold separately), ensure it is exposed to sunlight for continuous charging.

- **USB Charging:** Connect the USB cable to the camera's charging port and a standard USB power adapter.
- **Car Charger:** Use the car charger to power the camera directly from your vehicle's 12V outlet.
- **Solar Charging:** Position the camera so the solar panel receives at least 2 hours of direct sunlight daily for optimal performance and extended standby time.

# 2024 Upgraded WiFi Signal Technology, More Stable

Note: The transmission distance of the camera varies depending on the vehicle types and the environment.

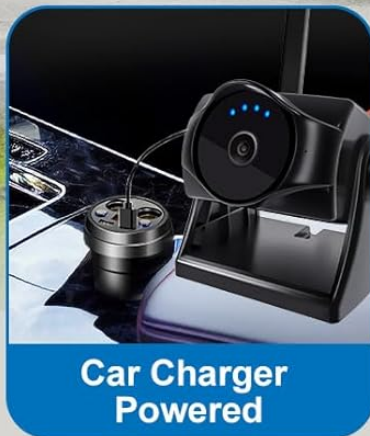

Image: Illustration of the three charging methods: car charger, USB power, and solar power for the STONVUE backup camera.

## 5.2 App Download and Installation

The STONVUE camera operates with the INSEECam App, compatible with iPhone, iPad, and Android devices.

1. Search for "INSEECam" in the Apple App Store (for iOS) or Google Play Store (for Android).
2. Download and install the app on your smartphone or tablet.



Image: A visual guide demonstrating the four steps for setup: downloading the INSEECam app, mounting the camera, connecting to the camera's Wi-Fi hotspot, and opening the app to begin use.

### 5.3 Mounting the Camera

The camera features a strong magnetic base for easy attachment.

1. Identify a suitable metal surface on your vehicle (e.g., rear bumper, trailer hitch, side panel) that provides a clear view.
2. Ensure the surface is clean and dry.
3. Attach the camera firmly to the metal surface using its magnetic base. No drilling is required.
4. Adjust the camera angle to achieve the desired viewing perspective. The camera offers a 150° wide-angle view and can be adjusted for optimal coverage.

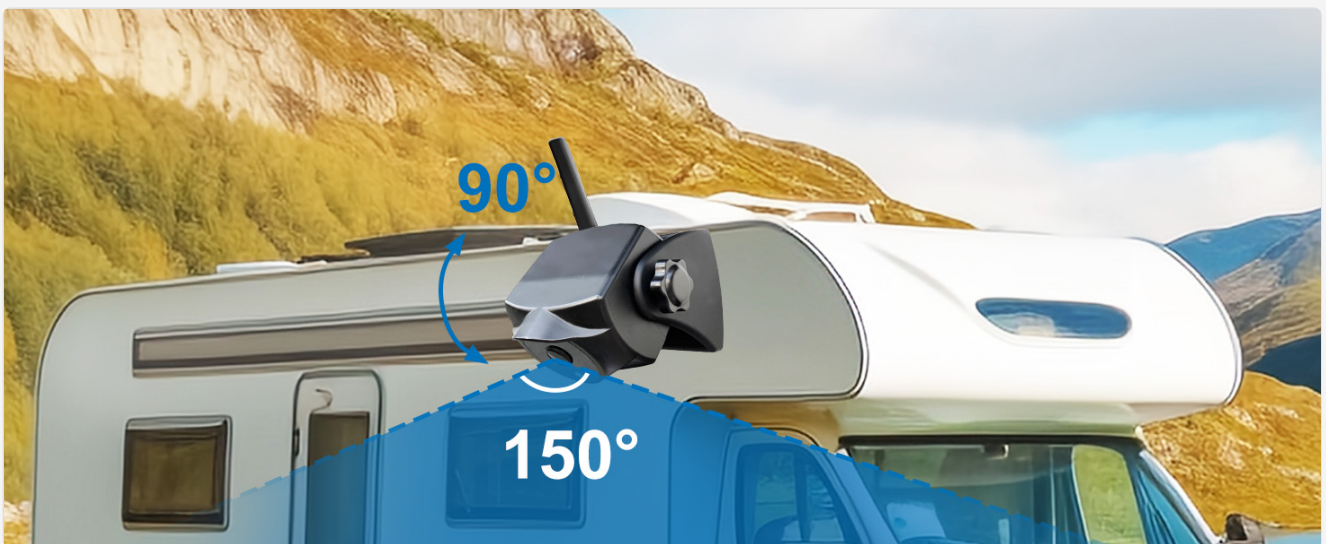

Image: The STONVUE camera securely attached to the side of a vehicle using its strong magnetic bracket, illustrating the ease of installation.

### 5.4 Connecting to Wi-Fi

1. Power on the camera. The battery indicator lights will illuminate.
2. On your smartphone or tablet, go to Wi-Fi settings.
3. Locate and connect to the Wi-Fi hotspot named "WFS-XXXXXX" (where XXXXXX is a unique identifier).
4. Once connected, open the INSEECam App to view the live feed.



Image: A visual representation of the STONVUE camera transmitting a stable Wi-Fi signal to a smartphone inside a vehicle, demonstrating its effective range for vehicles up to 30 feet.

## 6. OPERATING INSTRUCTIONS

### 6.1 Using the INSEECam App

The INSEECam App provides various functions to enhance your viewing experience:

- **Live View:** Access real-time video feed from the camera.
- **Parking Lines:** Customize and adjust parking guidelines for precise maneuvering. Drag 8 points to resize and align them for your vehicle.
- **Screenshot:** Capture still images from the live feed.
- **Video Recording:** Record video footage directly to your device.
- **Image Flip:** Horizontally or vertically flip the image for correct orientation.
- **Full Screen:** View the feed in full-screen mode.
- **Download:** Download recorded videos or screenshots.

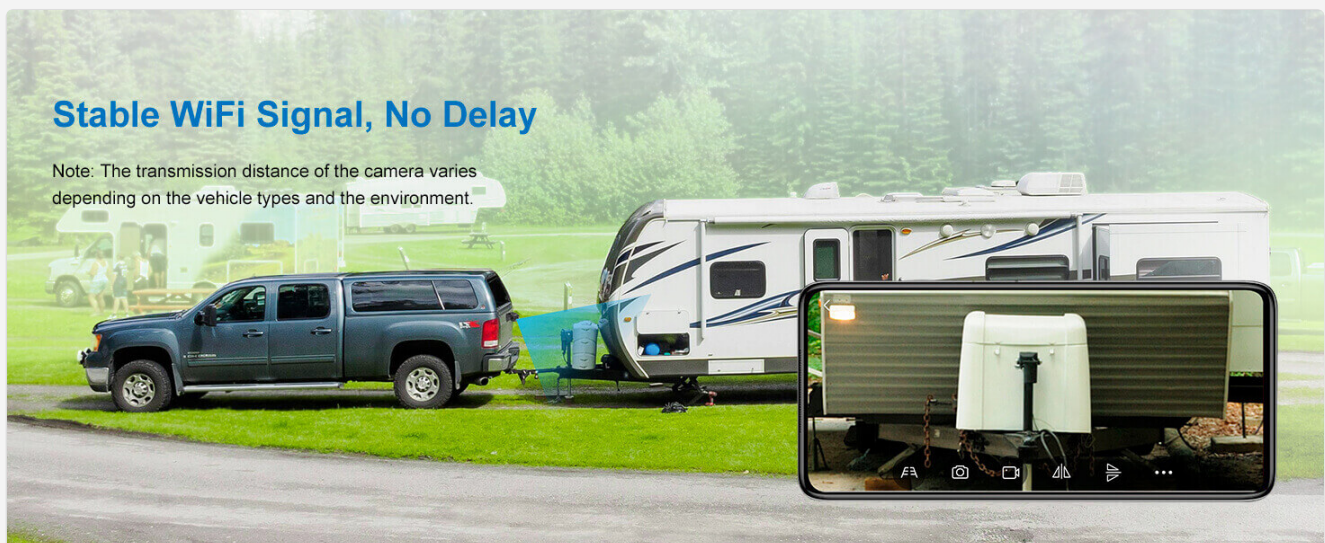

Image: A smartphone display illustrating the adjustable parking assisting lines feature within the INSEECam app, allowing users to customize guidelines by dragging eight points.



Image: A smartphone screen displaying various functions of the INSEECam app, including auto sleep, shutdown, download, video recording, 1080P resolution, and full-screen viewing.

## 6.2 Night Vision

The camera automatically activates its infrared LEDs in low-light conditions, providing clear night vision up to 17 feet (5 meters) for enhanced safety during nighttime operations.

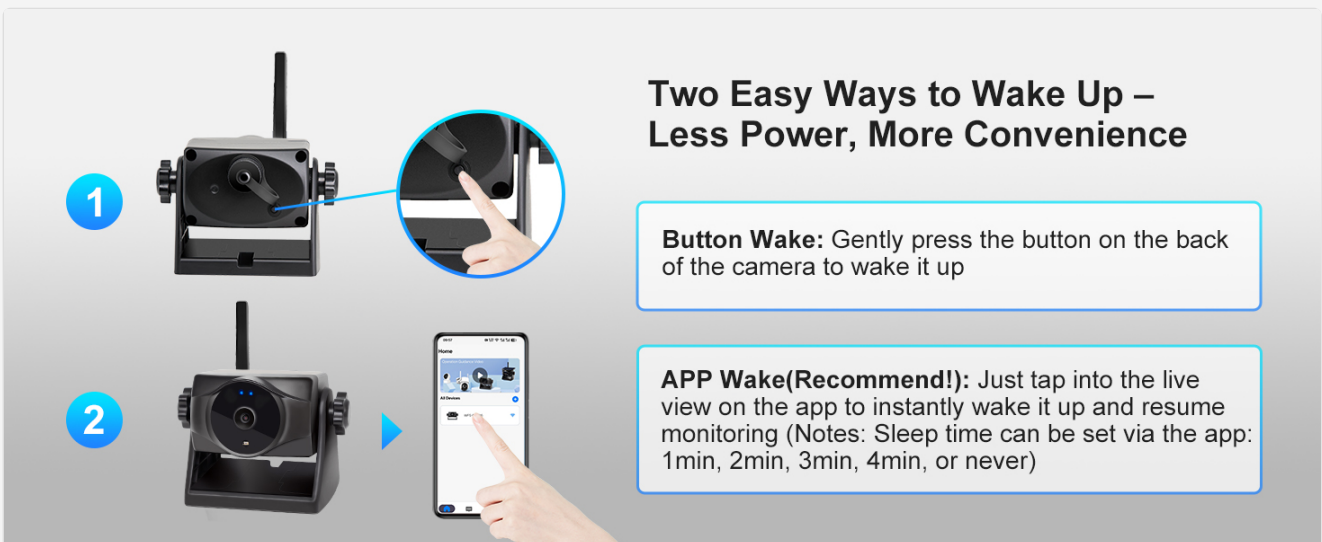

Image: An illustration depicting the STONVUE camera's excellent performance in both bright daylight and low-light night conditions, highlighting its versatility.

## 6.3 Power Saving and Wake-Up

The camera features a smart power-saving mode to conserve battery life.

- **Sleep Mode:** After 2 minutes of inactivity or when exiting the INSEECam app, the camera automatically enters a low-power sleep mode. It can remain in standby for up to 365 days with adequate solar exposure (at least 2 hours per day).
- **Wake-Up Methods:**
  - **Button Wake:** Gently press the button on the back of the camera to reactivate it.
  - **App Wake (Recommended):** Simply tap into the live view on the INSEECam app to instantly wake up the camera and resume monitoring. Sleep time can be set via the app (1 min, 2 min, 3 min, 4 min, or never).

## Two Charging Modes

The hitch backup camera supports USB charging and car charger charging, providing flexible power options for various scenarios.



Car Charger Powered



USB Powered

Image: The STONVUE camera in standby mode, showing battery indicator lights and an explanation of how it enters low-power mode when the app is exited, reactivating upon app reopening.

## Stable WiFi Signal

One minute setup, covering up to 197FT/60m without obstacles.



Image: A diagram illustrating the two methods to wake up the camera: pressing the physical button on the back or using the "App Wake" feature by tapping the live view in the INSEECam app.

## 6.4 Usage Scenarios

The STONVUE camera is versatile and can be used for:

- **Reversing:** Provides a clear view behind your vehicle for safer backing up.
- **Hitching:** Assists in aligning your vehicle with a trailer hitch.
- **Monitoring:** Can be used to monitor cargo, livestock, or blind spots during travel.



Image: An infographic showing the primary applications of the STONVUE camera: reversing, hitching, and monitoring, suitable for

## 7. MAINTENANCE

- **Cleaning:** Regularly clean the camera lens and solar panel (if applicable) with a soft, damp cloth to ensure clear image quality and efficient solar charging. Do not use abrasive cleaners.
- **Battery Care:** For optimal battery life, avoid fully discharging the battery frequently. Charge the camera regularly, especially if not exposed to sufficient sunlight.
- **Weather Resistance:** The camera is IP69K weatherproof, designed to withstand dust, water, and extreme temperatures. However, prolonged exposure to severe conditions may affect performance over time. Ensure the charging port cover is securely closed when not charging.
- **Storage:** If storing the camera for an extended period, ensure it is fully charged and store it in a cool, dry place. Recharge periodically to prevent deep discharge.

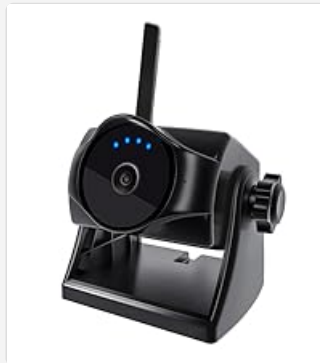

Image: An illustration highlighting the STONVUE camera's durability against various environmental factors, including high operating temperatures (140°F), low operating temperatures (-4°F), anti-hail capabilities, and IP69K waterproof rating.

## 8. TROUBLESHOOTING

Problem	Possible Cause	Solution
No image on app / Cannot connect to Wi-Fi	<ul style="list-style-type: none"> <li>◦ Camera is off or battery is low.</li> <li>◦ Incorrect Wi-Fi network selected.</li> <li>◦ Camera is in sleep mode.</li> <li>◦ Obstruction between camera and device.</li> </ul>	<ul style="list-style-type: none"> <li>◦ Ensure camera is charged and powered on.</li> <li>◦ Connect to the "WFS-XXXXXX" Wi-Fi network.</li> <li>◦ Wake up the camera via button or app.</li> <li>◦ Reduce distance or clear obstructions.</li> </ul>
Image is blurry or unclear	<ul style="list-style-type: none"> <li>◦ Lens is dirty.</li> <li>◦ Poor lighting conditions.</li> </ul>	<ul style="list-style-type: none"> <li>◦ Clean the camera lens with a soft cloth.</li> <li>◦ Ensure adequate lighting or rely on night vision.</li> </ul>
Battery drains quickly	<ul style="list-style-type: none"> <li>◦ Insufficient solar charging.</li> <li>◦ Continuous operation without sleep mode.</li> <li>◦ Aging battery.</li> </ul>	<ul style="list-style-type: none"> <li>◦ Ensure solar panel receives direct sunlight.</li> <li>◦ Allow camera to enter sleep mode when idle.</li> <li>◦ Contact support if battery life significantly degrades.</li> </ul>

Problem	Possible Cause	Solution
App crashes or freezes	<ul style="list-style-type: none"> <li>App software issue.</li> <li>Device compatibility issue.</li> </ul>	<ul style="list-style-type: none"> <li>Restart the app and your device.</li> <li>Ensure your app is updated to the latest version.</li> <li>Check device compatibility requirements.</li> </ul>

## 9. SPECIFICATIONS

Feature	Detail
Model	B0DS1P9772
Brand	STONVUE
Resolution	1080P HD (720P output)
Optical Sensor Technology	CMOS infrared
Optical Sensor Size	1/2.7 inch
Lens Type	Wide Angle (150°)
Night Vision Range	Up to 17 ft (5 m)
Battery Capacity	3000mAh Lithium Ion
Continuous Operation Time	Up to 7 hours
Standby Time	Up to 365 days (with solar exposure)
Charging Modes	Solar, USB, Car Charger
Connectivity	Wireless (Wi-Fi Hotspot)
Wi-Fi Signal Range	Up to 197 ft (60m) without obstacles
Installation Type	Surface Mount (Magnetic)
Weather Resistance	IP69K
Compatible Devices	iPhone, iPad, Android Devices
Dimensions	Approx. 4.05 x 2.75 x 3.46 inches (10.3 x 7 x 8.8 cm)

## 10. WARRANTY & SUPPORT

STONVUE products are designed for reliability and performance. For warranty information, technical support, or any questions regarding your product, please refer to the contact information provided with your purchase or visit the official STONVUE website.

Please retain your proof of purchase for warranty claims.



© 2025 STONVUE. All rights reserved.