

## Bonsaii C275-B

# Bonsaii C275-B 10-Sheet Micro-Cut Paper Shredder User Manual

Model: C275-B

## 1. INTRODUCTION

---

Thank you for choosing the Bonsaii C275-B 10-Sheet Micro-Cut Paper Shredder. This document provides essential information for the safe and efficient operation, maintenance, and troubleshooting of your new shredder. Please read this manual thoroughly before use and retain it for future reference.

The Bonsaii C275-B is designed for secure document disposal, featuring a P4 security level micro-cut, a 10-sheet capacity, an anti-jam system, and overheat protection, making it suitable for both home and office environments.

## 2. SAFETY INSTRUCTIONS

---

- **Read all instructions:** Familiarize yourself with the shredder's functions and safety warnings before operation.
- **Keep hands and fingers clear:** Never place hands or fingers near the paper entry slot.
- **Avoid loose clothing and jewelry:** Keep ties, necklaces, and loose clothing away from the paper entry.
- **Hair safety:** Keep long hair away from the paper entry.
- **Children and pets:** Keep children and pets away from the shredder at all times.
- **Power source:** Connect the shredder to a properly grounded power outlet with the correct voltage.
- **Unplug when not in use:** Always unplug the shredder before cleaning, moving, or when it is not in use.
- **Do not shred wet or sticky materials:** This can damage the shredder blades.
- **Lid Safety Lock:** The shredder is equipped with a safety lock that stops operation when the lid is opened, preventing accidental injury.
- **Overheat Protection:** The unit will automatically shut off if it overheats. Allow it to cool down before resuming operation.

## 3. PRODUCT OVERVIEW

---



Overall view of the Bonsai C275-B paper shredder, showing its compact design and waste bin.

### Key Features:

- **Micro-Cut Security (P4):** Shreds documents into 5 x 12 mm particles for enhanced security.
- **10-Sheet Capacity:** Shreds up to 10 sheets of A4 paper simultaneously.
- **Multi-Material Shredding:** Capable of shredding paper, credit cards, staples, and small paper clips.
- **Anti-Jam System:** Automatic start/stop and manual reverse function to clear paper jams.
- **Overheat Protection:** Automatically shuts off to prevent motor damage during extended use.
- **21-Liter Waste Bin:** Large capacity bin with a transparent window for easy monitoring of shredded waste.
- **Compact Design:** Dimensions of 32.1 x 20 x 46.5 cm, designed to fit under most desks.
- **Built-in Handle:** Ergonomic handle for easy lifting and emptying of the shredder head.

## 4. SETUP

---

1. **Unpack:** Carefully remove the shredder from its packaging.
2. **Placement:** Place the shredder on a flat, stable surface. Ensure it is positioned near a power outlet and that there is sufficient space around it for ventilation. The compact design allows it to fit under most desks.
3. **Assemble (if necessary):** Ensure the shredder head is securely seated on top of the waste bin. The lid safety lock will prevent operation if not correctly assembled.
4. **Connect Power:** Plug the power cord into a standard electrical outlet.



The Bonsai C275-B shredder positioned under a desk, illustrating its compact dimensions (20 cm depth, 32.1 cm width, 46.5 cm height).

## 5. OPERATING INSTRUCTIONS

### Control Panel:

The control panel typically features a slide switch with three positions: FWD (Forward), AUTO (Automatic), and REV (Reverse).

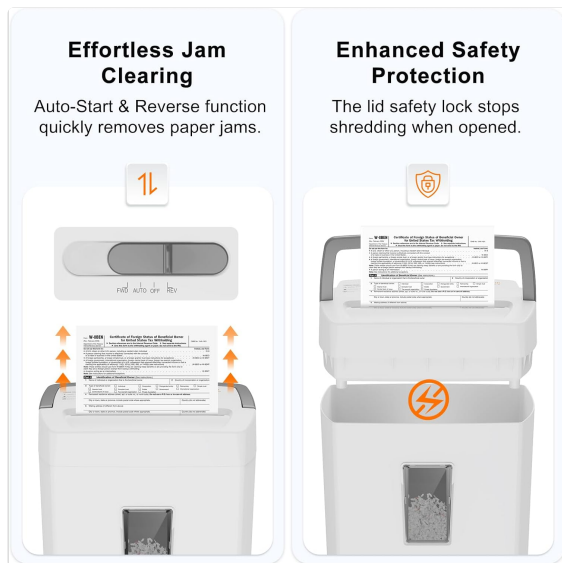

Image showing the control panel with FWD, AUTO, OFF, REV settings, and the lid safety lock mechanism.

### Shredding Documents:

- Select Mode:** Slide the switch to the 'AUTO' position. The shredder is now ready for operation.
- Insert Material:** Insert up to 10 sheets of A4 paper, a credit card, or a small paper clip/staple into the paper entry slot. The shredder will automatically start and stop once the material has passed through.
- Continuous Operation:** The shredder can operate continuously for up to 5 minutes. After this period, it may require a cool-down time to prevent overheating.



Illustration of the Bonsaii C275-B shredding various materials like junk mail, credit cards, paper, staples, and clips into 5x12mm micro-cut particles.



The shredder operating for its 5-minute continuous working time, indicating a shredding speed of 10 sheets per 9 seconds.

## 6. MAINTENANCE

### Emptying the Waste Bin:

1. **Unplug:** Always unplug the shredder from the power outlet before emptying the bin.
2. **Remove Shredder Head:** Use the built-in handle to lift the shredder head off the 21-liter waste bin.
3. **Empty:** Dispose of the shredded material.
4. **Replace Head:** Carefully place the shredder head back onto the bin, ensuring it is securely seated.



Image showing the built-in handle on the shredder head for easy removal and the 21-liter waste bin with a transparent window to monitor fill level.

### Cleaning:

- **Exterior:** Wipe the exterior of the shredder with a soft, dry cloth. Do not use abrasive cleaners or solvents.
- **Blades:** For optimal performance, periodically oil the shredder blades with shredder oil. Follow the instructions provided with the shredder oil.

## 7. TROUBLESHOOTING

---

### Common Issues and Solutions:

- **Shredder does not turn on:**
  - Ensure the power cord is securely plugged into a working outlet.
  - Check that the shredder head is correctly seated on the waste bin. The lid safety lock prevents operation if not properly aligned.
  - Verify the switch is in the 'AUTO' position.
- **Paper Jam:**
  - Slide the switch to the 'REV' (Reverse) position to clear the jam. This will push the paper back out.
  - If the jam persists, unplug the shredder, carefully remove the shredder head, and manually clear any visible paper. Be cautious of the sharp blades.
  - Avoid exceeding the maximum sheet capacity (10 sheets).
- **Overheat Protection Activated:**
  - If the shredder stops working and the 'Overheat' indicator light is on (or the power light turns red), the unit has overheated.
  - Unplug the shredder and allow it to cool down for approximately 40 minutes before resuming operation.



Image illustrating the overheat protection feature. The power indicator turns red and displays "Wait 40 min" when the unit needs to cool down.

## 8. SPECIFICATIONS

Feature	Specification
Brand	Bonsaii
Model Number	C275-B
Cut Type	Micro-Cut
Security Level	P4 (5 x 12 mm particles)
Standard Sheet Capacity	10 sheets (A4)
Waste Bin Capacity	21 Liters
Continuous Run Time	Up to 5 minutes
Cool Down Time	Approx. 40 minutes
Power Source	Corded Electric
Product Dimensions (D x W x H)	20.1 x 32.3 x 46.5 cm
Noise Level	70 Decibels
Color	White
Special Features	High-security micro-cut, Innovative anti-jam system

## 9. WARRANTY AND SUPPORT

Bonsaii products are designed for reliability and performance. For warranty information, please refer to the documentation included with your purchase or visit the official Bonsaii website.

If you encounter any issues or have questions regarding your Bonsaii C275-B paper shredder, please contact Bonsaii Customer Service. Contact details can typically be found on the product packaging, the

official Bonsaii website, or through your retailer.

Please have your model number (C275-B) and purchase date ready when contacting support.

---

© 2026 Bonsaii. All rights reserved.