

## Manuals+

[Q & A](#) | [Deep Search](#) | [Upload](#)

manuals.plus /

› [HEIMAN](#) /

› [HEIMAN Smart Home Sensors User Manual](#)

## HEIMAN M1-M, D1-M

# HEIMAN Smart Home Sensors User Manual

Motion Sensor (M1-M) and Door & Window Sensor (D1-M)

## 1. INTRODUCTION

---

This manual provides comprehensive instructions for the installation, operation, and maintenance of your HEIMAN Motion Sensor (M1-M) and Door & Window Sensor (D1-M). These devices are designed to enhance your smart home security and automation through Matter over Thread technology, offering reliable connectivity and seamless integration with compatible smart home ecosystems.



Figure 1.1: HEIMAN Motion Sensor (left) and Door & Window Sensor (right).

## 2. PRODUCT COMPONENTS

---

The HEIMAN smart sensor package includes two primary devices: the Motion Sensor and the Door & Window Sensor. Each sensor is designed for specific monitoring functions within your home.

### 2.1. HEIMAN Motion Sensor (M1-M)

The Motion Sensor (M1-M) is an infrared detector designed to sense human movement within its detection range. It features a 360° rotating bracket for flexible positioning and includes capabilities for security monitoring, illumination sensing, remote reminders, and scene linkage.



Figure 2.1: Packaging for the HEIMAN Smart Motion Sensor (M1-M).

# Smart Human Infrared Detector

M1-M

## Key feature :



360° rotating bracket



Security monitoring



Illumination sensing



Remote reminder



Scene linkage

Figure 2.2: Key features of the HEIMAN Smart Human Infrared Detector M1-M, including 360° rotating bracket, security monitoring, illumination sensing, remote reminder, and scene linkage.

## 2.2. HEIMAN Door & Window Sensor (D1-M)

The Door & Window Sensor (D1-M) is a two-part magnetic contact sensor designed to detect the opening and closing of doors or windows. It offers features such as switch reminders, real-time detection, a long 5-year battery life, anti-tamper alarm, and intelligent scene linkage.



Figure 2.3: Packaging for the HEIMAN Smart Door Sensor (D1-M).

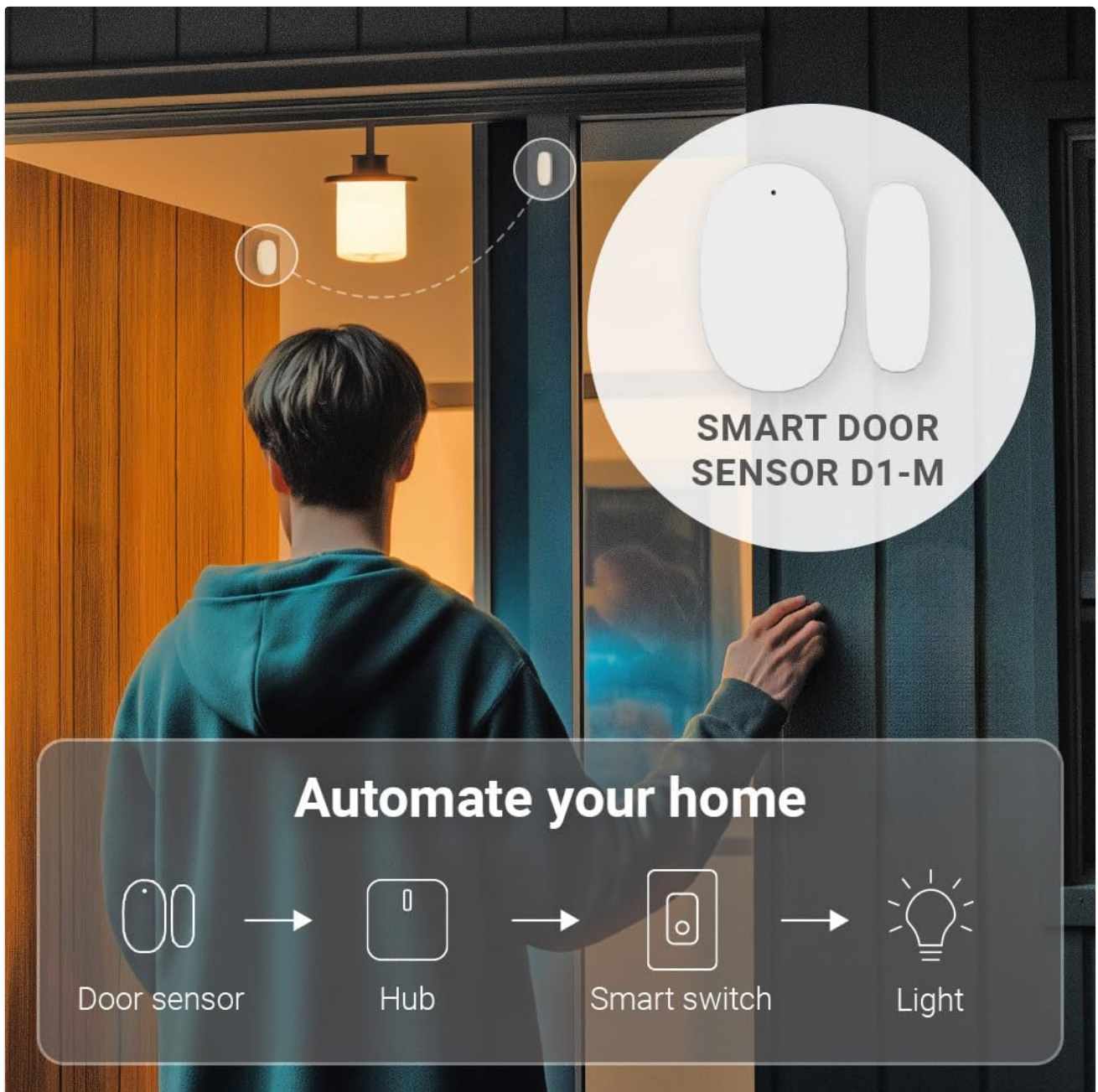

Figure 2.4: Key features of the HEIMAN Smart Door Sensor D1-M, including switch reminder, real-time detection, 5-year battery life, anti-tamper alarm, and intelligent scene linkage.

### 3. FEATURES AND COMPATIBILITY

Both HEIMAN sensors leverage **Matter over Thread** technology, providing a robust and efficient connection to your smart home ecosystem.

- **Native Matter Support over Thread:** Enables direct connectivity with major smart home platforms.
- **Enhanced Connectivity:** Utilizes Thread for a stable and reliable network.
- **Low Power Consumption:** Designed for extended battery life, especially the Door Sensor with a 5-year life.
- **Low Latency:** Ensures quick response times for automation and alerts.
- **Broad Compatibility:** Seamlessly integrates with Apple Home, Google Home, Amazon Alexa, and Samsung SmartThings.





\*This door sensor requires a hub of your chosen platform:





 <p><b>Apple Home:</b> Apple TV 4K (2nd gen) Apple TV 4K (3rd gen 128 GB) HomePod (2nd gen) HomePod mini</p>	 <p><b>Amazon Alexa:</b> Echo (4th gen) Echo Hub Echo Plus (2nd gen) Echo Show 8/10 (3rd gen) Echo Studio eero 6 / 6+ / Pro 6 / Pro 6E / Max 7</p>
 <p><b>Samsung SmartThings:</b> SmartThings Hub v3</p>	 <p><b>Google Home:</b> Nest Hub (2nd gen) Nest Hub Max Nest Wifi Nest Wifi Pro</p>

Figure 3.1: The HEIMAN Door Sensor requires a compatible Thread Border Router or hub from your chosen platform (Apple Home, Amazon Alexa, Samsung SmartThings, Google Home).

*Note:* A Thread Border Router is required for these sensors to function within your smart home network.

## 4. SETUP AND INSTALLATION

Before installation, ensure you have a compatible Thread Border Router set up and connected to your smart home platform (e.g., Apple Home, Google Home, Amazon Alexa, Samsung SmartThings).

### 4.1. General Pairing Process (Matter over Thread)

1. Ensure your Thread Border Router is powered on and connected to your home network.
2. Open your preferred smart home app (e.g., Apple Home, Google Home, Alexa app, SmartThings app).
3. Follow the app's instructions to add a new Matter-compatible device. This usually involves scanning a QR code or entering a pairing code found on the sensor or its packaging.
4. The app will guide you through connecting the sensor to your Thread network.
5. Once connected, you can assign the sensor to a room and configure its settings.

## 4.2. Motion Sensor (M1-M) Installation

The Motion Sensor (M1-M) comes with a 360° rotating bracket, allowing for versatile placement on ceilings or walls.

- Choose a location where the sensor can effectively monitor the desired area, considering its infrared detection range.
- Mount the bracket securely using screws or adhesive (if provided and suitable for the surface).
- Attach the motion sensor to the bracket, adjusting its angle for optimal coverage.

## 4.3. Door & Window Sensor (D1-M) Installation

The Door & Window Sensor (D1-M) is designed for easy, wire-free installation using its adhesive backing.

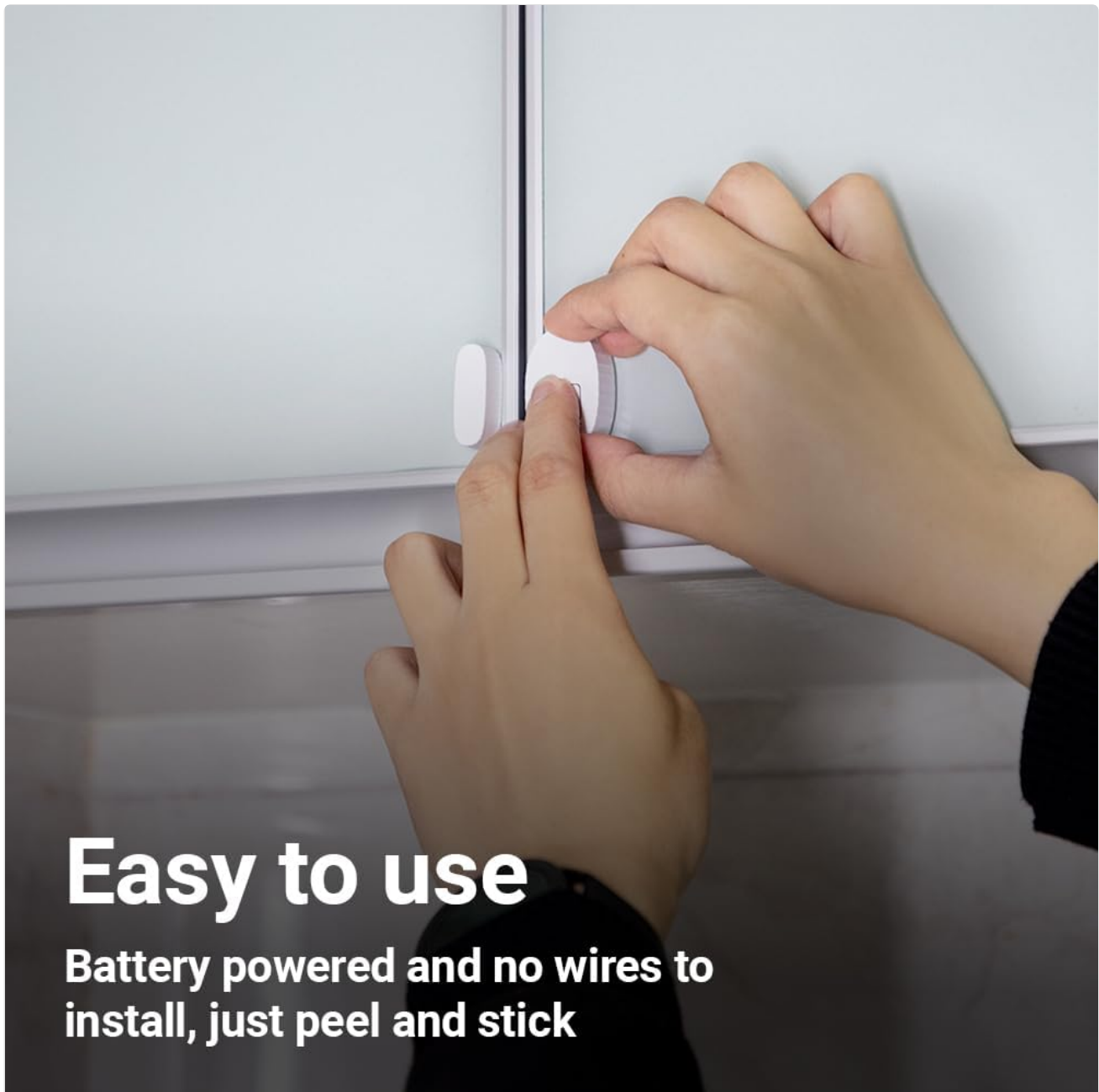

Figure 4.1: The HEIMAN Door Sensor is battery-powered and installs easily by peeling and sticking.

1. Identify a clean, dry surface on your door/window frame and the corresponding moving part (door/window).
2. Peel the protective film from the adhesive backing of both sensor parts.
3. Attach the larger sensor part to the fixed frame.



4. Attach the smaller magnetic part to the moving door/window, ensuring it is aligned with the larger part and within 1 cm when the door/window is closed.
5. Test the sensor by opening and closing the door/window to confirm detection in your smart home app.

## 5. OPERATING INSTRUCTIONS

---

Once installed and paired, your HEIMAN sensors will provide real-time data to your smart home system, enabling various automation scenarios.

### 5.1. Motion Sensor (M1-M) Operation

The Motion Sensor detects movement and reports it to your smart home hub. This allows for:

- **Security Monitoring:** Receive alerts when motion is detected in monitored areas.
- **Lighting Automation:** Automatically turn lights on when entering a room and off when no motion is detected.
- **Scene Linkage:** Trigger complex scenes, such as adjusting thermostat settings or activating other smart devices upon motion detection.

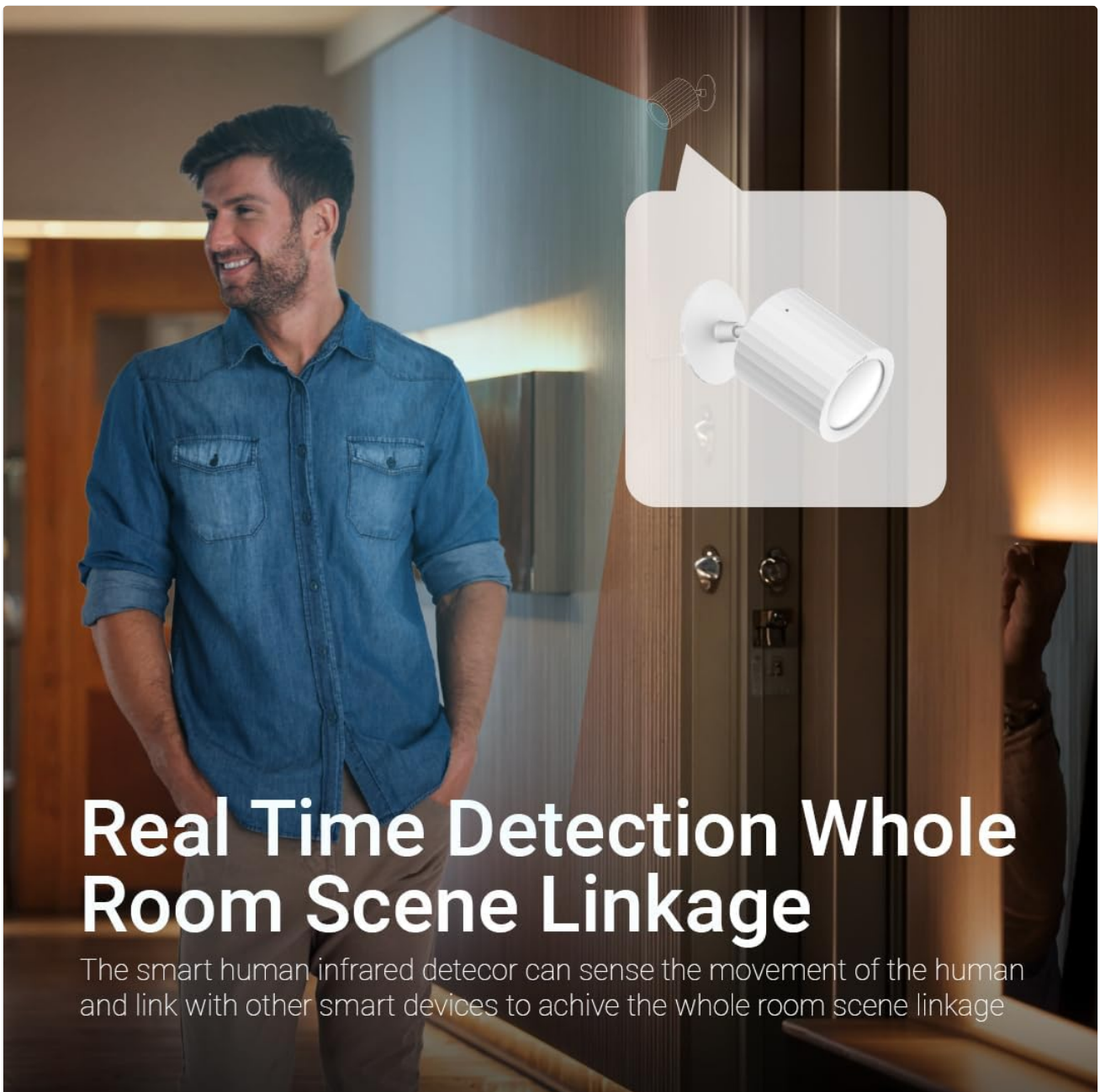
A man in a blue denim shirt stands in a modern interior, smiling. A motion sensor is highlighted in a callout box. The sensor is a white, cylindrical device with a lens and a mounting bracket. A small inset image shows the sensor mounted on a wall. The background is a blurred interior with warm lighting.

# Real Time Detection Whole Room Scene Linkage

The smart human infrared detector can sense the movement of the human and link with other smart devices to achieve the whole room scene linkage

Figure 5.1: The smart human infrared detector (motion sensor) can sense human movement and link with other smart devices for whole room scene linkage.

## 5.2. Door & Window Sensor (D1-M) Operation

The Door & Window Sensor reports its open/closed status. This enables:

- **Real-time Detection:** Instantly know if a door or window is open or closed.
- **Security Alerts:** Receive notifications if a monitored entry point is opened unexpectedly.
- **Switch Reminders:** Get reminders if a door or window is left open for too long.
- **Automation:** Create rules to trigger actions, such as turning off HVAC when a window is open, or turning on a light when a door opens.



Figure 5.2: Example of home automation: Door sensor detects opening, signals the hub, which activates a smart switch to turn on a light.

## 6. MAINTENANCE

Both sensors are designed for low maintenance.

- **Battery Replacement:** The Door & Window Sensor (D1-M) boasts an approximate 5-year battery life. When the battery is low, your smart home app will typically notify you. Refer to the sensor's specific model documentation or the HEIMAN website for battery type and replacement instructions.
- **Cleaning:** Gently wipe the sensors with a dry, soft cloth to remove dust. Do not use liquid cleaners or abrasive materials.
- **Firmware Updates:** Ensure your Thread Border Router and smart home app are kept up-to-date, as they may facilitate firmware updates for the sensors to improve performance and security.

## 7. TROUBLESHOOTING

---

If you encounter issues with your HEIMAN sensors, consider the following troubleshooting steps:

- **Sensor Not Responding:**
  - Check the battery level in your smart home app. Replace if low.
  - Ensure the sensor is within range of your Thread Border Router.
  - Verify that your Thread Border Router is online and functioning correctly.
  - Attempt to re-pair the sensor with your smart home app.
- **Inaccurate Readings (Motion Sensor):**
  - Ensure the sensor's field of view is not obstructed.
  - Avoid placing the sensor near heat sources or direct sunlight, which can cause false triggers.
  - Adjust the sensor's angle using its rotating bracket for optimal coverage.
- **Inaccurate Readings (Door & Window Sensor):**
  - Ensure the two parts of the sensor are properly aligned and within 1 cm when the door/window is closed.
  - Check if the adhesive is still secure; re-attach if necessary.
- **Connectivity Issues:**
  - Restart your Thread Border Router.
  - Ensure your smart home app and hub firmware are updated to the latest versions.
  - Check for any Wi-Fi interference if your Thread Border Router relies on Wi-Fi for backhaul.

If problems persist, consult the support section of the HEIMAN website or contact customer support.

## 8. SPECIFICATIONS

---

Attribute	Detail
Product Name	HEIMAN Motion Sensor and Door & Window Sensor
Model Numbers	Motion Sensor: M1-M, Door & Window Sensor: D1-M
Connectivity	Matter over Thread
Power Source	Battery-powered (specific battery type not provided, refer to product for details)

Attribute	Detail
Door Sensor Battery Life	Approximately 5 years
Required Hub	Thread Border Router (e.g., Apple HomePod, Google Nest Hub, Amazon Echo (4th Gen+), Samsung SmartThings Hub v3)
ASIN	B0DRV5GWVL
Date First Available	December 30, 2024

## 9. WARRANTY AND SUPPORT

---

For warranty information, product registration, and technical support, please visit the official HEIMAN website or contact their customer service. Keep your purchase receipt as proof of purchase.

**HEIMAN Official Website:** [www.heimantech.com](http://www.heimantech.com)

For further assistance, refer to the support section of your smart home platform's application or website.

© 2024 HEIMAN. All rights reserved.

Product specifications are subject to change without notice.