

SAHAUHY WTE80P-025P

SAHAUHY 80-Pint Dehumidifier User Manual

Model: WTE80P-025P

INTRODUCTION

Thank you for choosing the SAHAUHY 80-Pint Dehumidifier. This manual provides essential information for the safe operation, installation, maintenance, and troubleshooting of your appliance. Please read it thoroughly before use and retain it for future reference.

SAFETY INSTRUCTIONS

To prevent injury to the user or others and property damage, the following instructions must be followed. Incorrect operation due to ignoring instructions may cause harm or damage.

- Always operate the unit on a grounded power outlet.
- Do not operate the unit with a damaged power cord or plug.
- Ensure the unit is placed on a stable, level surface to prevent tipping.
- Keep a minimum clearance of 8 inches (20 cm) around the unit for proper airflow.
- Do not insert objects into the air inlet or outlet.
- Unplug the unit before cleaning or performing any maintenance.
- Do not use chemical solvents to clean the unit.
- This appliance is not intended for use by persons (including children) with reduced physical, sensory or mental capabilities, or lack of experience and knowledge, unless they have been given supervision or instruction concerning use of the appliance by a person responsible for their safety.

PRODUCT OVERVIEW

The SAHAUHY 80-Pint Dehumidifier is designed to efficiently remove moisture from the air in spaces up to 5200 square feet. It features a compact and portable design with built-in handles and smooth-rolling casters for easy movement. The unit operates quietly, producing less than 35 decibels of sound.



Figure 1: Front view of the SAHAUHY 80-Pint Dehumidifier, showing the digital display and water level indicator.

Key features include multiple fan speeds, adjustable humidity settings, and a removable water tank with an auto-shutoff function when full. The unit is capable of removing up to 80 pints of moisture per day under specific conditions (95°F, 90% RH).



Figure 2: Diagram illustrating the internal components and highlighting the 80 pints/day capacity and 5,200 sq. ft. coverage area.

SETUP

1. **Unpacking:** Carefully remove the dehumidifier from its packaging. Remove all packing materials, including any tape or protective films.
2. **Placement:** Place the dehumidifier on a firm, level surface in an area where the temperature will not fall below 41°F (5°C) or rise above 95°F (35°C). Ensure there is at least 8 inches (20 cm) of space on all sides of the unit for proper air circulation. Do not block the air inlet or outlet.
3. **Power Connection:** Plug the power cord into a grounded 120V/60Hz electrical outlet. Do not use an extension cord.
4. **Initial Operation:** Allow the unit to stand upright for at least 24 hours before plugging it in and operating it, especially if it was not stored or transported in an upright position. This allows the refrigerant to settle.

OPERATING INSTRUCTIONS

Control Panel

The control panel is located on the top of the unit and features various buttons and a digital display for setting and monitoring humidity levels and operating modes. Refer to the labels on the control panel for specific button functions.

Power On/Off

Press the Power button to turn the unit on or off.

Setting Desired Humidity Level

Use the humidity setting buttons (usually '+' and '-') to adjust the desired humidity level between 30% and 80% relative humidity (RH) in 5% increments. The unit will operate until the set humidity level is reached, then cycle on and off to maintain it.

Fan Speed

Select between different fan speeds (e.g., Low, High) to control the airflow. Higher fan speed results in faster dehumidification but may produce more noise.

Operation Modes

The dehumidifier offers several pre-programmed modes to suit different environments:

4 Modes to Suit Your Needs

Living Area Mode



Sleeping Area Mode



Basement Mode



Continuous Mode



Figure 3: Illustration of the four available operation modes and their typical applications.

- **Living Area Mode:** Optimized for general living spaces to maintain comfortable humidity.
- **Sleeping Area Mode:** Operates at a lower fan speed for quieter performance, suitable for bedrooms.
- **Basement Mode:** Designed for higher humidity environments like basements, often targeting lower humidity levels.
- **Continuous Mode:** The unit will run continuously regardless of the ambient humidity level until the water tank is full or continuous drainage is enabled.

Water Drainage Options

Your dehumidifier offers three methods for water removal:

Optional Draining Methods

Three drainage methods can be chosen according to the effect you want, how convenient!



Manual Draining
1.14 gallon water tank



Automatic Drainage
3.28 ft drain hose
(Include)



Portable Drainage
Compatible with garden
hose(Not Include)

Automatic drainage hose connection precautions

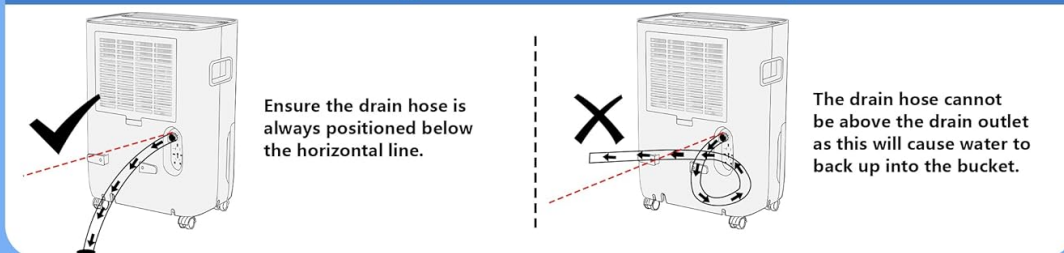

Figure 4: Visual guide to the three drainage methods: Manual, Automatic, and Portable.

- **Manual Draining:** When the water tank is full, the unit will automatically shut off and an indicator light will illuminate. Carefully remove the water tank from the front of the unit and empty the collected water. Reinsert the tank securely to resume operation. The tank capacity is approximately 1.14 gallons.
- **Automatic Drainage:** For continuous operation without emptying the tank, connect the included 3.28 ft drain hose to the continuous drain outlet on the back of the unit. Ensure the hose is positioned downwards and leads to a floor drain or suitable receptacle. The drain hose must always be positioned below the drain outlet to allow gravity flow. Do not allow the hose to rise above the drain outlet, as this will cause water to back up into the bucket.
- **Portable Drainage:** This method is compatible with a standard garden hose (not included). Connect a garden hose to the designated outlet for continuous drainage into a larger drain or outdoor area. Follow the same precautions as automatic drainage regarding hose positioning.

MAINTENANCE

Regular maintenance ensures optimal performance and extends the lifespan of your dehumidifier.

Cleaning the Air Filter

The air filter should be cleaned every two weeks or more frequently depending on usage and air quality. A

dirty filter can reduce efficiency and cause the unit to work harder.

1. Turn off the dehumidifier and unplug it from the power outlet.
2. Remove the air filter from the back or side of the unit (refer to your unit's specific design).
3. Wash the filter with warm, soapy water. Rinse thoroughly and allow it to air dry completely before reinserting. Do not use a dishwasher.
4. Reinstall the dry filter into the unit.

Cleaning the Water Tank

Clean the water tank periodically to prevent mold and mildew growth.

1. Remove the water tank from the unit.
2. Wash the tank with warm water and a mild detergent.
3. Rinse thoroughly and dry before placing it back into the dehumidifier.

Storage

If the unit will not be used for an extended period:

1. Empty and clean the water tank.
2. Clean the air filter.
3. Unplug the unit and coil the power cord.
4. Store the unit upright in a cool, dry place, away from direct sunlight and extreme temperatures.

TROUBLESHOOTING

Before contacting customer support, please refer to the following troubleshooting guide for common issues.

Problem	Possible Cause	Solution
Unit does not turn on.	No power; Power cord loose; Water tank full or not properly seated.	Check power connection; Ensure tank is empty and correctly inserted.
No water collected.	Humidity setting too high; Room temperature too low; Air filter clogged; Continuous drain hose connected.	Lower humidity setting; Ensure room temp is above 41°F; Clean air filter; Check continuous drain setup.
Unit runs constantly.	Continuous mode selected; Humidity setting too low for current conditions; Room size too large.	Select a specific humidity mode; Increase humidity setting; Consider if unit is appropriate for space.
Unit is noisy.	Fan speed set to high; Unit not on a level surface; Obstruction in fan.	Reduce fan speed; Place on a level surface; Check for obstructions.
Frost on coils.	Room temperature too low.	Move unit to a warmer room or allow it to defrost naturally.

SPECIFICATIONS

- **Model Number:** WTE80P-025P

- **Product Dimensions:** 9.84 x 13.39 x 19.29 inches
- **Item Weight:** 30 pounds
- **Dehumidification Capacity:** 80 Pints/day (at 95°F, 90% RH)
- **Coverage Area:** Up to 5200 Square feet
- **Included Components:** Dehumidifier, 3.28 ft drain hose
- **Noise Level:** Less than 35 decibels

WARRANTY AND SUPPORT





Warranty Information

This SAHAUHY dehumidifier includes a **2-year warranty for the compressor** from the date of purchase. Please retain your proof of purchase for warranty claims. The warranty covers defects in materials and workmanship under normal use. It does not cover damage resulting from misuse, accident, alteration, or unauthorized repair.

Customer Support

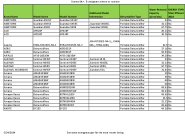
If you have any questions, require technical assistance, or need to make a warranty claim, please contact SAHAUHY customer support. Refer to the contact information provided with your product packaging or visit the official SAHAUHY website for support details.

Related Documents - WTE80P-025P

	<p>ENERGY STAR Certified Residential Dehumidifier Qualifying Product List</p> <p>A comprehensive list of ENERGY STAR certified residential dehumidifiers, including brand, model, capacity, and efficiency ratings for 2024.</p>
	<p>H.B. Abrams Wind Controller Models - Industrial and Fountain Automation</p> <p>H.B. Abrams Company offers a range of wind velocity activated control systems designed for various applications including fountains, irrigation, and crane operations. These electronic devices monitor wind speed and activate relay outputs based on preset conditions. Models include single-stage, dual-stage, multi-stage, analog output, and delayed trip configurations, all featuring a standard 0-30 MPH wind speed indicator and 120VAC input. Optional anemometer sensors are available.</p>
	<p>Skoda Trinity Anthracite Grey Alloy Wheel 7J x 18" ET 45 - Fitting Instructions</p> <p>Official fitting instructions for the Skoda Trinity brushed alloy wheel in anthracite grey (7J x 18" ET 45). Includes important information on wheel bolt tightening torque, installation, and compatibility for Skoda vehicles like the Karoq (NU).</p>
	<p>Master MFG 2023 Catalog: Sprayers, Pumps, and Accessories</p> <p>Explore the comprehensive 2023 catalog from Master MFG, featuring a wide range of high-quality sprayers, pumps, boom kits, nozzles, spray guns, and accessories for agricultural, lawn care, and industrial applications. Includes Li-Ion powered, ATV, trailer, UTV, and specialty models.</p>



[Awards and Trophies Catalog - Corporate Recognition and Gifts](#)

Comprehensive catalog featuring a wide range of awards, trophies, plaques, crystal, acrylic, and polyester recognition items for corporate events and employee appreciation.