

[Manuals.plus](#) /

› [Lehoo Castle](#) /

› Lehoo Castle Dinosaur Baby Bath Bubble Machine (Model BT-006) User Manual

## Lehoo Castle BT-006

# Lehoo Castle Dinosaur Baby Bath Bubble Machine (Model BT-006) User Manual

Enhancing bath time with fun and bubbles.

---

## 1. PRODUCT OVERVIEW

---

The Lehoo Castle Dinosaur Baby Bath Bubble Machine is designed to make bath time an enjoyable experience for toddlers. This automatic bubble maker features a dinosaur design, produces a steady stream of bubbles, and includes 12 melodies for entertainment. It is built with safety and durability in mind, featuring waterproof construction and strong suction cups for secure attachment to various smooth surfaces.



Figure 1: Lehoo Castle Dinosaur Baby Bath Bubble Machine (Green model).

## 2. WHAT'S IN THE BOX

Upon opening your Lehoo Castle Dinosaur Baby Bath Bubble Machine package, you should find the following components:

- 1 x Bubble Machine (Dinosaur design)
- 1 x Stirring Rod
- 5 x Suction Cups
- 1 x User Instructions (This manual)
- 1 x Silicone Cup

# KIT CONTENTS & SIZE



Figure 2: All components included in the Lehou Castle Dinosaur Baby Bath Bubble Machine package.

### 3. SAFETY INFORMATION

- Ensure the battery compartment is securely closed and sealed with the upgraded silicone ring to prevent water ingress.
- Always use new batteries for optimal performance and safety.
- The product is designed with high-quality, waterproof construction (IP6 rated) and no sharp edges or small parts to ensure toddler safety.
- Adult supervision is recommended during bath time play.
- Do not submerge the entire unit in water. It is designed to be attached to the bathtub wall.



**Upgraded silicone ring protects the battery compartment from water.**

Figure 3: The upgraded silicone ring provides enhanced water protection for the battery compartment.

#### 4. SETUP

1. **Install Batteries:** Open the battery compartment on the back of the bubble machine using a screwdriver. Insert 2 x AA batteries (not included), ensuring correct polarity. Securely close the compartment, making sure the silicone ring is properly seated to maintain waterproofing.
2. **Attach Suction Cups:** Insert the five provided suction cups into the designated holes on the back of the bubble machine.
3. **Mount the Machine:** Choose a smooth, clean surface on your bathtub wall (e.g., ceramic tile, bathtub surface, glass). Press the bubble machine firmly against the surface to ensure the suction cups create a strong seal.
4. **Prepare Bubble Solution:** Use the included silicone cup. Add a small amount of regular body wash or baby shampoo, then fill the cup with water. Use the stirring rod to gently mix the solution until it is well combined.
5. **Pour Solution:** Carefully pour the prepared bubble solution into the mouth of the dinosaur bubble machine. The machine has a 250ml capacity.

# LESS STEPS & MORE FUN

1



Add Water & Shower Gel

2

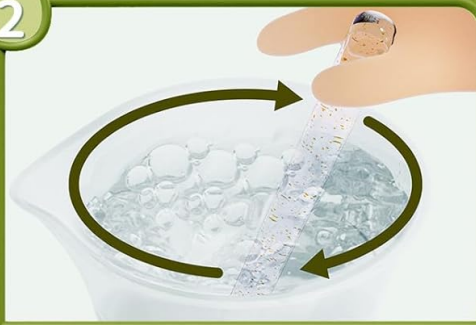

Stir the Mixture

3



Pour in Bubble Mixture

4



Press the Switch



Using silicone cups avoids the troublesome step of removing the container.

Figure 4: Simple steps for preparing the bubble solution and filling the machine.



Figure 5: The strong suction cups ensure secure attachment to smooth surfaces.

Your browser does not support the video tag.

Video 1: Official demonstration of the Lehou Castle Dinosaur Baby Bath Toys, showing setup and operation.

## 5. OPERATING INSTRUCTIONS

The Lehou Castle Dinosaur Baby Bath Bubble Machine offers two distinct play modes:

1. **Music & Bubbles Mode:** Press the ON/OFF button once to activate both the 12 melodies and continuous bubble production.
2. **Bubbles-Only Mode:** Press the ON/OFF button a second time to switch to bubbles-only mode, where the music will stop but bubbles will continue.
3. **Turn Off:** Press the ON/OFF button a third time to turn off all functions of the bubble machine.

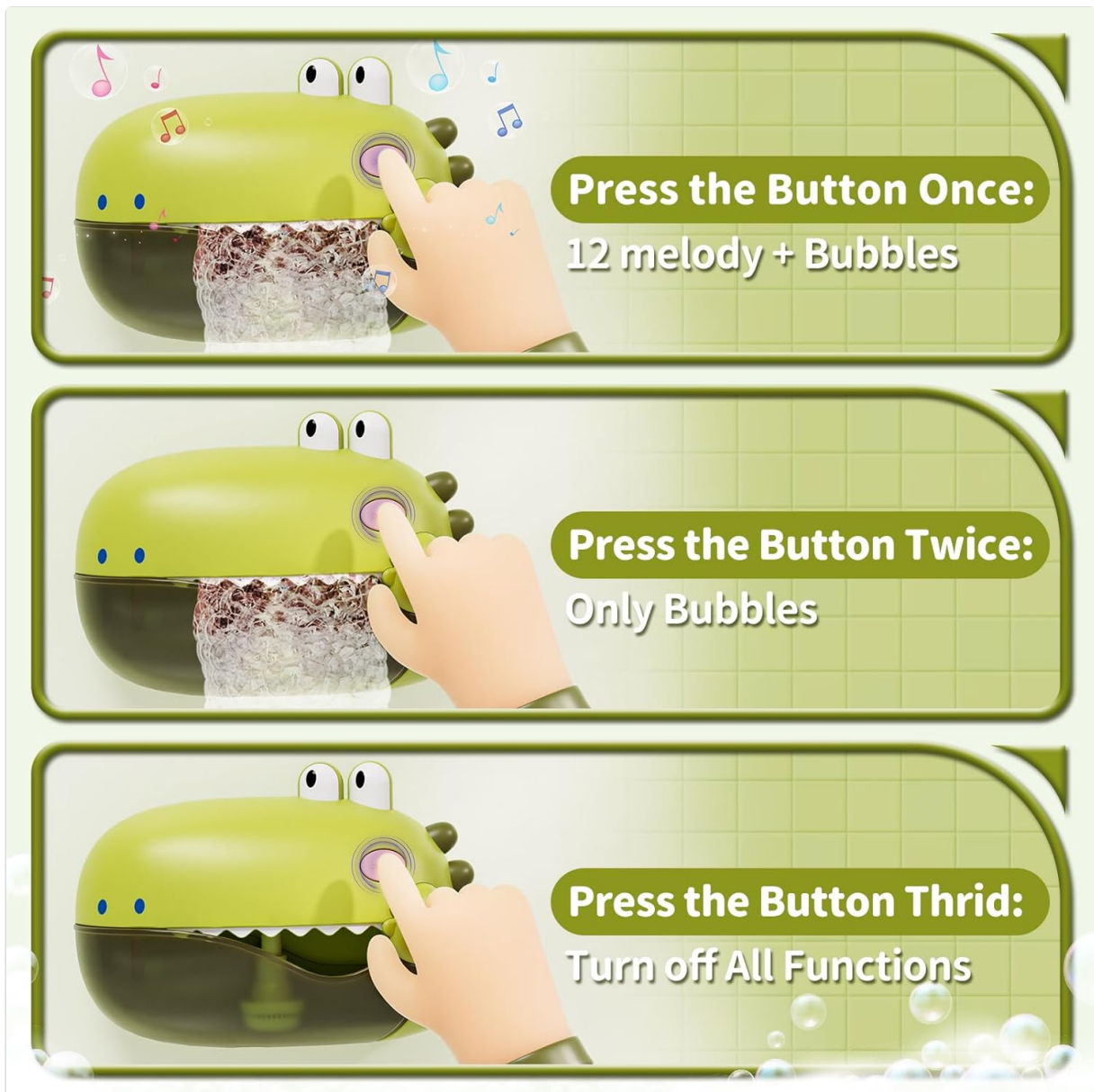

Figure 6: Operating modes for the bubble machine.

Your browser does not support the video tag.

Video 2: Demonstration of the Dinosaur Bath Bubble Machine in action, showing bubble output.

## 6. MAINTENANCE

To ensure the longevity and proper functioning of your bubble machine, follow these maintenance tips:

- **Regular Cleaning:** After each use, remove the lower transparent part of the dinosaur's mouth. Empty any remaining bubble solution and rinse both parts thoroughly with clean water. Wipe dry before reassembling.
- **Battery Care:** If the machine will not be used for an extended period, remove the batteries to prevent leakage and corrosion.
- **Storage:** Store the bubble machine in a dry place away from direct sunlight when not in use.

## 7. TROUBLESHOOTING

Problem	Possible Cause	Solution
---------	----------------	----------

<b>Problem</b>	<b>Possible Cause</b>	<b>Solution</b>
No bubbles are produced.	Low battery, insufficient bubble solution, or incorrect solution mixture.	Replace batteries with new ones. Ensure enough bubble solution is in the reservoir. Adjust the ratio of body wash/shampoo to water.
Music is not playing.	Machine is in 'Bubbles-Only' mode or batteries are low.	Press the ON/OFF button once to switch to 'Music & Bubbles' mode. Replace batteries if needed.
Machine does not stick to the wall.	Surface is not smooth, dirty, or suction cups are damaged.	Ensure the surface is clean, dry, and smooth. Moisten suction cups slightly before applying. Replace damaged suction cups if necessary.
Loud noise during operation.	Normal operating sound or internal obstruction.	A slight motor sound is normal. If the noise is excessive, ensure no foreign objects are obstructing the bubble-making mechanism.

## 8. SPECIFICATIONS

- **Model Number:** BT-006
- **Product Dimensions:** 6.3 x 8.66 x 3.58 inches
- **Item Weight:** 1.03 pounds
- **Material:** High-quality, durable plastic
- **Waterproof Rating:** IP6
- **Recommended Age:** 18 months and up
- **Bubble Solution Capacity:** 250ml
- **Power Source:** 2 x AA batteries (not included)



Figure 7: Kit contents and dimensions of the bubble machine.

## 9. WARRANTY AND SUPPORT

Lehoo Castle is committed to providing high-quality products. For any questions, concerns, or support regarding your Dinosaur Baby Bath Bubble Machine, please contact Lehoo Castle customer service through the retailer's platform where the product was purchased. Please retain your proof of purchase for any warranty claims.