

## Manuals+

[Q & A](#) | [Deep Search](#) | [Upload](#)

manuals.plus /

› [Donpidd](#) /

› [Cartablet Pro Max 2025 Model User Manual](#)

## Donpidd Cartablet Pro Max 2025 Model (Drivewiz CarPlay Pro)

# Cartablet Pro Max 2025 Model User Manual

Model: Drivewiz CarPlay Pro | Brand: Donpidd

## 1. INTRODUCTION

This manual provides detailed instructions for the installation, operation, maintenance, and troubleshooting of your Donpidd Cartablet Pro Max 2025 Model. Please read this manual thoroughly before using the device to ensure proper functionality and safety. Keep this manual for future reference.

## 2. PRODUCT OVERVIEW

### 2.1 Key Features

- **Wireless Connectivity:** Seamless integration with Bluetooth, AUX, and FM transmitter options.
- **Voice Control & Navigation:** Hands-free operation for navigation, calls, messages, and music.
- **Dual Camera System:** Equipped with a 4K front camera and a 1080p rearview backup camera for comprehensive recording.
- **10.26-Inch IPS HD Touch Screen:** Crystal-clear and responsive display for intuitive control.
- **Easy Installation & Broad Compatibility:** Simple setup via Type-C connection (12-32V) compatible with most cars and trucks.

### 2.2 Package Contents

Upon opening the package, please verify that all components are present:

- Cartablet Pro Max 2025 Model Main Unit
- 4K Front Dash Camera
- 1080p Rearview Backup Camera
- 128GB MicroSD Card
- Power Cable (Type-C, 12-32V)
- Rear Camera Connection Cable
- Mounting Accessories (e.g., dashboard mount, windshield mount)
- User Manual (this document)



Figure 2.1: Complete package contents of the Cartablet Pro Max 2025 Model.

### 3. SETUP AND INSTALLATION

#### 3.1 Mounting the Main Unit

The Cartablet Pro Max 2025 Model offers flexible installation options to suit your vehicle's interior. Choose between windshield, dashboard, or air outlet mounting.

- **Windshield Installation:** Attach the suction cup mount to a clean, smooth area of your windshield that does not obstruct your view.
- **Dashboard Installation:** Use the adhesive base to secure the unit to a flat, stable surface on your dashboard.
- **Air Outlet Installation:** Utilize the clip mount to attach the unit to a compatible air vent.



Figure 3.1: Various mounting options for the main unit.

### 3.2 Camera Installation

Install the front dash camera and the rearview backup camera for comprehensive recording and parking assistance.

1. **Front Dash Camera:** The front camera is integrated into the main unit. Ensure the unit is positioned to capture a clear view of the road ahead.
2. **Rearview Backup Camera:** Mount the rearview camera at the rear of your vehicle, typically above the license plate or near the trunk handle. Ensure it has a clear view of the area behind the vehicle.
3. **Wiring the Rear Camera:** Connect the rear camera cable to the main unit. For automatic display of the rearview when reversing, connect the red wire of the rear camera cable to the positive pole of your vehicle's reverse light.

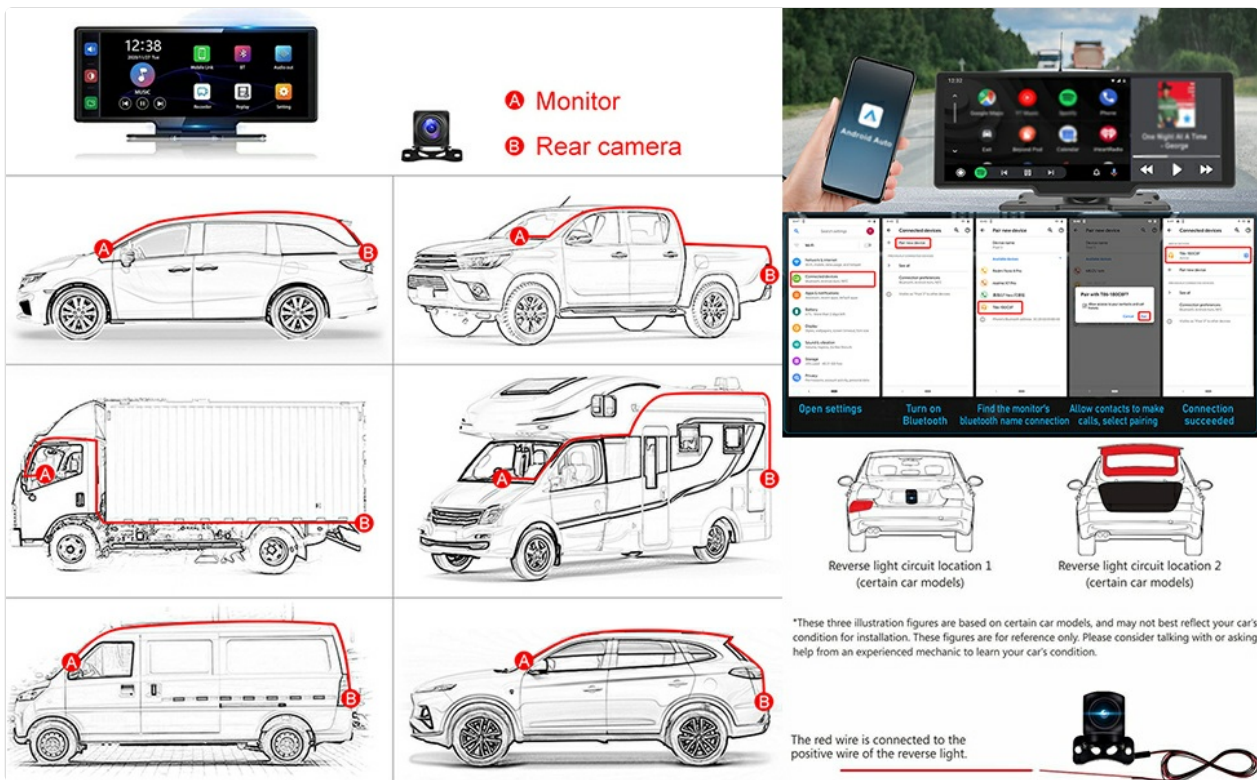

Figure 3.2: Rear camera installation and wiring diagrams for various vehicle types.

### 3.3 Power Connection

Connect the provided Type-C power cable to the main unit and plug the other end into your vehicle's 12-32V power outlet (cigarette lighter socket). The device will power on automatically when the vehicle starts.

## 4. OPERATING INSTRUCTIONS

### 4.1 Power On/Off

- **Power On:** The device powers on automatically when connected to vehicle power and the ignition is turned on.
- **Power Off:** The device powers off automatically when the vehicle's ignition is turned off. You can also manually turn it off by pressing and holding the power button.

### 4.2 Touch Screen Operation

The 10.26-inch IPS HD touch screen provides intuitive control over all functions. Tap icons to open applications, swipe to navigate menus, and use pinch-to-zoom gestures where applicable.



Figure 4.1: Touch screen interface with key connectivity options.

### 4.3 Wireless Connectivity

- **Bluetooth:** Pair your smartphone via Bluetooth 5.0 for hands-free calling, music streaming, and contact synchronization.
- **Wi-Fi:** Connect to a Wi-Fi hotspot for online navigation, app updates, and other internet-dependent features.
- **FM Transmitter:** Transmit audio from the device to your car's FM radio for sound output through your vehicle's speakers.
- **Screen Mirroring:** Project your smartphone screen (Android or iOS) onto the Cartablet display for enhanced viewing.

# Carplay Car Mode

Wired/wireless connection



## 10.26 inch HD screen (IPS)

Display Resolution: 1600\*600



## Smart Bluetooth

5.0 version bluetooth chip



Figure 4.2: Overview of CarPlay, screen, and Bluetooth features.

### 4.4 Voice Control

Utilize voice commands to control various functions without taking your hands off the wheel. Simply activate the voice assistant and speak your command.

- Example commands: "Open Screen", "Open Video", "Turn off screen".

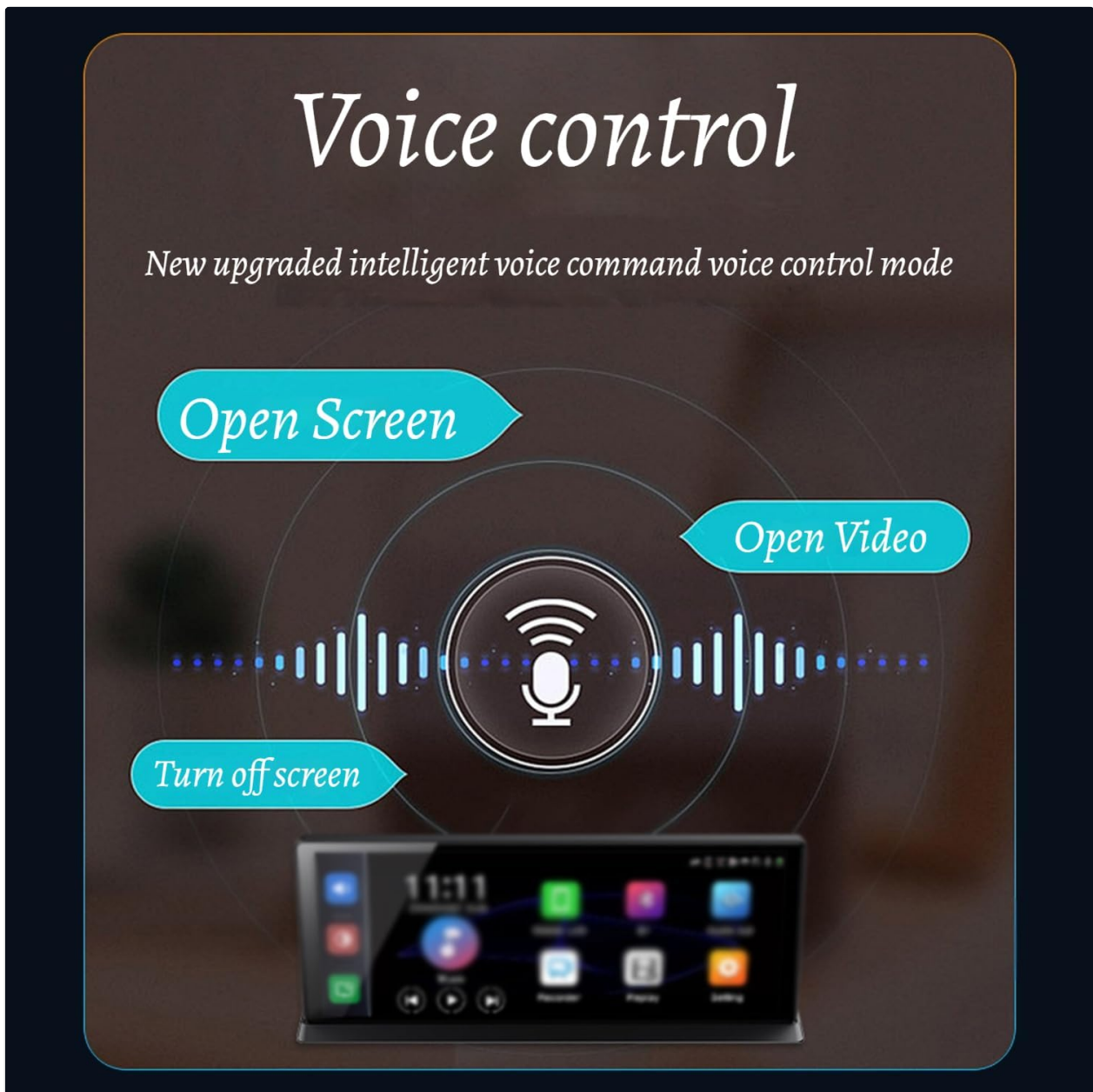

Figure 4.3: Voice control functionality.

## 4.5 Dash Cam Operation

The integrated dash cam system provides continuous recording for both front and rear views.

- **Dual-Screen Recording:** Simultaneously records 4K video from the front camera and 1080p video from the rear camera.
- **Loop Recording:** Automatically overwrites the oldest footage when the memory card is full, ensuring continuous recording.
- **G-Sensor (Gravity Sensing):** Detects sudden impacts or collisions. In such events, the system automatically locks and saves the current recording to prevent it from being overwritten.

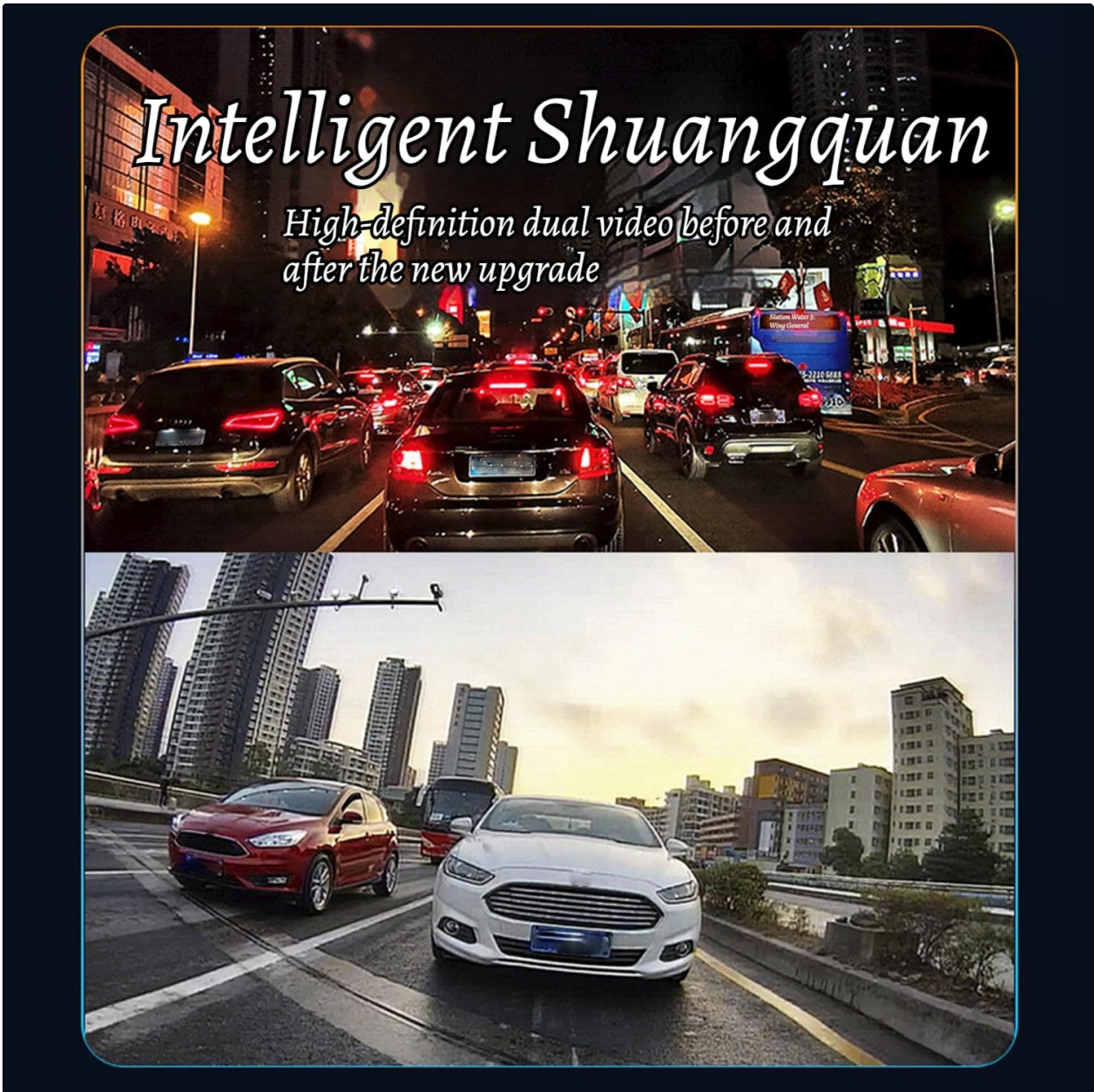

Figure 4.4: Dual camera recording view.

# Shrinkage Recording

*Smarter release of memory cache pressure*



Figure 4.5: Loop recording functionality.

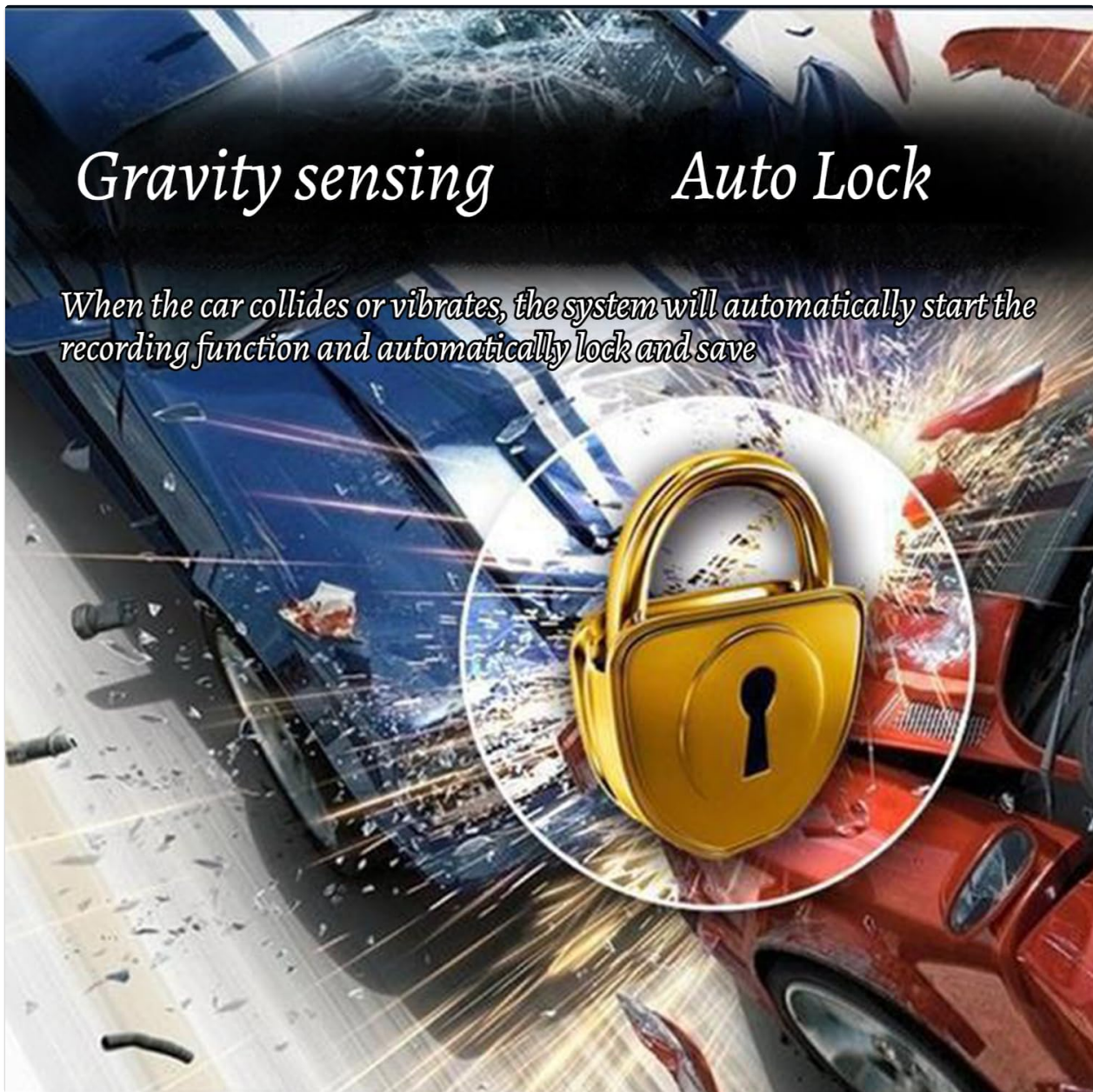

Figure 4.6: G-Sensor and Auto Lock feature.

#### **4.6 GPS Navigation**

The device supports real-time GPS navigation. Ensure the device has a clear view of the sky for optimal satellite reception. Navigation apps can be accessed via the touch screen.

#### **4.7 Multimedia Playback**

Play music, videos, and view photos directly on the device. The system supports multimedia playback from the inserted MicroSD card. Audio can be output through the device's own speaker, AUX cable, or via FM transmission to your car's stereo.



Figure 4.7: Multimedia and audio output options.

## 5. MAINTENANCE

### 5.1 Cleaning

- **Screen:** Use a soft, lint-free cloth to gently wipe the screen. For stubborn smudges, slightly dampen the cloth with water or a screen cleaner. Avoid abrasive materials or harsh chemicals.
- **Lenses:** Carefully clean the camera lenses with a lens cleaning cloth to ensure clear recording quality. Do not touch the lenses directly with your fingers.

### 5.2 MicroSD Card Management

- Regularly format the MicroSD card (at least once a month) to maintain optimal recording performance and prevent data corruption.
- Use a high-quality MicroSD card (Class 10 or higher) for reliable recording.

### 5.3 Firmware Updates

Periodically check the manufacturer's website for available firmware updates. Updates can improve performance, add new features, or fix bugs. Follow the instructions provided with the update file carefully.

## 6. TROUBLESHOOTING

If you encounter issues with your Cartablet Pro Max 2025 Model, please refer to the following common problems and solutions:

Problem	Possible Cause	Solution
---------	----------------	----------

Problem	Possible Cause	Solution
Device does not power on.	No power connection; vehicle power outlet issue.	Ensure power cable is securely connected. Check vehicle's power outlet fuse.
Screen is unresponsive.	Temporary software glitch; screen protector interference.	Restart the device. Remove and reapply screen protector if applicable.
Cameras not recording or footage is unclear.	MicroSD card issue; dirty lenses; incorrect settings.	Format the MicroSD card. Clean camera lenses. Check recording settings.
No audio output.	Volume too low; incorrect audio output mode.	Increase volume. Verify selected audio output (internal speaker, AUX, FM).
GPS signal is weak or lost.	Obstructed view of sky; device interference.	Relocate device for clearer sky view. Avoid placing near other electronic devices.

If the problem persists after trying these solutions, please contact customer support.

## 7. SPECIFICATIONS

Feature	Specification
Model Name	Cartablet Pro Max 2025 Model
Item Model Number	Drivewiz CarPlay Pro
Display Size	10.26 Inches IPS HD Touch Screen
Front Camera Resolution	4K
Rear Camera Resolution	1080p
Connectivity Technology	Bluetooth 5.0, Wi-Fi, FM Transmitter, AUX
Operating System Compatibility	Android, iOS (for screen mirroring)
Power Input	Type-C, 12-32V
Mounting Type	Dashboard Mount, Windshield Mount, Air Outlet Mount
Vehicle Service Type	Car, Truck

## 8. WARRANTY INFORMATION

The Donpidd Cartablet Pro Max 2025 Model comes with a **3-year warranty** from the date of purchase. This warranty covers manufacturing defects and malfunctions under normal use. It does not cover damage caused by misuse, accidents, unauthorized modifications, or improper installation.

Please retain your proof of purchase for warranty claims.

## 9. SUPPORT

For further assistance, technical support, or warranty claims, please contact Donpidd customer service through the following channels:

- **Website:** Visit the official Donpidd website for FAQs, driver downloads, and support resources.
- **Email:** Refer to your product packaging or the official website for customer support email addresses.
- **Online Retailer:** Contact the seller through the platform where you purchased the product.

© 2025 Donpidd. All rights reserved.