



[Manuals.plus](#) /

› [BIWIBON](#) /

› BIWIBON Fingerprint Door Lock User Manual

## BIWIBON BCA-02

# BIWIBON Fingerprint Door Lock User Manual

Model: BCA-02

## INTRODUCTION

---

This manual provides comprehensive instructions for the installation, operation, and maintenance of your BIWIBON Fingerprint Door Lock (Model BCA-02). This smart door knob offers multiple access methods including fingerprint recognition, mobile application control, entry codes, IC cards, and traditional mechanical keys. For enhanced functionality, voice activation via Alexa or Google Home is available with an optional BIWIBON gateway (sold separately).



Image: The BIWIBON Fingerprint Door Lock in gold, showcasing its various components and access methods.

## SETUP AND INSTALLATION

### Package Contents

Before beginning installation, verify that all components are present in the package:

- 1 Front Lever
- 1 Rear Handle
- 1 Adjustable Latch
- 1 Strike Plate and Reinforcer
- 2 Mechanical Keys
- 2 IC Cards
- 1 Spindle
- 2 Threaded Pillars
- Screws

- 1 Type-C Cable
- 1 User Manual (this document)
- 1 Drill Template
- 1 Spare Package

## Door Compatibility

The BIWIBON Fingerprint Door Lock is designed for compatibility with most standard American wooden doors. It can be installed on both left-handed and right-handed doors without requiring additional adjustments.



Image: Door and lock dimensions for installation reference.

## Installation Steps

Installation typically involves replacing an existing door handle or knob using a basic screwdriver. No extra drilling or specialized tools are generally required. Refer to the included drill template for precise measurements if a new installation is necessary.

1. Remove your existing door handle or knob.
2. Install the adjustable latch into the door edge.
3. Mount the exterior lever assembly, ensuring the spindle is correctly aligned.
4. Install the interior handle assembly, connecting any necessary cables.
5. Secure all components with the provided screws.
6. Insert 4 AAA batteries into the designated compartment (batteries not included).

**Note:** Ensure the lock is properly aligned and operates smoothly before closing the door completely.

### **Initial Configuration (App Pairing)**

To utilize smart features, download the BIWIBON application from your device's app store. Follow the in-app instructions to pair your lock via Bluetooth and begin adding users, fingerprints, and passcodes.

## **OPERATING INSTRUCTIONS**

---

The BIWIBON Fingerprint Door Lock offers multiple methods for access and control:

# Fingerprint Door Lock Multiple Ways to Unlock

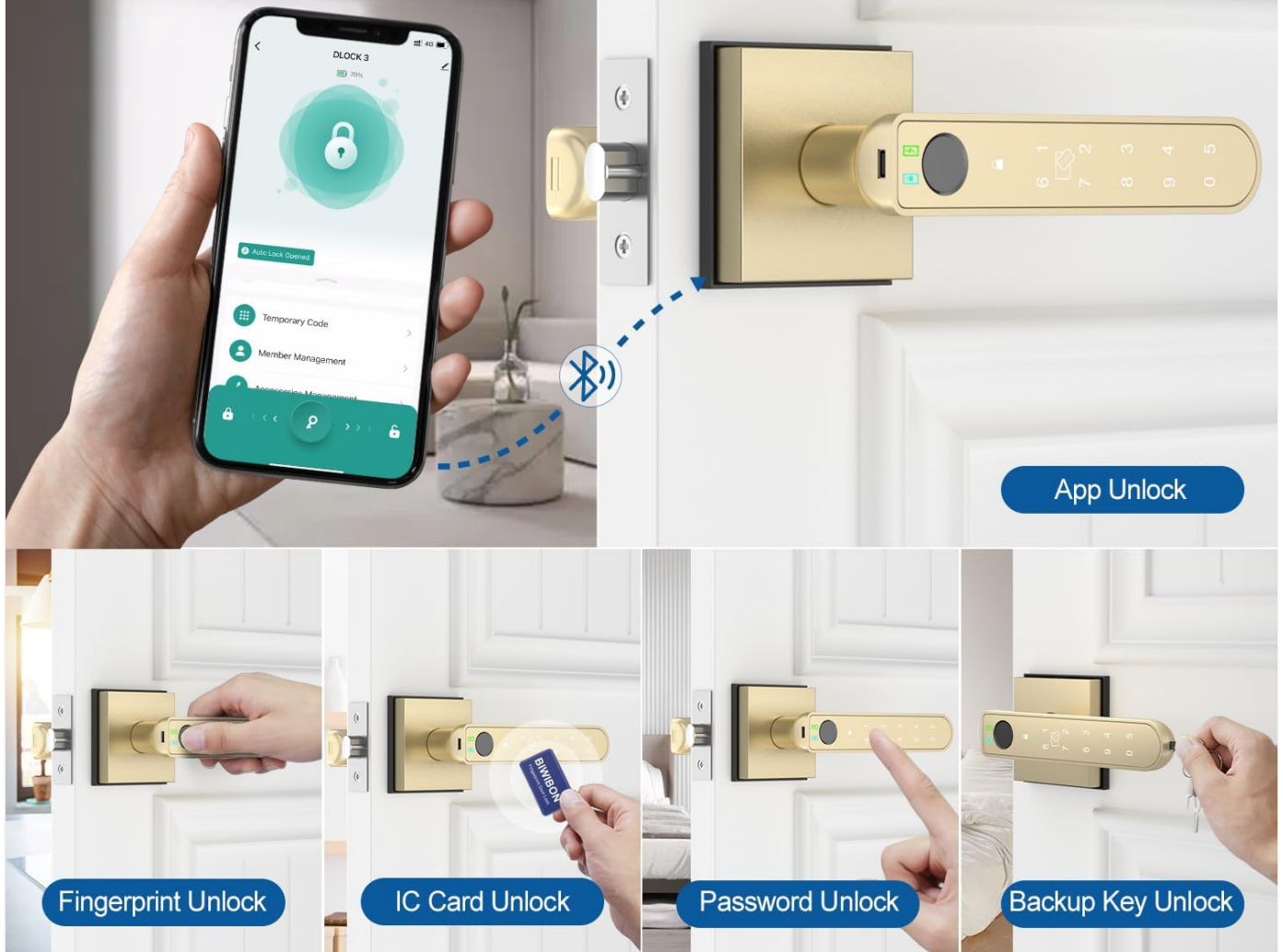

Image: Visual representation of the five primary unlocking methods.

## 1. Fingerprint Unlock

The lock features an advanced 508 DPI fingerprint sensor with a 160 x 160 effective pixel resolution, allowing for over 99% recognition accuracy in approximately 0.2 seconds. To unlock, place your registered finger on the sensor. The lock will disengage upon successful recognition.

- **Adding Fingerprints:** Use the mobile application to register new fingerprints. Follow the on-screen prompts for multiple scans to ensure accurate recognition.
- **Capacity:** The lock supports up to 100 unique fingerprints.

## 2. Mobile App Control

The BIWIBON app provides comprehensive control over your lock. Connect via Bluetooth for local control or integrate with a BIWIBON Gateway (sold separately) for remote access.

# APP Smart Control



Keyless Entry



Share Access



Auto Lock



Generate Passcode

Remotely



View History

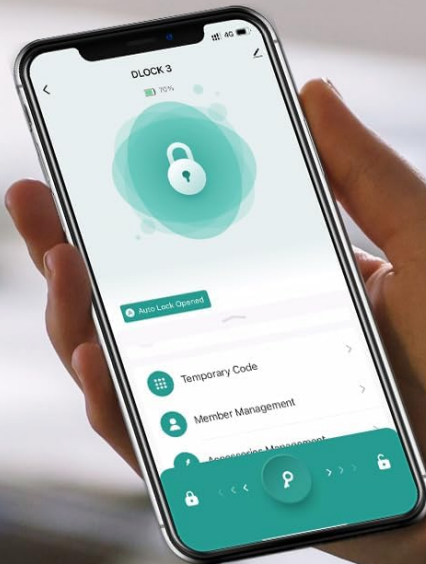

*Image: BIWIBON app interface demonstrating smart control features.*

- **Keyless Entry:** Unlock the door directly from the app.
- **Share Access:** Grant temporary or permanent access to others.
- **Auto Lock:** Configure automatic locking after a set duration.
- **Generate Passcode Remotely:** Create and send time-limited, one-time, or dynamic codes from anywhere (requires Gateway).
- **View History:** Monitor access records and unlock events (requires Gateway for remote viewing).

### 3. Entry Codes (Password Unlock)

Use the integrated touchscreen keypad to enter a numerical passcode. The lock supports up to 100 different passwords.

# Tailored Password Solutions for Every Need

## Time-Limited Code:

Active Only Within Your Specified Date and Time

## Dynamic Code:

Multiple Uses Within 5 Minutes After Activation

## One-Time Code:

Valid for a Single Use Within 6 Hours Before Expiration

## Custom Permanent Code:

Create a Code You Can Use Anytime

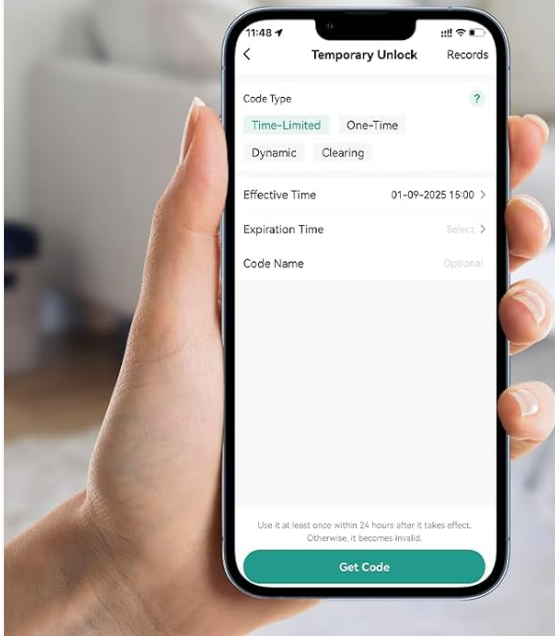

Image: Tailored password solutions for various access needs.

- **Anti-Peeping Feature:** To prevent others from observing your code, you can enter random digits before and after your actual passcode. For example, if your code is 123456, you can enter 987**123456**321.
- **Code Types:**
  - **Time-Limited Code:** Active only within a specified date and time range.
  - **Dynamic Code:** Multiple uses within 5 minutes after activation.
  - **One-Time Code:** Valid for a single use within 6 hours before expiration.
  - **Custom Permanent Code:** A code you can use anytime.

## 4. IC Card Unlock

Tap a registered IC card against the designated area on the lock to gain access. The lock supports up to 100 IC cards.

- **Adding IC Cards:** Use the mobile application to register new IC cards.

## 5. Mechanical Key Unlock

For traditional access or in emergency situations, use the provided mechanical backup keys to unlock the door.

### **Optional: Voice Control (Requires BIWIBON Gateway)**

When paired with a BIWIBON Gateway (sold separately), the lock can be integrated with smart home assistants like Amazon Alexa or Google Home for voice-activated unlocking.



*Image: Voice control integration with smart home assistants via BIWIBON Gateway.*

### **Passage Mode**

Activate Passage Mode via the mobile app to keep the door unlocked for extended periods, useful during gatherings or when frequent entry/exit is required. The lock will remain disengaged until Passage Mode is manually deactivated.

## **MAINTENANCE**

---

### **Battery Replacement**

The lock requires 4 AAA batteries. When the battery level is low, the lock will provide warning signals (e.g., indicator light, app notification). Replace all four batteries promptly to ensure continuous operation.

# Peace of Mind with BIWIBON Biometric Door Lock

## Unlocking Your Smart Fingerprint Door Lock with a Dead Battery:

- Replace the battery when the low warning signals.
- Emergency Power: Use an external power bank for unlocking, not charging.
- Keep your spare keys within reach.

Power Bank as Backup Power(NOT INCLUDED)

Low Battery Alert

Mechanical Backup Keys

Image: Emergency power options and mechanical backup keys.

## Emergency Power

If the batteries are completely depleted, the lock can be temporarily powered using an external power bank connected via the Type-C port. This provides power for unlocking but does not charge the internal batteries. Always keep your mechanical backup keys accessible for such situations.

## Cleaning

Wipe the lock's surface with a soft, dry cloth. Avoid using abrasive cleaners or solvents that could damage the finish or electronic components.

## TROUBLESHOOTING

Problem	Possible Cause	Solution
---------	----------------	----------

Problem	Possible Cause	Solution
Lock does not respond.	Depleted batteries.	Replace all 4 AAA batteries. Use emergency power via Type-C port if necessary.
Fingerprint not recognized.	Incorrect finger placement; dirty sensor; unregistered fingerprint.	Ensure finger is clean and dry. Place entire pad of registered finger firmly on sensor. Re-register fingerprint if issues persist.
App cannot connect to lock.	Bluetooth disabled; lock out of range; app malfunction.	Ensure Bluetooth is enabled on your phone. Move closer to the lock. Restart the app or your phone. Check lock batteries.
Keypad unresponsive or code not working.	Incorrect code; keypad dirty; battery issue.	Verify the correct passcode. Clean the keypad surface. Check battery level.
Lock mechanism is stiff or not engaging.	Misalignment during installation; obstruction.	Check installation alignment. Ensure no obstructions are preventing the latch from extending or retracting fully.

If you encounter issues not listed here or if the suggested solutions do not resolve the problem, please contact BIWIBON customer support.

## SPECIFICATIONS

Feature	Detail
Brand	BIWIBON
Model Name	BCA-02 App Control Fingerprint Door Lock with Keypad
Lock Type	Biometric
Material	Aluminum
Color	Gold
Finish Type	Polished
Item Dimensions (L x W x H)	5.6 x 2.75 x 2.75 inches
Item Weight	1.79 pounds (0.81 Kilograms)
Control Method	App, Touch, Voice (with Gateway)
Special Features	Auto-Lock Delay Setting, Electronic Anti-Lock (from Inside), Time-Limited Code, One-Time Code, Dynamic Code, Large Capacity (100 Fingerprints, 100 IC Cards, 100 Passwords)
Batteries Required	4 AAA batteries (Alkaline recommended, not included)
Fingerprint Sensor	508 DPI, 160 x 160 effective pixel resolution

## WARRANTY INFORMATION

---

BIWIBON products are manufactured to high-quality standards. For specific warranty details regarding your Fingerprint Door Lock (Model BCA-02), please refer to the warranty card included in your product packaging or visit the official BIWIBON website. Keep your proof of purchase for warranty claims.

## CUSTOMER SUPPORT

---

For technical assistance, troubleshooting, or general inquiries, please contact BIWIBON customer support through the following channels:

- **Email:** Refer to the product packaging or official website for the latest contact email.
- **Online Support:** Visit the [BIWIBON Store on Amazon](#) for FAQs and support resources.
- **Phone:** Check the official BIWIBON website for customer service phone numbers.

When contacting support, please have your product model (BCA-02) and purchase information ready.

