



Manuals.plus /

- › [8Bitdo](#) /
- › [8Bitdo Ultimate 2 Wireless Gaming Controller User Manual](#)

8Bitdo Ultimate 2 Wireless

8Bitdo Ultimate 2 Wireless Gaming Controller User Manual

Model: Ultimate 2 Wireless

[Setup](#) [Operating Instructions](#) [Key](#)
[Features](#) [Maintenance](#) [Troubleshooting](#) [Specifications](#) [Warranty & Support](#)

PRODUCT OVERVIEW

The 8Bitdo Ultimate 2 Wireless Gaming Controller is designed for enhanced gaming experiences on PC and Android platforms. It features advanced TMR Joysticks, switchable Hall Effect/Tactile Triggers, 8Speed Wireless Technology, and a convenient charging dock. This manual provides detailed instructions for setup, operation, and maintenance.



Figure 1: 8Bitdo Ultimate 2 Wireless Gaming Controller (Black) on its charging dock.

Your browser does not support the video tag.

Video 1: Official 8Bitdo Ultimate 2 Wireless Controller feature overview.

SETUP GUIDE

1. Charging the Controller

Before initial use, fully charge the controller using the included charging dock or USB-C cable.

1. Connect the USB-C cable to the charging dock and a power source.
2. Place the controller onto the charging dock. The LED indicator on the controller will show charging status.
3. Alternatively, connect the USB-C cable directly to the controller for charging.

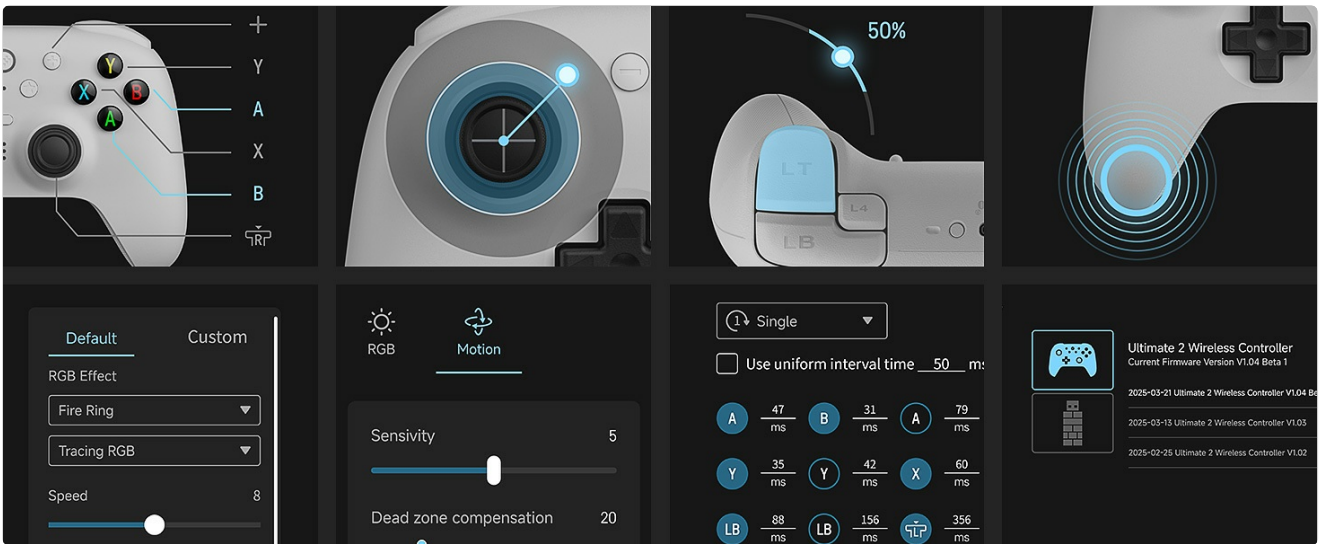

Figure 2: Placing the controller on the charging dock.

2. Connecting to Devices

The 8BitDo Ultimate 2 supports 2.4G wireless, Bluetooth, and wired connections.

2.1. 2.4G Wireless Connection (PC)

1. Locate the 2.4G USB-C adapter. It is typically stored within the charging dock.



Figure 3: USB-C adapter stored in the charging dock.

2. Plug the 2.4G USB-C adapter into an available USB port on your PC.

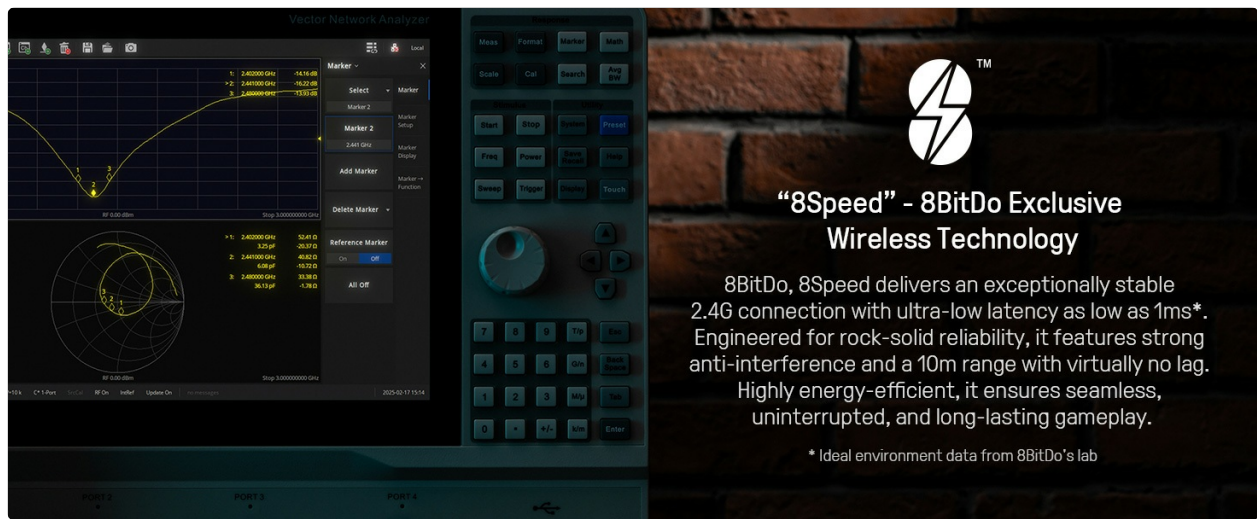

Figure 4: The 8BitDo USB-C adapter.

3. On the back of the controller, slide the mode switch to the 'X' position (for XInput, compatible with Windows).
4. Press the 8Bitdo button (home button) on the controller to power it on. The controller will automatically connect to the adapter.

2.2. Bluetooth Connection (Android)

1. On the back of the controller, slide the mode switch to the 'D' position (for DInput, compatible with Android).
2. Press the 8Bitdo button (home button) to power on the controller.
3. Press and hold the Pair button on the controller for 3 seconds to enter pairing mode. The LED indicators will rapidly flash.
4. On your Android device, go to Bluetooth settings and select '8Bitdo Ultimate 2' from the list of available devices.
5. Once paired, the LED indicators on the controller will become solid.

2.3. Wired Connection (PC)

1. Connect the USB-C cable directly from the controller to your PC.
2. The controller will be recognized as a wired gamepad.

OPERATING INSTRUCTIONS

1. Basic Controls

- **Analog Sticks:** Used for movement and camera control.
- **D-Pad:** For directional input, often used in menus or 2D games.
- **Action Buttons (A, B, X, Y):** Perform in-game actions.
- **Shoulder Buttons (L1, R1) & Triggers (L2, R2):** For various in-game functions like shooting, aiming, or menu navigation.
- **Start/Select Buttons:** Typically for pausing games or accessing menus.
- **Home Button:** Powers on/off the controller and can access system menus.

2. Mode Switching

The switch on the back of the controller allows you to change between XInput (PC) and DInput (Android) modes. Ensure the correct mode is selected for your device to ensure proper functionality.



Figure 5: Controller back with mode switch and back buttons.

KEY FEATURES

1. TMR Joysticks

The controller is equipped with TMR (Tunnel Magnetoresistance) Joysticks, offering enhanced sensitivity, precision, and durability while consuming less power. These joysticks provide a responsive and accurate input for competitive gaming.

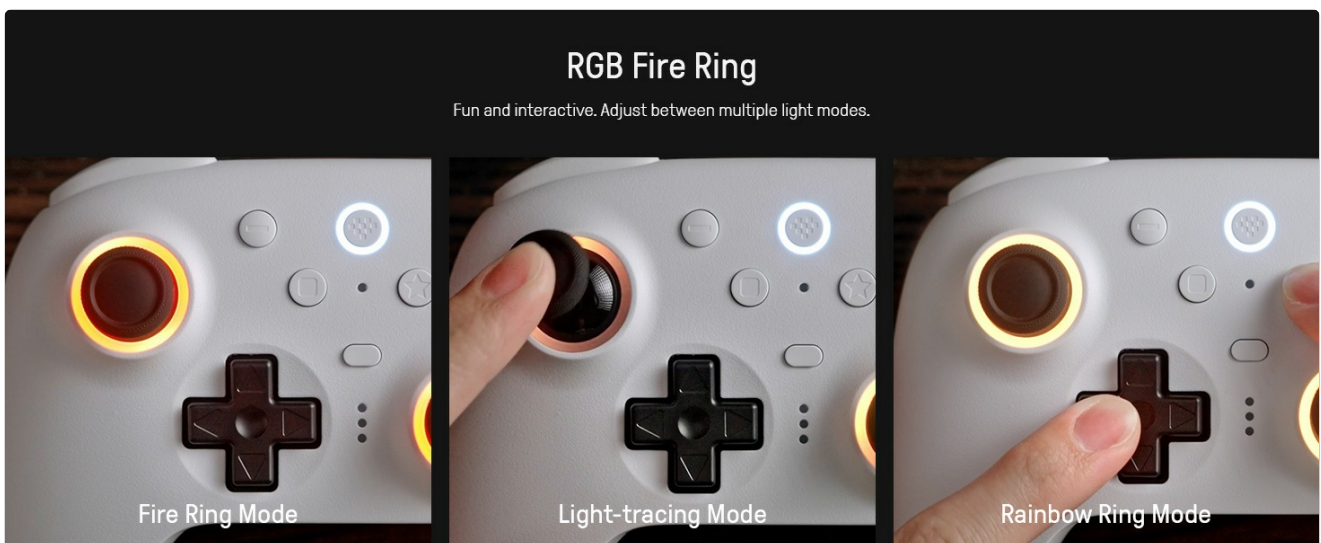

Figure 6: Close-up of a TMR Joystick with RGB lighting.

2. Switchable Hall Effect/Tactile Triggers

Easily switch between linear Hall Effect triggers and non-linear tactile triggers. This allows for optimal control across different gaming scenarios, providing precise input for racing games (linear) or quick, responsive feedback for shooters (tactile).

3. 8Speed Wireless Technology

8Bitdo's exclusive 8Speed Wireless Technology delivers an exceptionally stable 2.4G connection with ultra-low latency, as low as 1ms. Engineered for reliability, it features strong anti-interference and a 10m range with virtually no lag, ensuring seamless and long-lasting gameplay.

Hall Effect Triggers & Mode Switching

Easily switch between linear Hall Effect triggers and non-linear tactile triggers for optimal control across different gaming scenarios.



Figure 7: Illustration of 8Speed Wireless Technology.

4. Motion Control

Enjoy enhanced motion-based actions with 6-axis motion control. This feature is customizable through the 8BitDo Ultimate Software V2, allowing you to fine-tune motion sensitivity and other parameters.

5. RGB Fire Ring

The controller features an RGB Fire Ring around the joysticks, offering fun and interactive lighting. Adjust between multiple light modes and colors using the 8BitDo Ultimate Software V2.



Equipped with TMR Joysticks

The first 8BitDo controller to feature market-leading TMR joysticks, offering higher sensitivity, greater precision, and enhanced durability—all while consuming less power.

Figure 8: RGB Fire Ring modes: Fire Ring, Light-tracing, and Rainbow Ring.

6. Additional Features

- **Extra Bumpers:** Provides additional customizable input options.
- **2 Pro-level Back Buttons:** Programmable buttons on the rear for advanced control.
- **Tactile Bumpers and D-pad:** Designed for satisfying and responsive feedback.
- **Turbo Function:** Allows for rapid, repeated button presses.
- **Vibration:** Haptic feedback for immersive gameplay.

MAINTENANCE

1. Cleaning

- Use a soft, dry cloth to clean the controller's surface.
- For stubborn dirt, slightly dampen the cloth with water or a mild cleaning solution. Avoid harsh chemicals.
- Do not allow liquids to enter the controller's openings.

2. Storage

- Store the controller in a cool, dry place away from direct sunlight and extreme temperatures.
- When not in use, placing the controller on its charging dock helps keep it charged and protected.

3. Battery Care

- Avoid fully discharging the battery frequently to prolong its lifespan.
- If storing for an extended period, charge the controller to about 50% before storage.

TROUBLESHOOTING

1. Controller Not Connecting

- **Check Mode Switch:** Ensure the mode switch on the back of the controller is set to the correct position (X for PC, D for Android).
- **Re-pair:** For Bluetooth, try unpairing and re-pairing the controller with your device. For 2.4G, unplug and re-plug the adapter.
- **Battery Level:** Ensure the controller has sufficient battery charge.
- **Interference:** Move closer to your device or away from potential sources of wireless interference.

2. Input Lag or Disconnections

- **2.4G Connection:** The 8Speed Wireless Technology is designed for low latency. Ensure the adapter is plugged into a direct USB port, not a hub, if experiencing issues.
- **Bluetooth:** Bluetooth connections can be more susceptible to interference. Try switching to 2.4G wireless if available for PC.
- **Firmware Update:** Check the official 8Bitdo website for any available firmware updates for your controller.

3. Buttons Not Responding

- **Test in Software:** Use the 8BitDo Ultimate Software V2 to test individual button inputs.
- **Clean:** Ensure no debris is lodged around the buttons.
- **Reset:** Perform a factory reset if issues persist (refer to the 8Bitdo website for specific instructions).

SPECIFICATIONS

Feature	Detail
Model Name	Ultimate 2
Connectivity	2.4G Wireless, Bluetooth, Wired (USB-C)
Compatible Devices	Windows PC, Android
Joysticks	TMR Joysticks
Triggers	Switchable Hall Effect / Tactile Triggers
Motion Control	6-axis Motion Control
Polling Rate	1000Hz (2.4G & Wired)
Additional Buttons	Extra Bumpers, 2 Pro-level Back Buttons
Special Features	RGB Fire Ring, Charging Dock, USB-C Adapter, Turbo Function, Vibration
Power Source	Battery Powered
Item Weight	0.64 Kilograms

WARRANTY AND SUPPORT

For detailed warranty information and technical support, please refer to the official 8Bitdo website or the documentation included with your product. Keep your proof of purchase for warranty claims.

Online Resources:

- Official 8Bitdo Website: www.8bitdo.com
- Firmware Updates & Software: Check the support section of the official website for the latest firmware and 8BitDo Ultimate Software V2.