

[manuals.plus](#) /

› [EZVALO](#) /

› [EZVALO LED Puck Lights \(Model EZL2433A\) Instruction Manual](#)

EZVALO EZL2433A

EZVALO LED Puck Lights Instruction Manual

Model: EZL2433A

INTRODUCTION

Thank you for choosing EZVALO LED Puck Lights. These versatile, rechargeable touch lights are designed to provide convenient illumination in various spaces. Featuring three adjustable color temperatures and dimmable brightness, they offer flexible lighting solutions for your home or office. This manual provides detailed instructions for setup, operation, and maintenance to ensure optimal performance.



Image: EZVALO LED Puck Lights in use, demonstrating touch activation.

PACKAGE CONTENTS

- 2 x EZVALO 2.5-inch LED Puck Lights
- 2 x 3M Double-Sided Adhesive Pads
- 1 x USB Charging Cable
- 1 x Instruction Manual (this document)

PRODUCT FEATURES

- **USB Rechargeable:** Built-in battery eliminates the need for frequent battery replacement.
- **Compact Design:** Mini 2.5-inch size, ideal for small spaces and discreet installation.
- **Touch Control:** Easy operation with simple touch gestures for power, color, and brightness.
- **3 Color Temperatures:** Switch between 3000K (Warm Light), 4500K (Natural Light), and 6500K (Cool Light) to suit your preference.
- **Dimmable Brightness:** Adjust light intensity from 10% to 100%.
- **High Brightness:** Up to 50 lumens output for effective illumination.
- **Long Battery Life:** Up to 6 hours of illumination at maximum brightness.
- **Quick Charging:** Fully charges in approximately 1.5 hours via Type-C USB port.
- **Easy Installation:** Wireless design with 3M adhesive for flexible placement.

SETUP AND INSTALLATION

The EZVALO LED Puck Lights offer simple, wireless installation using the included 3M adhesive pads.

1. **Prepare the Surface:** Ensure the desired installation surface is clean, dry, and smooth.
2. **Attach the Adhesive Pad:** Remove the protective film from one side of the 3M double-sided adhesive pad. Attach this side firmly to the back of the light's mounting base.
3. **Mount the Base:** Remove the protective film from the other side of the adhesive pad. Press the mounting base firmly onto your chosen surface (e.g., under a cabinet, inside a closet). Hold for a few seconds to ensure a secure bond.
4. **Attach the Light:** Align the puck light with the mounted base. Rotate the light clockwise until you hear a "click" sound, indicating it is securely locked into place.

Easy Installation

Wireless Lights Installation Anywhere

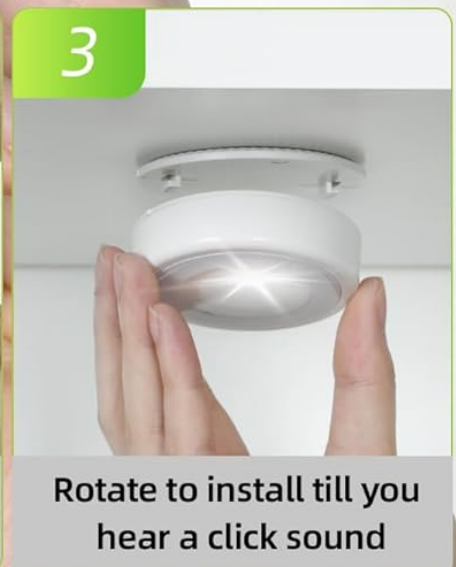

Image: Step-by-step guide for installing the EZVALO LED Puck Light using 3M adhesive and a twist-lock mechanism.

Your browser does not support the video tag.

Video: Demonstrates the easy installation process of the EZVALO Rechargeable LED Puck Lights, including attaching the adhesive base and twisting the light into place.

OPERATING INSTRUCTIONS

The EZVALO LED Puck Lights are controlled via a simple touch interface.

1. Power On/Off

- **Short Press:** Lightly tap the center of the puck light once to turn it ON or OFF.

2. Adjust Color Temperature

- **Double Click:** Quickly tap the center of the puck light twice to cycle through the three color temperatures: 3000K (Warm Light), 4500K (Natural Light), and 6500K (Cool Light).

3. Adjust Brightness (Dimming)

- **Long Press:** Press and hold the center of the puck light to smoothly adjust the brightness from 10% to 100%. Release when the desired brightness level is reached.



Image: Visual guide to changing color temperature and adjusting brightness using touch controls.

Your browser does not support the video tag.

Video: Demonstrates the touch controls for the EZVALO puck lights, including short press for ON/OFF, double press for color temperature, and long press for dimming.

CHARGING

The EZVALO LED Puck Lights feature a built-in rechargeable battery for convenience and environmental friendliness.

- **Charging Port:** Locate the Type-C USB charging port on the side of the puck light.
- **Connect Cable:** Insert the included USB charging cable into the light's Type-C port and connect the other end to a compatible USB power source (e.g., power bank, phone charger, PC USB port).
- **Charging Indicator:** A red indicator light will illuminate during charging. The light will turn off or change color (depending on the model) once fully charged.
- **Charging Time:** A full charge typically takes approximately 1.5 hours.

Rechargeable Puck Lights

6

Hours

MAX Brightness

1.5

Hours

Charging Time

50

Lumen

Image: Illustrates connecting the USB cable for charging and highlights charging duration.

MAINTENANCE

- **Cleaning:** Wipe the surface of the puck light with a soft, dry cloth. Avoid using abrasive cleaners or solvents.
- **Battery Care:** To prolong battery life, avoid fully discharging the battery frequently. Recharge the lights when the brightness noticeably diminishes.

- **Storage:** If storing the lights for an extended period, charge them fully before storage and recharge every 3-6 months to maintain battery health.
- **Water Resistance:** These lights are designed for indoor use only and are not water-resistant. Avoid exposure to moisture or direct water.

TROUBLESHOOTING

Problem	Possible Cause	Solution
Light does not turn on.	Battery is depleted.	Charge the light using the provided USB cable.
Light is dim or flickers.	Low battery.	Recharge the light.
Cannot change color temperature or brightness.	Incorrect touch gesture.	Ensure you are using a double-tap for color and a long press for dimming.
Light falls off surface.	Adhesive not properly applied or surface is unsuitable.	Clean the surface thoroughly before applying adhesive. Ensure the surface is smooth and dry. Reapply with new 3M adhesive if necessary.

SPECIFICATIONS

Brand	EZVALO
Model Name	Ceres Puck Lights-White-2P (EZL2433A)
Product Dimensions	2.52"L x 2.52"W x 0.87"H
Item Weight	4.2 ounces
Light Source Type	LED
Brightness	50 Lumens
Color Temperature	3000K, 4500K, 6500K (Adjustable)
Dimmable	10% - 100%
Power Source	Battery Powered (Rechargeable Lithium Ion)
Charging Time	Approx. 1.5 hours
Max Runtime (Brightest)	Approx. 6 hours
Control Method	Touch
Indoor/Outdoor Usage	Indoor Use Only

WARRANTY AND SUPPORT

For warranty information or technical support, please refer to the contact details provided on the product packaging or visit

the official EZVALO website. Keep your purchase receipt for warranty claims.