

S190

User Manual

X10 BONE CONDUCTION SWIMMING HEADPHONES (MODEL S190)

Brand: Generic

1. Introduction

The X10 Bone Conduction Swimming Headphones are designed for active individuals, offering a unique audio experience through bone conduction technology. These headphones feature 32GB of internal memory, a digital display, and are built to be waterproof and sweatproof, making them suitable for various sports activities including swimming, running, and gym workouts. They provide wireless connectivity via Bluetooth for seamless audio streaming from compatible devices.



Image: The X10 Bone Conduction Swimming Headphones, showcasing their over-ear design and integrated digital display.

2. What's in the Box

Upon unboxing your X10 Bone Conduction Swimming Headphones, please ensure all the following components are present:

- X10 Bone Conduction Headphones
- Charging Cable
- User Manual

3. Key Features

- **Wireless Connectivity:** Equipped with Bluetooth technology for seamless audio streaming from compatible devices.
- **Bone Conduction Design:** Audio vibrations are transmitted directly to the inner ear, allowing you to enjoy music without obstructing your ears.
- **Waterproof and Sweatproof (IPX8):** Designed to withstand water exposure and resist sweat, ideal for swimming and intense workouts.
- **Built-in 32GB Memory:** Store thousands of music files directly on the headphones, eliminating the need for a separate device.
- **Digital Display:** Provides real-time information such as battery level, playback time, and track details.

Sports artifacts

Bone conduction bluetooth headset

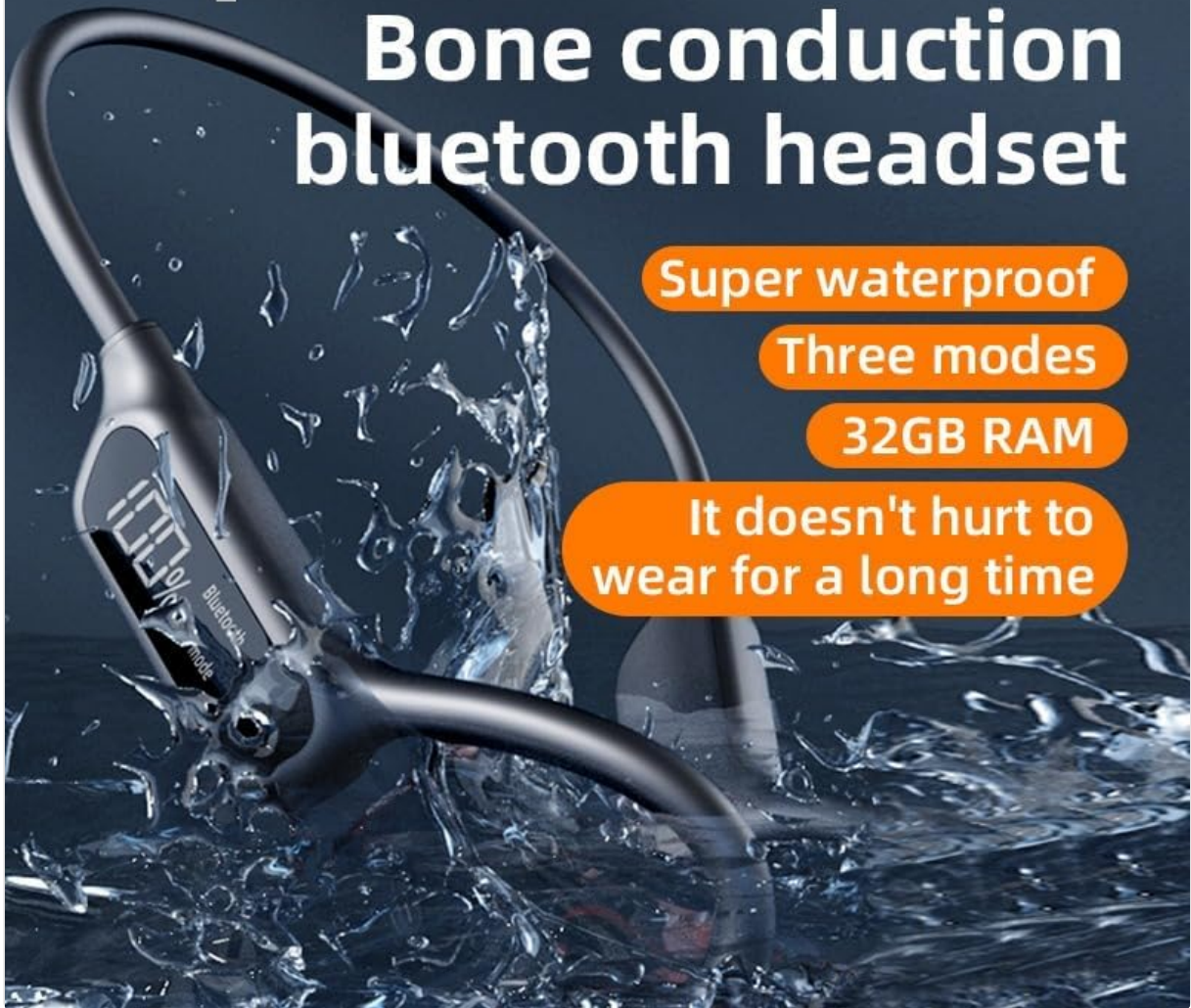

Super waterproof

Three modes

32GB RAM

It doesn't hurt to
wear for a long time

Image: The X10 headphones demonstrating their super waterproof capability, along with text indicating three modes, 32GB RAM, and comfortable wear.

AI Smart Screen

LED three numbers control
the overall situation

Cold LED three screen digital display
for clearer battery life at a glance



Image: A detailed view of the AI Smart Screen, illustrating the LED digital display for battery, Bluetooth playback mode, and MP3 playback mode.

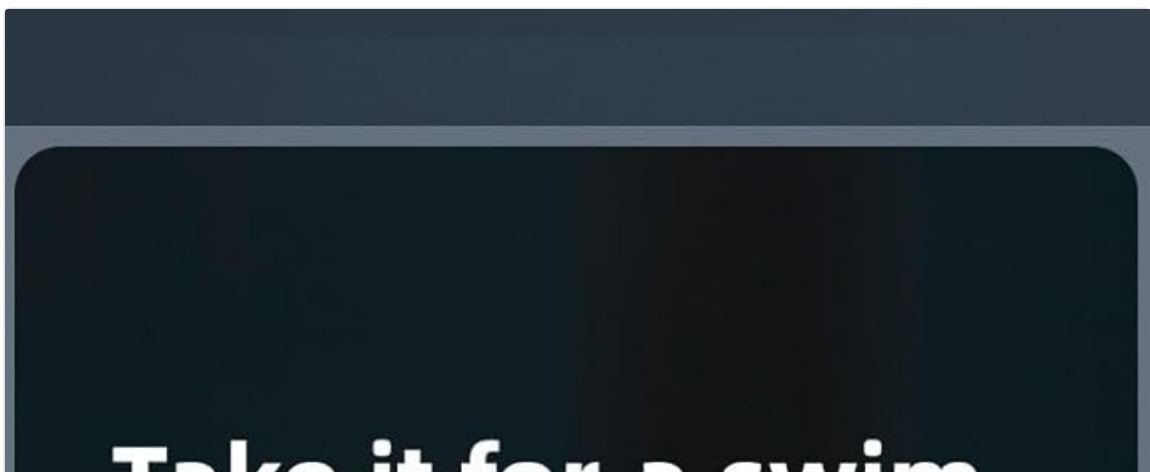

Take it for a swim No problem!

IPX8 waterproof design can be worn for swimming



Image: A swimmer wearing the X10 headphones, demonstrating their IPX8 waterproof design suitable for swimming.

Bluetooth 5.3 ultra fast and ultra stable.

Upgrading dual chip operation reduces functionality
and makes algorithms more intelligent and stable

Extremely low operating power consumption brings extra long range





Image: An internal diagram highlighting the Bluetooth 5.3 chip and 32GB memory, indicating ultra-fast and stable connectivity.

LED digital display for real-time display of battery level

**LED real-time power display
constantly controlling the remaining power
no longer anxious about battery life**





Charging display icon 88%

Image: A close-up of the LED digital display, showing the real-time battery level percentage.

Large memory capable of playing thousands of songs.

Built-in 32G memory capable of storing thousands of high-quality singles at any time enjoying the combination of sports and music





Image: The headphones with an overlay emphasizing their large 32GB memory, capable of storing thousands of songs.

**Can continuously listen
to music for 8 hours to meet the
daily exercise needs**

Small stature, high energy 230mAh,
large capacity, low power battery



Image: The headphones with text highlighting their ability to continuously play music for 8 hours, meeting daily exercise needs.

4. Setup

4.1 Charging the Headphones

Before first use, fully charge the headphones. The charging time is approximately 2 hours.

1. Connect the charging cable to the charging port on the headphones.
2. Connect the other end of the cable to a USB power adapter (not included) or a computer's USB port.
3. The digital display will show the charging status. A full charge is indicated by 100% on the display.

4.2 Bluetooth Pairing

To connect your headphones to a Bluetooth-enabled device:

1. Ensure the headphones are powered off.
2. Press and hold the Power button (Right button) until the digital display shows "Bluetooth" and the

indicator light flashes, indicating pairing mode.

3. On your device (smartphone, tablet, etc.), enable Bluetooth and search for available devices.
4. Select "X10 Headphones" (or similar name) from the list of found devices.
5. Once connected, the display will show "Bluetooth" steadily, and a voice prompt will confirm the connection.

4.3 Loading Music to Internal Memory (MP3 Mode)

The headphones have 32GB of built-in memory for storing music files directly.

1. Connect the headphones to your computer using the provided charging cable. The headphones will appear as a removable disk drive.
2. Drag and drop your desired audio files (e.g., MP3, WAV) into the headphone's storage folder.
3. Safely eject the headphones from your computer once file transfer is complete.

5. Operating Instructions

Humanized physical buttons with one hand operation, easy to use

The button functions are simple and easy to learn and various functions can be freely switched making it easy to manage music



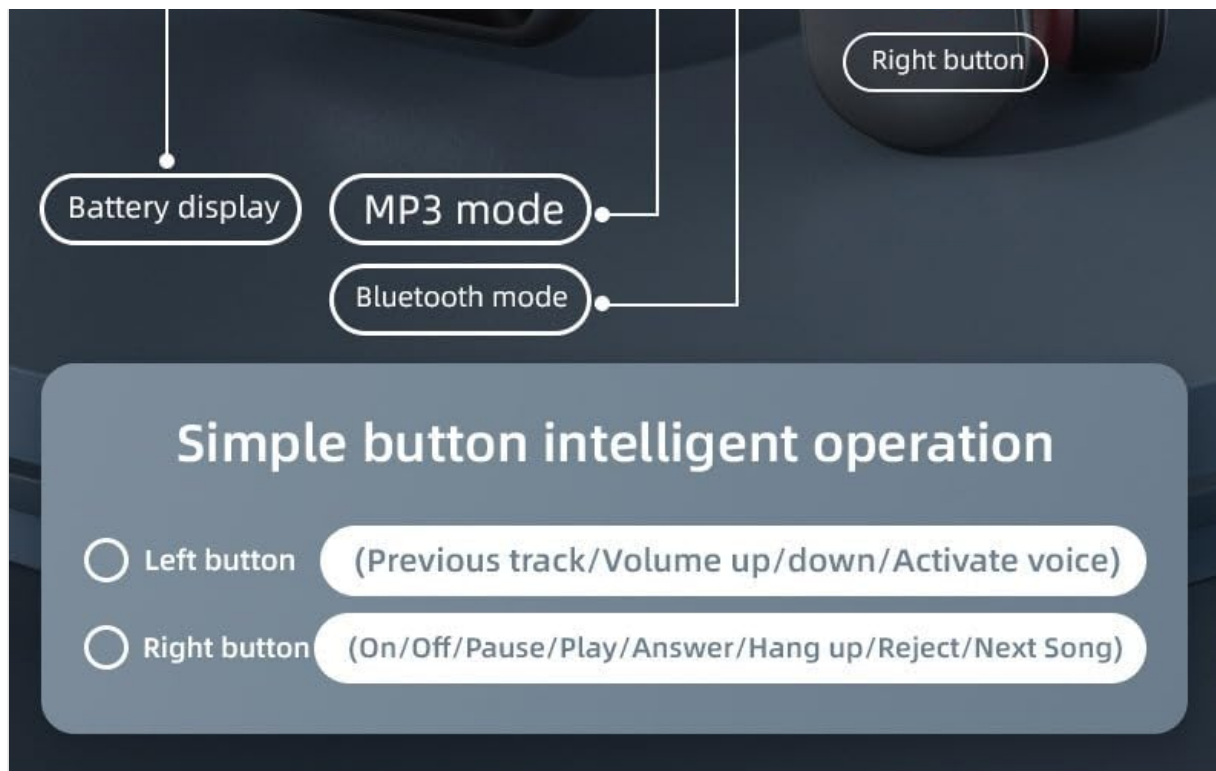

Image: A visual guide to the physical buttons on the X10 headphones, detailing the functions of the Left and Right buttons.

5.1 Power On/Off

- **Power On:** Press and hold the **Right button** for 3 seconds. The display will light up.
- **Power Off:** Press and hold the **Right button** for 5 seconds. The display will turn off.

5.2 Mode Switching

The headphones support both Bluetooth and MP3 playback modes.

- **Switch Modes:** Double-press the **Right button** to toggle between Bluetooth mode and MP3 mode. The digital display will indicate the current mode.

5.3 Music Playback (Bluetooth & MP3 Mode)

- **Play/Pause:** Single-press the **Right button**.
- **Next Track:** Triple-press the **Right button**.
- **Previous Track:** Triple-press the **Left button**.
- **Volume Up:** Single-press the **Left button**.
- **Volume Down:** Press and hold the **Left button**.

5.4 Call Management (Bluetooth Mode Only)

- **Answer Call:** Single-press the **Right button** when a call comes in.
- **End Call:** Single-press the **Right button** during a call.
- **Reject Call:** Press and hold the **Right button** for 2 seconds when a call comes in.

5.5 Voice Assistant Activation

- **Activate Voice Assistant:** Double-press the **Left button**.

6. Maintenance

Proper care will extend the life of your headphones.

- **Cleaning:** Wipe the headphones with a soft, damp cloth after each use, especially after swimming or intense workouts. Do not use harsh chemicals or abrasive cleaners.
- **Water Resistance:** While IPX8 rated, avoid prolonged submersion beyond recommended depths and times. Ensure the charging port cover is securely closed before exposing to water. Rinse with fresh water after use in chlorinated or saltwater.
- **Storage:** Store the headphones in a cool, dry place away from direct sunlight and extreme temperatures.
- **Charging:** Only use the provided charging cable. Avoid overcharging the battery.

7. Troubleshooting

Problem	Possible Cause	Solution
Headphones do not power on.	Low battery.	Charge the headphones fully.
Cannot connect via Bluetooth.	Headphones not in pairing mode; device Bluetooth off; too far from device.	Ensure headphones are in pairing mode. Turn device Bluetooth off/on. Move closer to device.
No sound in MP3 mode.	No music files loaded; corrupted files; volume too low.	Load music files. Check file format. Increase volume.
Sound quality is poor.	Low battery; interference; improper fit.	Charge headphones. Move away from interference sources. Adjust headphone position for optimal bone conduction.
Headphones not recognized by computer.	Faulty cable; driver issue.	Try a different USB port or cable. Restart computer.

8. Specifications

Feature	Detail
Model Name	S190
Connectivity Technology	Bluetooth 5.3
Internal Memory	32GB
Water Resistance Level	IPX8 (Waterproof)
Charging Time	2 Hours
Continuous Playback	Up to 8 Hours
Control Type	Touch Control / Physical Buttons
Material	Plastic
Ear Placement	In Ear (Bone Conduction)
Noise Control	Active Noise Cancellation

Feature	Detail
Impedance	140 Ohm

9. Warranty and Support

Your X10 Bone Conduction Swimming Headphones come with a standard manufacturer's warranty. For specific warranty details, claims, or technical support, please refer to the warranty card included with your purchase or contact the retailer where the product was purchased. Please retain your proof of purchase for warranty purposes.