

Manuals+

[Q & A](#) | [Deep Search](#) | [Upload](#)

[manuals.plus](#) /

› [Carpuride](#) /

› [Carpuride W702BS PRO Motorcycle Display User Manual](#)

Carpuride W702BS PRO

Carpuride W702BS PRO Motorcycle Display User Manual

Model: W702BS PRO

Brand: Carpuride

1. INTRODUCTION

The Carpuride W702BS PRO is an advanced 7-inch waterproof GPS navigation screen designed specifically for BMW motorcycles. It integrates wireless Apple CarPlay and Android Auto functionalities, dual Bluetooth connectivity for music sharing and intercom, and supports native BMW Wonder Wheel control for seamless interaction with your motorcycle's data and features.

This manual provides detailed instructions for the proper installation, operation, and maintenance of your Carpuride W702BS PRO device.

2. SAFETY INFORMATION

- Always prioritize safety while riding. Do not operate the device in a manner that distracts you from the road.
- Ensure the device is securely mounted to prevent detachment during operation.
- Avoid exposing the device to extreme temperatures outside its specified operating range.
- Do not attempt to disassemble or repair the device yourself. Refer to qualified service personnel.
- Keep the screen clean and free from obstructions for optimal visibility.

3. PACKAGE CONTENTS

Verify that all items are present in your package:

- 1x Carpuride W702BS PRO Motorcycle Stereo Unit

4. SETUP AND INSTALLATION

The Carpuride W702BS PRO is designed for plug-and-play installation on compatible BMW motorcycles equipped with an original BMW navigation base and a 4-pin connector. No complex wiring is required.

4.1 Compatibility

This device is suited for BMW R1200GS, BMW R1300GS, BMW S1000XR, and BMW R1250GS (excluding 2019 version). Ensure your motorcycle has an original BMW navigation base.

4.2 Installation Steps

1. Ensure your BMW motorcycle has an original BMW navigation base.
2. Align the 16-pin connector on the back of the W702BS PRO device with the corresponding port on your motorcycle's navigation base.
3. Gently slide the device onto the base until it clicks securely into place. A firm press may be required to ensure the snap mechanism engages fully, indicating a secure connection.
4. Once installed, the device should power on automatically with the motorcycle's ignition.



Figure 4.1: Original BMW Installation Mode. The image illustrates the device's back with its 16-pin connector and the process of sliding it onto the motorcycle's navigation base for a secure, plug-and-play fit.



Figure 4.2: Compatible BMW Motorcycle Models. This image displays several BMW motorcycle models, including R1250GS (not 2019 version), S1000XR, R1200GS, and R1300GS, indicating their compatibility with the Carpuride W702BS PRO.

4.3 Installation Video Guide

For a visual guide on installation and entering/exiting NAV mode, please refer to the video below:

Video 4.1: W702/W502 BS Pro Installation Tutorial, Entering TFT/NAV Mode. This video demonstrates the physical installation of the device and how to switch between the motorcycle's TFT display and the device's navigation mode using the Wonder Wheel.

5. OPERATING INSTRUCTIONS

5.1 Native Wonder Wheel Control

The W702BS PRO seamlessly integrates with your BMW's Wonder Wheel, allowing you to control the device's display and access various motorcycle data without taking your hands off the handlebars. This includes viewing TPMS, fuel levels, engine RPM, mileage, and more. Ensure you are using an original BMW bracket for compatibility.

BMW Wonder Wheel Control

Once connected to your BMW, the Carpuride Moto screen allows you to easily operate the device using the Wonder Wheel, including switching music, viewing basic data such as speed, fuel level, engine speed and mileage



Figure 5.1: BMW Wonder Wheel Control. This image highlights the integration of the Carpuride screen with the BMW Wonder Wheel, demonstrating how the wheel can be used to navigate the device's interface and display motorcycle data.

5.2 Wireless CarPlay & Android Auto

Connect your smartphone wirelessly to the W702BS PRO for access to navigation, calls, music, and messaging via Siri or Google Assistant. Compatible with iOS 6+ and Android 11+.

5.2.1 Connecting Apple CarPlay

1. On the W702BS PRO, open the 'i-Play' application.
2. On your iPhone, search for the device's Bluetooth name (e.g., 'carpuride-xxxx') and pair.
3. Confirm the pairing request on both devices and click 'Allow' and 'Use CarPlay' on your iPhone.
4. The connection should now be successful.

5.2.2 Connecting Android Auto

1. On the W702BS PRO, open the 'A-Auto' application.
2. On your Android phone, find the connected devices in Bluetooth settings.

3. Add a new device (e.g., 'carpuride-xxxx') and click 'Pair'.
4. The connection should now be successful.

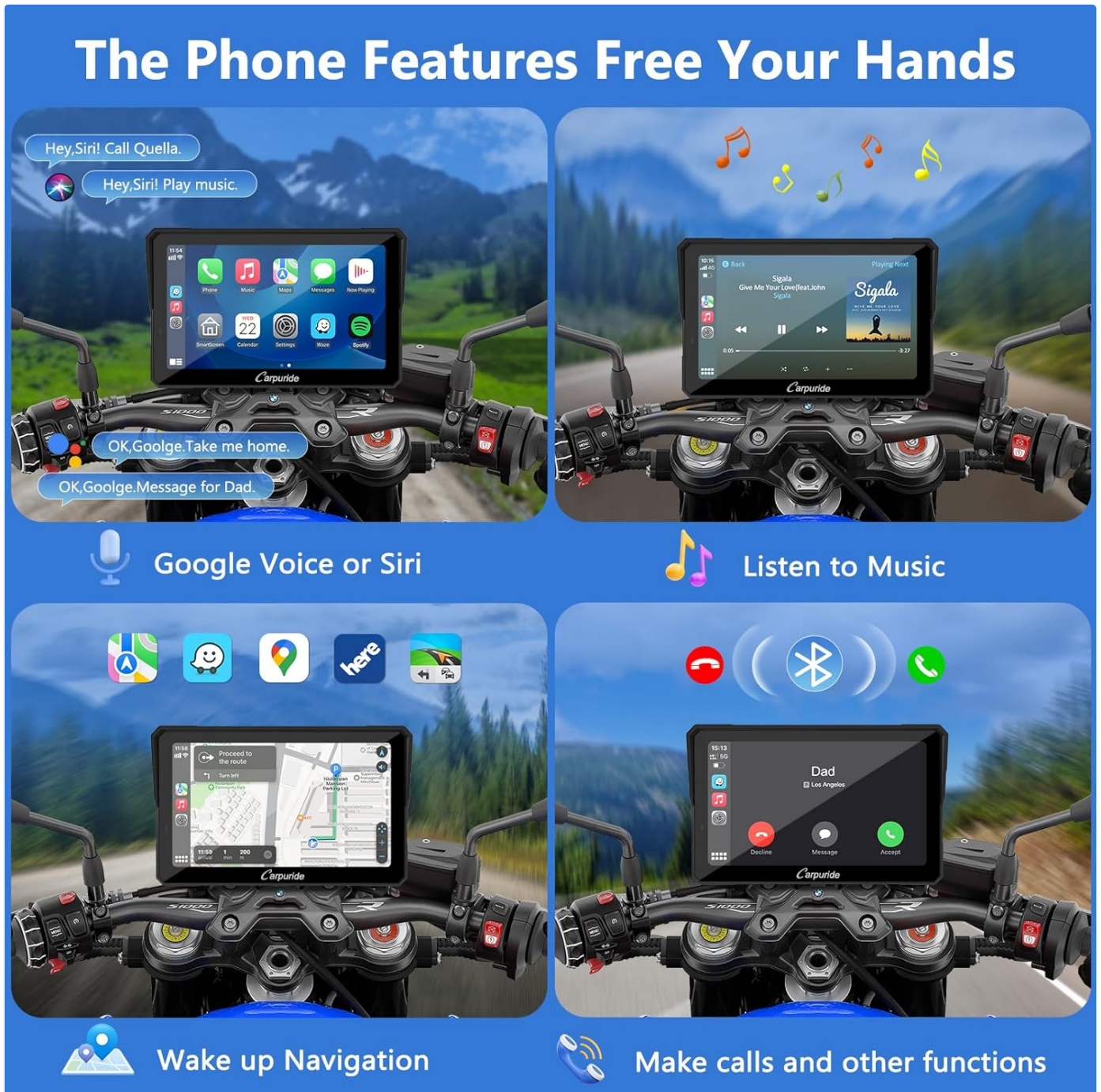

Figure 5.2: Phone Features. This image illustrates how the device allows hands-free operation of phone functions such as voice commands (Siri/Google Assistant), music streaming, navigation, and making/receiving calls.

5.3 Music Sharing & Intercom (Dual Bluetooth)

The W702BS PRO features upgraded dual Bluetooth technology, allowing two Bluetooth helmets to connect simultaneously via its BT Trans function. This enables both rider and passenger to share music and use the intercom function.

- In BT Trans mode, voice assistant commands and phone call audio are transmitted to Bluetooth 1. It is recommended that the primary rider connects to Bluetooth 1.
- The effective Bluetooth range for intercom is approximately 10 meters.

Bluetooth Trans (Single-person Connection Mode)

- Note:** 1. The helmet or earphone must be turned on and in an active state in order to be discovered by the Carpuride screen for pairing.
2. Do not connect your mobile phone to the Bluetooth headset or earphone, as this may interfere with the pairing process.



Bluetooth Trans (Two-person Connection Mode)

Connect to BT 1 and BT 2 at the same time, music and audio can be shared, but calls and voice assistant broadcast can only be realized through BT 1, BT 2 can't!



iPlay/ Auto (Bluetooth Audio)

Connect your phone to the Bluetooth Headset or Helmet. and use CarPlay or Android Auto to play audio through the Bluetooth Headset or Helmet.



Figure 5.3: Bluetooth Connection Modes. This diagram visually explains the single-person (Bluetooth Trans) and two-person (Bluetooth Trans) connection modes, as well as the iPlay/Auto (Bluetooth Audio) mode for connecting to headsets/helmets.

5.4 Sensor Light & EQ Effect

The built-in light sensor automatically adjusts screen brightness based on ambient light conditions, protecting your eyes and ensuring clear visibility during both day and night riding. The device also includes an EQ function for customizing audio output.

5.5 Data Reading (Compass & Barometer)

The W702BS PRO includes a compass for directional guidance and a barometer to monitor real-time altitude changes, enhancing safety and awareness, especially in varied terrains.

Fit for All Riding Environments

- ◆ Withstand all kinds of weather
- ◆ IP67 waterproof sunscreen design
- ◆ Anti-glare vehicle gauges screen
- ◆ Works between -4°F and 158°F



Figure 5.4: Environmental Features and Data Display. This image demonstrates the device's durability in different weather conditions (IP67 waterproof) and its ability to display useful environmental data like compass direction and barometric pressure.

5.6 Display Features

The 7-inch high-definition IPS touch screen features a resolution of 1024*600, vibrant 65K colors, and up to 1000nit peak brightness for excellent visibility even in direct sunlight.

High- Brightness Display

Our motorcycle-grade main display offers vibrant, refined colors that remain clear even in direct sunlight, Enjoy superior visibility and clarity while riding

1000 NIT



Figure 5.5: High-Brightness Display. This image emphasizes the screen's clarity and brightness, crucial for readability in various lighting conditions during motorcycle rides.

6. MAINTENANCE

- **Cleaning:** Use a soft, lint-free cloth to clean the screen. For stubborn marks, slightly dampen the cloth with water. Avoid harsh chemicals or abrasive materials.
- **Storage:** When not in use for extended periods, store the device in a cool, dry place away from direct sunlight.
- **Software Updates:** For software updates, use a small capacity TF card (4GB, 8GB, 16GB, or 32GB). A 64GB TF card does not support software upgrades; it is only for storing music and videos for local playback.

6.1 Software Update Video Guide

For instructions on updating the device's logo, refer to the video below:

Video 6.1: W702/W502 BS Pro Logo Upgrade Steps. This video provides a guide on how to upgrade the device's logo, which is part of the software update process.

7. TROUBLESHOOTING

Problem	Possible Cause	Solution
Device does not power on.	Not properly seated on navigation base; motorcycle ignition off.	Ensure device is fully clicked into place. Turn on motorcycle ignition.
CarPlay/Android Auto not connecting wirelessly.	Phone OS not compatible; Bluetooth/Wi-Fi off; phone not supported.	Check phone OS (iOS 6+, Android 11+). Ensure Bluetooth and Wi-Fi are enabled. Refer to compatibility list.
Wonder Wheel control not working.	Non-original BMW bracket; motorcycle model not supported.	Use original BMW bracket. Confirm motorcycle model compatibility (R1250RT after 2021, 2019 R1250GS, 2019 R1250RT are not compatible).
TPMS not operational.	Motorcycle lacks pre-installed TPMS system.	The device requires a pre-installed TPMS system on your BMW motorcycle to function.
Screen too bright/dim.	Light sensor issue or manual adjustment needed.	Ensure light sensor is not obstructed. Adjust brightness manually if automatic adjustment is insufficient.

8. SPECIFICATIONS

Feature	Description
Brand	Carpuride
Model	W702BS PRO
Screen Size	7 Inches
Resolution	1024*600
Brightness	Up to 1000nit peak brightness
Waterproof Rating	IP67
Connectivity	Dual Bluetooth, Wireless CarPlay, Wireless Android Auto
Special Features	GPS Navigation, Native Wonder Wheel Control, TPMS (requires pre-installed system), Light Sensor, Music Sharing, Intercom, Compass, Barometer
Operating System Compatibility	iOS (6+), Android (11+)
Audio Output Mode	Stereo
Mounting Type	Handlebar Mount (for BMW original navigation base)

9. WARRANTY AND SUPPORT

For warranty information and technical support, please refer to the official Carpuride website or contact their customer service directly. Keep your purchase receipt as proof of purchase for warranty claims.

Online Support: Visit the Carpuride official website for FAQs, software downloads, and contact information.

Customer Service: Refer to the contact details provided with your product packaging or on the official website for direct assistance.