

EPOMAKER WIN68 HE

EPOMAKER Aula WIN68 HE Magnetic Keyboard User Manual

Model: WIN68 HE

1. INTRODUCTION

This manual provides detailed instructions for the setup, operation, and maintenance of your EPOMAKER Aula WIN68 HE Magnetic Keyboard. Designed for precision and speed, this 65% wired compact keyboard features Hall Effect magnetic switches, adjustable actuation, and an 8000 Hz polling rate.

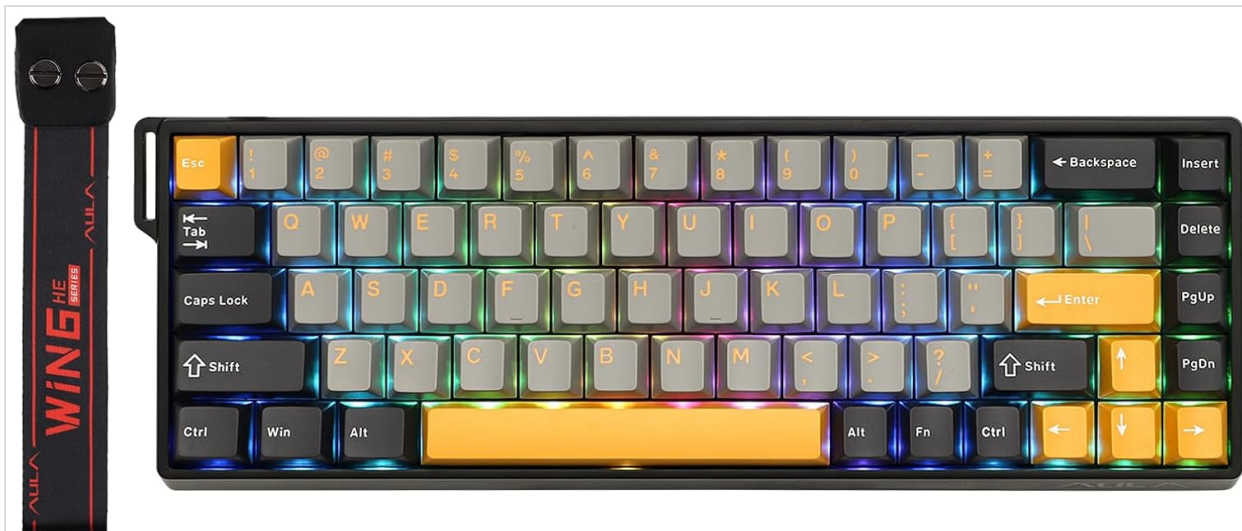

Image 1.1: The EPOMAKER Aula WIN68 HE Magnetic Keyboard in Grey and Yellow.

2. PACKAGE CONTENTS

Verify that all items are present in the package:

- EPOMAKER Aula WIN68 HE Magnetic Keyboard
- Extra Magnetic Switch
- Detachable Keyboard Ribbon

- Detachable USB A to C cable
- 2-in-1 Keycap-and-Switch Puller
- Dust Cover



Image 2.1: The keyboard and its included accessories, such as the USB-C cable, switch puller, and extra switches.

3. SPECIFICATIONS

Model	WIN68 HE
Brand	EPOMAKER
Keyboard Layout	65% (68 keys), ANSI Layout
Switch Type	Hall Effect Magnetic Switches
Actuation Point	Adjustable from 0.1mm to 3.4mm
Polling Rate	Up to 8000 Hz

Latency	Ultra-low, 0.3ms (0.2ms mentioned in image)
Connectivity	Wired (USB-C)
Backlighting	RGB (16 million colors, south-facing LEDs)
Hot-Swappable	Yes, compatible with magnetic switches
Keycaps	PBT Keycaps, Cherry Profile
Structure	Tray-Mount Structure with Aluminum Alloy Plate, PO Sandwich Cotton, PO Bottom Cotton
Compatible Devices	PC, Gaming Console
Operating Systems	Mac, Windows, Android
Product Dimensions	12.64 x 4.29 x 1.48 inches (321.9mm x 109mm x 37mm)
Item Weight	2.31 pounds (0.68kg)
Material	Aluminum, Plastic



Image 3.1: Key specifications and features of the WIN68 HE keyboard.



Image 3.2: Physical dimensions of the keyboard.

4. SETUP

4.1 Connecting the Keyboard

1. Unpack the keyboard and all accessories.
2. Connect the detachable USB A to C cable to the USB-C port on the keyboard.
3. Plug the USB-A end of the cable into an available USB port on your computer or gaming console.
4. The keyboard is plug-and-play and should be recognized automatically by your operating system.

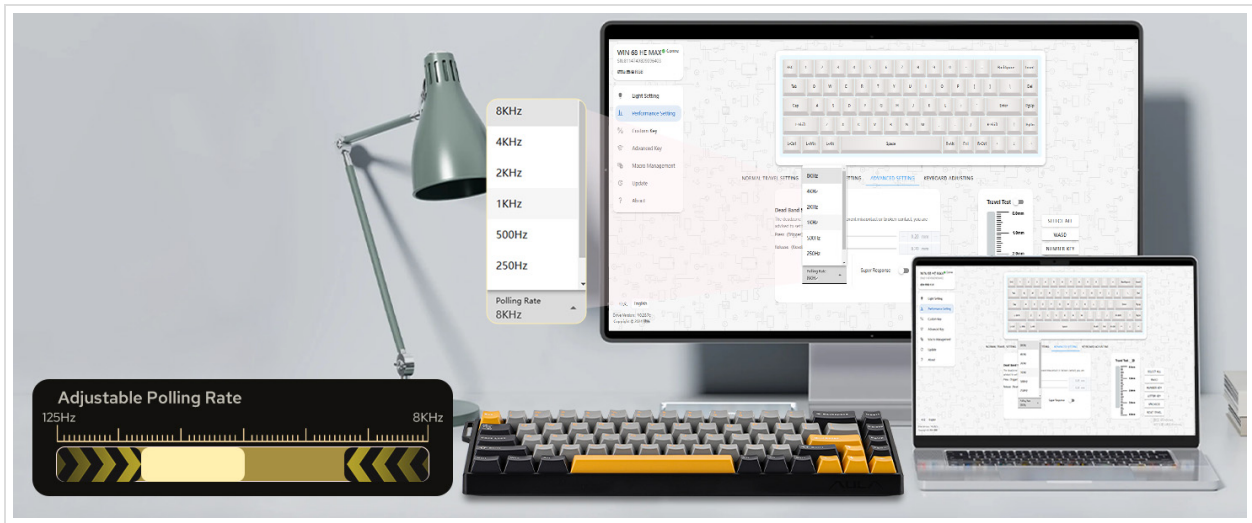

Image 4.1: The keyboard is compatible with Mac (FN+S) and Windows (FN+A) operating systems.

4.2 Web Driver Access and Calibration

For advanced customization and optimal performance, access the AULA Web Driver. The URL for the web driver is typically provided on a welcome card within the product packaging. This web-based tool allows for seamless configuration without software installation.

- **Calibration:** Before daily use, it is highly recommended to calibrate the keys via the web driver's 'Actuation' tab. This prevents ghost key presses and ensures accurate response.

AULA WEB DRIVER

Seamless access without the need for installation,
compatible with all operating systems



Image 4.2: The AULA Web Driver provides seamless access for customization across operating systems.

5. OPERATING INSTRUCTIONS

5.1 Adjustable Actuation

The Hall Effect magnetic switches allow for adjustable actuation points, ranging from 0.1mm to 3.4mm. This feature enables precise control over key sensitivity, catering to different typing and gaming preferences. The keystroke accuracy is up to 0.02mm, facilitating faster triggers and resets.



Image 5.1: Hall Effect magnetic switches offer adjustable trigger reset areas for high precision.

5.2 Advanced Key Functions

The AULA WIN68 HE Series supports several advanced key functionalities:

- **DKS (Dynamic Keystrokes):** Allows for different actions based on key press depth.
- **MT (Mod-Tap):** Assigns two functions to a single key, one for a quick tap and another for holding.
- **TGL (Toggle):** Toggles a function on or off with a single key press.
- **SOCD (Simultaneous Opposite Cardinal Directions):** Input cleaning for fighting games, preventing conflicting directional inputs.

These functions, along with adjustable zero dead zones, enhance gameplay and typing efficiency. Configuration is performed via the AULA Web Driver.



Image 5.2: Advanced functions available on the keyboard.

5.3 RGB Backlighting

The keyboard features 16 million colors of customizable RGB backlighting with south-facing LEDs for optimal visibility. Control the lighting effects using the following key combinations:

- **FN + INS:** Turn RGB lighting On/Off.
- **FN + PGUP:** Change light effect (21 effects available).
- **FN + DEL:** Change light color (8 colors available).

Further customization, including per-key lighting, is available through the AULA Web Driver.



Image 5.3: RGB backlight controls and effects.

5.4 Hot-Swappable Switches

The keyboard is designed with full-key hot-swappable sockets, allowing you to easily replace magnetic switches without soldering. This enables experimentation with different Hall Effect magnetic switches to find your preferred tactile feel and responsiveness.



Image 5.4: Hot-swappable design with magnetic switches and south-facing LEDs.

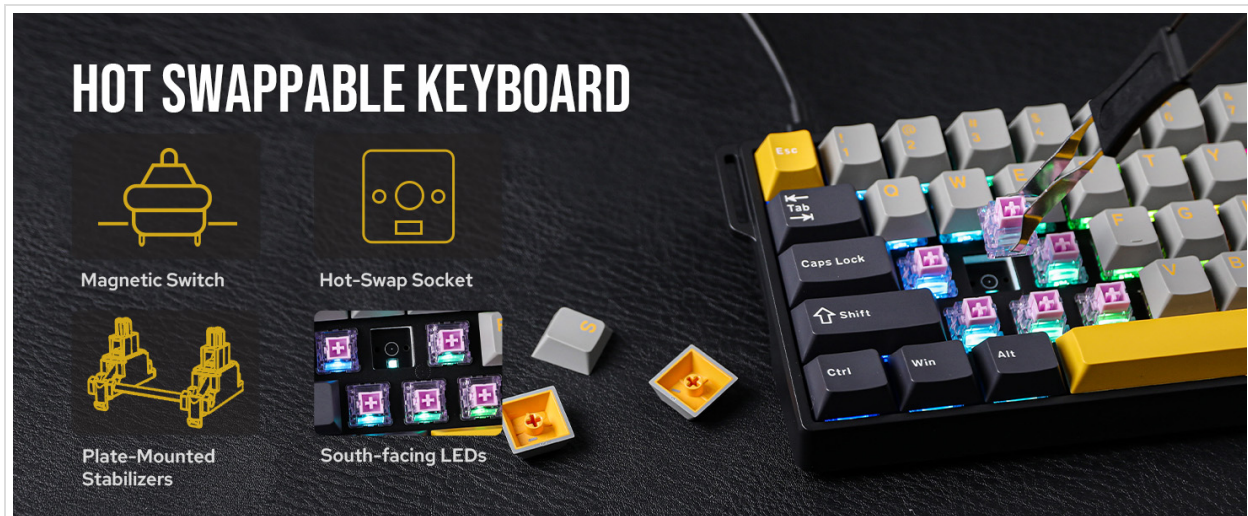

Image 5.5: Illustration of the hot-swappable switch mechanism.

5.5 Polling Rate

The keyboard supports an 8000 Hz polling rate, ensuring ultra-low latency and instantaneous keystroke

registration. This high polling rate provides a competitive advantage in fast-paced applications and gaming.



Image 5.6: Adjustable polling rate settings via the web driver.

6. MAINTENANCE

6.1 Cleaning

- Regularly clean the keyboard with a soft, dry cloth.
- Use a can of compressed air to remove dust and debris from between the keycaps.
- For deeper cleaning, use the provided keycap puller to remove keycaps and clean the switches and plate.

6.2 Switch Replacement

To replace a switch:

1. Use the 2-in-1 keycap-and-switch puller to carefully remove the keycap.
2. Use the switch puller end to gently grasp the switch and pull it straight up.
3. Align the pins of the new magnetic switch with the hot-swap socket on the PCB.
4. Press the new switch firmly into place until it clicks.
5. Reattach the keycap.



Image 6.1: The keyboard features Cherry profile keycaps.

7. TROUBLESHOOTING

- **Keyboard Not Responding:**

- Ensure the USB-C cable is securely connected to both the keyboard and the computer.
- Try connecting the keyboard to a different USB port.
- Test the keyboard on another computer to rule out system-specific issues.

- **Ghosting or Incorrect Key Presses:**

- Access the AULA Web Driver and perform a key calibration. This is crucial for Hall Effect keyboards to ensure accurate actuation.
- Check for any debris under the keycaps or switches that might be causing interference.

- **RGB Lights Not Working:**

- Ensure the RGB lights are turned on using **FN + INS**.
- Check the lighting settings in the AULA Web Driver.





- **Keys Feel Inconsistent:**

- Verify that all switches are fully seated in their sockets.
- Consider replacing individual switches if they are damaged or malfunctioning.

8. WARRANTY AND SUPPORT

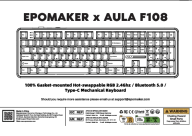
For warranty information, technical support, or service inquiries, please contact EPOMAKER directly through their official website or the retailer where the product was purchased. Keep your purchase receipt as proof of purchase.

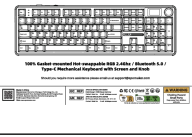
EPOMAKER is committed to providing quality products and customer satisfaction. Refer to the official EPOMAKER website for the most current support resources and contact details.

	<p>EPOMAKER HE68 65% Hall Effect RGB Analog Keyboard Quick Start Guide</p> <p>This guide provides setup instructions, function key combinations, lighting controls, rapid trigger customization, and switch replacement procedures for the EPOMAKER HE68 65% Hall Effect RGB Analog Keyboard.</p>
<p>HE75 Tri(X87-A)说明书 尺寸:210*140(骑马钉) 材质:128页铜板+覆膜 印刷:彩色印刷(双面印刷)</p>	<p>EPOMAKER HE75 MAG 75% Hall Effect Keyboard Quick Start Guide and Manual</p> <p>Comprehensive guide for the EPOMAKER HE75 MAG 75% Hall Effect Hot Swappable RGB Keyboard. Covers setup, connectivity (Bluetooth, 2.4G, Wired), key functions, customization via driver, and switch replacement.</p>
	<p>EPOMAKER x Aula F108 Mechanical Keyboard Quick Start Guide</p> <p>This guide provides instructions for setting up and using the EPOMAKER x Aula F108 mechanical keyboard, including pairing, lighting effects, and troubleshooting.</p>
	<p>EPOMAKER TH99 Keyboard Technical Specifications</p> <p>Detailed technical specifications for the EPOMAKER TH99 keyboard, including layout, connectivity, features, and compatibility.</p>
	<p>EPOMAKER F108 PRO Mechanical Keyboard Quick Start Guide</p> <p>This guide provides instructions for setting up and using the EPOMAKER F108 PRO mechanical keyboard, including connection methods, function key combinations, and troubleshooting.</p>
	<p>EPOMAKER X AULA F65 PRO Mechanical Keyboard Quick Start Guide</p> <p>This guide provides instructions for setting up and using the EPOMAKER X AULA F65 PRO mechanical keyboard, covering wired, Bluetooth, and 2.4G wireless connections, lighting effects, and troubleshooting.</p>

Documents - EPOMAKER – WIN68 HE

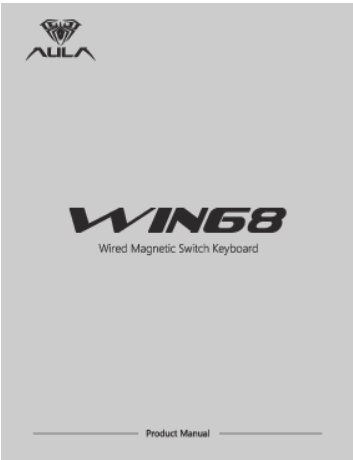

[pdf] User Manual

F108pro RGB EPOMAKER Aula WIN68 HE Magnetic Keyboard with Adjustable Actuation Hall Effect Switches 65% Wired Compact 8000 Hz Polling Rate Hot Swappable BlackWIN68 User Manual Black B0DRY7N36G B0DR2L6TY2 B0DR2K9YMP B0DRY8RRRXC1gOgElxEDLm media amazon images I C1gOgElxEDL |||

...

lang: score:17 filesize: 4.89 M page_count: 18 document date: 2025-03-08