

Manuals+

[Q & A](#) | [Deep Search](#) | [Upload](#)

manuals.plus /

› [STECHRO](#) /

› [STECHRO WD76 Water Leak Detector Instruction Manual](#)

STECHRO WD76

STECHRO WD76 Water Leak Detector Instruction Manual

Model: WD76

1. INTRODUCTION

The STECHRO WD76 Water Leak Detector is designed to provide early warning of water leaks and drips in your home. This device helps prevent potential water damage by alerting you with a loud alarm when water is detected. Its compact, IP66 waterproof design makes it suitable for various locations prone to leaks.



Illustration: Common household water leak scenarios.

2. PRODUCT FEATURES

- **Dual Detection Modes:** Equipped with 4 bottom flood probes and 1 top drip sensor for comprehensive water leakage and drip detection.
- **Adjustable Audio Alarm:** Features 4 levels of adjustable volume, ranging from 0-120dB, allowing customization to suit your environment. The alarm can be muted by pressing the sensor's button.
- **IP66 Waterproof:** Designed with IP66 waterproof rating for prolonged use in high humidity areas without compromising functionality.
- **Long Battery Life:** Low power design ensures up to 3 years of battery life.
- **Low Battery Alert:** Conveniently reminds you to change batteries in time.

- **Compact & Versatile:** Creative triangular shape and compact size allow for placement in various tight spaces like basements, kitchens, sinks, and laundry rooms.

Important Note: This Water Leak Sensor (Model: WD76) does not have WiFi/Bluetooth/APP functions, does not support connecting to the Stechro W13 WiFi gateway, and cannot work with other smart home products requiring these features.

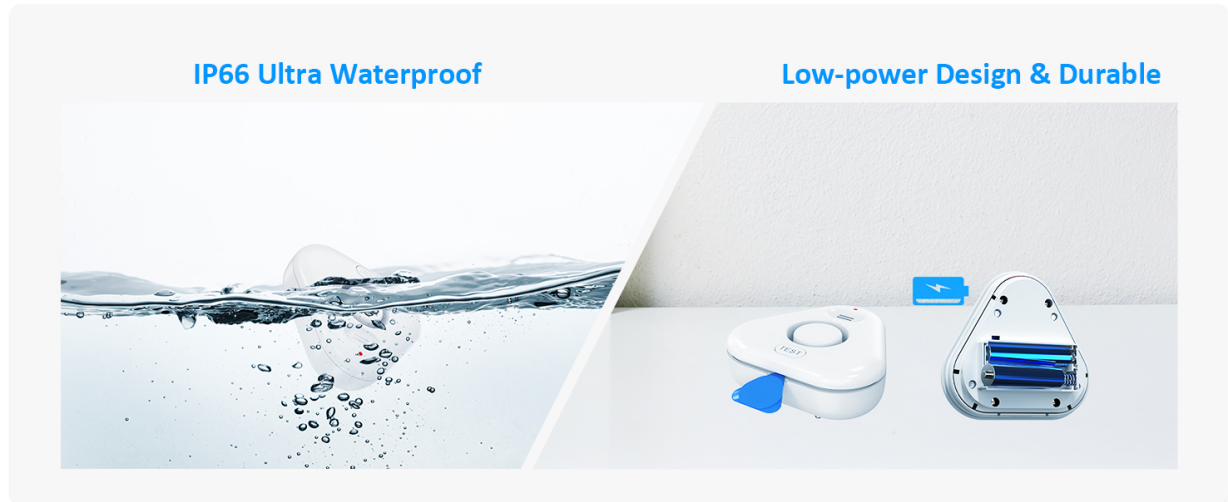

Image: WD76 is a standalone device and does not support WiFi connectivity.

3. PACKAGE CONTENTS

Your STECHRO WD76 Water Leak Detector package includes:

- 5 x Water Leak Detectors (Model: WD76)
- 10 x AAA Batteries
- 2 x Open Tools
- 1 x User Manual



Image: Contents of the STECHRO WD76x5 Water Leak Detector package.

4. SETUP & INSTALLATION

4.1 Battery Installation

1. Use one of the provided blue opening tools to gently press the socket inward and then rotate clockwise to open the product casing.
2. Insert two AAA batteries into the battery compartment, ensuring correct polarity (+/-).
3. Align the reference line and recap the plastic cover, pressing firmly until it clicks into place.



Image: Battery installation steps.

4.2 Placement

Place the water leak detector in areas where water leaks are likely to occur. Ensure the bottom probes are in contact with the surface where water might pool, or the top drip sensor is positioned to catch drips.

- Under sinks (kitchen, bathroom)
- Near washing machines and dishwashers
- In basements or utility rooms
- Near water heaters
- Under refrigerators with ice makers

5PCS Water Leak Detectors



Image: Multi-scenario placement for water leak detection.

5. OPERATING INSTRUCTIONS

5.1 Leak Detection

The WD76 detector utilizes both bottom flood probes and a top drip sensor to detect water. When water makes contact with either the probes or the sensor, the alarm will activate.

Dripping & Leaking Water Alarm

2 Detection Methods, Wider Applications



Image: Dripping and leaking water alarm detection.

5.2 Alarm Activation

Upon detecting water, the device will emit a loud audio alarm (up to 120dB) to alert you. A red indicator light will also flash.

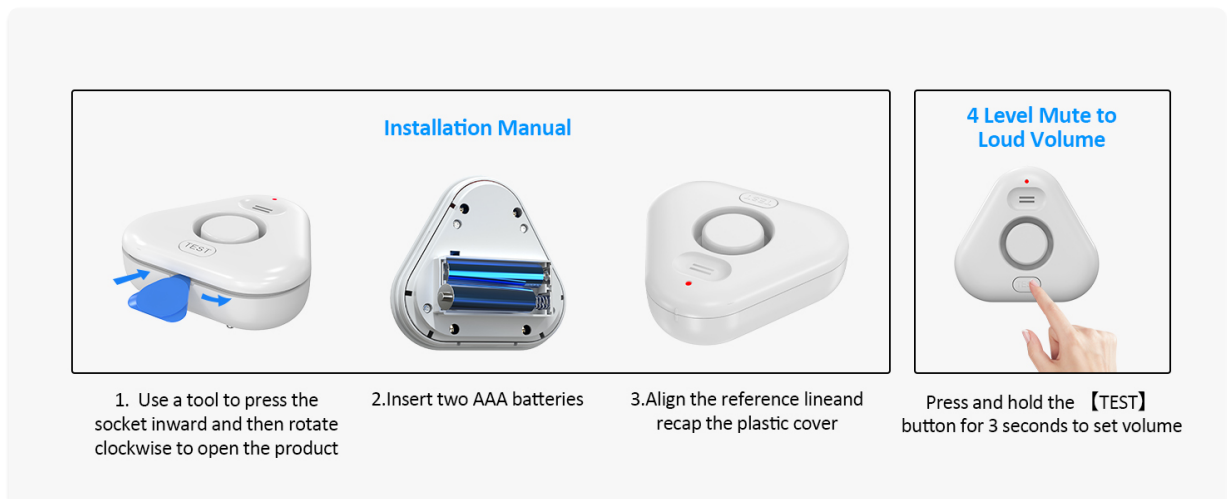

Image: Loud alarm sound for effective alert.

5.3 Stopping the Alarm

To stop the alarm after a leak is detected and addressed, simply press the 'TEST' button located on the front of the device.

5.4 Adjustable Volume

The WD76 offers 4 levels of adjustable volume. To change the volume, press and hold the 'TEST' button for 3 seconds. The device will cycle through the volume levels (DiDi-DiDi (120dB), DiDi-Di, Di-Di, Di (Mute)). Release the button at your desired volume level.

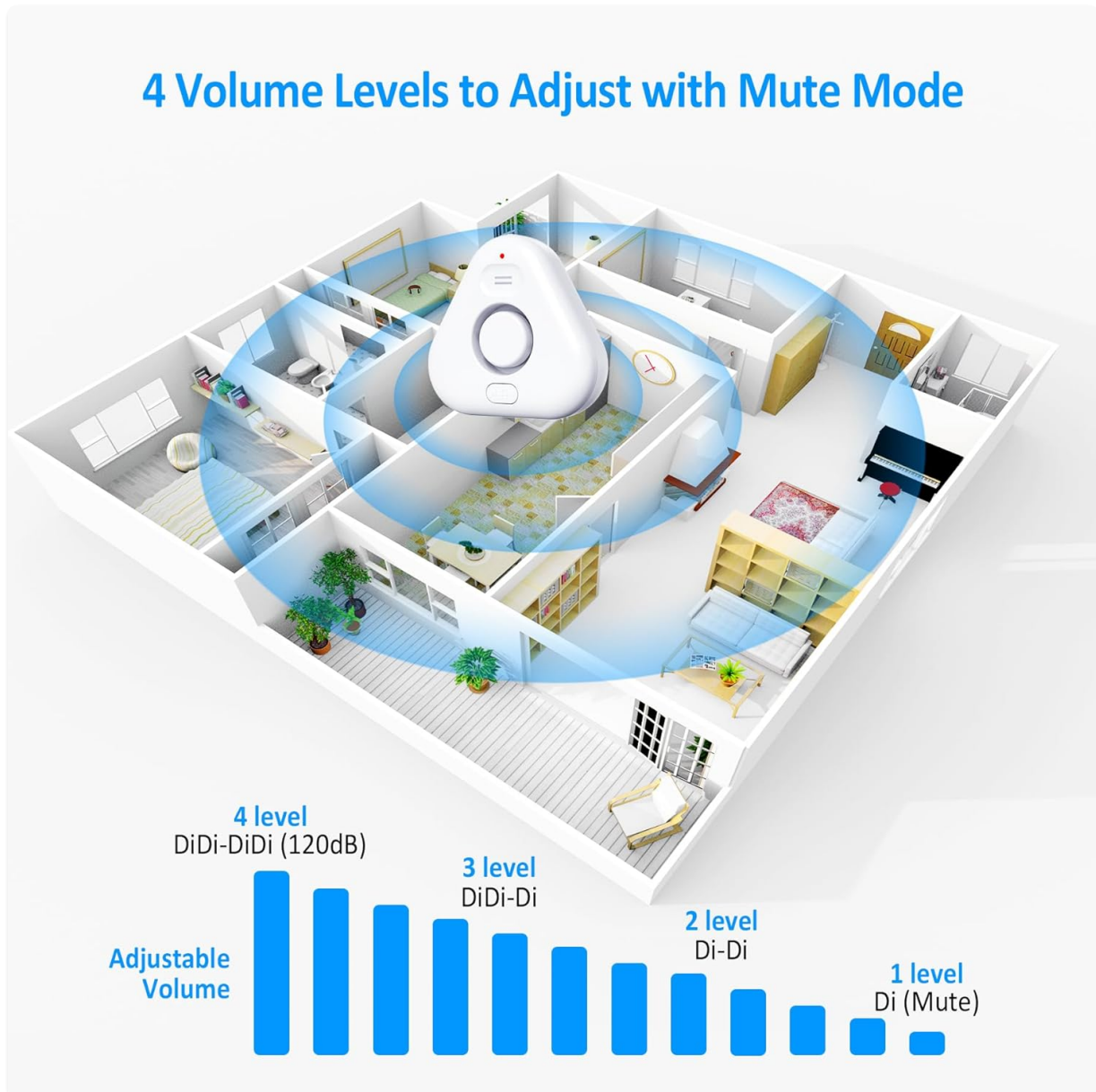

Image: 4 volume levels to adjust with mute mode.

6. MAINTENANCE

- **Low Battery Alert:** When the battery is low, the device will provide an alert to remind you to replace the AAA batteries.
- **Battery Replacement:** Replace batteries promptly when a low battery alert is issued to ensure continuous protection. Refer to section 4.1 for battery installation steps.
- **Cleaning:** After an alarm, wipe off any water from the detector's sensors and casing to keep it dry and ready for future use.
- **Regular Testing:** Periodically press the 'TEST' button to ensure the alarm is functioning correctly.

Multi-scenario Detection

Meet all of your daily needs



Image: IP66 Ultra Waterproof and Low-power Design for extended use.

7. TROUBLESHOOTING

- **Alarm not sounding:** Check if batteries are correctly installed and not depleted. Ensure the device is not in mute mode.
- **False alarms:** Ensure the device is placed on a dry surface and not in an area with high condensation that could trigger the sensors.
- **Weak alarm sound:** Check battery level. Adjust volume settings by pressing and holding the 'TEST' button.

8. SPECIFICATIONS

Feature	Specification
Model Number	WD76
Power Source	Battery Powered (2x AAA batteries per detector)
Battery Type	Alkaline

Battery Life	Up to 3 years
Noise Level	Up to 120 Decibels (4 adjustable levels)
Control Method	Touch (Test/Mute button)
Sensor Technology	Capacitive Sensor (4 bottom probes, 1 top drip sensor)
Waterproof Rating	IP66
Product Dimensions	2.89 x 2.89 x 1.04 inches
Item Weight	15.8 ounces (for 5-pack)

9. WARRANTY & SUPPORT

STECHRO is committed to providing high-quality products and customer satisfaction. Your purchase includes lifetime technical support. For any questions, concerns, or technical assistance, please contact STECHRO customer service.

10. OFFICIAL PRODUCT VIDEOS

Why not choose Stechro Water Leak Sensor

Your browser does not support the video tag.

Video: This video highlights the benefits and features of the STECHRO Water Leak Sensor, demonstrating its effectiveness in various home environments.

Any house NEEDS Stechro Water Sensor Alarm for peace of mind

Your browser does not support the video tag.

Video: This video emphasizes the importance of having a STECHRO Water Sensor Alarm for peace of mind, showcasing its practical application in preventing water damage.

Water SENSORS

Your browser does not support the video tag.

Video: A brief preview demonstrating the functionality of the water sensors, including how they detect water and trigger an alarm.