

[Manuals.plus](#) /

› [GarveeLife](#) /

› GarveeLife Ice Fishing Insulated Tent, 3-4 Persons (70 x 70 x 79 inches) Instruction Manual

GarveeLife B0FVFN5TK4

GarveeLife Ice Fishing Insulated Tent Instruction Manual

Model: B0FVFN5TK4

1. PRODUCT OVERVIEW

The GarveeLife Ice Fishing Insulated Tent is a portable, hub-style shelter designed for 3-4 persons, offering a comfortable and warm environment for ice fishing. Its insulated construction and easy setup make it ideal for cold weather conditions.



Image: Two individuals comfortably fishing inside the blue GarveeLife Ice Fishing Tent, with a view of the snowy outdoors through a tent window.

2. COMPONENTS (WHAT'S IN THE BOX)

- Ice Fishing Tent
- Ice Anchors x8
- Rope x4
- Storage Bag x1



Image: The GarveeLife Ice Fishing Tent with its dimensions and a visual representation of the included accessories: ice anchors, ropes, and a storage bag.

3. SETUP INSTRUCTIONS

The GarveeLife Ice Fishing Tent features an easy pop-up design for quick assembly. It is recommended to practice setup at home before your first trip to the ice.

1. Remove the tent from its storage bag and lay it flat on the ice.
2. Extend each hub-style wall outwards until it locks into place, forming the tent's structure.
3. Push up the roof hub to fully expand the tent.
4. Secure the tent to the ice using the provided ice anchors and ropes to prevent it from blowing away in windy conditions.

POP-UP ICE FISHING TENT

FEW STEPS FOR FAST ASSEMBLY

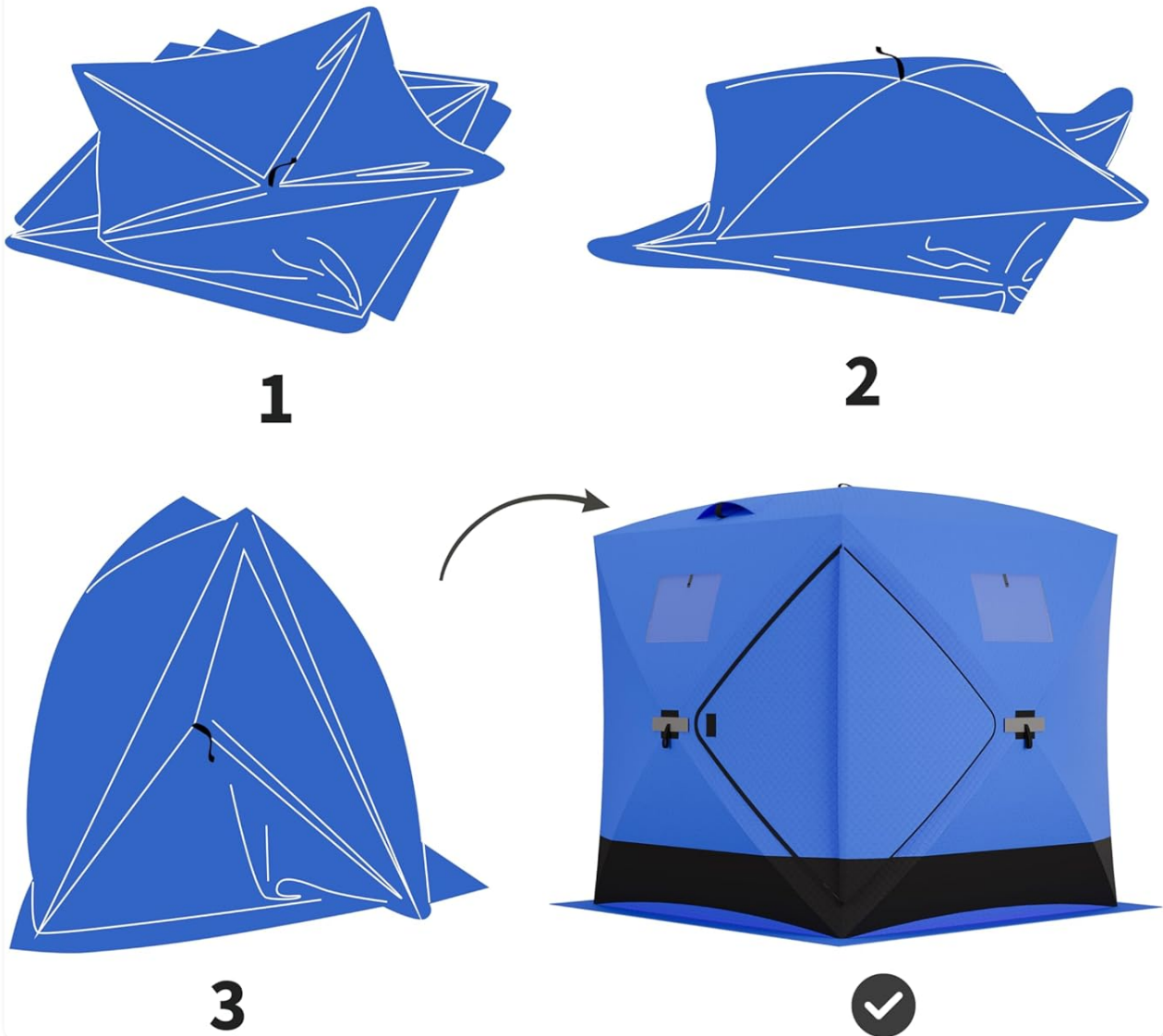

Image: Visual guide demonstrating the quick assembly process of the pop-up ice fishing tent.

Setup Video Guide

Your browser does not support the video tag.

Video: A detailed guide on how to set up and take down the Pop Up Ice Fishing Tent by Garvee Direct.

4. OPERATING INSTRUCTIONS

The tent is designed for comfort and functionality during ice fishing. It features multiple access points and ventilation options.

- **Doors:** The tent includes two zippered doors for easy entry and exit. Ensure zippers are fully closed to retain heat.
- **Windows:** Clear PVC windows allow for visibility of your surroundings. They can be covered for privacy or to block light.

- **Air Vents:** Integrated air vents provide necessary ventilation, especially when using a heater inside the tent.
- **Mesh Bags:** Internal mesh bags are available for storing small items and keeping the interior organized.



Image: An exploded view highlighting key features of the GarveeLife Ice Fishing Tent, such as windows, doors, air vents, and the warmth-retaining fabric.

5. MAINTENANCE

To ensure the longevity of your GarveeLife Ice Fishing Tent, follow these maintenance guidelines:

- **Cleaning:** Hand wash the tent with mild soap and water. Do not use harsh chemicals or machine wash.
- **Drying:** Ensure the tent is completely dry before folding and storing to prevent mold and mildew.
- **Inspection:** Regularly inspect zippers, fabric, and poles for any signs of wear or damage. Repair as

needed.

6. STORAGE AND TEARDOWN

Proper storage and teardown will extend the life of your tent.

1. Unsecure all ice anchors and ropes.
2. Collapse the roof hub, then gently push in each wall hub until the tent folds flat.
3. Fold the tent neatly to fit into its storage bag.
4. Store in a cool, dry place away from direct sunlight.

Teardown Video Guide

Your browser does not support the video tag.

Video: A short demonstration of the portability and ease of packing the 3-4 Person Ice Fishing Shelter.

7. TROUBLESHOOTING

- **Difficulty with Setup/Teardown:** Ensure all hubs are fully extended or collapsed. Practice the process a few times to become familiar with the mechanism.
- **Tent Instability:** Always use all provided ice anchors and ropes to secure the tent firmly to the ice, especially in windy conditions.
- **Cold Drafts/Poor Insulation:** Verify that all zippers are completely closed and the tent skirt is properly sealed against the ice to minimize heat loss.
- **Damaged Windows/Zippers:** Inspect these components regularly. Minor tears in windows can be repaired with clear tent repair tape. Damaged zippers may require professional repair or replacement.

8. SPECIFICATIONS

Brand	GarveeLife
Product Dimensions	70"L x 70"W x 78"H
Item Weight	23.04 Pounds
Recommended Uses	Fishing
Occupancy	4 Person
Seasons	4 Season
Material	Polyester
Color	Blue
Closure Type	Zipper
Water Resistance Level	Water Resistant
Model Name	Ice Fishing Tent
UPC	199641389763

9. WARRANTY & SUPPORT

Your GarveeLife Ice Fishing Tent comes with a **30-day manufacturer warranty**. For any questions, concerns, or warranty claims, please contact GarveeLife customer support through your original point of purchase.