



Manuals.plus /

› AsiaHorse /

› AsiaHorse Aurora ARGB PSU Cable Cover Kit User Manual

AsiaHorse Aurora ARGB PSU Cable Cover Kit

AsiaHorse Aurora ARGB PSU Cable Cover Kit

Model: Aurora ARGB PSU Cable Cover Kit

[Introduction](#)

[Safety Information](#)

[Package Contents](#)

[Installation](#)

[Operation](#)

[Maintenance](#)

[Troubleshooting](#)

[Specifications](#)

[Warranty & Support](#)

1. INTRODUCTION

The AsiaHorse Aurora ARGB PSU Cable Cover Kit is designed to enhance the aesthetic appeal of your PC build by providing addressable RGB lighting effects to your power supply unit (PSU) cables. This kit features a modular design that integrates ARGB light strips with your existing PSU extension cables, offering vibrant and customizable lighting synchronized with your motherboard's ARGB system. It is compatible with 12+4-Pin, 8-Pin, and 24-Pin cables, ensuring broad compatibility with various PC components.

2. SAFETY INFORMATION

- Ensure your PC is completely powered off and unplugged from the wall outlet before installation.
- Avoid touching electrical components directly during installation.
- Handle the ARGB cable covers and connectors with care to prevent damage.
- Do not force connectors. Ensure proper alignment before plugging them in.
- This product is designed for indoor use only.
- Keep out of reach of children.

3. PACKAGE CONTENTS

The AsiaHorse Aurora ARGB PSU Cable Cover Kit typically includes:

- ARGB PSU Cable Covers (e.g., 24-pin, 2x8-pin)
- Transparent plastic clips/cable buckles for securing cables
- ARGB 5V 3-pin connection cables

Note: This product does not include power supply unit (PSU) cables. It is designed to cover existing PSU extension cables.

INSTALLATION INSTRUCTIONS

How to Properly Install
the ARGBPSU Extension Cable Cover Kit (24-pin + 2*8-pin)

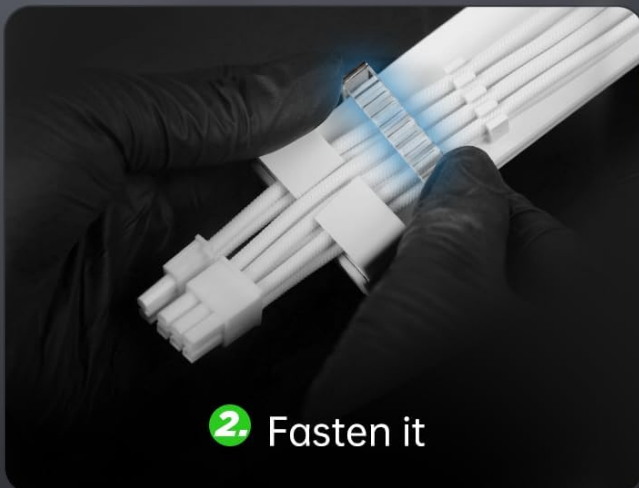
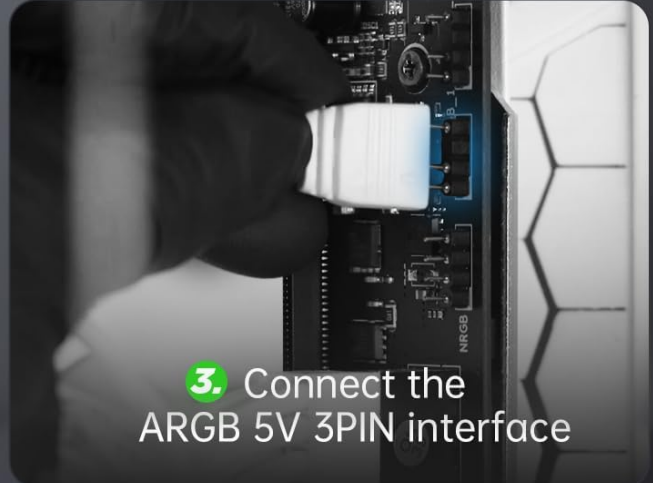

Image: Visual guide for installing the ARGB PSU Cable Cover Kit, showing clipping, fastening, connecting, and adjusting.

Video: Official installation guide for the AsiaHorse Aurora Cable Cover Kit, demonstrating the step-by-step process.

5. OPERATION

The AsiaHorse Aurora ARGB PSU Cable Cover Kit utilizes Addressable RGB (ARGB) technology, allowing individual control over each LED for dynamic and complex lighting patterns. To operate and customize the lighting:

- **Motherboard Software:** If connected to your motherboard's 5V 3-pin ARGB header, use the motherboard manufacturer's dedicated RGB software (e.g., ASUS Aura Sync, MSI Mystic Light Sync, GIGABYTE RGB Fusion, ASRock Polychrome Sync) to control colors, effects, and synchronization with other ARGB components.
- **ARGB Controller:** If connected to an external ARGB controller, refer to the controller's manual for instructions on how to select lighting modes, adjust brightness, and change colors.

ARGB offers smoother lighting effects compared to basic RGB, providing a more vibrant and synchronized light show.



Image: Depicts the ARGB Sync feature, showing compatibility with various motherboard RGB software and a color selection interface.

Video: An overview of the AsiaHorse Aurora RGB Power Extension Cable Cover Kit, showcasing its features and lighting capabilities.

6. MAINTENANCE

To ensure the longevity and optimal performance of your AsiaHorse Aurora ARGB PSU Cable Cover Kit, follow these maintenance guidelines:

- **Cleaning:** Gently wipe the cable covers with a soft, dry, anti-static cloth to remove dust. Do not use liquid cleaners or abrasive materials.
- **Cable Management:** Periodically check cable routing to ensure no cables are pinched or under excessive tension, which could damage the internal wiring or LED strips.
- **Connection Check:** Ensure all ARGB connections remain secure. Loose connections can lead to inconsistent lighting or functionality issues.

The ARGB LED beads are designed for an ultra-long lifespan of 20,000 hours, minimizing concerns about light decay under

normal operating conditions.



Image: Highlights the 20,000-hour lifespan of the ARGB LED beads, ensuring continuous operation.

7. TROUBLESHOOTING

If you encounter issues with your ARGB PSU Cable Cover Kit, refer to the following common problems and solutions:

Problem	Possible Cause	Solution
Lights are not turning on.	Loose ARGB connection, incorrect header, no power.	Ensure the 5V 3-pin ARGB connector is securely plugged into a compatible header. Verify the PC is powered on. Check motherboard software settings.
Inconsistent or incorrect colors.	Software conflict, incorrect ARGB mode, faulty connection.	Update motherboard RGB software. Ensure only one RGB software is controlling the effects. Re-check ARGB connections. Try different lighting modes.
Lights stop working after PC shutdown/restart.	Motherboard BIOS settings, software issue.	Check your motherboard's BIOS settings for ARGB power options during shutdown. Ensure RGB software is configured to start with Windows or apply settings on boot. Reconnect the ARGB cable.
Lights are too bright.	Brightness setting is too high.	Adjust the brightness level through your motherboard's RGB software or external ARGB controller.

8. SPECIFICATIONS

Feature	Detail
Brand	AsiaHorse
Model	Aurora ARGB PSU Cable Cover Kit
Connector Type	ATX (5V 3-Pin ARGB)
Cable Compatibility	12+4-Pin, 8-Pin, 24-Pin PSU extension cables
Special Features	Addressable RGB (ARGB), Modular Design, Ultra-Long Lifespan (20,000 hours)
Compatible Devices	Motherboards with 5V 3-Pin ARGB headers, ARGB controllers
Color	Black (also available in White)
Item Weight	0.25 Kilograms
Number of Items	2 (typically for 24-pin and 2x8-pin)

9. WARRANTY AND SUPPORT

This AsiaHorse Aurora ARGB PSU Cable Cover Kit comes with a **2-Year Manufacturer Warranty**. For warranty claims, technical support, or further assistance, please contact AsiaHorse customer service through their official website or the retailer where the product was purchased.

Please retain your proof of purchase for warranty validation.

