

## LinkSun G-425-1

# LinkSun G-425-1 Blood Glucose Monitor Kit Instruction Manual

## INTRODUCTION

---

This manual provides detailed instructions for the safe and effective use of your LinkSun G-425-1 Blood Glucose Monitor Kit. Please read all instructions carefully before use to ensure accurate results and proper device function.

### Intended Use

The LinkSun G-425-1 Blood Glucose Monitoring System is intended for *in vitro* diagnostic self-testing by individuals with diabetes in the home setting. It serves as an aid in monitoring the effectiveness of diabetes control and is designed for use with fresh capillary whole blood samples drawn from the fingertip.



**Excellent Accuracy  
Reliable Quality**



Image: LinkSun G-425-1 Blood Glucose Monitor Kit, emphasizing its accuracy and reliable quality.

## WHAT'S IN THE BOX

---

Your LinkSun G-425-1 Blood Glucose Monitor Kit includes the following components:

- 1 Blood Glucose Meter
- 1 Lancing Device
- 50 Test Strips
- 50 Lancets
- User Guide
- Carrying Case



**LinkSun®**

## Family Options

LinkSun devotes to blood glucose test, cares healthy life, spreads love and happiness.

Image: The complete LinkSun Blood Glucose Monitoring System kit, showing all included items.

### Product Overview Video

Video: An official overview of the LinkSun Blood Glucose Monitoring System, demonstrating its components and features.

### COMPONENTS OVERVIEW

---

The LinkSun G-425-1 system is designed for ease of use and accurate monitoring. Key features include a large screen display, 5-second fast test time, 500 reading memory, and no coding technology.

# Quick Setup Guide

## Time Setting

Press & hold M to enter setting mode.  
Order: Year → Month → Day → Hour  
→ Minute.  
Change: Short M / Confirm: Long M



## Unit Switch

(mmol/L ↔ mg/dL)  
After time is set, unit screen appears.  
Short press M to switch.  
Long press M to confirm.

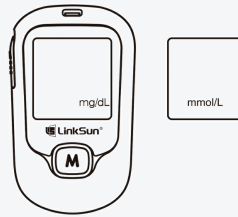

## Delete Memory

If records exist, short press M to view history.  
Long press M to show "dEL".  
Short press M to confirm delete.

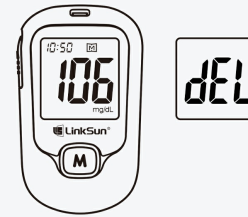

Image: Visual summary of the LinkSun Blood Glucose Monitoring System's main features and benefits.

## SETUP INSTRUCTIONS

### Battery Installation and Auto-Standby

The meter requires batteries for operation. After installing the batteries, the meter will enter an auto-standby mode. To activate the meter, simply insert a test strip; no button press is needed.



Image: Illustration of the meter's auto-standby function, activated by inserting a test strip.

### Lancing Device Setup

Follow these steps to prepare your lancing device for blood sample collection:

1. Unscrew the lancing device cap counterclockwise.
2. Remove the pen tip.
3. Insert a new lancet into the pen.
4. Unscrew the lancet cap (do not touch the needle).

- Twist clockwise to tighten the pen tip back on.
- Rotate the tip to set the desired lancing depth (1-5, with 5 being the deepest).
- Pull the tail of the lancing device until it clicks, indicating it is ready.

**Q3** What's control solution for?

**A3**

- Checks if meter & strips work properly by simulating blood test
- Steps:
  - Insert strip when off
  - Long-press "M" for CTL Mode.
  - Control soln on sterile; strip absorbs on contact.
  - Match Level 2 on test strip vial.
  - Out of range ❌ Expired      Within range ✅ Normal

CTL Mode

Control solution range	
Level:	Level 1/Level 2
mg/dL:	59-109 / 115-192
mmol/L:	3.3-6.1 / 6.4-10.7

Image: Detailed steps for installing a lancet and adjusting the lancing depth.

The lancing device offers 5 levels of lancing strengths to suit different skin types, ensuring a less painful experience.

**Q1** Why do results vary between brands?

**A1**

- Each brand uses unique algorithms and strip technologies
- All ISO 15197 certified devices meet clinical accuracy ( $\pm 15\%$ )

Different within  $\pm 60\text{mg/dL}$

Valid Data (different within  $\pm 15\%$ )

Valid Data (different within  $\pm 15\%$ )

Image: The lancing device in use, illustrating the 5-depth setting for comfortable blood sample collection.

## OPERATING INSTRUCTIONS

### Performing a Blood Glucose Test (6 Simple Steps)

Follow these steps for an accurate blood glucose measurement:

- Clean and Dry Your Hands:** Wash your hands thoroughly with soap and water, then dry them completely.
- Install the Lancet:** Prepare the lancing device as described in the 'Setup Instructions' section.
- Insert the Test Strip:** Insert a new test strip into the meter. The meter will turn on automatically.
- Collect Blood Sample:** Use the lancing device to prick your fingertip. Gently squeeze to form a small drop of blood.
- Get Result in 5s:** Touch the absorbent hole of the test strip to the blood drop. The meter will display the result in 5 seconds.
- Eject Test Strip & Lancet:** Dispose of the used test strip and lancet safely in a sharps container.



Image: Visual guide to the 6 simple steps for blood glucose testing.

### Quick Test Time

The LinkSun G-425-1 provides rapid results, with a countdown of just 5 seconds for daily testing.

# No coding, Reading



Image: The meter displaying a 5-second countdown for quick test results.

## No Coding Technology & Automatic Siphoning

The meter features a no-coding design, eliminating the need for manual code entry. Simply insert a test strip to begin. The test strip automatically absorbs the precise amount of blood needed (0.7 $\mu$ L) for accurate results. Ensure the blood drop is sufficient to fill the absorbent hole.

# Auto Coding, Reduce Error

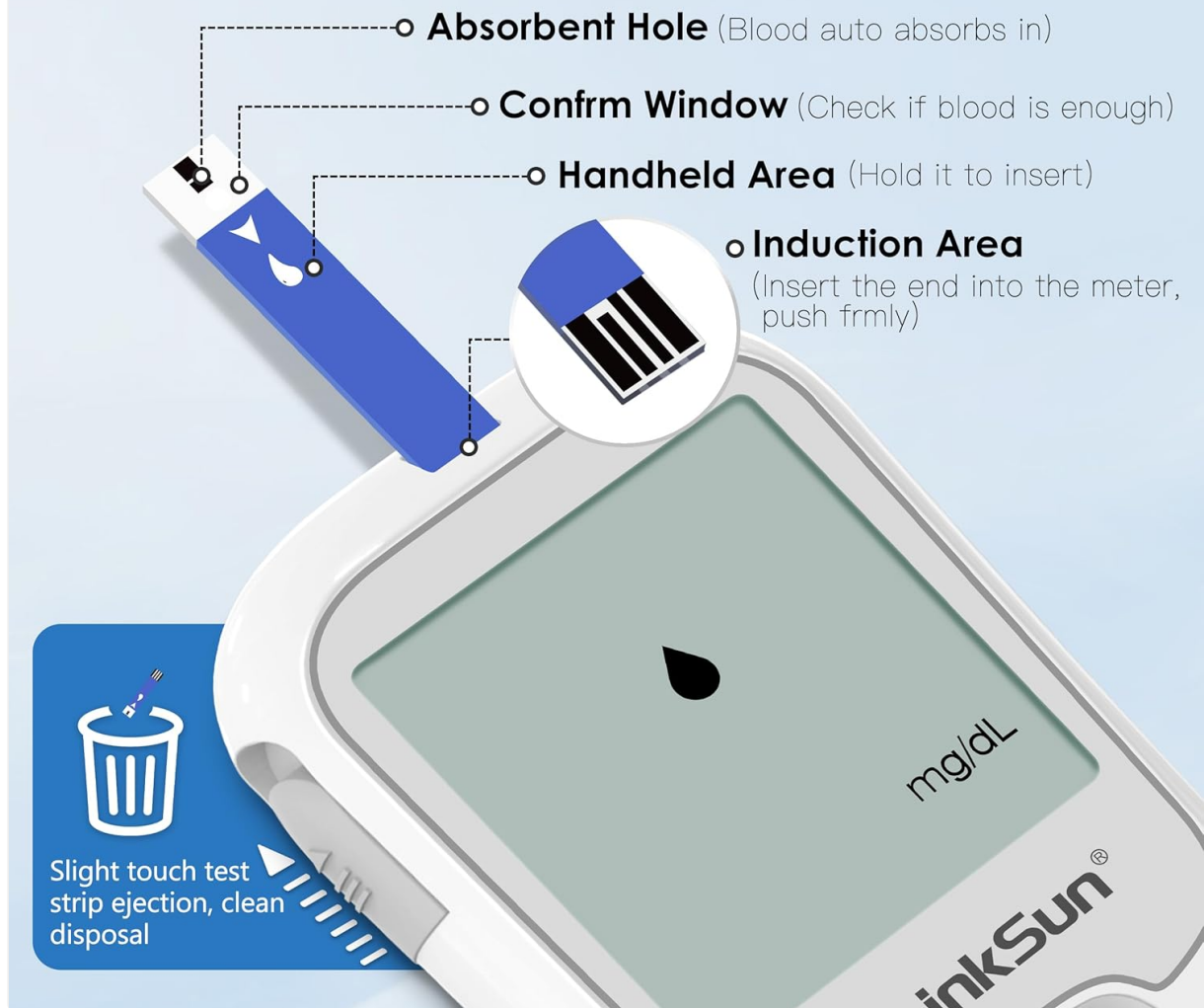

Image: Details of the test strip and meter's auto-coding and blood absorption features.



Image: Demonstrating the automatic siphoning technology for precise blood collection.

## Setting Time and Unit

To set the date, time, and unit (mmol/L or mg/dL) on your meter:

1. Press and hold the 'M' button to enter setting mode. The order for setting is Year → Month → Day →

Hour → Minute.

2. Briefly press 'M' to change the value. Long press 'M' to confirm and move to the next setting.
3. After time is set, the unit screen appears. Short press 'M' to switch between mmol/L and mg/dL. Long press 'M' to confirm.



Image: Instructions for setting the meter's time, date, and measurement unit.

## Tracking Records

Your meter stores up to 500 test results. To review past readings:

1. Press 'M' briefly while powered off to display '1' (first memory record).
2. After 1 second, it will automatically switch to show the latest test result.
3. Press 'M' button once more to cycle through previous test results.
4. Long press 'M' button to turn off the meter.



Image: Steps to access and review stored blood glucose readings.

## CONTROL SOLUTION TESTING (CTL MODE)

---

The control solution is used to check if the meter and test strips are working correctly. Always perform a control solution test when:

- You suspect the meter or test strips are not working properly.
- You open a new vial of test strips.
- You drop the meter.

### Procedure:

1. Insert a test strip when the meter is off.
2. Press and hold the 'M' button until the 'CTL' icon appears in the upper right corner of the screen. This activates CTL Mode.
3. Apply a drop of control solution onto the test well of the test strip.
4. Compare the result with the control solution range printed on the test strip vial. The result should fall within this range.
5. After testing, long-press 'M' again to return to blood measurement mode.

**Important: Testing without CTL Mode may give incorrect results. Always switch to CTL Mode before using control solution.**

Image: Steps for conducting a control solution test on the meter.

## How to Track the Records?

The date and time will cycle/alternate in display.



Image: Visual explanation of the purpose and procedure for using control solution.

## UNDERSTANDING YOUR BLOOD GLUCOSE RESULTS

### Blood Glucose Indicator Card

Refer to the following indicator card for general reference on blood glucose levels. Consult your healthcare professional for personalized target ranges and interpretation of your results.

**Q2** Why do home and hospital results differ?

**A2**

- Standard range:  $\pm 15\%$  difference is normal per ISO
- Home: Finger capillary whole blood
- Hospital: Venous plasma

Home Hospital

Image: A color-coded chart indicating various blood glucose level ranges.

### Factors Affecting Accuracy

Several factors can influence blood glucose readings. Understanding these can help ensure more accurate results:

- **Skin impurities:** Alcohol, sweat, or dirt on the skin can affect readings. Always clean hands with soap and water, then dry fully before testing.
- **Insufficient blood on the test strip:** Apply a full 0.7 $\mu$ L blood sample to the test strip.
- **Using the first drop of blood:** Discard the first drop of blood; use the second drop, avoiding alcohol interference.
- **Improper test strip storage:** Keep strips in a sealed container, away from heat and moisture.
- **Blood collected from non-fingertip sites:** Fingertip samples are generally the most accurate; alternate sites are less reliable.
- **Two tests run too quickly on the same blood:** Readings may vary up to 15% if tests are done within 5-10 seconds of each other.

## Differences in Readings

It is normal for blood glucose readings to vary slightly between different brands of meters or between home and laboratory tests.

### Why do results vary between brands?

Each brand uses unique algorithms and strip technologies. All ISO 15197 certified devices meet clinical accuracy ( $\pm 15\%$ ).



Image: Comparison illustrating why results may vary between different brands of blood glucose monitors.

### Why do home and hospital results differ?

A standard range of  $\pm 15\%$  difference is normal per ISO. Home tests typically use finger capillary whole blood, while hospital tests often use venous plasma.



Image: Visual representation of the difference between home and hospital blood samples.

## MAINTENANCE AND CARE

---

## Cleaning the Meter

Wipe the meter exterior with a soft, damp cloth. Do not immerse the meter in water or use harsh cleaning agents. Ensure the meter is dry before storage or next use.

## Storage

Store the meter, test strips, and lancets in a cool, dry place, away from direct sunlight and extreme temperatures. Keep test strips in their original vial and close the cap immediately after use to prevent moisture exposure.

## TROUBLESHOOTING

If you encounter any issues with your LinkSun G-425-1 Blood Glucose Monitor, refer to the following table for common error messages and their solutions:



Image: Troubleshooting guide for common error messages displayed on the meter.

## SPECIFICATIONS

Feature	Specification
Brand	LinkSun
Model Name	G-425-1
Product Dimensions	3.5"L x 2.2"W x 5.2"H
Item Weight	173 Grams
Battery Cell Composition	Alkaline

Included Components	1* blood glucose meter, 1* lancing device, 50* test strips, 50* lancets
Manufacturer	Bioland
UPC	029082409488

## WARRANTY AND SUPPORT

---

For warranty information, technical assistance, or any questions regarding your LinkSun G-425-1 Blood Glucose Monitor Kit, please contact LinkSun customer service. Refer to the product packaging or the official LinkSun website for the most current contact details.

### **Additional Product Information Video**

Video: An official video from LinkSun providing additional information on blood sugar management with their products.