

[manuals.plus](#) /

› [VIFOCUFY](#) /

› [VIFOCUFY 96W 48V 2A Adapter Charger User Manual](#)

VIFOCUFY SDI65-48-UD / SDI65-48-UDC-P6-C2

VIFOCUFY 96W 48V 2A Adapter Charger User Manual

Model: SDI65-48-UD / SDI65-48-UDC-P6-C2

1. INTRODUCTION

Thank you for choosing the VIFOCUFY 96W 48V 2A Adapter Charger. This power supply is designed to provide reliable and efficient power to compatible Saris and CycleOps smart bike trainers. This manual provides essential information for the safe and effective use of your new adapter charger, including setup, operation, maintenance, and troubleshooting.

Package Contents:

- 1 × VIFOCUFY 96W 48V 2A Adapter Charger
- Power Cord (attached)



Image 1.1: The VIFOCUFY 96W 48V 2A Adapter Charger with its integrated power cord.

2. SAFETY INFORMATION

Please read all safety instructions carefully before using the adapter charger. Failure to follow these instructions may result in electric shock, fire, or damage to the product or connected devices.

- Do not expose the adapter to water, moisture, or extreme temperatures.
- Do not disassemble, modify, or attempt to repair the adapter.
- Ensure the adapter is connected to a properly grounded power outlet.
- Avoid placing heavy objects on the power cord.
- Unplug the adapter from the power outlet when not in use for extended periods.
- Keep out of reach of children.

Built-in Safety Protections:

The VIFOCUFY adapter charger is equipped with multiple safety features to protect your devices:

- **Over Temperature Protection:** Prevents overheating of the adapter.

- **Short Circuit Protection:** Safeguards against short circuits.
- **Over Voltage Protection:** Protects against excessive voltage input.
- **Over Current Protection:** Prevents damage from excessive current draw.
- **Over Load Protection:** Protects against power overloads.
- **Over Charge Protection:** Ensures safe charging for compatible devices.



Image 2.1: Visual representation of the charger's built-in safety protection features.

3. PRODUCT OVERVIEW AND COMPATIBILITY

The VIFOCUFY 96W 48V 2A Adapter Charger is a high-quality power supply designed for specific smart bike trainers. It features a robust design and a standard round barrel connector for reliable power delivery.

Key Features:

- **Input:** AC 100-240V, 50-60Hz
- **Output:** DC 48V, 2A, 96W

- **Charging Port:** Round Jack (Barrel Connector)
- **Cable Length:** Approximately 7.5 feet (2.3 meters)
- **Color:** Black

Compatible Devices:

This adapter charger is compatible with the following smart bike trainer models:

- Saris 9830T H3, 9830TH3, 9830TF, 9830TF_0, 9830TF0, 9830TZ, M2, 9930T, 9930TF_0, 9930TF0 Direct Drive Smart Bicycle Cycle Indoor Bike Trainer
- CycleOps H2, M2, 9930T, 9820, 9820Z Direct Drive Smart Bike Trainer
- CycleOps Hammer 9810 H1 Smart Bike Trainer
- CycleOps Magnus 9920, 25420, 25420_0 Bicycle Smart Trainer
- Saris Direct Drive Smart Bike Trainer Model SDI65-48-UD, SD165-48-UD, SD16-48-UD, SDI65-48UD, SD165-48UD, SD16-48UD P/N: SDI65-48-UDC-P6-C2, SD165-48-UDC-P6-C2



48V 2A Charger Power Cord Replacement Compatible with CycleOps H2 Smart Bike Trainer

Image 3.1: The charger connected to a Saris bike trainer, illustrating its primary use.



Image 3.2: The charger's compatibility with CycleOps H2 Smart Bike Trainer, showing the barrel connector detail.

4. SETUP

Follow these steps to set up your VIFOCUFY adapter charger:

1. **Inspect the Charger:** Before connecting, visually inspect the adapter and its cables for any signs of damage. Do not use if any damage is observed.
2. **Connect to Device:** Locate the power input port on your compatible Saris or CycleOps smart bike trainer. Insert the round barrel connector of the VIFOCUFY adapter firmly into the device's power input port.
3. **Connect to Power Outlet:** Plug the AC power cord of the adapter into a standard AC 100-240V wall outlet. Ensure the outlet is easily accessible.
4. **Verify Connection:** Once connected, the indicator light on the adapter should illuminate, typically green, indicating that power is being supplied.



Image 4.1: Proper connection of the charger to a smart bike trainer and a wall outlet.

5. OPERATING INSTRUCTIONS

The VIFOCUFY adapter charger operates automatically once connected to a power source and a compatible device. It provides a stable 48V DC output to power your smart bike trainer.

Indicator Light:

- A **green** indicator light signifies that the adapter is receiving power and is ready to supply power to the connected device.
- If the light is **off**, check the power connections to both the wall outlet and the device.

The adapter is designed for continuous operation within its specified limits. Always ensure that the power requirements of your device do not exceed the adapter's 96W (48V 2A) output capacity.



Image 5.1: Operational details of the charger, including input, output, and charging port type.

6. MAINTENANCE AND CARE

Proper maintenance ensures the longevity and safe operation of your adapter charger.

- **Cleaning:** Disconnect the adapter from all power sources and devices before cleaning. Use a soft, dry cloth to wipe the surface. Do not use liquid cleaners or abrasive materials.
- **Storage:** When not in use, store the adapter in a cool, dry place away from direct sunlight and extreme temperatures. Avoid tightly coiling the cables to prevent damage.
- **Cable Management:** Regularly check the power cord and connector for any signs of fraying, cuts, or bends. Replace the adapter if any damage is found.

7. TROUBLESHOOTING

If you encounter issues with your VIFOCUFY adapter charger, refer to the following common problems and solutions:

Problem	Possible Cause	Solution
Adapter indicator light is off.	No power from outlet, loose connection, or faulty adapter.	<p>Check if the wall outlet is functional by plugging in another device.</p> <p>Ensure all connections (wall to adapter, adapter to device) are secure.</p> <p>If the issue persists, the adapter may be faulty and require replacement.</p>
Device is not powering on/charging.	Incorrect adapter, device issue, or insufficient power.	<p>Verify that the adapter's specifications (48V 2A) match your device's requirements.</p> <p>Ensure the adapter is fully plugged into both the wall and the device.</p> <p>Test the device with its original power supply (if available) to rule out a device issue.</p>
Adapter feels excessively hot.	Overload, poor ventilation, or internal fault.	<p>Disconnect the adapter immediately.</p> <p>Ensure the adapter is in a well-ventilated area and not covered.</p> <p>Verify that the connected device's power draw does not exceed 96W.</p> <p>If overheating continues, discontinue use and replace the adapter.</p>

Charger Safety Protection



Over Voltage
Protection



Over Temperature
Protection



Short Circuit
Protection



Over Current
Protection



Over Load
Protection



Over Charge
Protection

Image 7.1: Visual comparison highlighting the reliability of VIFOCUFY chargers.

8. SPECIFICATIONS

Detailed technical specifications for the VIFOCUFY 96W 48V 2A Adapter Charger:

- **Product Dimensions:** 5.3 x 2.4 x 1.3 inches (13.46 x 6.1 x 3.3 cm)
- **Item Weight:** 12.6 ounces (357.2 grams)
- **Input Voltage:** AC 100-240V, 50-60Hz
- **Output Voltage:** DC 48 Volts
- **Output Amperage:** 2 Amps
- **Output Wattage:** 96 Watts
- **Connector Type:** Barrel Connector (Round Jack)
- **Color:** Black
- **Special Features:** Over Load Protection, Over Temperature Protection, Short Circuit Protection, Over Voltage Protection, Over Current Protection, Over Charge Protection

Product Size

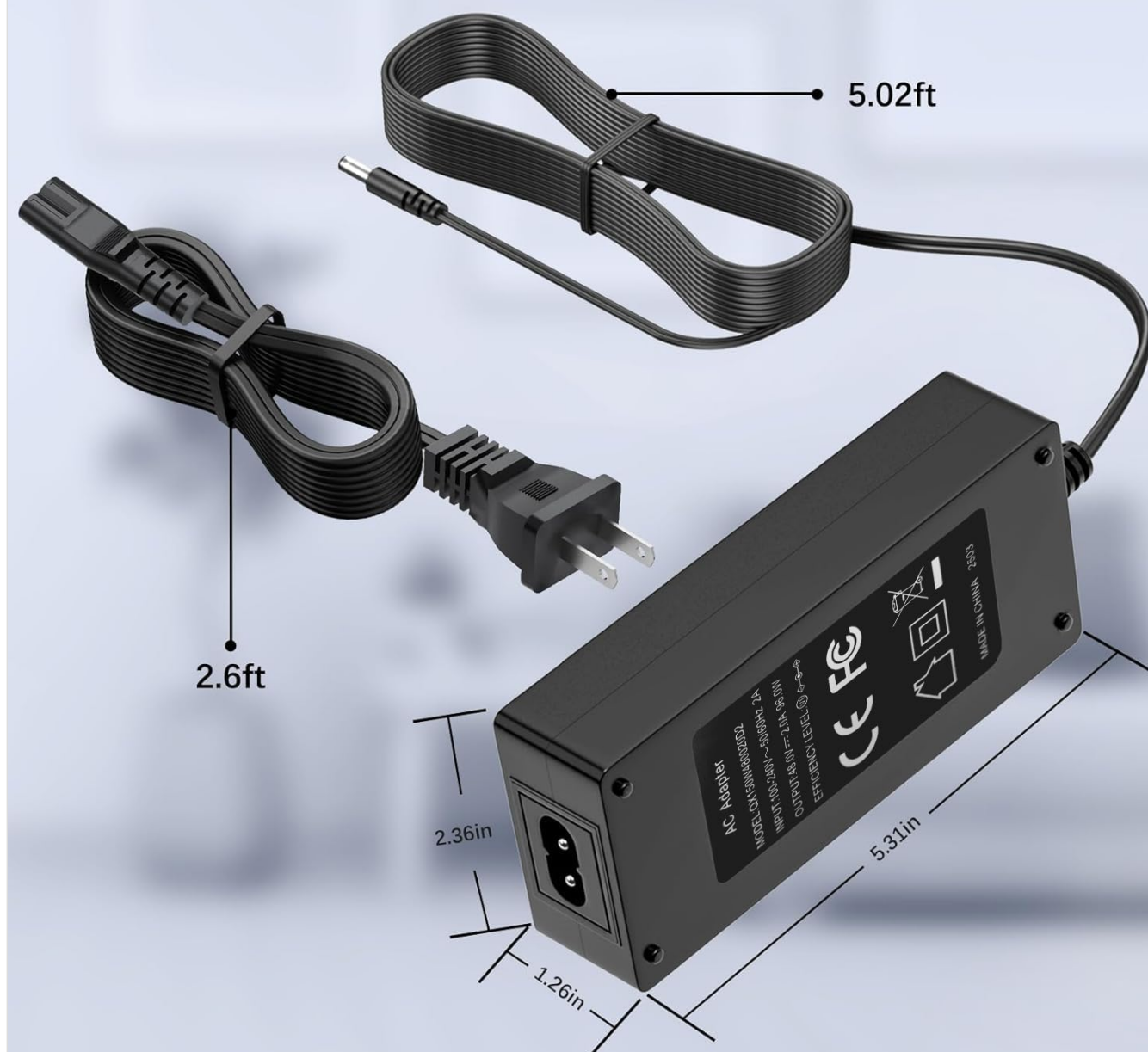

Image 8.1: Close-up details of the charger's components and features.

Product Details

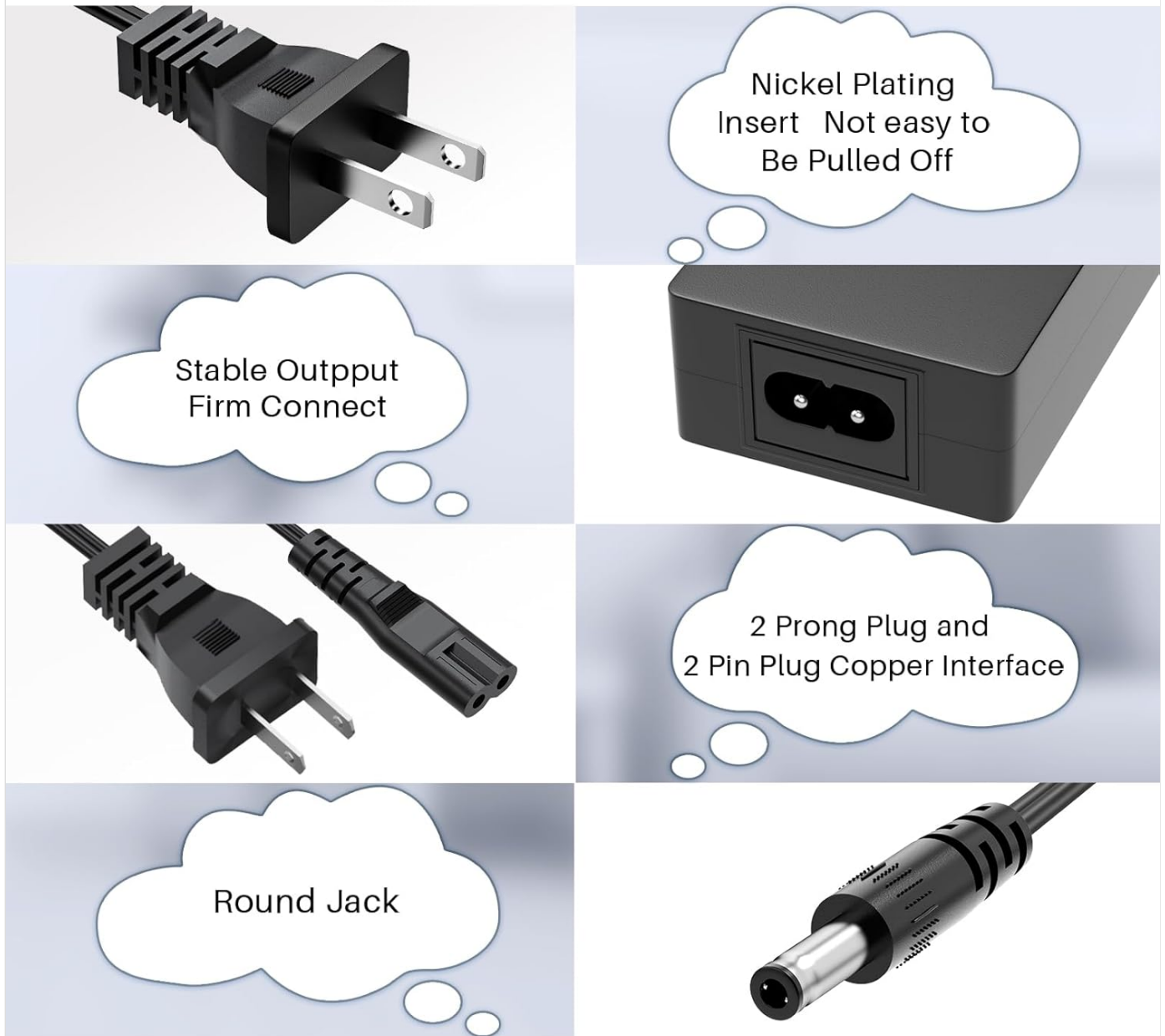

Image 8.2: Dimensions of the adapter and cable lengths.

9. WARRANTY AND SUPPORT

VIFOCUFY stands behind the quality of its products.

Quality Assurance:





This VIFOCUFY 96W 48V 2A Adapter Charger comes with a **12 Months Quality Assurance**. This warranty covers manufacturing defects and ensures the product performs as described under normal use.

Customer Support:

If you have any questions, concerns, or require assistance with your product, please contact VIFOCUFY customer support. We are committed to providing prompt support and solutions.

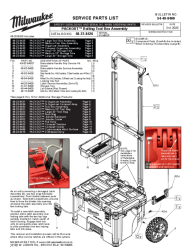
For support, please refer to the contact information provided with your purchase or visit the official VIFOCUFY store page on Amazon: [VIFOCUFY Amazon Store](#).

Related Documents - SDI65-48-UD / SDI65-48-UDC-P6-C2

	<p>Milwaukee Li-Ion Battery Pack Safety, Operation, and Warranty Information</p> <p>Comprehensive guide to safe operation, charging, maintenance, and warranty details for Milwaukee Li-Ion battery packs, including model numbers and important safety warnings.</p>
	<p>Milwaukee PACKOUT Service Parts List</p> <p>Detailed service parts list for Milwaukee PACKOUT tool storage systems, including tool boxes, organizers, totes, and dollies. Find part numbers, descriptions, and assembly instructions for various PACKOUT models.</p>
	<p>Milwaukee Lithium-Ion Battery Packs: Safety, Operation, and Warranty Information</p> <p>Comprehensive safety instructions, operating guidelines, functional descriptions, and warranty details for Milwaukee Lithium-Ion battery packs, including model numbers and troubleshooting tips.</p>
	<p>Milwaukee Lithium-Ion Battery Pack Safety, Operation, and Warranty Information</p> <p>This document provides essential safety instructions, functional descriptions, maintenance guidelines, transport information, disposal procedures, and warranty details for Milwaukee Lithium-Ion battery packs.</p>
	<p>Milwaukee M18 M12 Lithium-Ion Battery Charger & Packs Operator's Manual</p> <p>Official operator's manual for Milwaukee M18 and M12 Lithium-Ion battery chargers and battery packs. Includes safety instructions, operating procedures, maintenance, and warranty information.</p>



[Projecta Intelli-Grid 48V 4000W System User Manual](#)

User manual detailing the Projecta Intelli-Grid 48V 4000W power management system. Covers installation, operation, system components, key features, monitoring, and technical specifications for RVs and off-grid use.