



[Manuals.plus](#) /

> [TYT](#) /

> TYT 2500 lb ATV Electric Winch User Manual

## TYT TYT 2500 lb ATV Winch

# TYT 2500 lb ATV Electric Winch User Manual

Model: TYT 2500 lb ATV Winch

## 1. IMPORTANT SAFETY INFORMATION

---

Read and understand all instructions before installing, operating, or servicing this winch. Failure to follow these instructions may result in serious injury or property damage.

- Always wear appropriate personal protective equipment, including gloves and eye protection, when operating the winch.
- Never exceed the rated capacity of the winch (2500 lbs).
- Ensure the winch is securely mounted to a structure capable of withstanding the pulling force.
- Keep hands and clothing clear of the winch rope, hook, and fairlead during operation.
- Do not operate the winch if the rope is frayed, kinked, or damaged.
- Maintain a safe distance from the winch and load during operation.
- Disconnect power to the winch before performing any maintenance or adjustments.
- Avoid prolonged continuous operation to prevent overheating. Allow the motor to cool between heavy pulls.
- Never use the winch to lift people or objects over people.

## 2. PRODUCT OVERVIEW

---

The TYT 2500 lb ATV Electric Winch is designed for recovery and towing applications on ATVs, UTVs, and other off-road vehicles. It features a 12V DC motor, synthetic rope, and a wired remote control for safe operation.



Image 2.1: TYT 2500 lb ATV Electric Winch with wired remote control and clevis hook.

## 2.1 Components Included

The winch kit includes the following components:

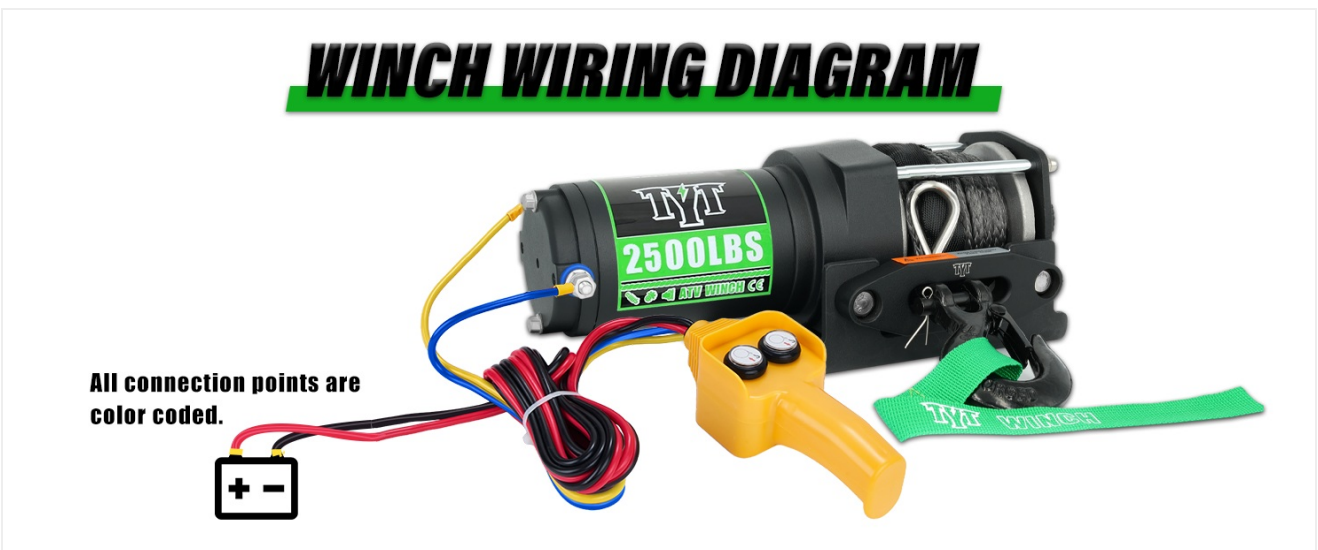

Image 2.2: Overview of included accessories: winch, installation bolts, instructions, clevis hook, mounting plate, aluminum fairlead, brand strap, and wired remote.

- TYT 2500 lb Electric Winch with Synthetic Rope

- Wired Remote Control
- Aluminum Fairlead
- Clevis Hook
- Mounting Plate
- Installation Bolts
- Brand Strap

### 3. INSTALLATION

---

#### 3.1 Mounting the Winch

Ensure the mounting surface on your ATV or UTV is strong enough to support the winch's maximum pulling force. The winch mounting plate is designed for standard mounting dimensions.

- **Fairlead Mounting Pattern:** 4 1/4" (108mm)
- **Mounting Plate 2-Hole:** 3.10" (78mm) / 3" (76mm)

Verify compatibility of these dimensions with your vehicle's winch bracket before proceeding with installation.



Image 3.1: Detailed dimensions of the winch, mounting plate, and fairlead for installation planning.

1. Position the mounting plate on your vehicle's winch bracket.
2. Secure the mounting plate using appropriate hardware.
3. Attach the winch to the mounting plate using the provided installation bolts.
4. Install the aluminum fairlead to the front of the mounting plate, ensuring the rope can pass through freely.

#### 3.2 Wiring Instructions

The winch operates on a 12V DC power supply. Ensure all connections are secure and properly insulated.

# ACCESSORY COMPONENTS

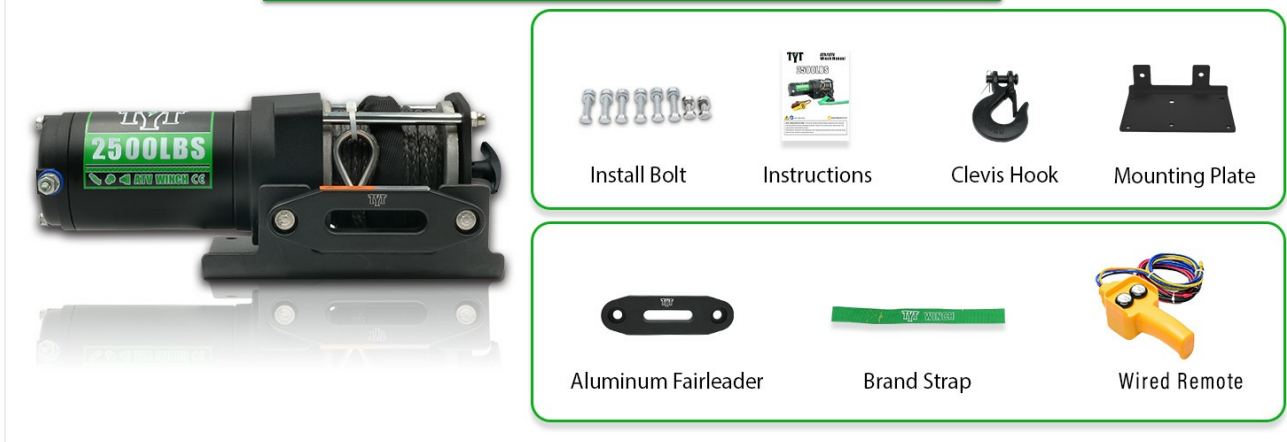

Image 3.2: Wiring diagram showing connections for the winch and wired remote control to a 12V battery.

1. Connect the red power cord from the wired remote control to the red terminal of the winch.
2. Connect the black power cord from the wired remote control to the black terminal of the winch.
3. Connect the remaining red wire from the remote control to the positive (+) terminal of your vehicle's 12V battery.
4. Connect the remaining black wire from the remote control to the negative (-) terminal of your vehicle's 12V battery.
5. Ensure all connections are tight and free from corrosion.

## 4. OPERATION

---

### 4.1 Wired Remote Control

The wired remote control allows for safe operation from a distance, keeping you clear of the winch rope and load.

# **HAND-HELD REMOTE WITH INTEGRATED RELAY SWITCH**



The hand-held, plastic remote has a relay switch inside that transmits power from your vehicle's battery to the winch.

Image 4.1: The wired remote control with integrated relay switch for operating the winch.

- Press the "IN" button to retract the synthetic rope.
- Press the "OUT" button to extend the synthetic rope.
- Release the button to stop the winch operation.

## **4.2 General Winching Procedures**

1. **Assess the Situation:** Determine the load weight, anchor point, and potential obstacles.
2. **Select Anchor Point:** Choose a strong, stable anchor point capable of holding the load. Use a tree saver strap or similar accessory to protect trees.
3. **Prepare the Rope:** Unspool enough synthetic rope to reach the anchor point. Ensure the rope is not twisted or kinked.
4. **Attach Hook:** Securely attach the clevis hook to the anchor point.
5. **Clear the Area:** Ensure all personnel are at a safe distance from the winch and rope.
6. **Begin Winching:** Use the wired remote control to slowly retract the rope. Observe the rope and load for any issues.
7. **Monitor Winch:** Listen for unusual noises and check for signs of overheating. If the motor becomes hot, pause operation to allow it to cool.
8. **Rewind Rope:** After use, carefully rewind the synthetic rope onto the drum under light tension to ensure even layering. Guide the rope by hand (wearing gloves) to prevent tangles.

## 5. MAINTENANCE

Regular maintenance ensures the longevity and safe operation of your winch.

- **Rope Inspection:** Regularly inspect the synthetic rope for cuts, abrasions, fraying, or other damage. Replace damaged rope immediately.
- **Hardware Check:** Periodically check all mounting bolts and electrical connections for tightness.
- **Cleaning:** Keep the winch clean and free of dirt, mud, and debris. Use a damp cloth to wipe down the exterior.
- **Lubrication:** Consult a qualified technician for internal lubrication requirements.
- **Storage:** When not in use, store the winch in a dry environment to prevent corrosion.

## 6. TROUBLESHOOTING

Problem	Possible Cause	Solution
Winch does not operate.	No power to winch; loose electrical connections; faulty remote control.	Check battery connections; ensure remote is properly plugged in; test remote control.
Winch operates slowly or with reduced power.	Low battery voltage; overloaded winch; motor overheating.	Charge vehicle battery; reduce load; allow motor to cool.
Rope is tangled or unevenly spooled.	Improper rewinding technique.	Unspool rope completely and rewind under light tension, guiding it evenly.
Winch makes unusual noises.	Internal mechanical issue; foreign object in drum.	Discontinue use and contact customer support.

## 7. SPECIFICATIONS

# 2500 LBS ATV/UTV WINCH



**MOTOR**  
12v 1.2hp

**GEARTRAIN**  
3-STAGE PLANETARY

**RATED SINGLE LINE PULL**  
2500lbs 1130kg

**SYNTHETIC ROPE**  
0.19" X 32ft 4.8mm X 10m

Image 7.1: Key specifications of the TYT 2500 lb ATV/UTV Winch.

Feature	Detail
Rated Line Pull	2500 lbs (1130 kg)
Motor	12V DC, 0.9kW / 1.2hp Permanent Magnet

Feature	Detail
Gear Train	3-Stage Planetary
Gear Ratio	153:1
Rope Type	Dyneema Synthetic Rope
Rope Dimensions	0.19" x 32 ft (4.8mm x 10m)
Fairlead	Aluminum Hawse Fairlead
Control	Wired Remote Control
Winch Dimensions	11.65 x 3.94 x 4.17 inches
Item Weight	15.49 pounds

## 8. WARRANTY AND SUPPORT

All TYT winches come with a one-year quality service and lifetime technical support.

Should you encounter any issues or require technical assistance, please contact TYT customer support. We are committed to resolving any problems within 12 hours.



Image 8.1: Information regarding TYT's one-year quality service and lifetime technical support.