

Manuals+

[Q & A](#) | [Deep Search](#) | [Upload](#)

[manuals.plus](#) /

› [Pongori](#) /

› [Pongori Decathlon Table Tennis Table for Clubs TTT 930 Approved by Ittf Black Blades - Table Tennis User Manual](#)

Pongori 8584579

Pongori Decathlon Table Tennis Table for Clubs TTT 930 User Manual

Model: 8584579

PRODUCT OVERVIEW

The Pongori Decathlon Table Tennis Table for Clubs TTT 930 is designed for club use and competitive play, offering a high-quality bounce approved by ITTF. This model incorporates the Lock Click System (LCS) safety mechanism, which securely holds the tabletop in the closed position, enhancing user safety during storage and transport. The table is engineered for single-person setup and storage, featuring integrated net storage for convenience.

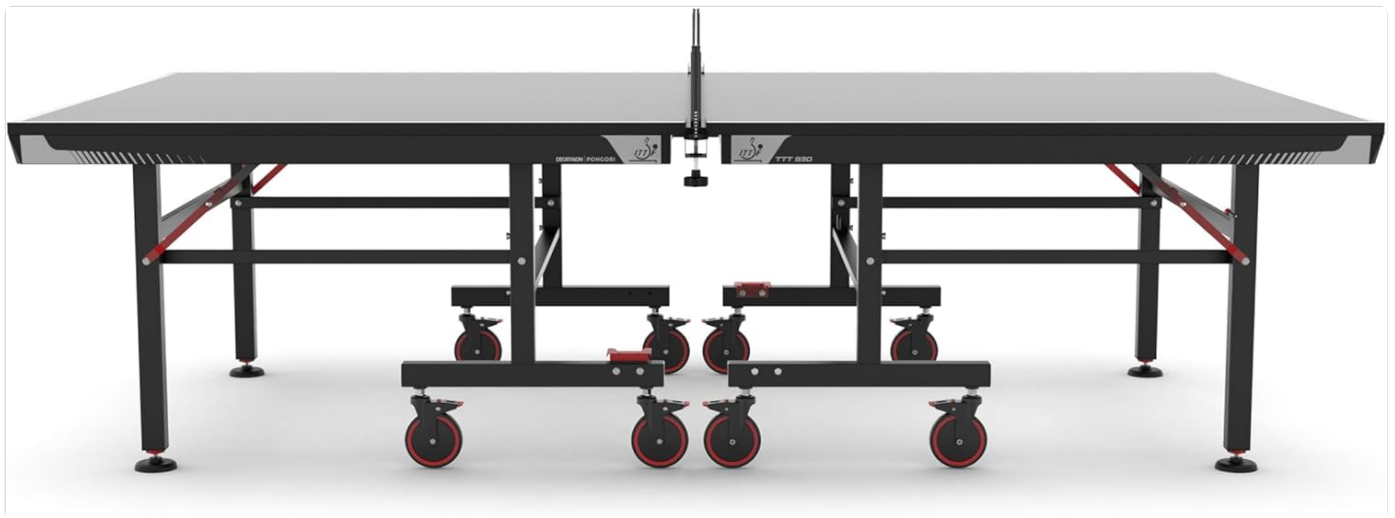

Image: The Pongori TTT 930 table tennis table in its full playing configuration, showcasing its sturdy black frame and playing surface.

SETUP AND ASSEMBLY

Unpacking and Initial Inspection

- Carefully remove all components from the packaging.
- Verify that all parts listed in the included components section are present.
- Inspect all parts for any signs of damage during transit. If damage is found, do not proceed with assembly and contact customer support.

Table Deployment

The TTT 930 table is designed for single-person deployment. Follow these steps to set up the table for play:

1. Ensure the table is on a flat, stable surface.
2. Unlock the safety mechanisms (Lock Click System - LCS) that secure the tabletop in the folded position.
3. Carefully unfold each half of the table, allowing the legs to extend.
4. Ensure all eight wheels are unlocked for movement during deployment.
5. Adjust the 90mm-diameter adjustable feet to level the playing surface, if necessary.
6. Once fully extended, engage the eight brakes on the wheels to secure the table in place.
7. Attach the net to the designated holders on the table.



Image: The table in its compact folded storage position, highlighting the safety mechanisms and integrated net storage.



Image: A close-up view of the table's base, showing the robust wheels and the locking mechanism for stability.

OPERATION

Playing Position

- Ensure both halves of the table are fully extended and locked into place.
- Confirm that the net is securely attached and taut across the center of the table.
- Verify that all eight wheel brakes are engaged to prevent accidental movement during play.

Playback Position (Solo Training)

To use the table for solo practice, one half of the table can be folded up:

1. Disengage the brakes on the wheels.
2. Carefully lift and fold one half of the tabletop upwards until it locks into the vertical playback position. Ensure the safety mechanisms engage.
3. Re-engage the wheel brakes for stability during solo play.



Image: The table configured in the playback position, with one half folded vertically for solo practice.

Storage Position

To fold and store the table:

1. Remove the net and store it in the dedicated holder behind the tabletop.
2. Disengage the wheel brakes.
3. Carefully lift and fold both halves of the tabletop upwards until they meet and lock securely using the Lock Click System (LCS).
4. Ensure all 2 automatic locking mechanisms and 4 locking straps are engaged for maximum safety.
5. The table can now be easily transported using its 8 wheels (125mm diameter) to its storage location.
6. Engage the wheel brakes once the table is in its final storage position.

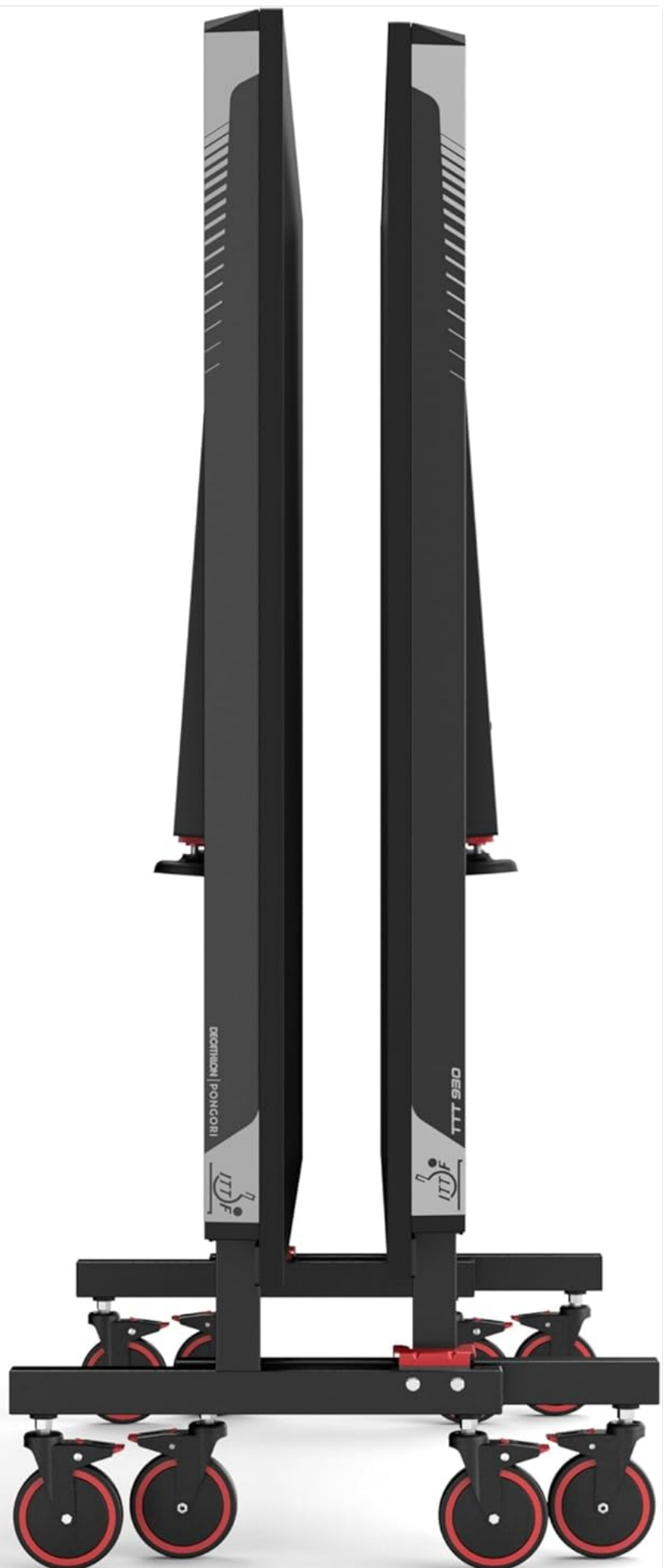

Image: A side view of the table in its compact storage position, demonstrating its space-saving design.

CARE AND MAINTENANCE

Cleaning

- **Tabletop:** Wipe the playing surface with a soft, damp cloth. Avoid abrasive cleaners or solvents that could damage the finish.
- **Frame and Legs:** Clean metal parts with a damp cloth. Dry thoroughly to prevent rust.
- **Net:** The net can be gently wiped with a damp cloth. Ensure it is dry before storing.

Storage

- Store the table in a dry, temperate environment to prevent warping or damage from extreme temperatures or humidity.
- Always store the table in its fully folded and locked position to ensure stability and safety.
- Utilize the built-in net storage behind the tabletop to keep the net secure and prevent loss.

Inspection

- Periodically check all bolts, screws, and fasteners to ensure they are tight. Tighten if necessary.
- Inspect the wheels and brakes for smooth operation and wear.
- Examine the safety locking mechanisms (LCS) to ensure they engage and disengage correctly.

TROUBLESHOOTING

| Problem | Possible Cause | Solution |
|---------------------------------|---|---|
| Table is unstable or wobbly. | Uneven floor surface; adjustable feet not properly set; wheel brakes not engaged. | Adjust the 90mm-diameter adjustable feet to level the table. Ensure all eight wheel brakes are engaged during play. |
| Table difficult to fold/unfold. | Safety mechanisms (LCS) not fully disengaged; obstruction; stiff hinges. | Ensure the Lock Click System (LCS) is fully disengaged. Check for any obstructions. Apply a small amount of lubricant to hinges if stiff. |
| Wheels not rolling smoothly. | Debris in wheels; wheel brakes engaged; damaged wheel. | Clean any debris from the wheels. Ensure wheel brakes are disengaged for movement. If a wheel is damaged, contact customer support for replacement. |
| Net is loose or sagging. | Net not properly attached or tightened. | Re-attach the net, ensuring it is securely fastened and adjusted for proper tension. |

TECHNICAL SPECIFICATIONS

| Feature | Specification |
|--------------|---------------|
| Model Number | 8584579 |
| Brand | Pongori |



| Feature | Specification |
|---------------------|--|
| Colour | Black |
| Material Type | Medium Density Fiberboard |
| Item Weight | 136 Kilograms |
| Number of Items | 1 |
| Included Components | 1 x Pongori Decathlon Table Tennis Table for Clubs TTT 930 Approved by ITTF Black Blades |
| Safety System | Lock Click System (LCS), 2 Automatic locking mechanisms, 4 locking straps |
| Wheels | 8 wheels, 125mm diameter |
| Brakes | 8 brakes |
| Adjustable Feet | 90mm diameter adjustable feet |
| Net Storage | Built-in net storage behind tabletop |

WARRANTY AND CUSTOMER SUPPORT

For specific warranty details, please refer to the warranty card included with your purchase or the product listing on the retailer's website. The warranty typically covers manufacturing defects under normal use conditions.

If you encounter any issues or require assistance with your Pongori Decathlon Table Tennis Table TTT 930, please contact the retailer or manufacturer's customer support. Have your model number (8584579) and purchase information ready for faster service.

Related Documents - 8584579

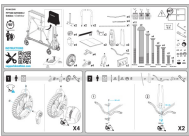
| | |
|---|--|
|  | <p>PONGORI PPT 530 M Outdoor Table Tennis Table Assembly Instructions</p> <p>Detailed assembly instructions for the PONGORI PPT 530 M outdoor table tennis table. Includes parts list, step-by-step guidance, and setup information for safe and correct assembly.</p> |
|  | <p>PONGORI TTT 110 Table Tennis Table Assembly Guide</p> <p>Detailed assembly instructions for the PONGORI TTT 110 table tennis table, including parts list and step-by-step guidance for setup and use.</p> |
|  | <p>Pongori PPT 930 Outdoor .2 User Manual and Installation Guide</p> <p>Comprehensive user manual and installation guide for the Pongori PPT 930 Outdoor .2, covering safety, operation, maintenance, and troubleshooting.</p> |

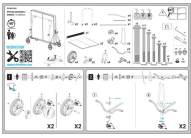

[PONGORI PPT 530 OUTDOOR .2 User Manual and Installation Guide](#)

Official user manual and installation guide for the PONGORI PPT 530 OUTDOOR .2. Find setup instructions, maintenance tips, troubleshooting advice, and spare parts information.

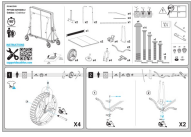

[PONGORI PPT 500 OUTDOOR .2 Portable Projector User Manual](#)

User manual for the PONGORI PPT 500 OUTDOOR .2 portable projector, detailing setup, operation, safety, and maintenance for outdoor entertainment. Includes specifications and troubleshooting.

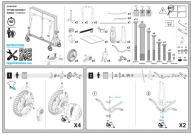

[Pongori PPT 900 Outdoor .2: Installation, Maintenance, and Spare Parts Guide](#)

Comprehensive guide for the Pongori PPT 900 Outdoor .2, covering installation procedures, spare parts information, and maintenance instructions for optimal performance.