

WELUSOPU G123-4

WELUSOPU Wireless HDMI Transmitter and 4 Receivers (G123-4) User Manual

Model: G123-4

1. INTRODUCTION

This manual provides detailed instructions for the setup, operation, and maintenance of your WELUSOPU Wireless HDMI Transmitter and 4 Receivers (Model G123-4). This system allows for wireless transmission of HDMI signals from a source device to up to four displays, with support for up to six receivers in total, and includes an app function for mobile device mirroring. Please read this manual thoroughly before use to ensure proper functionality and to maximize your experience.

2. PACKAGE CONTENTS

Verify that all items listed below are included in your package. If any items are missing or damaged, please contact customer support.

- 1 x WELUSOPU Wireless HDMI Transmitter (TX)
- 4 x WELUSOPU Wireless HDMI Receivers (RX)
- 5 x USB-C Charging Cables
- 1 x HDMI Extension Cable
- 1 x Micro HDMI Adapter
- 1 x Mini HDMI Adapter
- 1 x User Manual (this document)

Package Included



- 1 × Transmitter
- 4 × Receivers
- 5 × USB C Cables
- 1 × Mini / Micro HDMI Adapters
- 1 × HDMI Extension Cable
- 1 × User Manual

Image: All components included in the WELUSOPU Wireless HDMI Transmitter and 4 Receivers package, laid out for inspection.

3. PRODUCT OVERVIEW

The WELUSOPU Wireless HDMI system consists of a Transmitter (TX) and multiple Receivers (RX). Each unit is compact and designed for ease of use.

3.1 Transmitter (TX) Unit

The Transmitter connects to your source device (e.g., laptop, PC, cable box) via HDMI. It features a USB-C port for power and an integrated antenna for wireless signal transmission.

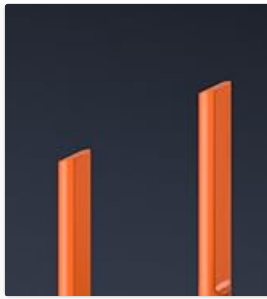

Image: A detailed view of the Transmitter (TX) unit, highlighting its HDMI connector, USB-C power port, and antenna.

3.2 Receiver (RX) Unit

Each Receiver connects to a display device (e.g., TV, monitor, projector) via HDMI. Like the TX, it has a USB-C port for power and an integrated antenna for receiving the wireless signal.

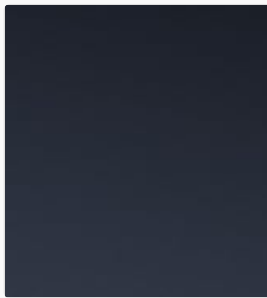

Image: A detailed view of a Receiver (RX) unit, showing its HDMI connector, USB-C power port, and antenna.

4. SETUP INSTRUCTIONS

The WELUSOPU Wireless HDMI system is designed for plug-and-play operation. Follow these steps for initial setup.

4.1 Basic Connection (1 Transmitter, 1 Receiver)

1. **Connect Receiver (RX) to Display:** Plug one RX unit into an available HDMI port on your TV, monitor, or projector.
2. **Power Receiver (RX):** Connect one of the provided USB-C cables to the RX unit and the other end to a USB power source (e.g., TV's USB port, USB wall adapter). Ensure the RX unit powers on.
3. **Connect Transmitter (TX) to Source:** Plug the TX unit into an HDMI output port on your source device (e.g., laptop, PC). Use the included HDMI extension cable or Mini/Micro HDMI adapters if needed for compatibility or clearance.
4. **Power Transmitter (TX):** Connect a USB-C cable to the TX unit and the other end to a USB power source. Ensure the TX unit powers on.
5. **Automatic Connection:** After both TX and RX units are powered on, they will automatically connect. Wait approximately 5 seconds for the signal to appear on your display.



Image: Step-by-step diagram illustrating the simple plug-and-play connection process for the Transmitter and Receiver units.

4.2 Connecting Multiple Receivers (Up to 6)

To use additional receivers (up to a total of 6), each new RX unit must be paired with the TX unit one by one.

1. **Connect and Power New RX:** Connect the new RX unit to a display and power it on as described in steps 4.1.1 and 4.1.2.
2. **Initiate Pairing on RX:** Long press the button on the new RX unit until the display shows 'Pairing'.
3. **Initiate Pairing on TX:** While the RX is in pairing mode, press the button on the TX unit until its light turns off, indicating it's ready to pair.
4. **Confirm Pairing:** The TX and RX units will connect. Repeat this process for each additional receiver you wish to pair.



Image: Visual guide demonstrating the pairing procedure for connecting additional receiver units to the transmitter for multi-screen display.

4.3 Smartphone & Tablet App Function

You can use your smartphone or tablet as an additional display (up to 6 touch-screen devices) by downloading the WELUSOPU app.

1. **Download App:** Search for the WELUSOPU app on your iOS or Android device's app store and install it.
2. **Connect to Wi-Fi:** On your mobile device, connect to the Wi-Fi network broadcast by the WELUSOPU Transmitter. The network name (SSID) and password will be displayed on the connected TV screen or can be

found on the TX unit itself.

3. **Launch App:** Open the WELUSOPU app. Your mobile device will now mirror the content being transmitted by the TX unit.

Note: This function supports mirroring only and does not offer reverse operations (e.g., controlling the source device from the mobile device).



Image: Illustration of how to connect smartphones and tablets to the WELUSOPU system using the dedicated app to function as additional display screens.

5. OPERATING INSTRUCTIONS

5.1 Basic Operation (Mirror Mode)

Once connected and powered, the system will automatically mirror the content from your source device to all connected displays. This is the default operating mode.



Image: Comparison of Extend Mode and Mirror Mode, illustrating how content can be duplicated or expanded across displays.

5.2 Extend Mode

For certain operating systems (e.g., Windows), you can configure your computer to use the wireless display as an extended desktop rather than a mirrored one. This allows you to have different content on your primary screen and the wirelessly connected display.

1. **Connect as usual:** Ensure the TX and RX units are connected and displaying content in mirror mode.
2. **Access Display Settings:** On your source computer, navigate to your operating system's display settings (e.g., right-click on desktop > Display settings on Windows).
3. **Select Extend Display:** Locate the option to extend your display to the wireless monitor and apply the changes.

5.3 Multi-Display Functionality

The system supports casting to up to 6 receivers simultaneously, allowing for synchronized content across multiple screens. This is ideal for presentations, digital signage, or multi-room entertainment.



Image: A meeting room setup demonstrating multiple displays connected wirelessly via WELUSOPU receivers, showing synchronized content.

6. ADVANCED FEATURES

6.1 Long Range Transmission

The system offers a stable signal range of up to 165 feet (50 meters) in open spaces, utilizing advanced 5.8G/2.4G dual-band technology for reliable connectivity.



Image: A visual representation of the system's 165-foot long-range transmission capability within a large indoor space.

6.2 High-Quality Video and Audio

Supports 4K input and 1080p HD output at 60Hz, ensuring crystal-clear visuals and stereo sound with minimal latency. The dual-band (2.4G and 5G) auto frequency hopping technology helps maintain a stable, interference-free connection.



Image: A graphic emphasizing the 60Hz refresh rate and 5G wireless technology for delivering clear and high-quality video.

6.3 Broad Compatibility

The system is compatible with a wide range of HDMI-enabled devices, including:

- **Transmitter (TX) Sources:** Cable boxes, Blu-ray players, DVD players, laptops, PCs, MacBooks, streaming devices (e.g., Roku, Apple TV, Fire Stick), DSLR cameras, camcorders, set-top boxes.
- **Receiver (RX) Displays:** HDTVs, monitors, projectors, soundbars, karaoke systems.



Image: A comprehensive diagram illustrating the wide range of compatible input devices for the transmitter and output displays for the receivers.

7. MAINTENANCE

To ensure the longevity and optimal performance of your WELUSOPU Wireless HDMI system, follow these maintenance guidelines:

- **Cleaning:** Use a soft, dry cloth to clean the units. Avoid liquid cleaners, solvents, or abrasive materials.
- **Storage:** When not in use for extended periods, store the units in a cool, dry place away from direct sunlight and extreme temperatures.

- **Ventilation:** Ensure the units have adequate ventilation during operation to prevent overheating. The upgraded chips are designed to prevent overheating, but proper airflow is still recommended.
- **Cable Care:** Handle HDMI and USB-C cables gently. Avoid bending or crimping them sharply, which can damage internal wires.

8. TROUBLESHOOTING

If you encounter issues with your WELUSOPU Wireless HDMI system, refer to the following troubleshooting steps:

Problem	Possible Cause	Solution
No signal on display	<ul style="list-style-type: none"> • Units not powered • Incorrect HDMI connection • TX/RX not paired • Source device output issue 	<ul style="list-style-type: none"> • Ensure both TX and RX units are properly powered via USB-C. • Verify HDMI cables are securely connected to both source and display. • For multiple RX units, ensure each is paired (see Section 4.2). • Check if the source device is outputting a signal (e.g., connect directly to display). • Try a different HDMI port on the display.
Flickering or unstable image	<ul style="list-style-type: none"> • Interference • Distance too great • Low power 	<ul style="list-style-type: none"> • Reduce distance between TX and RX units. • Minimize obstructions (walls, large metal objects). • Ensure units are receiving stable power. • Avoid placing units near other wireless devices (Wi-Fi routers, cordless phones).
Audio but no video, or vice versa	<ul style="list-style-type: none"> • HDMI cable issue • Display settings 	<ul style="list-style-type: none"> • Try a different HDMI cable. • Check display's input settings and audio output settings. • Restart both TX and RX units.
Units disconnect frequently	<ul style="list-style-type: none"> • Weak signal • Interference • Power instability 	<ul style="list-style-type: none"> • Ensure TX and RX are within optimal range and line of sight. • Check for strong sources of wireless interference. • Use reliable USB power adapters for both units. • Restart the system (power cycle both TX and RX).
App function not working	<ul style="list-style-type: none"> • Not connected to TX Wi-Fi • App not updated 	<ul style="list-style-type: none"> • Verify your mobile device is connected to the TX unit's Wi-Fi network. • Ensure the app is the latest version. • Restart the app and the TX unit.

9. SPECIFICATIONS

Feature	Detail
Model Number	G123-4
Brand	WELUSOPU
Item Weight	1.46 pounds (total package)
Product Dimensions	8.66 x 1.37 x 0.59 inches (per unit)
Connectivity Technology	Wireless (5.8G/2.4G Dual Bands)
Video Input Resolution	Up to 4K
Video Output Resolution	1080p HD @ 60Hz
Transmission Range	Up to 165 feet (50 meters) in open spaces
Latency	Near zero latency
Audio Output Mode	Stereo
Video Encoding	H.264, H.265/HEVC
Total HDMI Ports	1 (on each unit)
Connector Type	HDMI, Micro USB (for power)
Special Features	Multi-display mirroring (up to 6 RX + app), 4K input, 1080P output, 2.4G/5G dual bands, low latency, overheating prevention, mobile device mirroring via app, plug and play.

10. SAFETY INFORMATION

- Do not expose the units to water, moisture, or extreme temperatures.
- Avoid dropping or subjecting the units to severe impact.
- Do not attempt to disassemble or modify the units. This will void the warranty and may cause damage or injury.
- Use only the provided USB-C cables and appropriate power adapters to power the devices.
- Keep the units away from sources of heat and direct sunlight.

11. WARRANTY AND SUPPORT

WELUSOPU is committed to providing high-quality, reliable products. While specific warranty details are not provided in this manual, we stand by our commitment to quality and customer satisfaction. For any technical support, troubleshooting assistance, or warranty inquiries, please contact WELUSOPU customer service through the retailer where you purchased the product or visit the official WELUSOPU website for contact information.