

Manuals+

[Q & A](#) | [Deep Search](#) | [Upload](#)

manuals.plus /

› [TECXERLLON](#) /

› [TECXERLLON 10.26" Wireless CarPlay Screen with 4K Dash Cam & 1080P Backup Camera User Manual](#)

TECXERLLON DC10Q5

TECXERLLON 10.26" Wireless CarPlay Screen with 4K Dash Cam & 1080P Backup Camera User Manual

Model: DC10Q5 | Brand: TECXERLLON

1. INTRODUCTION

Thank you for choosing the TECXERLLON 10.26" Wireless CarPlay Screen. This device is designed to enhance your driving experience by integrating advanced features such as wireless CarPlay, Android Auto, a 4K dash camera, and a 1080P backup camera. This manual provides detailed instructions for setup, operation, maintenance, and troubleshooting to ensure optimal performance and safety.



Image: The TECXERLLON 10.26-inch portable car screen, showcasing its main display, integrated 4K dash cam, and included 1080P backup camera.

2. WHAT'S IN THE BOX

Please verify that all items listed below are included in your package:

- 10.26" Portable Car Screen Body with Soft Plastic Base + Suction Mount Bracket
- Backup Camera
- Power Cord
- AUX Cable
- 64G TF Card (Inserted in Device)
- User Manual
- Car Charger (9.84ft)
- Adhesive Gasket
- Backup Camera Adhesive (x2)
- Backup Camera Screws (x2)

PACKAGING LIST

- 1 10.26" Portable Car Screen*1
- 2 Car Charger(9.84ft)*1
- 3 AUX Audio Cable*1
- 4 Base Bracket with Adhesive Pad*1
- 5 Adhesive Pad*1
- 6 User Manual*1
- 7 Suction Cup Bracket*1
- 8 Adhesive Gasket*1
- 9 64G TF Card(Inserted in Device)*1
- 10 Backup Camera(19.69ft)*1
- 11 Backup Camera Adhesive*2
- 12 Backup Camera Screws*2



Image: A visual representation of all components included in the TECXERLLON 10.26-inch Wireless CarPlay Screen package.

3. PRODUCT FEATURES

- **10.26-inch HD IPS Display:** Provides a clear and immersive viewing experience.
- **Wireless CarPlay & Android Auto:** Seamless smartphone integration for navigation, music, and calls.
- **4K Dash Camera:** Records high-resolution front-facing video with vertical adjustment and G-sensor for collision detection.
- **1080P Rearview Camera:** Automatically activates in reverse with wide-angle HD view and parking guidelines.
- **Multiple Audio Output Options:** Connects to car stereo via Bluetooth, FM transmitter, AUX, or uses built-in speakers.
- **Online GPS Navigation:** Supports popular navigation apps like Google Maps and Waze, syncing with smartphone data.
- **Auto-Brightness Adjustment:** Adapts screen brightness to ambient lighting conditions for optimal visibility.
- **Screen Mirroring Function:** Supports Airplay (iOS) and Android Cast for displaying smartphone

content.

- **Easy Installation:** Mounts quickly with included suction cup or adhesive base, no car disassembly required.

4. SETUP & INSTALLATION

4.1 Mounting Methods

Choose the best installation method to ensure driving safety and avoid obstructing your view. The device supports three primary mounting options:

1. **Adhesive Flexible Rubber Base Bracket:** For dashboard mounting.
2. **Dashboard Suction Cup Bracket:** Provides a secure hold on the dashboard.
3. **Windshield Suction Cup Bracket:** For windshield mounting.

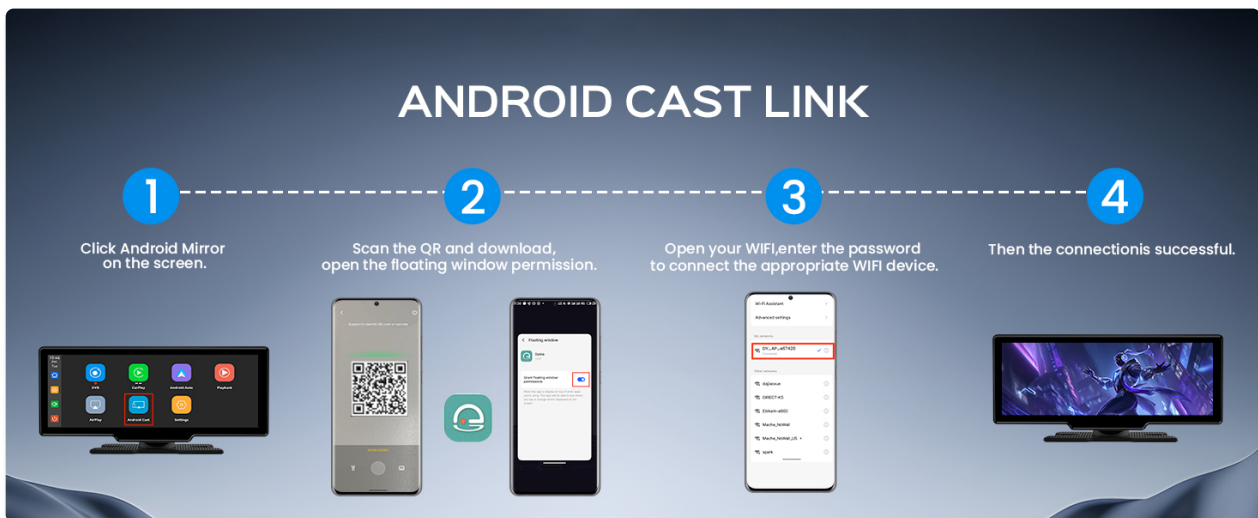

Image: Illustration of the three available mounting methods: adhesive base, dashboard suction cup, and windshield suction cup.

Bracket Installation Steps:

Clean the mounting area thoroughly before installation.

- **For Flexible Rubber Base Bracket:** Adjust the angle, remove the protection film, stick to the dashboard, and then install the device.
- **For Suction Cup Bracket:** Remove the protection film, stick to the dashboard/windshield, press the bar to lock it, adjust the angle, and lock the screw.

THREE MOUNTING METHODS

To avoid obstructing your view, choose the best installation method to ensure driving safety!



Image: Step-by-step guide for installing both the flexible rubber base bracket and the suction cup bracket.

4.2 Backup Camera Installation

The 1080P backup camera provides a wide-angle view with parking guidelines. For optimal functionality, connect the backup camera to your vehicle's reversing light circuit.

1. Connect the backup camera cable to the AV IN port on the portable CarPlay screen.
2. Route the backup camera cable to the rear of your vehicle.
3. Connect the red wire of the backup camera cable to the positive terminal of your vehicle's reversing light. This ensures the camera activates automatically when shifting into reverse.
4. Mount the backup camera securely at the rear of your vehicle using the provided adhesive or screws.

Warning: If you have no experience in vehicle repair/modification or rear camera installation, please seek professional assistance for installation.

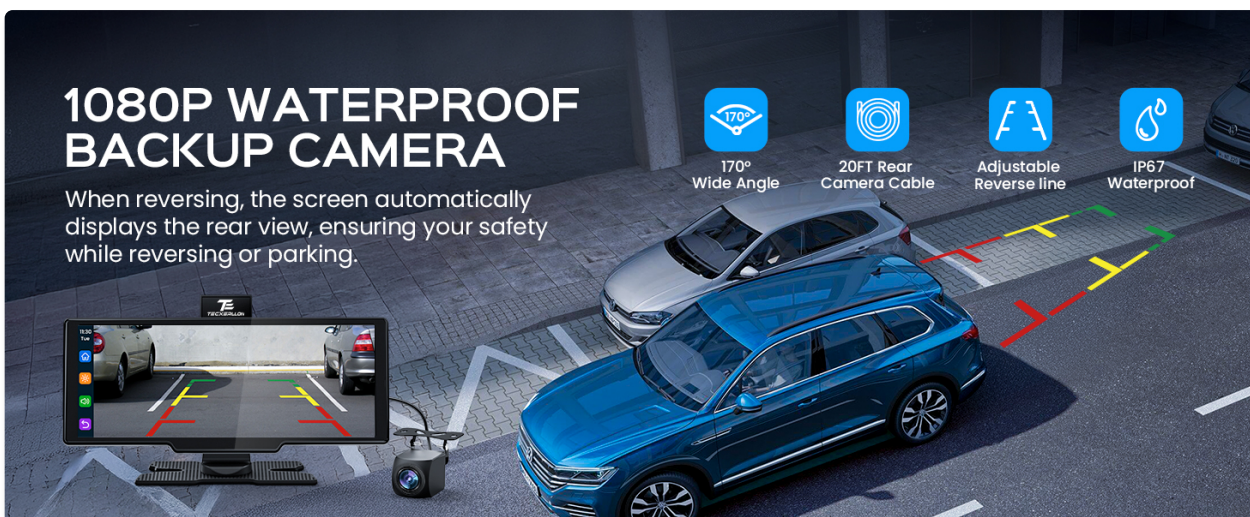

Image: A diagram illustrating the connection points for the backup camera to the CarPlay screen and the vehicle's reversing light.

5. OPERATING INSTRUCTIONS

5.1 Wireless CarPlay & Android Auto Connection

The device supports both wireless Apple CarPlay and Android Auto. After the initial setup, your smartphone will automatically connect via Bluetooth when you start your car.

For Wireless Apple CarPlay:

1. Turn on Bluetooth and Wi-Fi on your iPhone.
2. On your iPhone, select the corresponding Bluetooth device name (e.g., "TECXERLLON_XXXX").
3. Wait for approximately 10 seconds, then click "Pair" when prompted.
4. Select "Use CarPlay" on your iPhone.
5. Wait about 10 seconds; the connection should be successful.



Image: Visual guide detailing the steps to connect your iPhone to the device via Wireless Apple CarPlay.

For Wireless Android Auto:

1. Turn on Bluetooth and Wi-Fi on your Android phone.
2. On your Android phone, select the corresponding Bluetooth device.
3. Allow the connection when prompted.
4. Wait about 10 seconds; the connection should be successful.

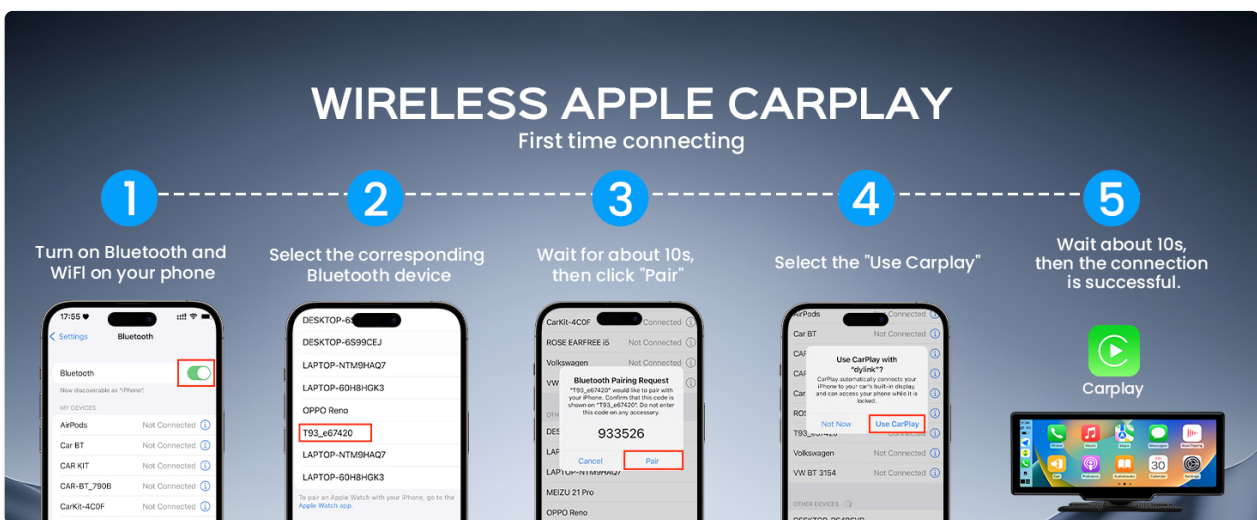

Image: Visual guide detailing the steps to connect your Android phone to the device via Wireless Android Auto.

5.2 Online GPS Navigation

Utilize your smartphone's navigation apps (e.g., Google Maps, Waze, Apple Maps) directly on the 10.26-inch display through CarPlay or Android Auto. The system syncs with your phone's latest GPS data for real-time navigation without frequent updates.

ONLINE GPS NAVIGATION

Connect Apple CarPlay or Android Auto and use the online navigation function.



Apple maps



Waze



Google maps



HERE maps



sygic



Image: The TECXERLLON screen displaying online GPS navigation from a connected smartphone, showing various map app icons.

5.3 Audio Output Options

The device offers multiple ways to output audio:

- **Bluetooth:** Stream audio wirelessly to your car's OEM stereo speakers for a lossless experience.
- **FM Transmitter:** Transmit audio to your car's stereo via a selected FM frequency.
- **AUX Connection:** Connect directly to your car's AUX input using the provided AUX cable.
- **Built-in Speaker:** The device features its own high-quality built-in speakers.

FOUR AUDIO OUTPUTS



Image: A visual representation of the four audio output options: Bluetooth, FM Transmitter, AUX Connection, and Built-in Speaker.

5.4 Hands-Free Operation

Utilize Siri or Google Voice Assistant for hands-free control of navigation, phone calls, and music playback. This enhances safety by allowing you to keep your hands on the wheel and eyes on the road.

HANDS-FREE OPERATION

You can use Siri/Google Voice Assistant to control navigation, make phone calls, play music, and perform other command operations.



Image: The TECXERLLON screen demonstrating hands-free control via voice commands for music and phone calls.

5.5 Screen Mirroring (AirPlay & Android Cast)

Mirror your smartphone's screen to the CarPlay display using Airplay for iOS or Android Cast for Android devices. This allows you to view videos or other content on the larger screen.

Note: Some apps cannot mirror or cast videos due to licensing or system restrictions (e.g., Netflix, YouTube, Apple TV, Amazon Video, ESPN, MLB).

For AirPlay Mirror Link (iOS):

1. Click "iPhone Mirror" on the screen.
2. Turn on Wi-Fi on your iPhone.
3. Enter the password to connect to the appropriate Wi-Fi device displayed on the screen.
4. Click "Screen Mirror" from your iPhone's control center menu.
5. Click on "Car" to complete screen mirroring.
6. The connection is successful.

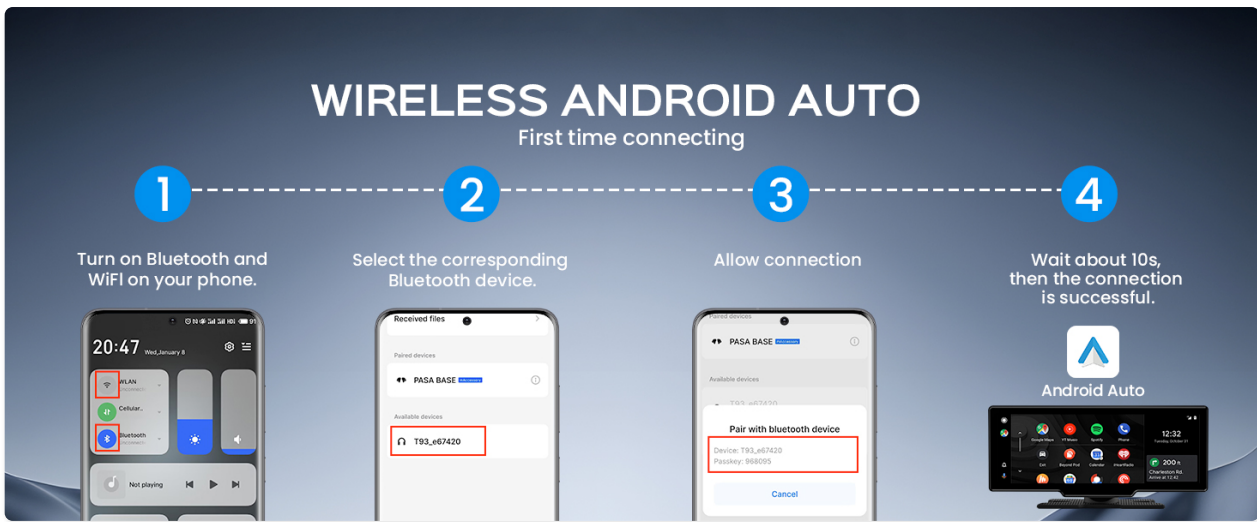

Image: A visual guide demonstrating the steps to establish an AirPlay Mirror Link connection from an iPhone to the CarPlay screen.

For Android Cast Link:

1. Click "Android Mirror" on the screen.
2. Scan the QR code and download the mirroring application, then open the floating window permission. You can also visit <http://dl.mirroring.app.sageres.com/jinzhuo/index.html> for the download.
3. Open your Wi-Fi settings and enter the password to connect to the appropriate Wi-Fi device.
4. The connection is successful.

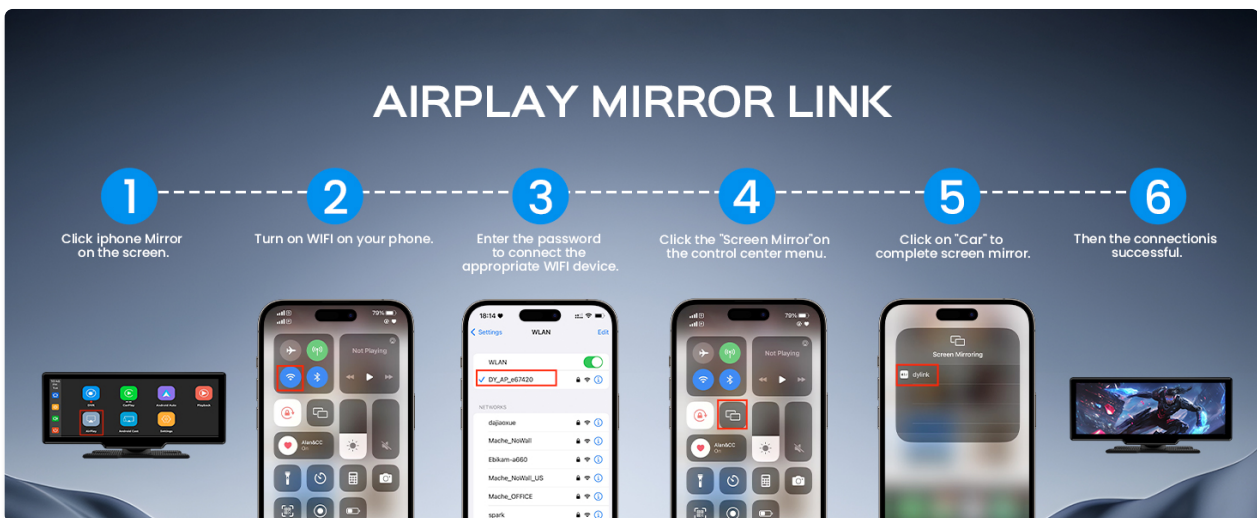

Image: A visual guide demonstrating the steps to establish an Android Cast Link connection from an Android phone to the CarPlay screen.

5.6 Dash Cam & Backup Camera Operation

The integrated cameras provide continuous recording and parking assistance.

- **4K Dash Cam:** Records front-facing video. Features vertical adjustment for optimal positioning and a built-in G-sensor for collision detection and emergency recording.
- **1080P Rearview Camera:** Automatically activates when the vehicle is in reverse, providing a wide-angle HD view with parking guidelines.
- **Loop Recording:** Ensures continuous recording by overwriting the oldest footage when the storage card is full.
- **64GB TF Card:** Included for continuous storage.

DASH CAMERA & BACKUP CAMERA



The 64GB TF card has been inserted into the device.



Image: An illustration highlighting the 4K dash cam and 1080P backup camera, their wide viewing angles, G-sensor, loop recording, and parking guidelines.

5.7 Auto-Brightness Adjustment

The screen features an auto-brightness function that adapts to ambient lighting conditions. This ensures optimal visibility whether driving in bright sunlight or at night, reducing glare and enhancing safety.

COMPATIBLE WITH 99% 12V-24V VEHICLE

Unlike traditional car stereos, it fits most car models without requiring specific size standards like single DIN or double DIN.



Cars



SUVs



Pickup Trucks



Trucks



Image: A visual comparison showing the screen's auto-brightness adjusting for daytime and nighttime driving conditions.

6. MAINTENANCE

- **Cleaning:** Use a soft, dry cloth to clean the screen and device body. For stubborn smudges, lightly dampen the cloth with water or a screen-safe cleaner. Avoid harsh chemicals.
- **Software Updates:** Periodically check for software updates to ensure optimal performance and compatibility. Instructions for updates will be provided by TECXERLLON support if available.
- **Storage:** If storing the device for an extended period, disconnect it from power and store it in a cool, dry place away from direct sunlight.
- **TF Card:** The included 64GB TF card is pre-inserted. Ensure it is properly seated. Format the card periodically (e.g., monthly) through the device settings to maintain optimal recording performance.

7. TROUBLESHOOTING

Problem	Possible Cause	Solution
Device does not power on.	Power cord not connected properly; vehicle's power outlet issue.	Ensure the power cord is securely plugged into the device and the car's cigarette lighter socket. Check if the car's power outlet is functional.
Wireless CarPlay/Android Auto fails to connect.	Bluetooth/Wi-Fi off on phone; incorrect pairing; software issue.	Ensure Bluetooth and Wi-Fi are enabled on your phone. Forget the device in your phone's Bluetooth settings and re-pair. Restart both the device and your phone.
No audio or poor audio quality.	Incorrect audio output setting; loose AUX cable; FM interference.	Check the audio output settings on the device (Bluetooth, FM, AUX, Built-in Speaker). Ensure AUX cable is fully inserted. If using FM, try a different frequency.
Backup camera not displaying.	Camera cable loose; incorrect wiring to reverse light.	Verify the backup camera cable is securely connected to the AV IN port. Ensure the camera's power wire is correctly connected to the vehicle's reversing light.
Screen mirroring not working for certain apps.	App restrictions.	Some streaming apps (e.g., Netflix, YouTube, Amazon Video) have licensing restrictions that prevent screen mirroring. This is normal behavior.
Issues connecting CarPlay with iOS 26.	Compatibility issue with new iOS version.	If your phone is running iOS 26 and experiencing connection issues, please contact TECXERLLON support via the email address provided in this manual. We will provide a device update file and step-by-step guide.

8. SPECIFICATIONS

Feature	Detail
Product Dimensions	9.45 x 3.94 x 1.85 inches
Item Weight	2.43 pounds
Model Number	DC10Q5
Display Resolution	1600*600
Connectivity Technologies	Bluetooth, Wi-Fi
Special Features	Built-In Speaker, 4K Dash Cam, 1080P Backup Camera, Wireless CarPlay, Android Auto, GPS Navigation, Airplay, Mirror Link, Auto-Brightness Adjustment
Video Capture Resolution	4K (Front), 1080P (Rear)
Mounting Type	Dashboard Mount or Windshield Mount
Control Method	Touch
Included Storage	64G TF Card (pre-inserted)
Vehicle Service Type	All (Compatible with 99% 12V-24V vehicles)

9. WARRANTY & SUPPORT

TECXERLLON is committed to providing high-quality products and responsive service. We offer 24/7 support to assist with any issues you may encounter.

- **Customer Support:** For technical assistance, troubleshooting, or any inquiries, please contact our support team.
- **Email Support:** support@texcerllon.com
- **Returns:** Refer to your purchase platform's return policy for details on product returns.

TECXERLLON

TECXERLLON is redefining the automotive lifestyle with advanced solutions. Driven by innovation and smart technology, we focus on automotive mobility products.

Committed to quality and reliability, our mission is to make every journey safer, smoother, and more enjoyable.



High Quality



Responsive Service



30 Days Free Returns

Technical Services: support@texcerllon.com

Image: TECXERLLON's commitment to high quality, responsive service, and customer satisfaction.

© 2025 TECXERLLON. All rights reserved.