

[Manuals.plus](#) /

› [CAMECHO](#) /

› CAMECHO Motorcycle CarPlay Screen User Manual

CAMECHO B0DPMSXCLS

CAMECHO Motorcycle CarPlay Screen User Manual

Model: B0DPMSXCLS

Brand: CAMECHO

1. PRODUCT OVERVIEW

The CAMECHO Motorcycle CarPlay Screen is a 5-inch waterproof touch screen designed to bring advanced connectivity to your motorcycle. It supports wireless Apple CarPlay and Android Auto, allowing seamless integration with your smartphone for navigation, music, calls, and voice control (Siri/Google Assistant). Its robust IP67 waterproof design ensures reliable performance in various weather conditions.



Image: The CAMECHO Motorcycle CarPlay Screen, showcasing its compact design and wireless connectivity features for both Apple CarPlay and Android Auto, alongside a motorcycle.

2. PACKAGE CONTENTS

Verify that all items are present in the package before proceeding with installation.

- 1 x 5-inch CarPlay Screen Unit
- 1 x Power Cable
- 1 x Mounting Bracket Kit

- 1 x User Manual

Wide Compatible



Package List

142mm / 5.5inch

7.4mm / 2.9inch



9.6mm / 3.7inch



140mm / 5.5inch



Power Cable



Brackets



User Manual



Image: Visual representation of the product dimensions and the complete list of items included in the package.

3. SETUP

3.1 Installation

The CAMECHO Motorcycle CarPlay Screen is designed for easy installation on various motorcycles, scooters, trikes, golf carts, and UTVs (DC 12V). Use the provided bracket and tools to securely mount the unit on your motorcycle's handlebar. Ensure the mounting location does not obstruct your view or interfere with vehicle controls.

Wireless Apple Carplay & Android Auto



Image: The CarPlay screen securely mounted on a motorcycle handlebar, demonstrating its integration into the riding environment.

3.2 Initial Power On

Connect the power cable to your motorcycle's 12V power source according to the wiring instructions provided in the full user manual. Once connected, the device should power on automatically with the ignition. Follow the on-screen prompts for initial setup, including language selection and time zone.

4. OPERATING INSTRUCTIONS

4.1 Wireless Apple CarPlay & Android Auto

This device allows you to seamlessly integrate your smartphone's features directly onto the screen. Ensure your phone's Bluetooth and Wi-Fi are enabled.

Connecting with iPhone (Apple CarPlay)

1. Open "Settings" on your iPhone.
2. Turn on "Bluetooth".
3. Select the Bluetooth device name of the CarPlay screen (e.g., "CARLINK-XXXX").

4. Wait for approximately 20-30 seconds, then select "Use CarPlay" when prompted.
5. The CarPlay mode will activate.

Wireless Android Cast



1

Download and open the app



2

Turn off the wifi on the phone, turn on the hotspot, set the hotspot name to car, and set the password to 12345678



3

Click on Start now



4

Please wait for a moment and you will enter the Android Cast mode.

* Install Android Auto application from Google Play Store

Image: Detailed visual steps for connecting an iPhone to enable wireless Apple CarPlay.

Connecting with Android Phone (Android Auto)

Note: Install the Android Auto application from the Google Play Store on your Android phone prior to connection.

1. Open "Settings" on your Android phone and navigate to "Connected devices" or "Bluetooth".
2. Turn on "Bluetooth".
3. Find the monitor's Bluetooth name (e.g., "T86-XXXX") and select it to pair.
4. Allow contacts access and confirm pairing when prompted.
5. The Android Auto mode will activate.

Bluetooth Trans



1 **2**

Pair Phone via BT / Bluetooth Headset & Bluetooth Helmet

Bluetooth Audio



1 **2**

Bluetooth Headset & Bluetooth Helmet

Note:

1. The helmet or earphone must be turned on and in an active state in order to be discovered by the Carplay screen for pairing.
2. Do not connect your mobile phone to the Bluetooth helmet or earphone, as this may interfere with the pairing process.

Connect your phone to the Bluetooth Headset or Helmet, and use CarPlay or Android Auto to play audio through the Bluetooth Headset or Helmet.

Image: Detailed visual steps for connecting an Android phone to enable wireless Android Auto.

Bluetooth Trans

- Note:**
1. The helmet or earphone must be turned on and in an active state in order to be discovered by the Carplay screen for pairing.
 2. Do not connect your mobile phone to the Bluetooth helmet or earphone, as this may interfere with the pairing process.



Bluetooth Audio

Connect your phone to the Bluetooth Headset or Helmet, and use CarPlay or Android Auto to play audio through the Bluetooth Headset or Helmet.



Image: The CarPlay screen displaying both Apple CarPlay and Android Auto interfaces from the rider's perspective.

4.2 Bluetooth Connectivity (Hands-Free & Audio)

The unit features built-in Bluetooth for hands-free calls and audio streaming. You can pair your phone to the CarPlay screen via Bluetooth, and then pair your Bluetooth helmet or earphone to the CarPlay screen for audio output.

- **Bluetooth Trans:** Pair your phone to the CarPlay screen. Then, pair your Bluetooth helmet/earphone to the CarPlay screen. This allows the CarPlay screen to act as an intermediary for audio and calls.
- **Bluetooth Audio:** Once connected, you can adjust volume, switch songs, and make hands-free calls directly through your helmet or earphone.

Important Notes:

- The helmet or earphone must be turned on and in an active state to be discovered by the CarPlay screen for pairing.
- Do not connect your mobile phone directly to the Bluetooth helmet or earphone, as this may interfere with the pairing process with the CarPlay screen.

Wireless Apple Airplay

Connect with iPhone



1

Open your phone's WiFi and connect to it



2

Pull down the phone to find the screen projection

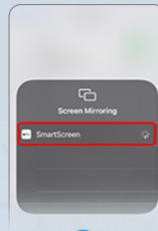

3

Click to cast the screen



4

Please wait for a moment and you will enter the Android Cast mode.

Image: A diagram explaining the Bluetooth connection process for both phone-to-screen and screen-to-helmet/earphone audio transmission.

4.3 Mirror Link (AirPlay & Android Cast)

The device supports wireless AirPlay for iOS devices and Mirror Link (Android Cast) for Android devices, allowing you to sync your smartphone's screen to the CarPlay display. This feature is useful for viewing content like maps or videos directly from your phone.

Connecting with iPhone (Wireless Apple AirPlay)

1. Open your iPhone's Wi-Fi settings, search for the Wi-Fi name of the CarPlay screen (e.g., "CARLINK-XXXX"), and connect using the password "12345678".
2. Pull down the phone's control center to find the screen projection option.
3. Click on "Screen Mirroring" and select "SmartScreen".
4. Wait for a moment, and your iPhone screen will be mirrored to the CarPlay display.

Wireless Apple Carplay

Connect with iPhone



1

Open "Setting" on your phone.

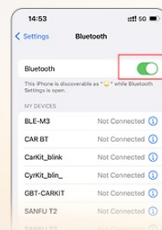

2

Turn on "Bluetooth".

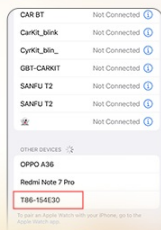

3

Select the Bluetooth device

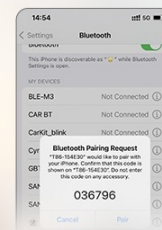

4

Wait for about 20-30 seconds then select "Use CarPlay".

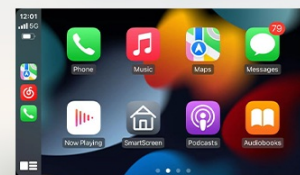

5

Please wait for a moment and you will enter the CarPlay mode.

Image: Detailed visual steps for mirroring an iPhone screen to the CarPlay display using AirPlay.

Connecting with Android Phone (Wireless Android Cast)

Note: Install a mirroring application (e.g., "Mirroring") on your Android phone from the Google Play Store.

1. Download and open the mirroring application on your Android phone.
2. Turn off Wi-Fi on your phone, turn on the personal hotspot, set the hotspot name to "car", and set the password to "12345678".

3. On the CarPlay screen, navigate to the Android Cast function.
4. Click on "Start now" on your phone to begin casting.
5. Wait for a moment, and your Android phone screen will be mirrored to the CarPlay display.

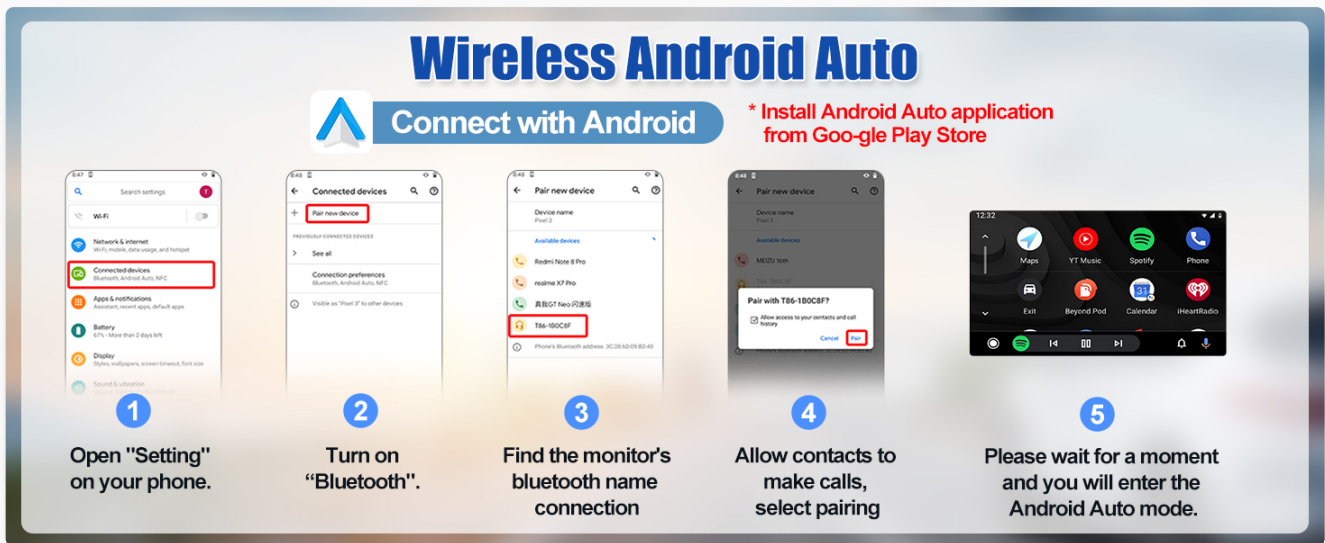

Image: Detailed visual steps for mirroring an Android phone screen to the CarPlay display using Android Cast.

4.4 EQ Sound Effect Adjustment

The unit features an adjustable equalizer (EQ) to customize your audio experience. You can select from preset modes such as Jazz, Classical, Rock, Pop, or Flat. Additionally, a 'User' mode allows you to manually adjust individual frequency bands to fine-tune the sound to your preference.

EQ SOUND EFFECT

You can choose jazz/ classical/ rock/ pop modes, or debug your favorite sound effects yourself.



Image: The equalizer interface on the CarPlay screen, showing options for sound customization.

4.5 Voice Control

Utilize voice commands for hands-free operation. With Apple CarPlay, activate Siri by saying "Hey Siri" or pressing the voice command button. For Android Auto, activate Google Assistant by saying "OK Google" or pressing the voice command button. This allows you to make calls, get directions, play music, and more without taking your hands off the handlebars.

5. MAINTENANCE

The CAMECHO Motorcycle CarPlay Screen is designed with an IP67 waterproof rating, providing protection against dust and temporary immersion in water. To ensure longevity and optimal performance:

- Regularly wipe the screen with a soft, damp cloth to remove dust and smudges. Avoid abrasive cleaners.
- Ensure all cable connections are secure and free from corrosion.
- While waterproof, avoid prolonged submersion or high-pressure water jets directly on the unit.
- Store the device in a cool, dry place when not in use for extended periods.

AIRPLAY

1. Open your phone's WiFi, search for the WiFi name of the machine, and connect with the password 12345678.
2. Pull down the phone and find the screen casting button, click on the screen casting button.



Image: The CarPlay screen demonstrating its resilience in wet and dusty conditions, emphasizing its IP67 rating.

6. TROUBLESHOOTING

If you encounter issues with your CAMECHO Motorcycle CarPlay Screen, refer to the following common problems and solutions:

- **Clock Resets Frequently:**
Ensure a stable power connection to the device. Fluctuations in power can cause the clock to reset. Check all wiring and connections. If the issue persists, contact customer support for potential firmware updates.
- **Bluetooth Pairing Issues (Helmet/Earphone):**
Ensure your Bluetooth helmet or earphone is fully charged and in pairing mode. Verify that it is not already connected to another device (e.g., your phone). Remember to pair your phone to the CarPlay screen first, then pair your helmet/earphone to the CarPlay screen. Do not attempt to pair your phone directly to the helmet/earphone while using the CarPlay screen.
- **No Firmware Support/Updates:**
While the device is functional, specific firmware updates or technical information may not be publicly available.

For any firmware-related inquiries or advanced troubleshooting, it is recommended to contact CAMECHO customer support directly.

- **Screen Not Responding:**

Try restarting the device by cycling the motorcycle's ignition. If the screen remains unresponsive, check the power connection.

- **No Audio Output:**

Verify that your Bluetooth helmet/earphone is properly paired and connected to the CarPlay screen. Check the volume levels on both the CarPlay screen and your helmet/earphone. Ensure that the correct audio output mode is selected on the CarPlay unit.

7. SPECIFICATIONS

Feature	Specification
Item Weight	1.1 pounds
Product Dimensions	5.5 x 2.9 x 3.7 inches
Display Size	5 Inches
Waterproof Rating	IP67
Connectivity Technology	Bluetooth, Wireless (Wi-Fi for AirPlay/Cast)
Special Features	Android Auto, Apple CarPlay, Built-in Bluetooth, Waterproof, Mirror Link, EQ Adjustment
Mounting Type	Handlebar Mount
Vehicle Service Type	Motorcycle, Scooter, UTV, Golf Cart

8. WARRANTY INFORMATION

The CAMECHO Motorcycle CarPlay Screen comes with a 1-year manufacturer's warranty. This warranty covers defects in materials and workmanship under normal use. Please retain your proof of purchase for warranty claims. For detailed warranty terms and conditions, refer to the documentation included with your product or contact CAMECHO customer support.

9. CUSTOMER SUPPORT

For technical assistance, troubleshooting beyond this manual, or warranty claims, please contact CAMECHO customer support. Refer to the contact information provided in the product packaging or visit the official CAMECHO website for the most up-to-date support details.

