



[Manuals.plus](#) /

> [Srivdk](#) /

> Srivdk Compressor Nebulizer Machine User Manual

Srivdk for Women 1

Srivdk Compressor Nebulizer Machine User Manual

Model: for Women 1

1. INTRODUCTION

This manual provides essential instructions for the safe and effective operation and maintenance of your Srivdk Compressor Nebulizer Machine. Please read this manual thoroughly before initial use and retain it for future reference. This device is designed to convert liquid medication into a fine mist for inhalation, aiding in respiratory therapy for both adults and children.

2. IMPORTANT SAFETY INFORMATION

WARNING:

- Statements regarding dietary supplements have not been evaluated by the FDA and are not intended to diagnose, treat, cure, or prevent any disease or health condition.
- Always consult with a healthcare professional before using this device or starting any new medication.
- Do not immerse the main unit in water or any other liquid.
- Keep the device out of reach of children when not in use.
- Use only medications prescribed by your doctor with this nebulizer.
- Ensure the power cord is not damaged and is properly connected to a suitable power outlet.

3. PACKAGE CONTENTS

Carefully unpack the box and ensure all the following items are present:

WHAT'S IN THE BOX

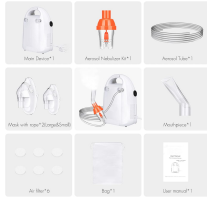

What's in the Box:

This image displays the main device, aerosol nebulizer kit, aerosol tube, two masks (large and small), mouthpiece, six air filters, a storage bag, and the user manual.

- 1 x Main Unit (Compressor)
- 1 x Liquid Cup (Medication Reservoir)
- 1 x Power Adapter
- 1 x Adult Mask
- 1 x Child Mask
- 1 x Mouthpiece
- 2 x Straps (for masks)
- 5 x Filter Pieces (Replacement Air Filters)
- 1 x Air Tube
- 1 x User Manual (this document)

4. PRODUCT COMPONENTS

Familiarize yourself with the different parts of your nebulizer machine:



Component Diagram: This image illustrates the main unit, indicating the power switch, air filter cotton attachment point, air tube connection, and where to install the mouthpiece or mask, and fill medicine.

- **Main Unit:** The compressor that generates compressed air.
- **Liquid Cup:** Holds the liquid medication to be nebulized.
- **Air Tube:** Connects the main unit to the liquid cup, delivering compressed air.
- **Mouthpiece:** Used for direct inhalation of the mist.
- **Adult Mask:** Covers the nose and mouth for adult users.
- **Child Mask:** Smaller mask for pediatric users.
- **Air Filter:** Filters incoming air to ensure clean mist production.

FOR **WHOLE** FAMILY USE SUITABLE FOR **DIFFERENT** NEEDS



Mask(adult)



Mask(child)

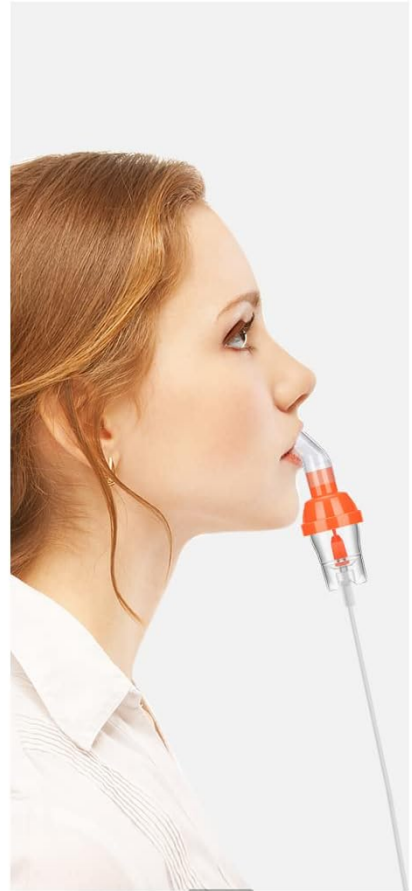

Mouthpiece

Accessory Usage: This image demonstrates the use of the adult mask, child mask, and mouthpiece, highlighting their suitability for different users and needs.

5. SETUP INSTRUCTIONS

Follow these steps to prepare your nebulizer for use:

1. **Place the Main Unit:** Position the main unit on a stable, flat surface. Ensure it is near a power outlet and away from water.
2. **Attach Air Filter:** Locate the air filter port on the main unit. Insert one of the provided air filter pieces. (Refer to image below for visual guidance).



Air Filter Installation: This image shows a hand inserting the white air filter into its designated slot on the nebulizer unit.

3. **Connect Air Tube:** Firmly connect one end of the air tube to the air outlet on the main unit. Connect the other end of the air tube to the bottom of the liquid cup.
4. **Prepare Medication:** Open the liquid cup and pour the prescribed amount of liquid medication into the reservoir. Do not overfill. Close the liquid cup securely.
5. **Attach Mouthpiece or Mask:** Connect either the mouthpiece, adult mask, or child mask to the top of the liquid cup, depending on the user's needs.
6. **Connect Power:** Plug the power adapter into the main unit and then into a suitable electrical outlet.

6. OPERATING INSTRUCTIONS

Once the device is set up, follow these steps for treatment:

HOW TO USE IT



1. Fill the container with medicine and connect the mouthpiece or mask.



2. Attach the air filter to the air compressor and turn on the power switch



3. Connect the tubing after the air compressor runs for 1-2 minutes.



4. Begin treatment and turn off the machine when treatment is over.

How to Use: This diagram shows the four main steps: filling the medicine cup, attaching the air filter and turning on the power, connecting the tubing, and beginning treatment.

1. **Power On:** Press the power switch located on the side of the main unit to turn on the device. The compressor will start, and you will hear a gentle hum. (The device operates at a low noise level, under 40dB).



Power Switch: This image highlights the simple one-button power switch for easy operation.

2. **Begin Treatment:** If using a mouthpiece, place it between your teeth and seal your lips around it. If using a mask, place it over your nose and mouth, ensuring a comfortable seal. Breathe normally and deeply to inhale the medication mist.
3. **Monitor Treatment:** Continue breathing until the medication cup is empty or the mist stops forming. This typically takes 5-15 minutes, depending on the medication volume.
4. **Power Off:** Once the treatment is complete, press the power switch again to turn off the device.
5. **Disconnect:** Unplug the power adapter from the wall outlet.



RELIEVE PAIN

It can Effectively help you relieve pain and restore health.

During Use: This image shows a user undergoing nebulizer treatment, demonstrating the comfortable and quiet operation of the device.

7. MAINTENANCE AND CLEANING

Proper cleaning and maintenance are crucial for the longevity and hygienic operation of your nebulizer.

7.1 Daily Cleaning (After Each Use)

1. **Disassemble:** Disconnect the air tube from the liquid cup. Separate the mouthpiece/mask from the liquid cup.
2. **Rinse Components:** Rinse the liquid cup, mouthpiece, and mask thoroughly with warm tap water.
3. **Dry:** Shake off excess water and allow all components to air dry completely on a clean paper towel. Do not use a cloth towel as it may leave lint.

7.2 Weekly Disinfection

1. **Prepare Solution:** Mix 1 part white vinegar with 2 parts distilled water, or use a nebulizer disinfectant solution as recommended by your healthcare provider.
2. **Soak Components:** Soak the cleaned liquid cup, mouthpiece, and mask in the disinfection solution for 30 minutes.

3. **Rinse and Dry:** Rinse all components thoroughly with sterile water (or boiled and cooled tap water) and air dry completely.

7.3 Air Filter Replacement

The air filter should be replaced every 30 days or sooner if it appears discolored or clogged. Your package includes 5 replacement filters.

1. **Locate Filter:** Identify the air filter compartment on the side of the main unit.
2. **Remove Old Filter:** Gently pull out the old air filter.
3. **Insert New Filter:** Insert a new, clean air filter into the compartment.



Air Vents: This image shows the air vents on the side of the main unit, indicating where the air filter is located.

Important: Do not wash or reuse air filters. Do not operate the device without an air filter.

8. TROUBLESHOOTING

If you encounter issues with your nebulizer, refer to the following common problems and solutions:

Problem	Possible Cause	Solution
No mist produced	<ul style="list-style-type: none"> • No power • Air tube disconnected or kinked • Medication cup empty or improperly assembled • Clogged air filter 	<ul style="list-style-type: none"> • Check power connection and outlet • Ensure air tube is securely connected and free of kinks • Verify medication is in cup and cup is assembled correctly • Replace air filter if clogged
Weak mist production	<ul style="list-style-type: none"> • Clogged air filter • Air tube partially blocked • Medication cup components dirty 	<ul style="list-style-type: none"> • Replace air filter • Check air tube for blockages • Clean medication cup and accessories thoroughly
Unusual noise or vibration	<ul style="list-style-type: none"> • Device not on a flat surface • Internal component issue 	<ul style="list-style-type: none"> • Place device on a stable, flat surface • If problem persists, discontinue use and contact customer support

If the problem persists after attempting these solutions, please contact Srivdk customer support for assistance.

9. SPECIFICATIONS

Feature	Detail
Model Number	for Women 1
Manufacturer	Srivdk
Package Dimensions	8.54 x 7.91 x 7.01 inches
Item Weight	3.68 Pounds
Noise Level	Under 40dB
ASIN	B0DPMHJR4N
First Available	January 21, 2025

10. WARRANTY AND SUPPORT

For warranty information, please refer to the documentation included with your product packaging or visit the official Srivdk website. For technical support or further assistance, please contact Srivdk customer service.