

SAMA S40

SAMA S40 Mid Tower ATX PC Case User Manual

Model: S40

INTRODUCTION

Welcome to the user manual for the SAMA S40 Mid Tower ATX PC Case. This guide provides essential information for the proper setup, operation, and maintenance of your new PC case. The SAMA S40 is designed with a high-airflow mesh front panel, a tempered glass side panel, and comes with four pre-installed 120mm ARGB PWM fans, offering both performance and aesthetics for your build.



Image: The SAMA S40 Mid Tower ATX PC Case, showcasing its design and pre-installed fans.

PACKAGE CONTENTS

Please verify that all components are present in your package:

- SAMA S40 Mid Tower ATX PC Case
- 4 x 120mm ARGB PWM Fans (pre-installed)
- Accessory Box (containing screws, standoffs, cable ties, and user manual)

SPECIFICATIONS

Feature	Detail
Brand	SAMA

Feature	Detail
Model Name	S40
Case Type	Mid Tower
Color	S40-White
Material	Alloy Steel, Plastic, Tempered Glass
Motherboard Compatibility	ATX, M-ATX, ITX
GPU Length Support	Up to 415mm
CPU Cooler Height	Up to 164mm
Expansion Slots	7+2 (Vertical)
Pre-installed Fans	4 x 120mm ARGB PWM Fans
Max Fan Support	Up to 12 x 120mm fans
Radiator Support	Up to 360mm (Top)
Drive Bays	3 x 3.5" HDD or 3 x 2.5" SSD (hybrid configurations supported)
Front I/O Ports	2 x USB 3.0, 1 x USB 3.1 Type-C, HD Audio, Mic, Power, LED Control
Dimensions (L x W x H)	485mm x 215mm x 483mm



S40 WHITE

Dimensions	485x215x483mm
CPU Cooler Height	164mm
Graphic Card Length	415mm
120mm Fans	Up to 12
140mm Fans	Up to 5
AIO Cooler	Up to 360mm
3.5" HDD Bays	3
2.5" SSD Bays	3

Image: Detailed dimensions and key specifications of the SAMA S40 PC Case.

SETUP GUIDE

1. Component Overview

Familiarize yourself with the case's layout and connection points.

FRONT PANEL I/O

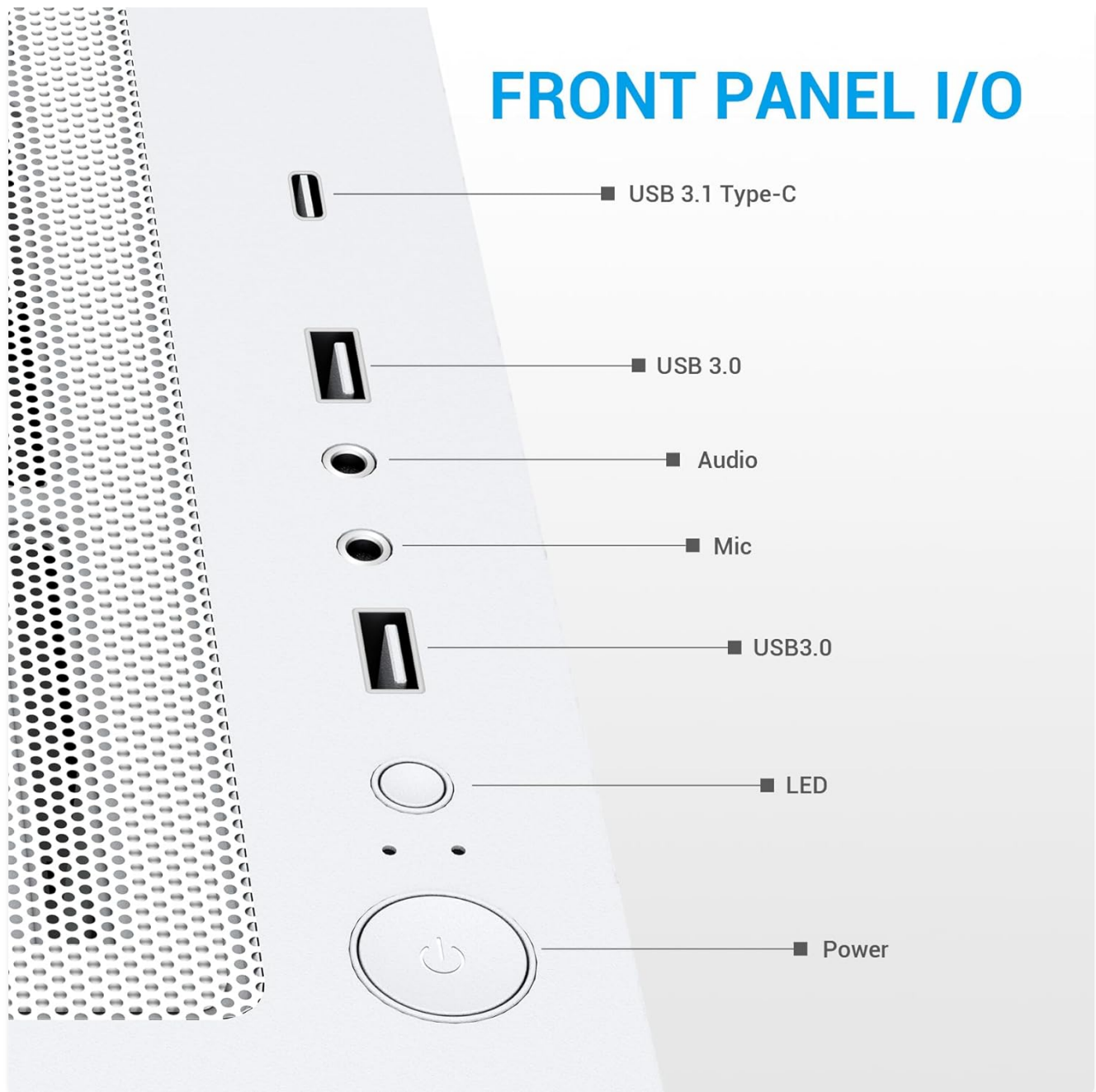

Image: The front I/O panel of the SAMA S40, indicating USB 3.1 Type-C, USB 3.0, Audio, Mic, LED, and Power buttons.

The front I/O panel includes:

- USB 3.1 Type-C Port
- 2 x USB 3.0 Ports
- HD Audio Jack
- Microphone Jack
- LED Control Button
- Power Button

PRE-INSTALLED FANS

4PIN + 5VARGB CASE FANS (PWM 1500RPM)



270° wide Angle View

Rear
x1
120mm PWM
ARGB Fan



Side
x3
120mm PWM
ARGB Reverse Fan



Fan PWM and ARGB HUB included



Image: Illustration of the SAMA S40 with pre-installed fans (3 front, 1 rear) and overall dimensions.

2. Motherboard Installation

The SAMA S40 supports ATX, Micro-ATX, and Mini-ITX motherboards. Install your motherboard using the appropriate standoffs and screws provided in the accessory box.

MOTHERBOARD SUPPORT

ITX/MATX/ATX

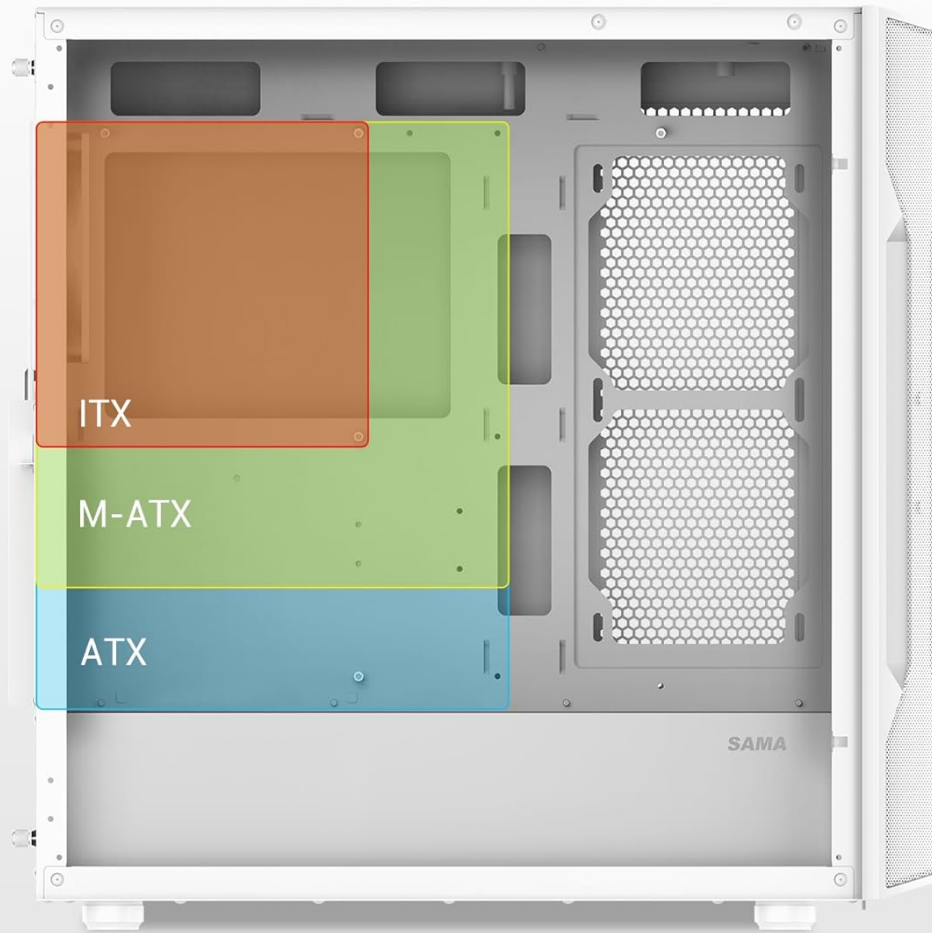

Image: Visual representation of motherboard size compatibility within the SAMA S40 case.

3. Graphics Card Installation

This case accommodates high-end graphics cards up to 415mm in length. It features 7+2 PCIe expansion slots, allowing for flexible installation, including vertical GPU mounting with an optional riser cable (not included).

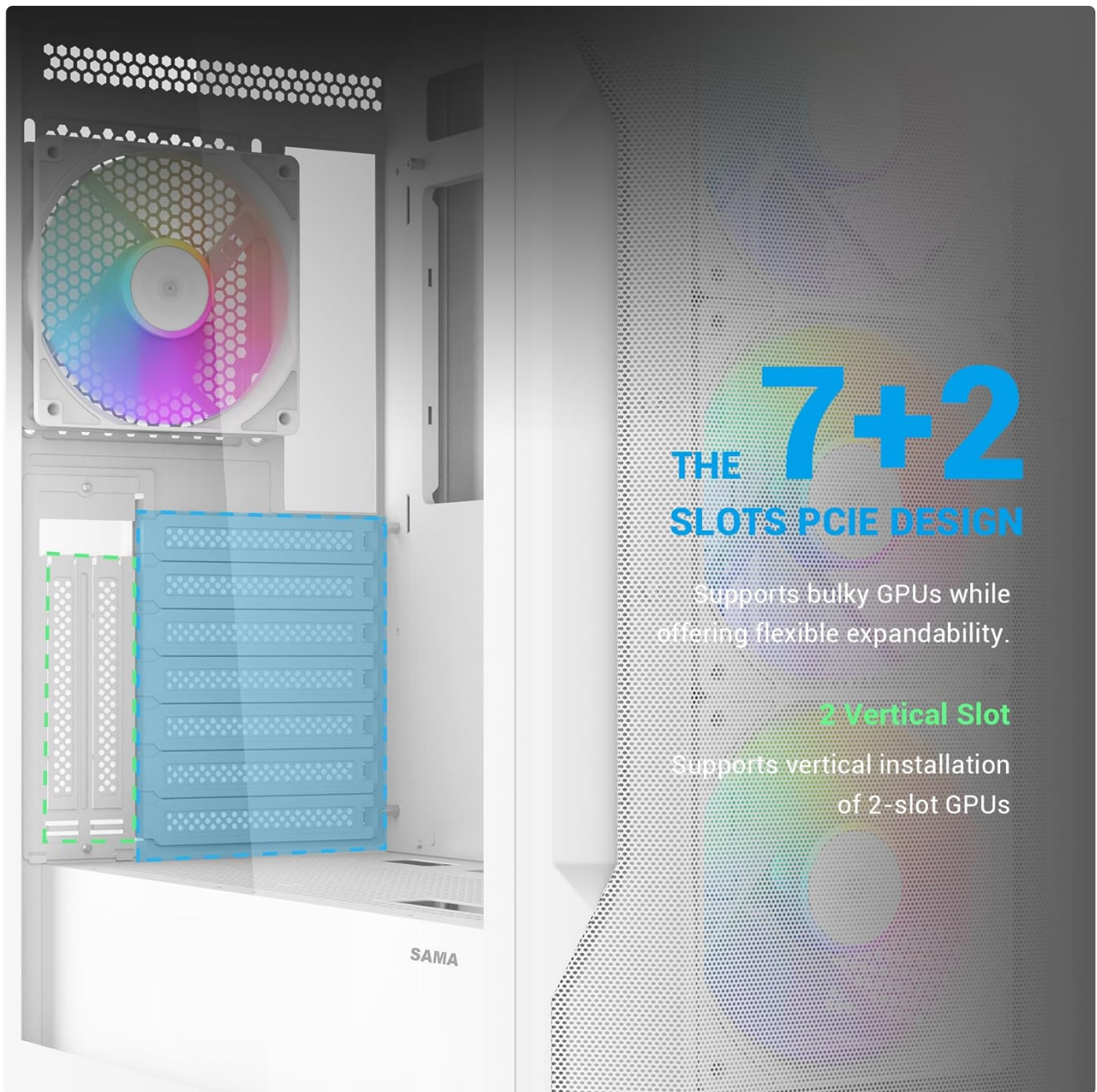

Image: Illustration of the 7+2 PCIe slot design, highlighting support for vertical GPU installation.

4. Storage Drive Installation

The S40 offers versatile storage options, supporting up to three 3.5" HDDs or three 2.5" SSDs, with various hybrid configurations possible.

DRIVE CAPACITY SUPPORT

2.5" SSD ×2 / 3.5" HDD ×1

on the HDD tray behind the motherboard

2.5" SSD ×1 + 3.5" HDD ×1 / 3.5" HDD ×2

on the HDD cage above the bottom plate

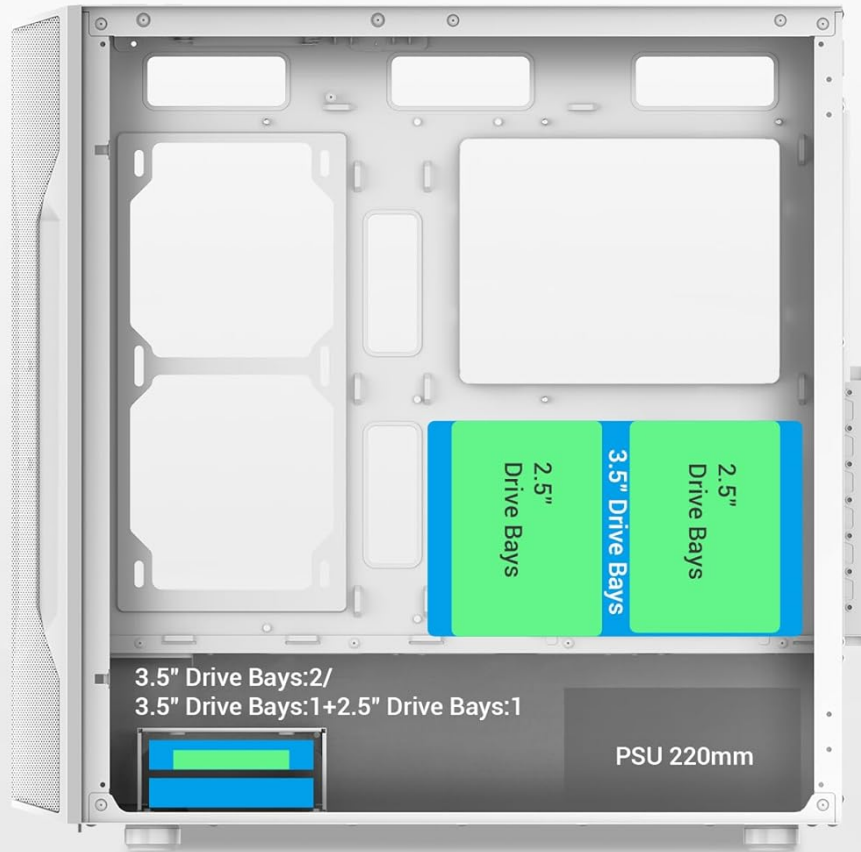

Image: Layout of the drive bays, showing locations for 2.5" SSDs behind the motherboard tray and 3.5" HDDs in the bottom cage.

5. Cooling System Setup

The case features a high-airflow design with a mesh front panel and supports up to 12 fans in total. A 360mm radiator can be accommodated on the top panel for advanced liquid cooling solutions.



Image: Visual representation of the airflow channels, showing intake from the front and exhaust from the top and rear.

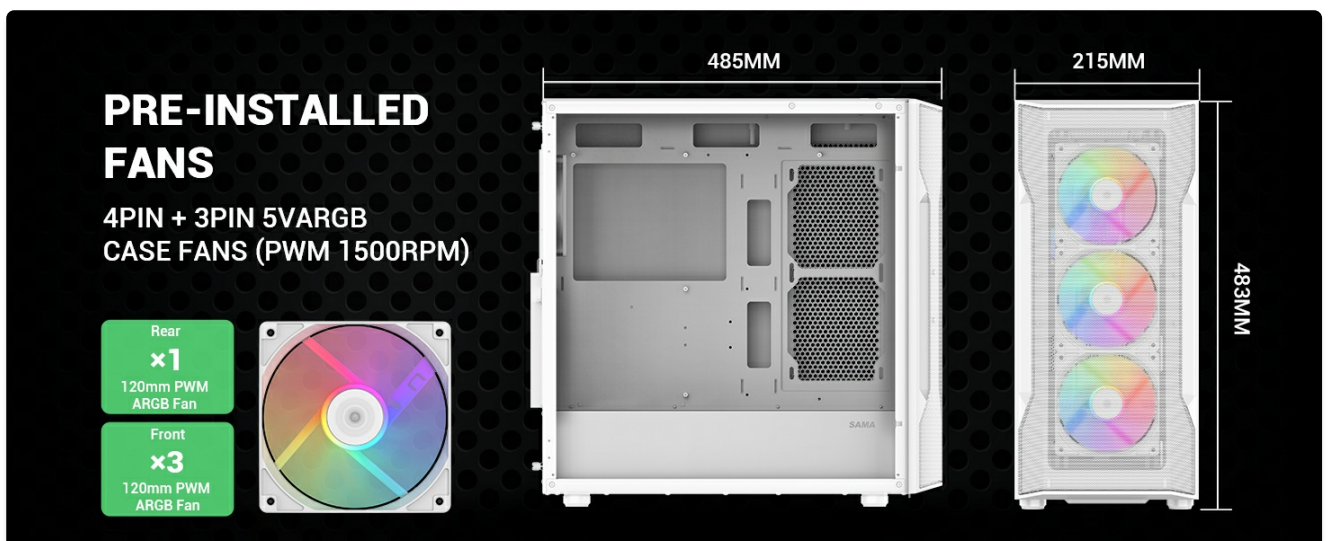

Image: Instructions for connecting the SATA cable from the power supply to the fan control board.

6. Cable Management

The S40 includes dedicated rear cable management space to help organize cables for a cleaner interior and improved airflow.

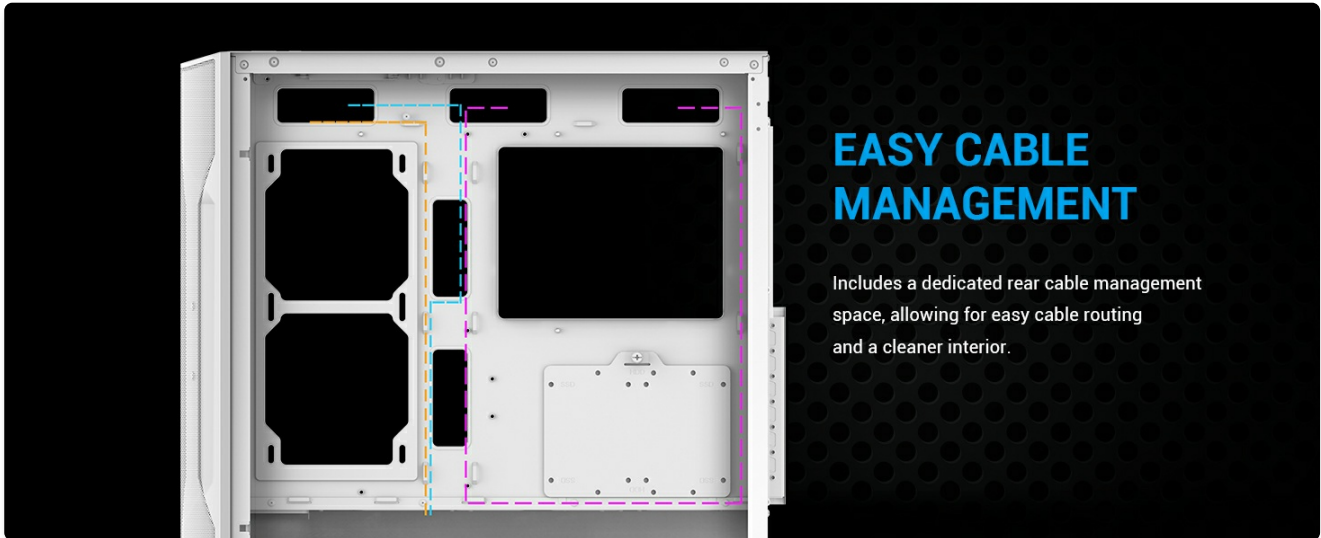

Image: Illustration of the cable management routes and tie-down points behind the motherboard tray.

OPERATING INSTRUCTIONS

Power On/Off

Press the power button located on the front I/O panel to turn your system on or off.

LED Control

Use the LED control button on the front I/O panel to cycle through various ARGB lighting effects for the pre-installed fans.

MAINTENANCE

Dust Filter Cleaning

The SAMA S40 is equipped with PVC dust filters on the top and bottom, and a fine nylon dust filter on the front panel. Regularly clean these filters to maintain optimal airflow and prevent dust buildup inside your PC.



Image: Visual guide to the removable dust filters located on the top, front, and bottom of the case.

Panel Removal

The tempered glass side panel can be easily removed without tools by unscrewing the hand-tightened screws, allowing quick access to the interior for installation or maintenance.

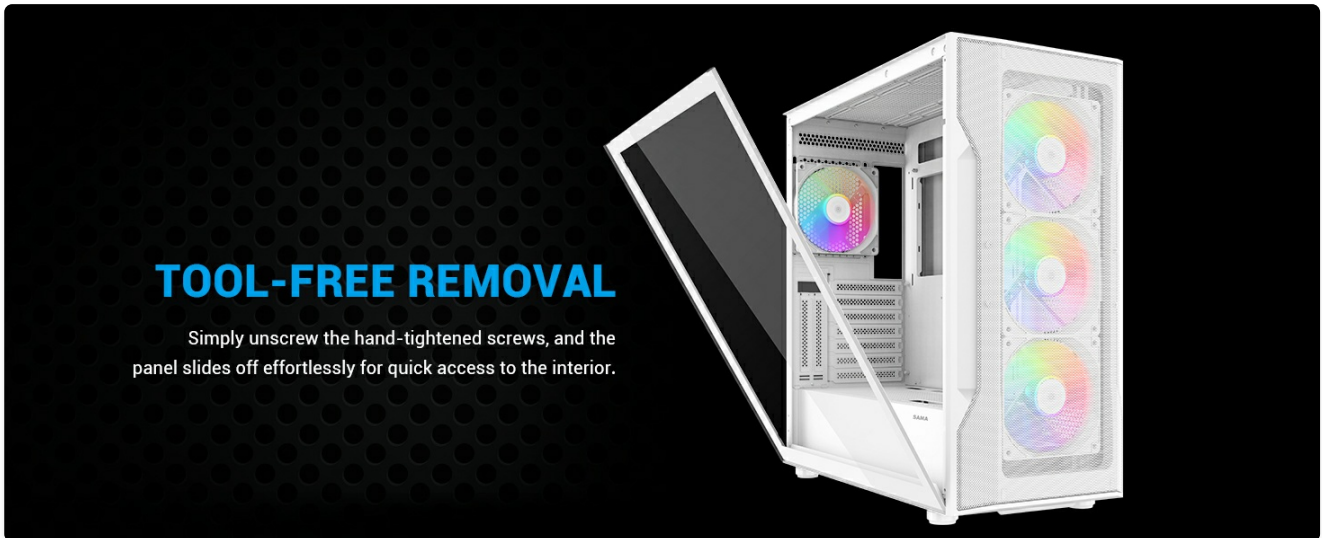

Image: Demonstration of the tool-free removal process for the tempered glass side panel.

TROUBLESHOOTING

If you encounter issues with your SAMA S40 PC case, consider the following common troubleshooting steps:

- **No Power:** Ensure all power supply cables are securely connected to the motherboard, GPU, and other components. Check the power button connection to the motherboard.
- **Fans Not Spinning/No RGB:** Verify that the fan power cables and ARGB cables are correctly connected to the fan hub and motherboard/controller. Check the fan control board's SATA power connection.
- **Poor Airflow:** Clean all dust filters regularly. Ensure fans are oriented correctly for optimal intake and exhaust.
- **Front I/O Not Working:** Check that all front panel connectors (USB, Audio, Power, LED) are correctly plugged into the motherboard headers.

OFFICIAL PRODUCT VIDEO

Video: SAMA S40 Chassis multi-angle display, showcasing the case design and features.

WARRANTY AND SUPPORT

SAMA products are manufactured to high-quality standards. For warranty information, technical support, or service inquiries, please refer to the official SAMA website or contact your local retailer. Keep your proof of purchase for warranty claims.

