

[Manuals.plus](#) /

› [ATMPC](#) /

› ATMPC T10 10.1-inch Android 14 Tablet User Manual

ATMPC T10

ATMPC T10 10.1-inch Android 14 Tablet User Manual

Model: T10

INTRODUCTION

This manual provides essential instructions for setting up, operating, and maintaining your ATMPC T10 10.1-inch Android 14 Tablet. Please read this guide thoroughly to ensure optimal performance and longevity of your device.

PACKAGE CONTENTS

Verify that all items are present in your package:

- ATMPC T10 Android Tablet
- Bluetooth Keyboard
- Wireless Mouse
- Stylus
- Protective Case
- USB-C Data Cable
- User Manual



Image: The ATMPC T10 Tablet shown with its full set of accessories, including the keyboard, mouse, stylus, protective case, and charging cable.



Image: A detailed view of each item included in the ATMPc T10 package, clearly labeled: Keyboard, Flat Protective Cover, Android Tablet, Wireless Mouse, Stylus, Data Cable, and the User Manual.

SETUP

1. Initial Charging and Power On

1. Connect the provided USB-C data cable to the tablet's charging port and a compatible USB power adapter (not always included).
2. Allow the tablet to charge for at least 30 minutes before first use, or until the battery indicator shows sufficient charge.
3. Press and hold the Power button located on the side of the tablet until the ATMPc logo appears.



Image: The tablet connected to a USB-C charger, illustrating the charging process and highlighting the 6000mAh battery capacity.

2. Wi-Fi Connection

1. From the home screen, tap the **Settings** icon.
2. Select **Network & internet**, then tap **Wi-Fi**.
3. Toggle **Wi-Fi On**.
4. Select your desired Wi-Fi network from the list.
5. Enter the network password if prompted, then tap **Connect**.

10.1 inch IPS Screen



10.1 inch
Display



1280*800
Resolution



IPS
Panel



Multi-touch



Image: The tablet screen showing "WiFi 6", emphasizing its dual-band WiFi 6 and Bluetooth 5.4 capabilities for fast and stable connections.

3. Connecting the Bluetooth Keyboard

1. Ensure the keyboard is charged.
2. Locate the **ON/OFF** switch on the keyboard and slide it to the **ON** position.
3. Press the **Connect** button on the keyboard to enter pairing mode. The Bluetooth indicator light will flash.
4. On your tablet, go to **Settings > Connected devices > Pair new device**.
5. Select the keyboard from the list of available devices (e.g., "BT Keyboard").
6. Follow any on-screen prompts to complete the pairing process.

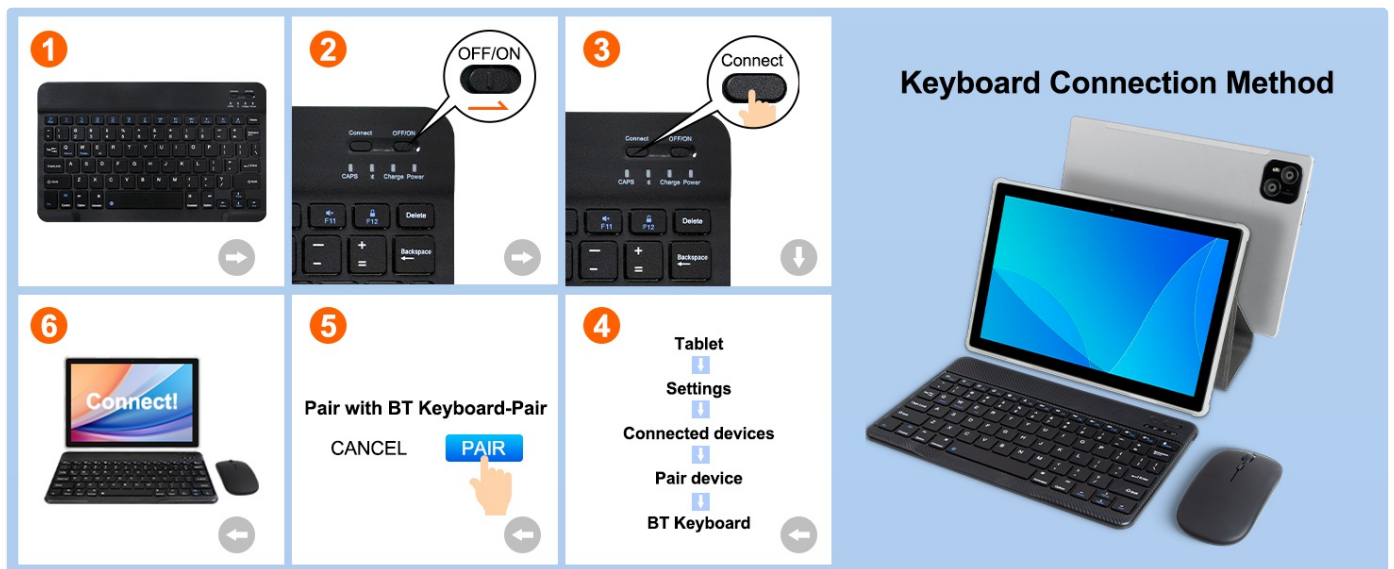

Image: A visual guide demonstrating the six steps to connect the Bluetooth keyboard to the ATMPc T10 tablet, from turning on the keyboard to pairing it via tablet settings.

4. Connecting the Wireless Mouse

1. Ensure the mouse has working batteries.
2. Locate the **ON/OFF** switch on the mouse and slide it to the **ON** position.
3. On your tablet, go to **Settings > Connected devices > Pair new device**.
4. Select the mouse from the list of available devices (e.g., "BT Mouse").
5. Follow any on-screen prompts to complete the pairing process.



Image: A visual guide demonstrating the six steps to connect the wireless mouse to the ATMPc T10 tablet, from turning on the mouse to pairing it via tablet settings.

OPERATING INSTRUCTIONS

1. Basic Navigation (Android 14)

- **Touchscreen Gestures:** Tap to select, swipe to scroll, pinch to zoom.
- **Home Screen:** Access apps, widgets, and notifications.
- **Notification Panel:** Swipe down from the top of the screen to view notifications and quick settings.
- **App Drawer:** Swipe up from the bottom of the screen to access all installed applications.

Android 14

Make your device more you



Android 14

Looks different

Parental Control

Control usage of your tablet



Privacy & Security

Manage and control your data



Split Screen

Multitasking easier



Image: The tablet displaying the Android 14 interface, highlighting key features such as parental control, privacy settings, and split-screen functionality.

2. Split Screen Functionality

The ATMPC T10 supports split-screen mode for enhanced multitasking:

1. Open the first application you wish to use.
2. Tap the **Recents** button (usually a square icon) to view recently opened apps.
3. Tap and hold the icon of the first app at the top of its card, then select **Split screen**.
4. Choose the second application from the recents list or app drawer to occupy the other half of the screen.

Immerse Audio Stereo Sound



Dual-band WiFi 6

BT 5.4 Faster WiFi 6



Long Lasting Battery

 **6000mAh**
Capacity

 **USB-C**
Easy to charge



Capture Wonderful Moments

 Rear 5MP

 Front 2MP



Image: The ATMPC T10 tablet in split-screen mode, showing two applications running simultaneously, demonstrating multitasking capabilities with the attached keyboard.

Split Screen

Maximize efficiency with our tablet's split-screen, letting you multitask effortlessly

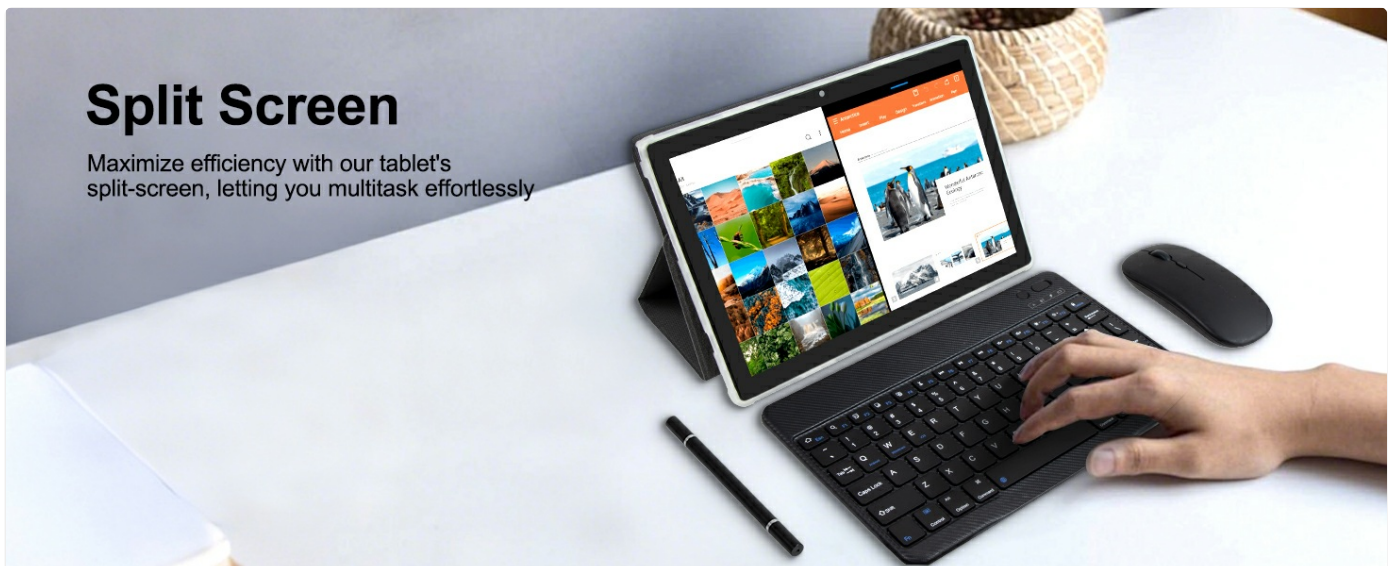

Image: The tablet displaying two applications side-by-side in split-screen mode, with the keyboard and mouse connected, illustrating efficient multitasking for productivity.

3. Camera Usage

The tablet features a 2MP front camera and a 5MP rear camera.

1. Open the **Camera** application from the home screen or app drawer.
2. Tap the camera switch icon to toggle between the front and rear cameras.
3. Tap the shutter button to capture photos or start/stop video recording.



Image: A close-up of the rear of the ATMP C T10 tablet, highlighting its dual camera module.

4. Audio Features

The ATMP C T10 tablet is equipped with stereo sound and a 3.5mm audio jack for headphones.

- **Built-in Speakers:** Enjoy immersive audio directly from the tablet.

- **3.5mm Audio Jack:** Connect your wired headphones or external speakers for private listening or enhanced sound.

Immerse AudioStereo Sound



3.5mm Audio Jack



Image: The tablet showcasing its immersive stereo sound capabilities with a music player interface, alongside an image of a user enjoying audio through headphones connected via the 3.5mm audio jack.

SPECIFICATIONS

Feature	Detail
Model	T10
Operating System	Android 14
Processor	Octa-Core
RAM	12GB (4GB + 8GB Virtual)
Internal Storage	64GB ROM
Expandable Storage	Up to 1TB via TF card
Screen Size	10.1 Inches
Screen Resolution	1280 x 800 Pixels (HD IPS)
Front Camera	2MP
Rear Camera	5MP
Battery Capacity	6000mAh
Average Battery Life	8 Hours
Connectivity	Dual-band WiFi 6 (2.4G/5G), Bluetooth 5.4
Charging Port	USB-C
Audio Jack	3.5mm

Feature	Detail
Item Weight	2.83 pounds
Product Dimensions	9.6 x 6.4 x 0.37 inches

Android 14

10.1 inch FHD 1280*800

64GB ROM

12GB RAM (4GB + 8GB Virtual)

Octa-Core Processor

2.4G/5G WiFi 6

6000 mAh

2MP Front Camera

5MP Rear Camera

9.5mm

540g

Image: An infographic summarizing the key specifications of the ATMPc T10 tablet, including its operating system, display, memory, storage, processor, battery, connectivity, and physical dimensions.

ATMPC Newest 2 in 1 Tablet Android 14

Octa-Core CPU | 12GB + 64GB | Various Accessories



Image: An overview of the ATMPC T10 tablet, highlighting its core components like the Octa-Core CPU, 12GB RAM, 64GB storage, and the included accessories.

MAINTENANCE

- **Cleaning:** Use a soft, lint-free cloth to clean the screen and body. Avoid abrasive materials or harsh chemicals.
- **Storage:** Store the tablet in a cool, dry place away from direct sunlight and extreme temperatures.
- **Battery Care:** To prolong battery life, avoid fully discharging the battery frequently. Charge the device regularly.
- **Software Updates:** Regularly check for and install system updates to ensure optimal performance and security.

TROUBLESHOOTING

Tablet does not power on:

Ensure the tablet is sufficiently charged. Connect it to the charger and wait a few minutes before attempting to power on again.

Cannot connect to Wi-Fi:

Check if Wi-Fi is enabled in settings. Verify the Wi-Fi password. Restart your router and the tablet. Ensure you are within range of the Wi-Fi signal.

Bluetooth accessories (keyboard/mouse) not pairing:

Ensure the accessories are charged/have fresh batteries and are in pairing mode. On the tablet, go to Bluetooth settings, turn Bluetooth off and then on again, and try to pair. Forget previously paired devices if issues persist.

Tablet is slow or unresponsive:

Close unnecessary background applications. Clear cache for frequently used apps. Restart the tablet. Consider performing a factory reset if the issue persists (back up data first).

Battery drains quickly:

Reduce screen brightness. Close unused apps. Turn off Wi-Fi/Bluetooth when not in use. Limit background data usage for apps.

WARRANTY AND SUPPORT

Your ATMPC T10 Tablet comes with a 1-Year Manufacturer Warranty.

For technical support or warranty claims, please contact ATMPC customer service:

- **Email:** atmpcservice@163.com
- **Response Time:** Replies typically within 24 hours.

ATMPC offers 30-day hassle-free returns. Please refer to your purchase documentation for detailed return policies.



Image: A summary of ATMPC's customer support and warranty details, including the 1-year warranty, 30-day free return policy, and contact email for service.

