

Eseesmart YL-D208

Eseesmart YL-D208 Smart Door Lock Instruction Manual

Model: YL-D208

1. INTRODUCTION

Thank you for choosing the Eseesmart YL-D208 Smart Door Lock. This advanced door lock offers multiple convenient and secure access methods, including fingerprint, keypad code, RFID card, mobile application, and traditional mechanical keys. Designed for ease of use and robust security, it is suitable for various environments, including homes, offices, and rental properties.

This manual provides detailed instructions for the installation, setup, operation, and maintenance of your smart door lock. Please read it thoroughly before installation and use to ensure proper functionality and safety.



Image 1.1: EseeSmart YL-D208 Smart Door Lock with included RFID cards and mobile application interface.

2. IMPORTANT SAFETY INFORMATION

- Read all instructions carefully before installation and use.
- Do not attempt to disassemble or repair the lock yourself. Refer to qualified personnel for service.
- Use only the specified AAA batteries. Do not mix old and new batteries or different types of batteries.
- Keep mechanical backup keys in a secure location outside the property.

- Ensure the door is properly aligned and closes smoothly before installing the lock to prevent damage.
- The lock is designed to be waterproof and suitable for various weather conditions. However, avoid prolonged submersion or direct high-pressure water jets.



Image 2.1: The Eseesmart YL-D208 Smart Door Lock is designed to withstand various weather conditions.

3. PACKAGE CONTENTS

Please verify that all components are present in the package:

- Eeesmart YL-D208 Smart Door Lock (Front and Rear Panels)
- 3585 Mortise Lock Body
- Mechanical Backup Keys (2)
- RFID Cards (2)
- Mounting Screws and Accessories
- Installation Template
- User Manual (This document)

4. PRODUCT OVERVIEW

Familiarize yourself with the main components of your Eeesmart YL-D208 Smart Door Lock:

- **Front Panel:** Keypad, Fingerprint Sensor, RFID Reader, Mechanical Keyhole, Handle.
- **Rear Panel:** Battery Compartment, Reset Button, Handle, Privacy Lock Button.
- **Mortise Lock Body:** The internal locking mechanism that fits into the door.

NO BATTERY ANXIETY

Low Power Consumption, Longer Battery Life

8 Month*

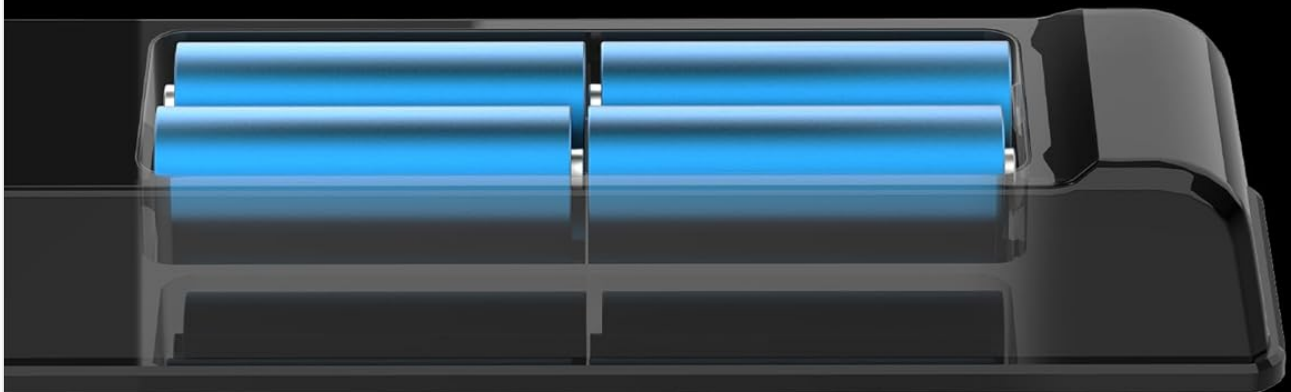

Peace of Mind



*Varies depending on the actual usage and environmental factor

Image 4.1: Close-up of the front panel, highlighting the 3D fingerprint sensor and backlit keypad.

5. INSTALLATION GUIDE

The EseeSmart YL-D208 Smart Door Lock is designed for compatibility with 99% of standard UK door locks and includes a 3585 mortise. It is suitable for door thicknesses ranging from 40mm to 120mm. The handle can rotate 45 degrees, and the lock length is 320mm.

5.1 Preparation

- Ensure your door meets the specified thickness and dimensions.
- Use the provided installation template to mark drilling points on your door.
- Gather necessary tools: screwdriver, drill, tape measure, pencil.

5.2 Installation Steps (General)

1. **Prepare the Door:** If replacing an existing lock, remove it. Drill holes as marked by the template.
2. **Install the Mortise:** Insert the 3585 mortise lock body into the door edge and secure it with screws.
3. **Install Front Panel:** Route the connecting cable through the door. Position the front panel and secure it.
4. **Install Rear Panel:** Connect the cable from the front panel to the rear panel. Attach the rear panel to the door, ensuring proper alignment.
5. **Test Functionality:** Before closing the door, test the handles and the latch mechanism to ensure smooth operation.

BRILLIANT FOR UK RESIDENT

Compatible with UK "Lift to Lock" Multipoint Locks

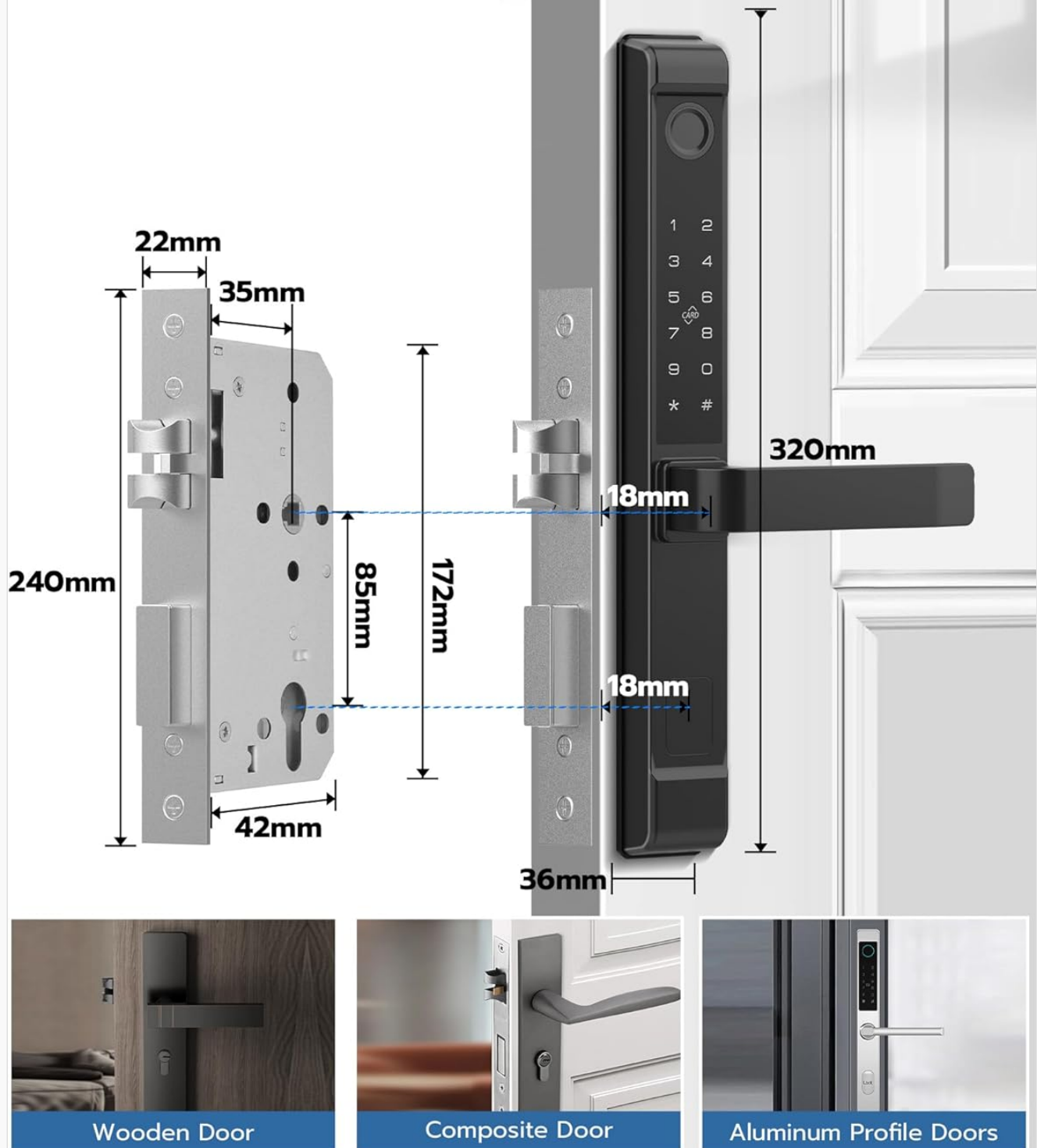

Image 5.1: Dimensions and compatibility details for the Eeesmart YL-D208 Smart Door Lock, suitable for wooden, composite, and aluminum profile doors.

6. INITIAL SETUP AND USER MANAGEMENT

6.1 Powering On

Insert 4 AAA batteries (not included) into the battery compartment on the rear panel. The lock will emit a startup sound.

6.2 Mobile Application Pairing

1. Download the designated smart lock application (e.g., Tuya Smart or Smart Life) from your app store.
2. Create an account or log in.
3. Enable Bluetooth on your smartphone.
4. In the app, select "Add Device" and follow the on-screen instructions to pair with your YL-D208 lock.

6.3 Administrator Setup

The first user registered will automatically be designated as an administrator. The lock supports up to 9 administrators and 291 ordinary users.

- **Via App:** Follow the app's instructions to add the first fingerprint, code, or RFID card.
- **Via Lock Keypad:** Refer to the specific instructions in the app or a detailed quick start guide for direct keypad programming of the first administrator.

6.4 Adding Users (Fingerprint, Code, RFID)

Once an administrator is set up, they can add additional users through the mobile application or directly on the lock's keypad. The app provides a user-friendly interface for managing access rights, including temporary passwords for guests.

7. OPERATING THE LOCK

The EseeSmart YL-D208 offers five primary methods for unlocking:

5-1 WAYS TO UNLOCK

Smarter | Faster

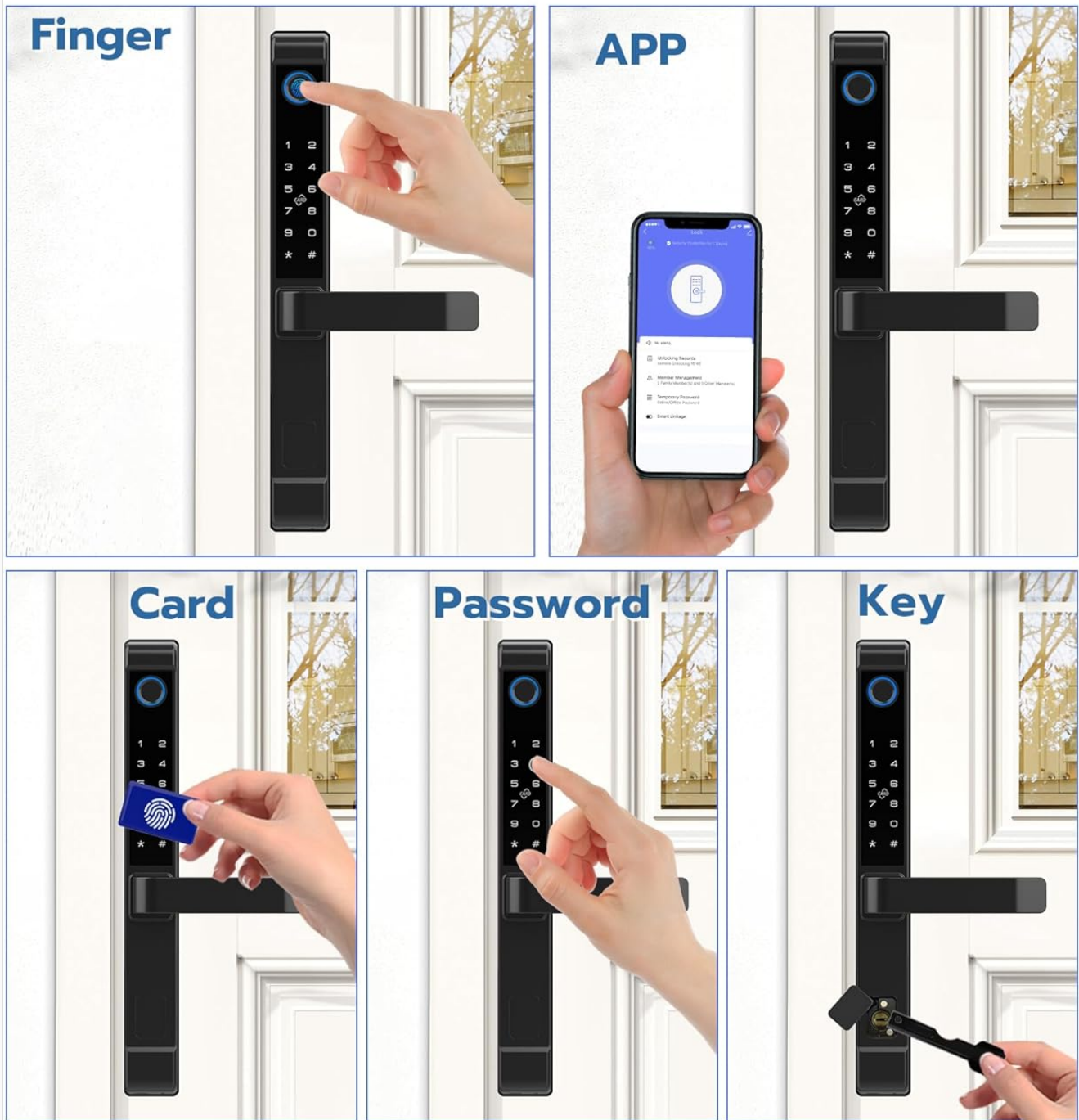

Image 7.1: Five convenient methods for unlocking your Eesmart YL-D208 Smart Door Lock.

7.1 Unlocking Methods

- **Fingerprint:** Place your registered finger on the fingerprint sensor. The lock will unlock upon successful recognition (0.2s faster unlock with 3D sensor).
- **Keypad Code:** Enter your registered access code on the backlit keypad, followed by '#'.
- **RFID Card:** Present your registered RFID card to the RFID reader area on the front panel.
- **Mobile Application:** Open the paired app on your smartphone and tap the unlock button. For remote unlock requests, a visitor can press '9' + '#' on the keypad, sending a notification to your app for one-click remote unlocking.

- **Mechanical Key:** Insert the backup key into the hidden keyhole and turn to unlock.

7.2 Locking the Door

- **Automatic Locking:** The lock will automatically re-lock after a set period (configurable in the app).
- **Manual Locking:** For multipoint locks, lift the handle upwards to engage the additional locking points.
- **Privacy Lock:** Use the privacy lock button on the rear panel for added security from the inside.

8. MAINTENANCE

8.1 Battery Replacement

The lock operates on 4 AAA batteries (not included) and offers approximately 8 months of battery life, depending on usage frequency. A low battery reminder will alert you when batteries need replacement.

1. Locate the battery compartment on the rear panel.
2. Remove the cover and replace all four AAA batteries with new ones.
3. Ensure correct polarity (+/-).

8.2 Emergency Power

In case of complete battery depletion, an emergency USB charging port is available on the front panel. Connect a power bank to temporarily power the lock and gain access. This port is for emergency power only and cannot charge internal batteries.

Work in ALL Weather Environment



Image 8.1: Battery compartment and emergency USB charging port for the EseeSmart YL-D208 Smart Door Lock.

8.3 Cleaning

Wipe the lock's surface with a soft, dry cloth. Avoid using abrasive cleaners or solvents that could damage the finish or electronic components.

9. TROUBLESHOOTING

Problem	Possible Cause	Solution
Lock does not respond.	Dead batteries.	Replace batteries or use emergency USB power.
Cannot register fingerprint/code/RFID.	No administrator set up; incorrect procedure.	Ensure an administrator is registered first. Follow setup instructions carefully.
Lockout after multiple failed attempts.	5 invalid entries (code or RFID).	The lock will disable for 90 seconds. Wait for the lockout period to end.
Door does not lock/unlock smoothly.	Misalignment; obstruction.	Check door alignment and ensure no obstructions. Re-check installation.
Alarm sounds unexpectedly.	Anti-burglary alarm triggered.	Verify door security. If false alarm, check for loose components or sensor issues.

10. SPECIFICATIONS

- Brand:** Eseesmart
- Model Number:** YL-D208
- Dimensions (L x W x H):** 5 x 5 x 20 cm
- Weight:** 2.2 Kilograms
- Color:** Black
- Material:** Acrylonitrile Butadiene Styrene, Zinc
- Style:** Modern
- Finish:** Polished
- Special Features:** Alarm, Backlit Keypad, Remote Unlock, Fingerprint, Application Control, RFID, Access Codes, 2 Backup Keys, Touch Screen
- Lock Type:** Biometric, Keypad, Deadbolt, Combination Lock
- Power Source:** 4 x AAA Batteries (not included)
- Battery Life:** Approximately 8 months (varies with usage)
- Emergency Power:** USB Charging Port
- Door Thickness Compatibility:** 40 - 120 mm
- Mortise Type:** 3585 (included)
- User Capacity:** 300 (9 administrators, 291 ordinary users)

11. WARRANTY AND SUPPORT

- The Eseesmart YL-D208 Smart Door Lock comes with a **12-month warranty** from the date of purchase, covering manufacturing defects and malfunctions under normal use.
- Eseesmart is committed to providing **lifetime customer service**. If you encounter any issues during installation, setup, or operation, or have any questions regarding your smart door lock, please do not hesitate to contact our support team.
- Contact Information:**
- Please refer to the contact details provided on the product packaging or the official Eseesmart website for the most

up-to-date support channels.

