



Manuals.plus /

› Samsung /

› Samsung Galaxy Tab S10 Ultra Tablet User Manual

Samsung Galaxy Tab S10 Ultra

Samsung Galaxy Tab S10 Ultra User Manual

Model: Galaxy Tab S10 Ultra

INTRODUCTION

This manual provides essential information for setting up, operating, maintaining, and troubleshooting your Samsung Galaxy Tab S10 Ultra. Please read this guide thoroughly to ensure optimal performance and longevity of your device. The Samsung Galaxy Tab S10 Ultra is designed for unparalleled performance and immersive entertainment. It features a stunning 14.6-inch Super AMOLED display, a powerful Snapdragon 8 Gen 1 processor, and 256GB of storage, making it suitable for both productivity and leisure.

WHAT'S IN THE BOX

Verify that all items are present in the product packaging:

- Samsung Galaxy Tab S10 Ultra Tablet
- S Pen
- USB-C Data Cable
- Ejection Pin
- Quick Start Guide

What's in the box

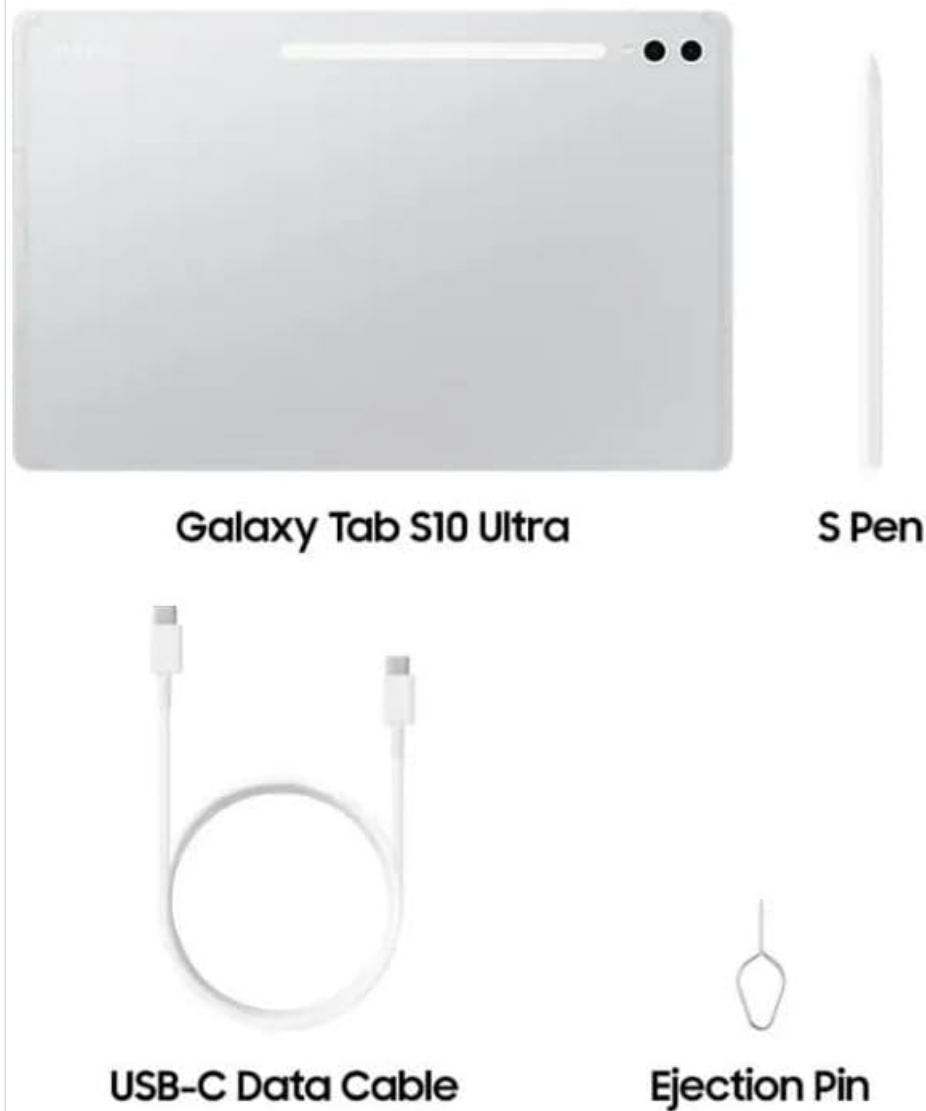

This image displays the typical contents found within the Samsung Galaxy Tab S10 Ultra packaging: the tablet itself, an S Pen, a USB-C data cable, and an ejection pin, along with a quick start guide.

SETUP GUIDE

1. Initial Charging

Before first use, fully charge your Galaxy Tab S10 Ultra using the provided USB-C cable and a compatible power adapter (sold separately). The device features an 11,200mAh battery, offering up to 16 hours of video playback.

2. Powering On/Off

- **To Power On:** Press and hold the Power button located on the side of the tablet until the Samsung logo appears.
- **To Power Off:** Press and hold the Power button, then tap "Power off" on the screen. Alternatively, swipe down from the top of the screen to open the Quick Panel, tap the Power icon, and select "Power off."

3. Initial Setup Wizard

Follow the on-screen prompts to complete the initial setup:

1. Select your preferred language.
2. Connect to a Wi-Fi network.
3. Review and accept the End User License Agreement and Privacy Policy.
4. Sign in with your Google account or create a new one.
5. Set up security features like a PIN, pattern, password, or fingerprint.
6. Restore data from a previous device (optional).

4. S Pen Pairing

The S Pen typically pairs automatically when attached to the magnetic charging strip on the back of the tablet. Ensure the S Pen is securely attached to charge and maintain connection.

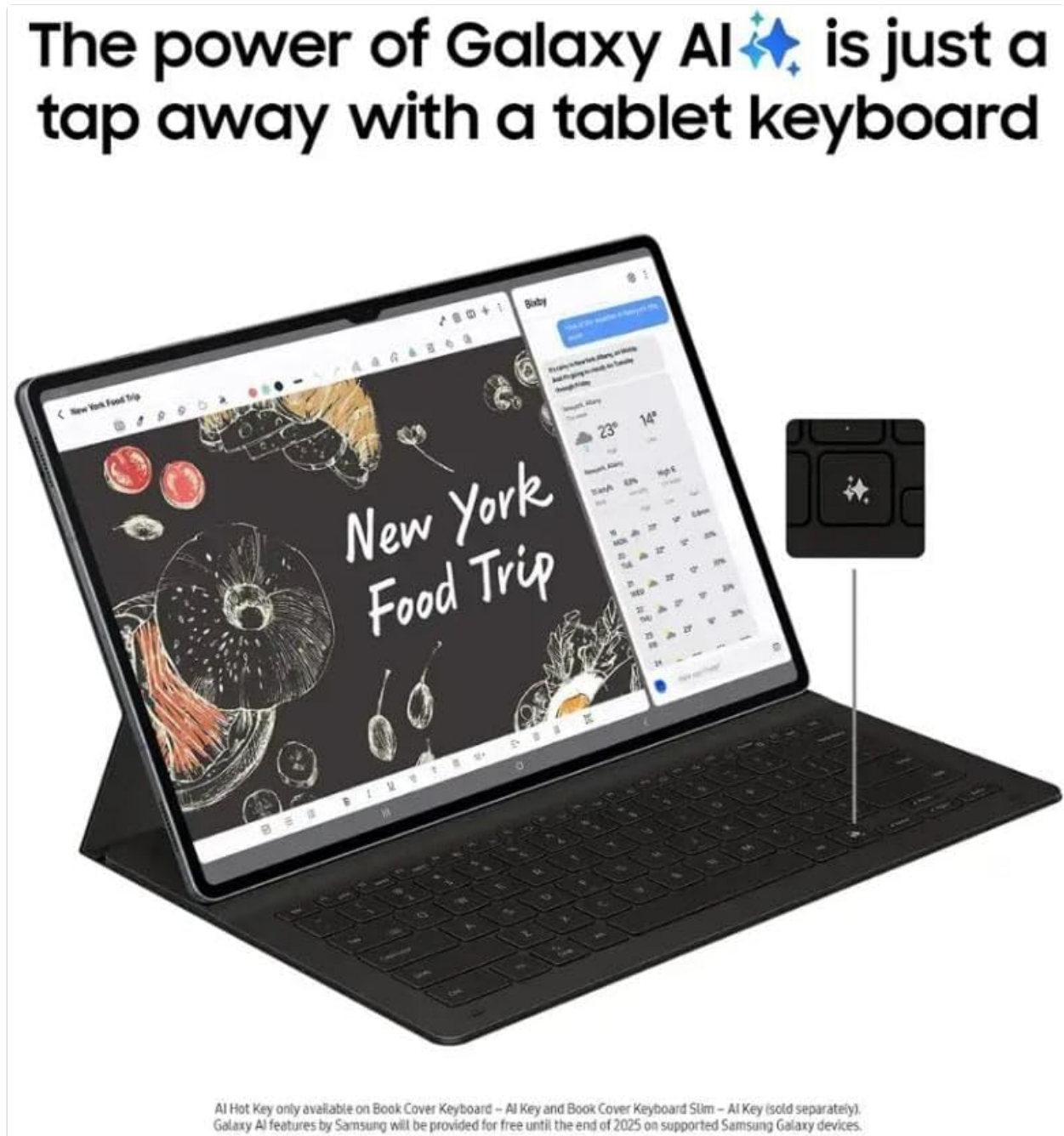

This image shows the Samsung Galaxy Tab S10 Ultra connected to a keyboard cover, demonstrating its use for productivity with the S Pen. The tablet's large display is ideal for tasks requiring extensive screen real estate.

OPERATING INSTRUCTIONS

1. Basic Navigation

- **Touch Gestures:** Tap to select, swipe to scroll, pinch to zoom.
- **Home Screen:** Access apps, widgets, and notifications. Customize by long-pressing on an empty area.
- **App Drawer:** Swipe up from the home screen to view all installed applications.
- **Recent Apps:** Tap the Recent Apps button (usually a square icon) or swipe up and hold from the bottom of the screen to see recently used applications.

2. Using the S Pen

The S Pen enhances productivity and creativity. Use it for:

- **Note-taking:** Quickly jot down notes with the screen off or in the Samsung Notes app.
- **Drawing and Sketching:** Utilize various art applications for creative expression.
- **Air Command:** Hover the S Pen over the screen and press the button to access quick functions like Smart Select, Screen Write, and Live Message.
- **Air Actions:** Control your tablet remotely with S Pen gestures (e.g., navigate presentations, control media playback).

3. Connectivity

- **Wi-Fi:** Go to *Settings > Connections > Wi-Fi* to connect to available networks.
- **Bluetooth:** Go to *Settings > Connections > Bluetooth* to pair with wireless accessories like headphones or keyboards.
- **USB-C:** Use the USB-C port for charging, data transfer, or connecting to external displays with compatible adapters.

4. Display Settings

Your tablet features a 14.6-inch Super AMOLED display with a resolution of 2960x1848 pixels and adaptive refresh rates up to 120Hz. Adjust display settings via *Settings > Display* for brightness, dark mode, screen mode, and refresh rate. The anti-reflection screen reduces glare for improved viewing.



Anti-reflection

Experience unbelievable brilliance with reduced glare on a large Dynamic AMOLED 2X screen.



Immersive display

A big screen for a big experience

Measured diagonally, the Galaxy Tab S10 Ultra screen size is 14.6" in the full rectangle and 14.5" accounting for the rounded corners. Actual viewable area is less due to the rounded corners.



Durability

With an Armor Aluminum frame, it's designed to be durable against bumps, dust and splashes.

Consistent with IP68 rating, water resistant up to 5 feet of water for up to 30 minutes. Rinse residue / dry after wet.

This image highlights key display and build features: the anti-reflection screen for reduced glare, the expansive 14.6-inch immersive display, and the tablet's durability due to its Armor Aluminum frame, designed to resist bumps, dust, and splashes.

5. Galaxy AI Features

Leverage integrated AI capabilities for enhanced productivity and creativity:

- **Note Assist:** Summarize long notes or format them automatically.
- **Circle to Search:** Circle an object on your screen to instantly search for information about it.
- **Math Helper:** Solve handwritten math problems by scanning them.
- **Sketch to Image:** Convert simple sketches into detailed images.

Galaxy AI ✨ is here



Note Assist

Note Assist makes a long story short

Format in Samsung Notes only (200 – 4,000 characters), requires Samsung account login and internet connection.



Circle to Search

Circle it, search it, find it. Just like that.

Circle to Search
with Google

Requires internet connection; results may vary by uniqueness, clarity and framing of circled image and related factors.



Math helper

Solve handwritten math problems

Math helper feature requires a network connection and Samsung account login. Math helper feature not available at launch; available via software update by 12/31/24.



Sketch to Image

Turn your simple sketches into works of art instantly using Sketch to Image

Sketch to Image feature requires a network connection and Samsung account login. Editing with Sketch to Image may result in a resized photo up to 12MP. A visible watermark is overlaid on the image output upon saving in order to indicate that the image is generated by AI. The accuracy and reliability of the generated output is not guaranteed.

Galaxy AI features by Samsung will be provided for free until the end of 2025 on supported Samsung Galaxy devices.

This image demonstrates the various Galaxy AI features available on the tablet, including Note Assist for summarizing text, Circle to Search for quick information retrieval, Math helper for solving equations, and Sketch to Image for creative content generation.

MAINTENANCE

1. Cleaning the Device

- Use a soft, lint-free cloth to clean the screen and body.
- For stubborn smudges, slightly dampen the cloth with water or a screen cleaner specifically designed for electronics.
- Avoid harsh chemicals, abrasive materials, or excessive moisture.

2. Software Updates

Regularly check for and install software updates to ensure optimal performance, security, and access to new features. Go to *Settings > Software update > Download and install*

3. Battery Care

- Avoid extreme temperatures, as they can degrade battery life.
- Do not leave the tablet fully charged or fully discharged for extended periods.
- For long-term storage, charge the battery to around 50%.

4. Storage Management

Periodically review and manage your 256GB internal storage. Delete unnecessary files, uninstall unused apps, or transfer large media to cloud storage or an external drive to maintain performance. The tablet supports microSD card expansion for additional storage (card sold separately).

TROUBLESHOOTING

Device Not Turning On

- Ensure the battery is charged. Connect the tablet to a charger for at least 10-15 minutes.
- Perform a forced restart: Press and hold the Power button and Volume Down button simultaneously for about 7-10 seconds until the device restarts.

Wi-Fi Connection Issues

- Restart your Wi-Fi router and the tablet.
- Forget the network and reconnect: Go to *Settings > Connections > Wi-Fi*, tap the gear icon next to the network, then "Forget." Re-enter the password.
- Ensure the tablet is within range of the Wi-Fi router.

Slow Performance

- Close unused applications running in the background.
- Clear cache data for apps: *Settings > Apps > [App Name] > Storage > Clear cache*
- Free up storage space by deleting unnecessary files or uninstalling unused apps.
- Restart the tablet regularly.

Battery Draining Quickly

- Reduce screen brightness.
- Disable Wi-Fi, Bluetooth, and GPS when not in use.
- Identify and close power-intensive apps in the background.
- Check battery usage in *Settings > Battery and device care > Battery* to identify apps consuming the most power.

Factory Reset (Last Resort)

If issues persist, a factory reset can resolve many software-related problems. **Warning: This will erase all data on your tablet. Back up important data before proceeding.**

1. Go to *Settings > General management > Reset > Factory data reset*
2. Review the information and tap "Reset device."
3. Enter your PIN/password if prompted, then tap "Delete all."

SPECIFICATIONS

Brand	Samsung
Model Name	Galaxy Tab S10 Ultra
Model Number	SM8450
Memory Storage Capacity	256 GB
RAM Memory Installed	12 GB
Screen Size	14.6 Inches
Display Type	AMOLED 2X
Native Resolution	2960 x 1848 pixels
Frame Rate	60Hz, 90Hz, 120Hz
Processor Brand	Qualcomm
Processor Description	Snapdragon 8 Gen 1
Processor Speed	3.4 GHz
Operating System	Android
Battery Capacity	11200 Milliamp Hours
Battery Average Life	16 Hours (video playback)
Connectivity Technology	Bluetooth 5, USB Type C, Wi-Fi (802.11ax)
Item Dimensions (L x W x Thickness)	10"L x 0.2"W x 7"Th
Human-Interface Input	Touchscreen with Stylus Support
Specific Uses For Product	Gaming, Multimedia, Productivity



This image provides a side view of the Samsung Galaxy Tab S10 Ultra, emphasizing its ultra-slim profile and the placement of its speaker grilles, contributing to its sleek and lightweight design.

WARRANTY INFORMATION

The Samsung Galaxy Tab S10 Ultra comes with a **90 Days Limited Warranty**. This warranty covers manufacturing defects under normal use. For detailed terms and conditions, please refer to the warranty card included in your product packaging or visit the official Samsung support website.

Keep your proof of purchase for warranty claims.

SUPPORT

For further assistance, technical support, or to download the full user manual, please visit the official Samsung support website:

Samsung Official Support

You can also contact Samsung customer service directly for personalized support.