



[Manuals.plus](#) /

› [JUBEST](#) /

› JUBEST 16FT Box Rail Exterior Barn Door Hardware Kit User Manual

## JUBEST 16FT Box Rail Exterior Barn Door Hardware Kit

# JUBEST 16FT Box Rail Exterior Barn Door Hardware Kit User Manual

Model: 16FT (for 2 doors)

## 1. INTRODUCTION

This manual provides detailed instructions for the installation, operation, and maintenance of your JUBEST 16FT Box Rail Exterior Barn Door Hardware Kit. This heavy-duty system is designed for two doors, offering a smooth-gliding and weatherproof solution for exterior barn door applications.

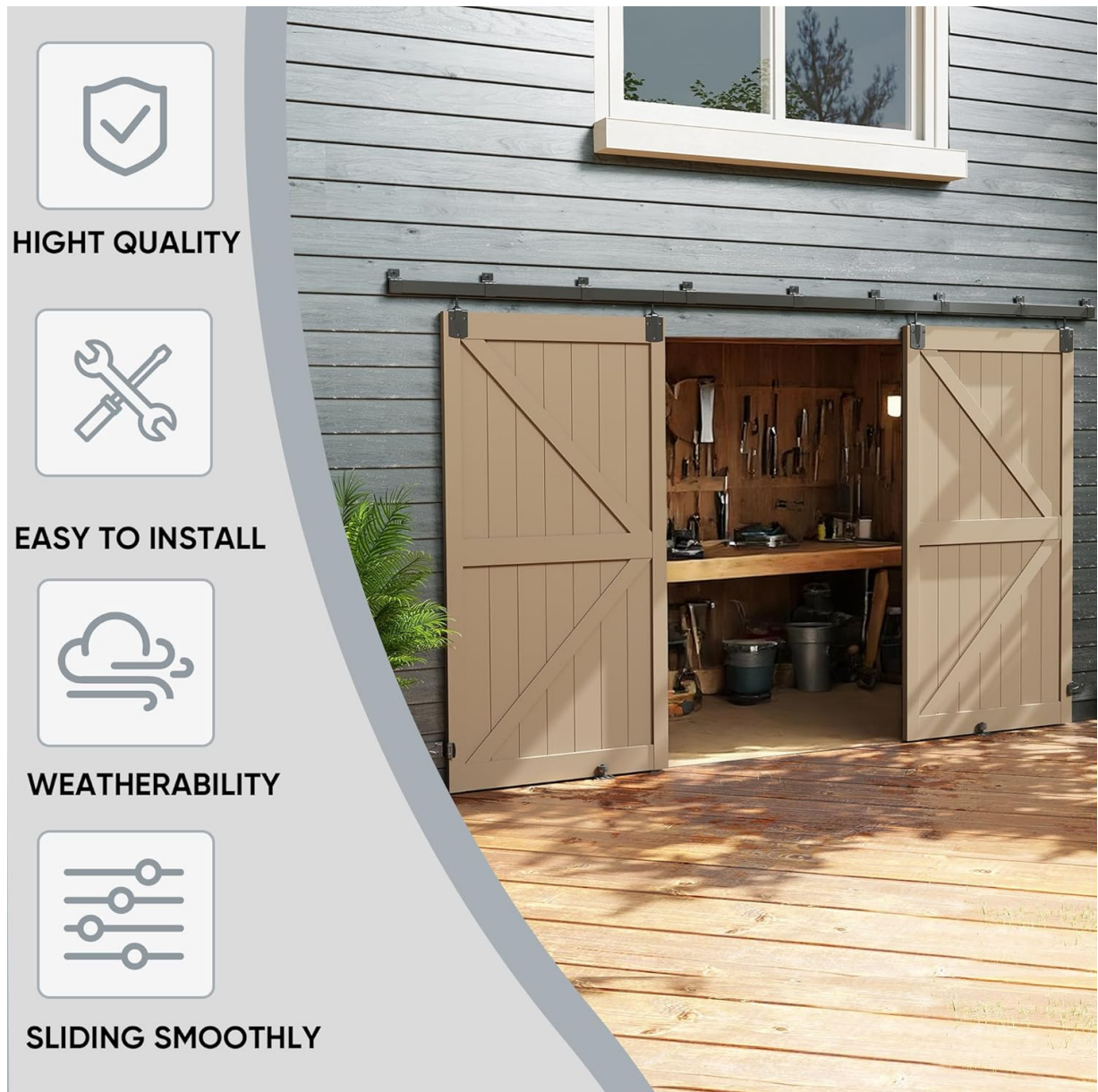

Image: An overview of the JUBEST barn door hardware kit installed on an exterior wall, emphasizing its key features: high quality, easy installation, weatherability, and smooth sliding.

## 2. SAFETY INFORMATION

Please read and understand all safety instructions before beginning installation or operation.

- Always wear appropriate safety gear, including gloves and eye protection, during installation.
- Ensure the wall structure is capable of supporting the combined weight of the doors and the hardware kit (up to 450 lbs per door). Consult a professional if unsure about wall integrity.
- Keep children and pets away from the work area during installation.
- Verify all components are securely fastened before operating the doors.
- Do not exceed the maximum door weight capacity of 450 lbs per door.

## 3. PACKAGE CONTENTS

Please verify that all components listed below are included in your package. **Door panels and handles are NOT included.**

# Package List



4FT Track x4

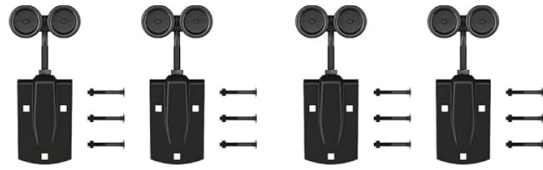

Roller x4



Stopper x2

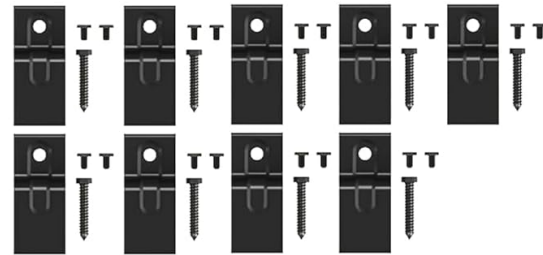

Track brackets x9



Track end caps x3

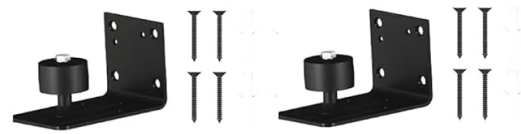

Floor Guide x2

Image: A visual representation of all components included in the JUBEST 16FT Box Rail Exterior Barn Door Hardware Kit, showing tracks, rollers, stoppers, track brackets, track end caps, and floor guides.

- 4 x 48" Track sections
- 3 x Track end caps
- 9 x Track brackets
- 4 x Hangers with door strap (Rollers)
- 2 x Galvanized steel floor guides
- 2 x Stoppers
- Step-by-step instructions (this manual)

## 4. PRODUCT SPECIFICATIONS

This kit is specifically designed for two doors.

# Product Size

Note: Doors are not Included

Door Weight  
Limit: **450lbs**

SIZE OPTION	TRACK LENGTH	FIT DOOR WIDTH	FIT DOOR OPENING WIDTH
8FT	4FT x2	2FT	Door Width-2"
10FT	3.3FT x3	2.5FT	Door Width-2"
12FT	4FT x3	3FT	Door Width-2"
14FT	4.66FT x3	3.5FT	Door Width-2"
16FT	4FT x4	4FT	Door Width-2"
20FT	4FT x5	5FT	Door Width-2"

Image: A table detailing various size options, corresponding track lengths, fit door widths, and fit door opening widths for the JUBEST barn door hardware kits. The 16FT option is highlighted.

Feature	Detail
Brand	JUBEST
Color	Black
Material	Galvanized Steel
Style	Industrial
Assembly Required	Yes
Max Door Weight (per door)	450 lbs
Door Panel Thickness	1-3/8" to 1-3/4"
Max Door Width (per door)	48"
Track Length (for 16FT kit)	4 x 48" sections

The hardware is engineered with industrial-grade roll-formed galvanized steel and has passed over 50,000 cycles of testing. The corrosion-resistant galvanized coating ensures durability in harsh outdoor conditions.

## 5. SETUP AND INSTALLATION

This section guides you through the installation process. Ensure you have all parts and necessary tools before beginning. No specialty tools are required.

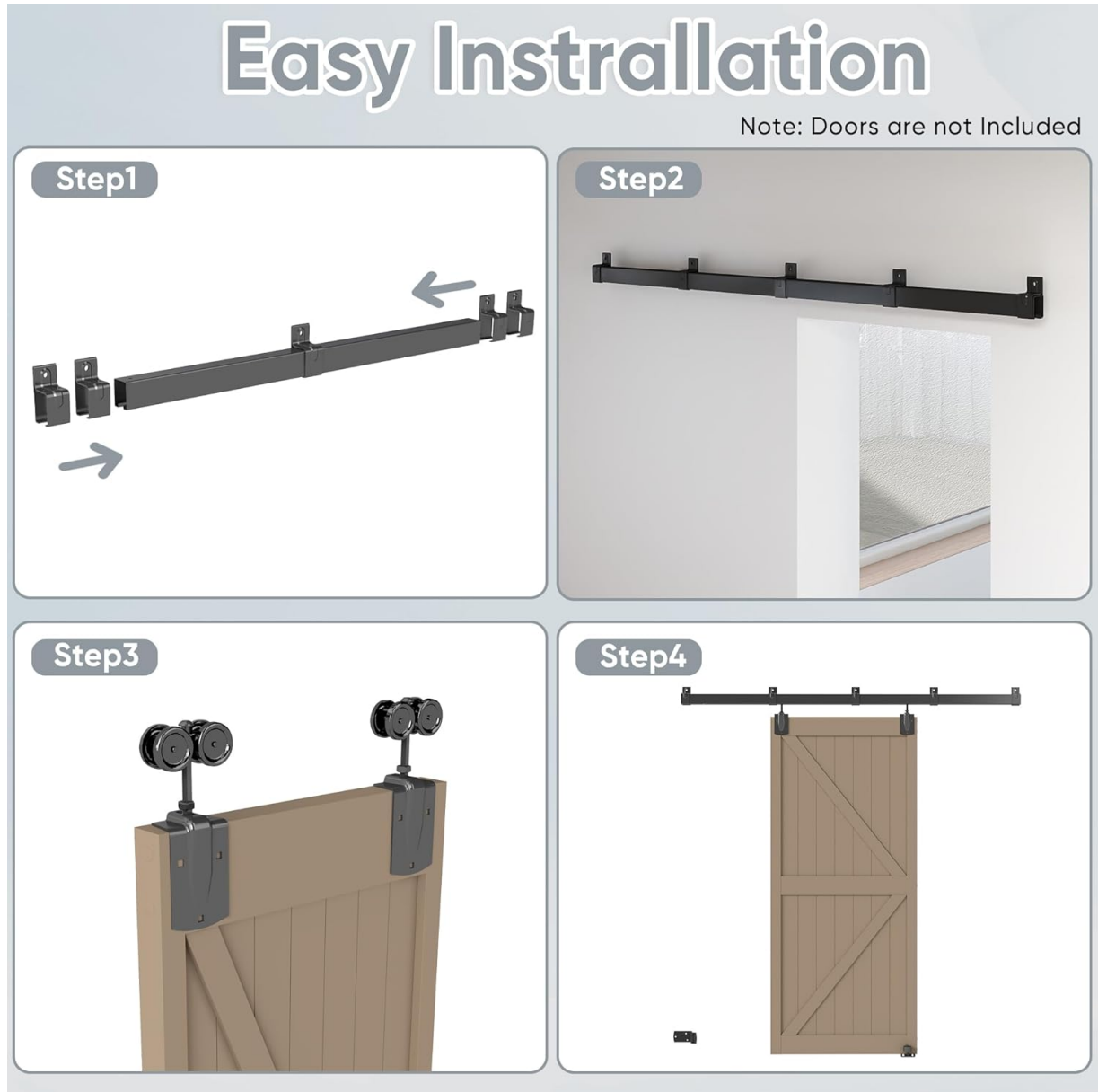

Image: A four-step visual guide demonstrating the installation process, from assembling the track to hanging the door.

- Step 1: Assemble the Track.** Connect the 48" track sections using the provided track brackets. Ensure proper alignment of the sections. *Note: Some users have reported minor misalignment in pre-drilled holes; careful alignment or slight adjustment with a file may be required for bolts to pass through smoothly.*
- Step 2: Mount the Track.** Securely attach the assembled track to the wall using the track brackets. It is crucial to anchor the track firmly into wall studs or use appropriate heavy-duty wall anchors. Ensure the track is perfectly level.
- Step 3: Attach Hangers to Doors.** Install the hangers (rollers) to the top edge of your barn doors. Ensure they are evenly spaced and securely fastened according to the door's design.
- Step 4: Hang the Doors.** Carefully lift and place the doors onto the track rollers. Adjust the stoppers

at both ends of the track to prevent doors from rolling off. Install the floor guides at the bottom of the doors to prevent them from swinging out from the wall.

The universal design is intended to fit standard door widths up to 48 inches per door.



Image: A fully installed JUBEST 16FT Box Rail Exterior Barn Door Hardware Kit on an exterior wall, featuring two barn doors in an open position.

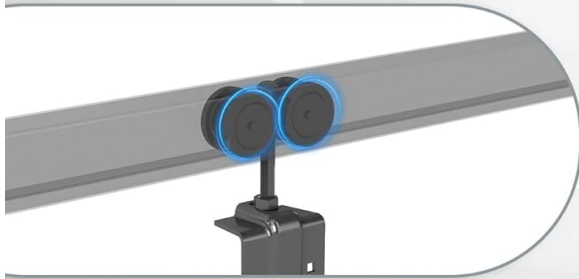

Image: A close-up view of the JUBEST barn door hardware, showing the rollers on the track and the door attachment mechanism, highlighting the smooth operation.

## 6. OPERATING INSTRUCTIONS

To operate your JUBEST barn doors, simply slide them along the track. The precision double-axis steel rollers are designed for whisper-quiet and frictionless operation.

# JUBEST HIGH-QUALITY HARDWARES



**Smooth Operation Hanger**  
For smooth-gliding, quiet operation, choose our flexible ball-bearing box rail hangers.

**Wall Mount Bracket**  
Galvanized steel brackets connect box rail tracks for smooth, flexible operation.



**Wall Mount Floor Guide**  
Prevent door shake when opening/closing. Installs securely on the wall—no floor holes needed.

Image: Detailed view of the smooth operation hanger with ball-bearing box rail hangers, wall mount bracket, and wall mount floor guide, illustrating their function.

- Ensure the path of the doors is clear of obstructions before sliding.
- Gently push or pull the door to open or close. Avoid excessive force.
- The stoppers are pre-set to prevent the door from exceeding its intended travel range.
- The wall-mounted floor guide prevents the door from swinging out from the wall, ensuring stable movement.

## 7. MAINTENANCE

Regular maintenance will ensure the longevity and smooth operation of your barn door hardware.

- **Cleaning:** Wipe down the track and rollers periodically with a damp cloth to remove dust, dirt, and debris. Avoid using abrasive cleaners or harsh chemicals that could damage the finish.
- **Lubrication:** Apply a silicone-based lubricant to the rollers and inside the track annually, or as needed, to maintain smooth gliding and quiet operation.
- **Inspection:** Periodically check all screws, bolts, and fasteners to ensure they are tight and secure. Re-tighten any loose components to prevent wear and ensure safety.
- **Weather Protection:** Although designed for outdoor use, regularly inspect the galvanized coating for

any signs of wear, scratches, or damage, especially in harsh weather conditions. Touch up any exposed metal areas with appropriate rust-inhibiting paint if necessary to prevent corrosion.

## 8. TROUBLESHOOTING

If you encounter any issues with your JUBEST barn door hardware, refer to the following common problems and solutions:

- **Door is difficult to slide:**
  - Check the track for any obstructions or debris. Clean if necessary.
  - Ensure the rollers are clean and adequately lubricated.
  - Verify the track is level and securely mounted to the wall. Uneven installation can cause friction.
  - Check if the floor guide is causing excessive friction; adjust its position if needed.
- **Door sways excessively:**
  - Ensure the floor guide is properly installed and adjusted to keep the door stable and prevent outward swing.
  - Check if the door hangers are securely fastened to the door panel.
- **Track holes do not align during assembly:**
  - This can sometimes occur due to manufacturing tolerances. Carefully align the track sections before tightening bolts.
  - A small round metal file or drill bit may be used to slightly enlarge or adjust misaligned holes for the bolts to pass through. Proceed with caution to avoid damaging the finish or structural integrity.
- **Noise during operation:**
  - Lubricate the rollers and track as described in the Maintenance section.
  - Check for any loose components that might be rattling and tighten them.

## 9. WARRANTY AND SUPPORT

JUBEST is committed to providing high-quality products and customer satisfaction. For any quality problems, missing parts, or installation issues, please do not hesitate to contact our professional customer service team. We are available to assist you with any concerns.

Please refer to your original purchase documentation or the JUBEST official website for specific warranty details and contact information.