

Pwxaxy HX160Q1

Pwxaxy Portable Charger Power Bank 40,800mAh with Built-in Cables (Model HX160Q1) - User Manual

Model: HX160Q1

INTRODUCTION

Thank you for choosing the Pwxaxy Portable Charger Power Bank 40,800mAh. This device is designed to provide reliable and fast charging for your electronic devices on the go. Featuring built-in cables and multiple output ports, it offers convenience and versatility. This manual provides essential information on how to set up, operate, maintain, and troubleshoot your power bank to ensure optimal performance and longevity.

PRODUCT OVERVIEW

Key Features:

- **40,800mAh High Capacity:** Provides multiple charges for smartphones, tablets, and other compatible devices.
- **Built-in Cables:** Includes integrated iOS (Lightning) and Type-C cables for direct device charging, eliminating the need to carry extra cables.
- **25W PD & QC 4.0 Fast Charging:** Supports Power Delivery (PD) and Quick Charge (QC 4.0) protocols for rapid charging of compatible devices.
- **Multiple Outputs:** Features 5 output options (2 built-in cables, 2 USB-A ports, 1 USB-C port) to charge up to 5 devices simultaneously.
- **Dual Inputs:** Recharge the power bank via the built-in USB-A cable or the USB-C port.
- **LED Digital Display:** Clearly shows the remaining battery percentage.
- **Advanced Safety Protection:** Equipped with an Intelligent Controlling IC to prevent overcharge, overvoltage, overcurrent, and short circuits.

Package Contents:

- 1 x Pwxaxy Portable Charger Power Bank (Model HX160Q1) with Built-in Cables
- 1 x Type-C Charging Cable (for recharging the power bank)
- 1 x User Manual



Figure 1: Pxwaxpy Portable Charger Power Bank showing its sleek design, built-in cables, and digital display.

SAFETY INFORMATION

Please read and follow these safety instructions carefully to prevent damage to the product or injury to yourself.

- Do not expose the power bank to extreme temperatures (hot or cold), direct sunlight, or fire.
- Do not immerse the power bank in water or other liquids.

- Avoid dropping, hitting, or disassembling the device.
- Keep out of reach of children.
- Use only certified chargers and cables for recharging the power bank.
- If the power bank swells, emits smoke, or shows any other abnormal behavior, discontinue use immediately.
- Do not attempt to modify or repair the device yourself. Contact customer support for assistance.
- This power bank contains a lithium polymer battery. Please dispose of it responsibly according to local regulations.

SETUP

Initial Charging of the Power Bank:

1. Upon first use, it is recommended to fully charge the power bank.
2. Connect the provided Type-C charging cable to the power bank's Type-C input port.
3. Plug the other end of the Type-C cable into a compatible USB wall adapter (not included).
4. Alternatively, you can use the built-in USB-A cable to recharge the power bank by plugging it into a USB wall adapter.
5. The LED digital display will show the charging progress, indicating 100% when fully charged.

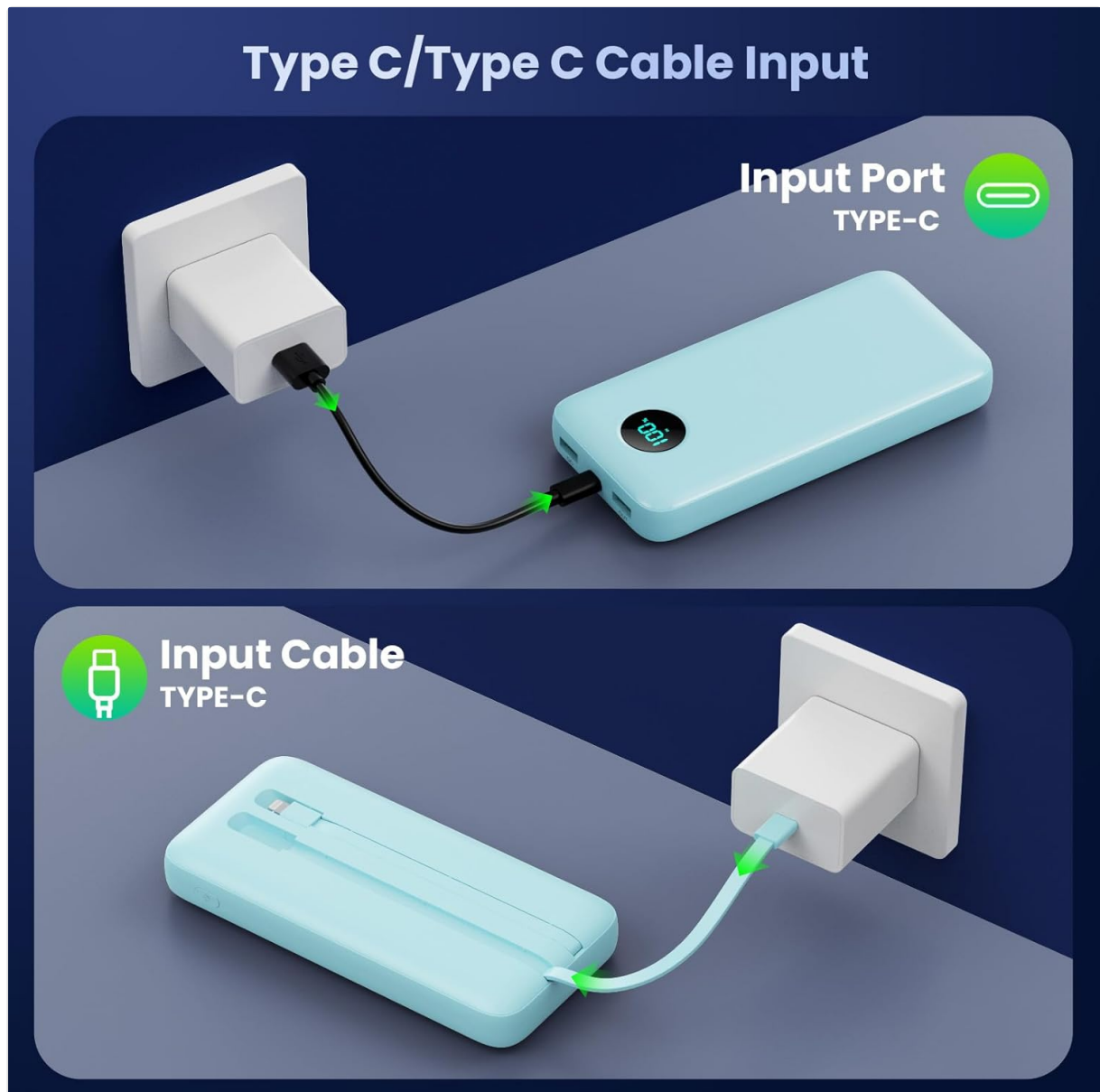

Figure 2: Recharging the Pwxapy Power Bank using its Type-C input port or the built-in Type-C cable.

OPERATING INSTRUCTIONS

Charging Your Devices:

The power bank offers multiple ways to charge your devices:

1. Using Built-in Cables:

- Locate the built-in iOS (Lightning) or Type-C cable.
- Pull out the appropriate cable and connect it directly to your compatible device.
- The power bank will automatically begin charging.

2. Using USB-A Ports:

- Connect your device's charging cable to one of the two USB-A output ports on the power bank.
- Connect the other end of your cable to your device.
- Charging will commence automatically.

3. Using USB-C Port (Output):

- Connect your device's USB-C charging cable to the power bank's USB-C port (which also functions as an output).
- Connect the other end to your USB-C compatible device.
- Fast charging (PD) will activate if your device supports it.

You can charge up to 5 devices simultaneously using a combination of the built-in cables and external ports.

Charging 5 Devices

Simultaneously Perfect for on the go!



For iOS/Android



Figure 3: The Pxwaxpy Power Bank simultaneously charging multiple devices, including smartphones, a tablet, earbuds, and a smartwatch.



Figure 4: Demonstrating the 25W high-speed charging capability of the power bank, significantly faster than standard charging.

LED DISPLAY INDICATORS

The integrated LED digital display provides real-time information about the power bank's battery status.

- **Percentage Display:** Shows the remaining battery capacity from 0-100%.
- **"IN" Indicator:** Appears when the power bank is being recharged.
- **"OUT" Indicator:** Appears when the power bank is charging an external device.

Monitor the display to know when to recharge the power bank or how much power is left for your devices.

MAINTENANCE

- **Cleaning:** Use a soft, dry cloth to clean the exterior of the power bank. Do not use harsh chemicals or abrasive materials. Regularly clean the tips of the built-in cables to ensure good contact and prevent oxidation.
- **Storage:** Store the power bank in a cool, dry place away from direct sunlight and extreme temperatures. For long-term storage, it is recommended to keep the power bank charged to approximately 50-75% to preserve battery health.

- **Battery Care:** To maximize battery lifespan, avoid fully discharging the power bank frequently. Recharge it when the battery level is low.

TROUBLESHOOTING

Problem	Possible Cause	Solution
Power bank not charging devices.	<ul style="list-style-type: none">• Power bank battery is depleted.• Cable connection is loose or faulty.• Device is incompatible or has a specific charging requirement.• Built-in USB-A cable is for input only.	<ul style="list-style-type: none">• Recharge the power bank fully.• Ensure cables are securely connected. Try a different cable or port.• Verify device compatibility.• Use the built-in iOS or Type-C cable, or the USB-A/USB-C output ports for charging devices.
Power bank not recharging.	<ul style="list-style-type: none">• Charging cable or adapter is faulty.• Port is dirty or damaged.	<ul style="list-style-type: none">• Try a different Type-C charging cable and wall adapter.• Gently clean the charging ports with a dry, soft brush.
Slow charging of devices.	<ul style="list-style-type: none">• Device does not support fast charging protocols (PD/QC).• Multiple devices are charging simultaneously, distributing power.• Cable quality.	<ul style="list-style-type: none">• Ensure your device and cable support PD or QC 4.0 for optimal speed.• Charging fewer devices at once may increase speed for individual devices.• Use high-quality cables.
LED display is not working.	<ul style="list-style-type: none">• Power bank is completely discharged.• Internal malfunction.	<ul style="list-style-type: none">• Attempt to recharge the power bank.• If the issue persists, contact customer support.

SPECIFICATIONS

Feature	Detail
Model Number	HX160Q1
Battery Capacity	40,800mAh
Battery Type	Lithium Polymer
Input (USB-C)	25W Max (PD)
Output (USB-C)	25W Max (PD)
Output (USB-A Ports)	QC 4.0 compatible

Feature	Detail
Output (Built-in iOS Cable)	Standard Charging
Output (Built-in Type-C Cable)	PD Fast Charging
Product Dimensions	15 x 1.5 x 7.5 inches
Item Weight	1.15 pounds
Special Features	LCD Indicator, Fast Charging, Over Discharge Protection, Short Circuit Protection, Overcurrent Protection, Overvoltage Protection



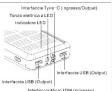
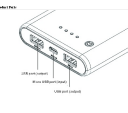
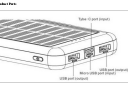

Figure 5: Internal intelligent controlling IC and multiple safety protections for the Pwxapxy Power Bank.

WARRANTY AND SUPPORT

Your Pwxapxy Portable Charger Power Bank comes with lifetime technical support. For any questions, concerns, or technical assistance, please refer to the contact information provided in your product packaging or visit the

official Pwxaxy website.
Please retain your purchase receipt for any warranty claims.

Related Documents - HX160Q1

<div><p>CARICABATTERIA INSTRUZIONI</p><p>Leggere attentamente le istruzioni prima di utilizzare il prodotto.</p><p>Nota:</p><p>Caricamento:</p><p>Il prodotto può essere utilizzato per caricare i dispositivi elettronici. Per caricare i dispositivi, collegare il cavo USB al prodotto e al dispositivo da caricare. Il prodotto supporta la ricarica rapida USB (2.4A).</p><p>Caricamento solare:</p><p>Il prodotto può essere utilizzato per caricare i dispositivi elettronici. Per caricare i dispositivi, collegare il cavo USB al prodotto e al dispositivo da caricare. Il prodotto supporta la ricarica rapida USB (2.4A).</p><p>Caricamento a rete:</p><p>Il prodotto può essere utilizzato per caricare i dispositivi elettronici. Per caricare i dispositivi, collegare il cavo USB al prodotto e al dispositivo da caricare. Il prodotto supporta la ricarica rapida USB (2.4A).</p></div>	<p>Pwxaxy HX200J2 Portable Power Bank User Manual</p> <p>User guide for the Pwxaxy HX200J2 portable power bank, covering features, specifications, charging methods (USB and solar), LED indicators, flashlight function, and safety warnings.</p>
<div><p>Operation Instruction for Portable Power Source</p><p>Please read the operation instruction carefully before using the product.</p><p>Product Overview:</p><p>Product Features:</p><p>The product is a portable power source that can be used to charge electronic devices. It features a built-in battery, a USB port, and a solar panel. The product is designed to be lightweight and easy to carry.</p><p>Operation Instructions:</p><p>1. Connect the USB cable to the product and the device to be charged.</p><p>2. Press the power button to start charging.</p><p>3. The product will automatically stop charging when the device is fully charged.</p><p>Safety Precautions:</p><p>1. Do not use the product in wet or rainy conditions.</p><p>2. Do not use the product near fire or other heat sources.</p><p>3. Do not use the product for purposes other than charging electronic devices.</p></div>	<p>Operation Instruction: Pwxaxy HX160Y1 Portable Power Source</p> <p>Detailed operation instructions and specifications for the Pwxaxy HX160Y1 portable power source (power bank), including charging, discharging, safety features, and warnings.</p>
<div><p>Operation Instruction for Portable Power Source</p><p>Please read the operation instruction carefully before using the product.</p><p>Product Overview:</p><p>Product Features:</p><p>The product is a portable power source that can be used to charge electronic devices. It features a built-in battery, a USB port, and a solar panel. The product is designed to be lightweight and easy to carry.</p><p>Operation Instructions:</p><p>1. Connect the USB cable to the product and the device to be charged.</p><p>2. Press the power button to start charging.</p><p>3. The product will automatically stop charging when the device is fully charged.</p><p>Safety Precautions:</p><p>1. Do not use the product in wet or rainy conditions.</p><p>2. Do not use the product near fire or other heat sources.</p><p>3. Do not use the product for purposes other than charging electronic devices.</p></div>	<p>Portable Power Source Operation Instructions</p> <p>Comprehensive operation instructions for a portable power source, detailing product features, charging methods (USB and solar), power indicator functions, and important safety notices and warnings.</p>
<div><p>USING MANUAL</p><p>USING MANUAL:</p></div>	<p>HX160Q1-M Portable Power Bank User Manual</p> <p>User manual for the HX160Q1-M portable power bank, detailing its features, specifications, charging instructions, and safety guidelines. Features 40800mAh capacity, PD/QC fast charging, and built-in cables.</p>