

SUNPOW NX-GD02

SUNPOW Pinpointer Metal Detector NX-GD02 User Manual

Model: NX-GD02

1. INTRODUCTION

The SUNPOW Pinpointer Metal Detector NX-GD02 is a versatile and robust tool designed for efficient metal detection. Featuring advanced technology, a rechargeable battery, and a durable waterproof design, it is suitable for both adults and children engaging in activities such as archaeology, exploration, and construction. This manual provides detailed instructions for the proper use, maintenance, and troubleshooting of your device.

2. PRODUCT OVERVIEW AND FEATURES

The NX-GD02 Pinpointer is engineered for precision and durability, offering a seamless metal detection experience. Key features include:

- **Rechargeable Li-ion Battery:** Equipped with an 800mAh lithium-ion polymer battery, providing an extra-long runtime of 12 to 15 hours on a single charge. This ensures extended use for uninterrupted treasure hunting.
- **One-Click Operation & 360° Omnidirectional Detection:** Easily powered on with a single click, the device offers a 360° side-scan capability. It can detect all types of metals, including gold, platinum, nickel, copper, and iron, and is effective up to a depth of 10 inches (25 cm) underwater.
- **IP68 Waterproof Design & High-Strength Materials:** The body is constructed from an excellent blend of PP (polypropylene) and glass fibers, ensuring exceptional durability. This unique material combination allows the product to effectively withstand impacts, friction, and scratches during daily use, maintaining its appearance and stable performance long-term.
- **Three Feedback Modes:** Offers three distinct feedback modes: audio, vibration, and audio + vibration. Users can customize their detection experience based on the environment and personal preference, ensuring no target is missed.
- **Simple One-Button Control:** The intuitive single-button design simplifies powering on/off and switching between detection modes, ensuring straightforward and stress-free operation.
- **Integrated LED Light:** Provides illumination for low-light conditions or dark search areas.
- **Precise Scale Display:** Features a visual scale to indicate proximity to the detected object.



Figure 2.1: The SUNPOW Pinpointer Metal Detector NX-GD02, shown with its included lanyard, holster, and USB charging cable.

8:00 AM

800 mAh

Batterie au Lithium

11:00 PM

15 HEURES D'UTILISATION AVEC UNE SEULE CHARGE

Batterie au Lithium Rechargeable – Une Charge est Équivalente à 2 x Piles de 9V, Une Utilisation Plus Longue, Plus Respectueuse de l'Environnement

Figure 2.2: Illustration of the pinpointer's extended battery life, demonstrating use from morning to night. The device offers 15 hours of continuous operation on a single charge.



Figure 2.3: The pinpointer demonstrating its precise detection capability up to 15cm (approximately 6 inches) depth, highlighting its improved chip technology for faster and more accurate target identification.



Figure 2.4: Detailed view of the pinpointer's features, including its 360° detection capability, simple one-click power button, integrated LED light for visibility, and the precise scale display indicating signal strength.



CONÇU POUR L'EXTÉRIEUR

Résistant dans Toute Condition, Fabriqué avec des Matériaux de Haute Résistance – Fonctionne de -10°C à 40°C

Figure 2.5: The pinpointer in an outdoor setting, emphasizing its robust construction designed to withstand various environmental conditions and impacts, functioning reliably between -10°C and 40°C .



Figure 2.6: The pinpointer partially submerged in water, demonstrating its IP68 waterproof rating, which allows for precise detection up to 3 meters (10 feet) underwater.

3. SETUP

3.1 Charging the Battery

Before first use, fully charge the pinpointer's internal lithium-ion battery. Use the provided USB charging cable and connect it to a standard USB power adapter (not included) or a computer USB port.

1. Locate the charging port cover on the device.
2. Carefully open the cover to expose the USB charging port.
3. Insert the small end of the USB cable into the pinpointer's charging port.
4. Connect the larger end of the USB cable to a power source.
5. The charging indicator (if present, refer to device display) will show charging status. Once fully charged, disconnect the cable and securely close the charging port cover to maintain IP68 waterproofing.

3.2 Attaching Accessories

The pinpointer comes with a lanyard and a holster for convenient carrying and use.

- **Lanyard:** Attach the lanyard to the designated loop on the pinpointer to prevent accidental drops, especially when working near water or in dense terrain.
- **Holster:** Slide the pinpointer into the provided holster. The holster can be attached to a belt or backpack strap for easy access during detection activities.

4. OPERATING INSTRUCTIONS

4.1 Powering On/Off

The NX-GD02 features a simple one-button control for power and mode selection.

- **To Power On:** Press the power button once. The device will activate, and the LED light may illuminate.
- **To Power Off:** Press and hold the power button for a few seconds until the device powers down.

4.2 Selecting Detection Modes

The pinpointer offers three feedback modes to suit different environments and preferences:

- **Audio Mode:** Ideal for quiet environments like parks and lawns, providing clear and precise audio feedback.
- **Vibration Mode:** Suitable for nighttime or underground detection, offering low noise and vibration feedback to avoid disturbing others.
- **Audio + Vibration Mode:** Combines both audio and vibration feedback, useful for noisy environments or when maximum feedback is desired.

To switch between modes, briefly press the power button while the device is on. Each press will cycle through the available modes.



Figure 4.1: The pinpointer operating in Audio Mode, suitable for quiet environments.



Figure 4.2: The pinpointer operating in Vibration Mode, ideal for discreet detection.



Figure 4.3: The pinpointer operating in Audio + Vibration Mode, providing comprehensive feedback.

4.3 Detection Technique

The pinpointer is designed for precise target location after a larger metal detector has identified a general area.

- **Scanning:** Hold the pinpointer with the tip pointed towards the ground or area of interest. Move it slowly over the surface. The 360° detection field allows for scanning from all sides.
- **Pinpointing:** Once a signal is detected, narrow down the search area by moving the pinpointer in a cross-hatch pattern. The signal strength (indicated by audio pitch, vibration intensity, and the visual scale on the device) will increase as you get closer to the target.
- **Depth Indication:** The visual scale on the device provides an approximate indication of the target's depth or proximity.
- **Using the LED Light:** If working in dark or confined spaces, press the power button briefly (if it's a separate function, or cycle through modes until light activates) to turn on the integrated LED light for better visibility.

DÉCOUVRIR DES TRÉSORS CACHÉS DANS LA VIE DE TOUS LES JOURS



À la recherche
de métaux précieux perdus



Chercher des
clous dans le bois



Chercher une
bague dans les mauvaises herbes

Figure 4.4: Examples of common uses for the pinpointer, including searching for lost precious metals, finding nails in wood, and locating rings in grass.

5. MAINTENANCE

Proper maintenance ensures the longevity and optimal performance of your SUNPOW Pinpointer.

- **Cleaning:** After each use, especially in dirty or wet conditions, wipe down the device with a damp cloth. For stubborn dirt, a mild soap solution can be used. Ensure the charging port cover is securely closed before cleaning with water. Do not use abrasive cleaners or solvents.
- **Battery Care:**
 - Avoid completely draining the battery before recharging.
 - If storing the device for an extended period, charge the battery to approximately 50% and recharge every 3-6 months to prevent deep discharge.
 - Use only the provided charging cable or a compatible USB cable.
- **Storage:** Store the pinpointer in a cool, dry place away from direct sunlight and extreme temperatures. Keep it in its holster or a protective case when not in use to prevent scratches and damage.
- **Waterproof Seal:** Regularly inspect the charging port cover and any other seals for signs of wear or damage. Ensure they are clean and properly seated before submerging the device in water.

6. TROUBLESHOOTING

If you encounter issues with your SUNPOW Pinpointer, refer to the following common problems and solutions:

Problem	Possible Cause	Solution
Device does not power on.	Battery is drained.	Charge the battery fully using the provided USB cable.
No detection or weak signal.	Incorrect mode selected; target too deep; interference.	Ensure correct mode (Audio, Vibration, or both) is selected. Move closer to the target. Move away from large metal objects or strong electromagnetic fields.
Audio feedback is too low.	Environmental noise; user preference.	Switch to Vibration or Audio + Vibration mode for additional feedback. Use in quieter environments if possible.

Problem	Possible Cause	Solution
Button triggers too easily / Device turns on accidentally.	Sensitive button design.	Be mindful of how the device is handled and stored. Use the holster to protect the button when not in active use.
Water leakage (if submerged).	Charging port cover not sealed properly; damaged seal.	Ensure the charging port cover is completely and securely closed before submerging. Inspect seals for any damage. If damaged, discontinue use in water.

If the problem persists after trying these solutions, please contact SUNPOW customer support for further assistance.

7. SPECIFICATIONS

Feature	Detail
Model Number	NX-GD02
Dimensions (L x W x H)	25.4 x 4.2 x 4.2 cm (10 x 1.65 x 1.65 inches)
Weight	300 Grams (0.66 lbs)
Battery Type	800mAh Rechargeable Lithium Metal (included)
Battery Life	12-15 hours (typical)
Waterproof Rating	IP68 (up to 3 meters / 10 feet underwater)
Material	PP (Polypropylene) and Glass Fiber blend
Power Source	Electric Cable (USB charging)
Detection Modes	Audio, Vibration, Audio + Vibration
Detection Depth	Up to 10 inches (25 cm)
Display Type	LED (for signal strength and light)
Recommended Uses	Archaeology, Exploration, Construction
Operating Temperature	-10°C to 40°C

8. WARRANTY AND SUPPORT

Information regarding specific warranty terms for the SUNPOW Pinpointer Metal Detector NX-GD02 is not provided in this manual. For warranty details, product support, or any inquiries not covered in this guide, please contact SUNPOW customer service directly through their official website or the retailer from whom you purchased the product. Always refer to the latest information provided by the manufacturer for the most accurate and up-to-date support.

SUNPOW OT-MD01 Metal Detector User Manual and Specifications



-US-

FEATURES

- **LCD Display:** Shows the probe type of metal, the depth of the target, range of DISC, NOTCH, the level of SENS VOLUME and battery condition. It also has digital display for target ID.
- **Backlight:** For better use in dark areas.
- **Five Control Buttons:**
 - 1. **UP/RESET:** Turns on or off the power.
 - 2. **MENU:** Press it to select desired operation mode and the setting of SENS and VOLUME.
 - 3. **INCREASE (+):** Increases the level of sensitivity or volume and the range of DISC (discriminate) or NOTCH.
 - 4. **DECREASE (-):** Decreases the level of sensitivity or volume and the range of discrimination or NOTCH.
 - 5. **UP/NOTCH:** Presets the level of the target accurately.
- **Three Tone Audio Discrimination:** Launch three distinctive tones (high, medium and low) for different types of metal.
- **Headphone Jack:** Lets you connect headphones of 3.5mm and operate without noise.
- **10 Inch Waterproof Search coil:** Lets you use the detector even in your hand and under shallow water.
- **Adjustable Shaft:** Lets you adjust the length of shaft for comfortable use.



-01-

EASY ASSEMBLY

Assembling your metal detector is easy and requires no special tools. Just follow these steps:

1. Fit the washers into the groove of the lower stem. Then using the supplied bolt and lock, attach the search coil to the lower stem.



2. Press the button on the upper end of the lower stem and slide the lower stem into the middle stem. Then tighten the lock nut on the middle stem.



-02-

3. Press the button on the middle stem and slide the middle stem into the S stem. Then tighten the lock nut on the S stem.



4. Press the button on the top stem, and slide the top stem into the S stem. Adjust the stem to a length that lets you maintain a comfortable upright position, with your arm relaxed at your side.

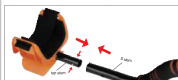

-03-

5. Fix the control box on the S stem and tighten the fixing screw properly.



6. Wind the search coil cable around the stem. Insert the cable plug into the jack at the back of the control box.

- Caution:**
 - Do not over-tighten the search coil or use tools to tighten it.
 - Do not force the plug in. Excess force will cause damage.
 - To disconnect the cable, pull out the plug. Do not pull on the cable.

-04-

INSTALLING THE BATTERIES

IMPORTANT:

- Always use ALKALINE batteries for optimal performance.
- Always remove the batteries for prolonged storage.
- **DO NOT use carbon batteries.**
- **DO NOT MIX OLD AND NEW BATTERIES.**
- **CHECK THE BATTERIES** if your detector exhibits any of the following symptoms:

1. The unit does not turn on.
 2. Low speaker volume.
 3. Unit beeps continuously at low sensitivity setting.
- Follow these steps to install the batteries:
1. Turn off battery replacing the batteries.
 2. Take off the battery cover.
 3. Place two (2) alkaline batteries into the battery compartment matching the polarity symbols (+ and -) marked inside.

Warning: Observe of old batteries properly. Never bury or burn them.

USING HEADPHONES

1. Fit earbuds to connect the headphones with volume control.
2. Insert the headphones' 3.5mm plug into the headphone jack at the bottom of the control box. At this time the internal speaker disconnects.

-05-

LAYOUT OF THE CONTROL PANEL

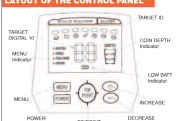

LCD DISPLAY



-06-

1. Target ID Indications

Target ID	IRON	STEEL	COIN	REVERSE	REVERSE
Target	1-10	11-15	16-20	21-25	26-30
Area	1-10	11-15	16-20	21-25	26-30
Area	1-10	11-15	16-20	21-25	26-30

2. SENS (Sensitivity) Adjust the sensitivity from 1 to 10. The higher the number, the more sensitive the detector. This sensitivity control does not affect Pinpoint sensitivity.

If the detector beeps erratically or beeps when there are no metal objects being detected, reduce the sensitivity.

Note: Call phones, cell phones, etc. ... generate interference signals and will cause the detector to "beep" when "no" metal is present.

3. VOLUME: Adjust the volume level from 1 to 10.

4. DISC (Discrimination) is an important feature of professional metal detectors. Discrimination is the ability to reject unwanted targets.

The DISC control is Discrimination function of the detector. In its default setting, all metals are detected. Use the DISC control in order to eliminate unwanted types of metals from detection. You only need to eliminate the targets in order. Each time you press "+" button, a

-07-

target will disappear. The target disappears means the category is eliminated from detection. To pick up the eliminated target category, press "+" and category will be accepted back in order.

Note: The two targets on the right cannot be eliminated. These two targets represent silver or other high value targets, which are generally desirable. So, the detector does not allow them to be discriminated out.

5. NOTCH: It is similar to Discrimination (DISC). It allows you not to turn in accept or reject different types of metals. The DISC can only accept or reject metals in order.

The NOTCH menu is only available in PIN, or ALK, and 10 Press four categories.

Press "C" or "N" to a new category. The target ID will flash for 3 seconds and then it will change to the opposite state. Or press MENU while the target ID is flashing and then it will change to the opposite state. If the target had been eliminated previously and disappears now, indicates that the target has been eliminated from detection. As same, the target disappeared before, and disappears now indicates that target is rejected in or can be detected.

-08-

SUNPOW GC-1083 Metal Detector Owner's Manual

Owner's manual for the SUNPOW GC-1083 Metal Detector, covering features, assembly, battery installation, control box layout, LCD display, control buttons, testing, outdoor detecting, pinpointing, troubleshooting, and maintenance.

1. 2000-10-26-11



1. Supplies Needed:

- 09-

① Place the detector on a table with the search coil hanging over the edge.

-

Wave all objects over the search coil and notice the difference.

- 5. Using NOTCH Feature:**
- ① Press MENU until NOTCH is displayed on LCD.
 - ② Press "+" twice. 5c will flash for 3 seconds and disappear that means 5c is "nooch out" (eliminated). To eliminate 1c,

-10-

- If you want to pick up the target type you eliminated before, press "+" or "-" to the target, and then wait for the target to

① Press and hold "PINPOINT" button, PP will appear on LCD display.

- ### 7.Adjusting SENS(Sensitivity)

1 to 10, _____

- OVERLOAD WARNING**

-11-

- Note:** There is a wide variety of metals and no target can be

1. Find a place outside where there is no metal.

- 1-2 inches above the ground as you search.



- Raising it during the sweep, or at the ends of your sweep, can cause

- 12-

- more often

After you find a format, you can use **PPtPinpoint** to find the exact

- Narrow the Detection Range:**
1. To narrow the response further, position the search coil near the

3. When you hear the sound, you can release the PP.

Problem	Reason	Solution
---------	--------	----------

-14-

Care and Maintenance

for years.

Keep the deflector away from dust and dirt, which can cause premature wear of parts.



[SUNPOW OT-MD02 Metal Detector User Manual](#)

Comprehensive user manual for the SUNPOW OT-MD02 metal detector, detailing its features, operation, specifications, and troubleshooting tips for hobbyists and enthusiasts.



[SUNPOW HP1172 Electric Pressure Washer User Manual](#)

This user manual provides comprehensive instructions for the SUNPOW HP1172 Electric Pressure Washer, detailing safety precautions, product features, assembly, operation, maintenance, and troubleshooting for optimal use.

