

## CPZZ 36V 7.5Ah Battery for Hiboy S2/KS4

# CPZZ 36V 7.5Ah Rechargeable Battery User Manual

Model: 36V 7.5Ah Battery for Hiboy S2/KS4 Electric Scooter

Brand: CPZZ

## 1. INTRODUCTION

This manual provides essential information for the safe and effective use of your CPZZ 36V 7.5Ah rechargeable battery. This battery is designed as a replacement for Hiboy S2/KS4 electric scooters and other electric scooters with compatible specifications. Please read this manual thoroughly before installation and use to ensure proper function and longevity of your battery.

## 2. PRODUCT OVERVIEW

The CPZZ 36V 7.5Ah battery is a high-capacity rechargeable lithium-ion battery pack featuring screw holes at the bottom and top for secure installation. It is engineered for good safety performance and strong power delivery, ensuring extended operation for your electric scooter.

### 2.1 Key Features

- **Voltage:** 36V DC
- **Capacity:** 7.5Ah (7500mAh)
- **Energy:** 270Wh
- **Compatibility:** Specifically designed for Hiboy S2/KS4 Electric Scooters and other electric scooters with identical battery specifications. **Not compatible with Hiboy S2 PRO/KS4 PRO Scooter battery.**
- **Connectors:** Equipped with SM (male) and XT60 (female) connectors.
- **Multiple Protections:** Includes overcurrent, overvoltage, overdischarge, overcharge, short circuit, temperature, and anti-reverse charging protection for enhanced safety and stability.

### 2.2 Dimensions and Weight

- **Size:** 312.5mm x 66mm x 40mm (approximately 12.3 x 2.59 x 1.57 inches)
- **Weight:** 1.5 kg (1500g)

**Important:** Before purchasing or installing, please confirm that the dimensions and specifications of your original

scooter battery match this replacement battery to ensure proper fit and function.

# Battery Size & Plugs

Please make sure that this replacement battery matches the size, voltage, plugs, model and specifications of your original battery before purchase



Figure 2.2.1: Battery dimensions and connector types.

# Product Parameters

Power: 270Wh

Size: 12.3\*2.59\*1.57In

Voltage: 36V DC

Capacity: 7.5Ah

Weight: 1500g



Figure 2.2.2: General view of the CPZZ 36V 7.5Ah battery.

## 3. SAFETY INFORMATION

Your CPZZ battery is equipped with multiple protection features to ensure safe operation. However, it is crucial to follow general battery safety guidelines:

- Do not disassemble, puncture, or modify the battery pack.
- Avoid exposing the battery to extreme temperatures, direct sunlight, or fire.
- Do not immerse the battery in water or other liquids.
- Use only the specified charger for this battery.
- Keep the battery away from children and pets.
- If the battery shows signs of damage, swelling, or leakage, discontinue use immediately and contact support.



Figure 3.1: Built-in intelligent protection features.

## 4. INSTALLATION

Follow these steps to replace your electric scooter battery. Ensure the scooter is powered off and disconnected from any charging source before beginning.

1. **Access the Battery Compartment:** Use the appropriate tools to open the bottom cover of your scooter to access the battery compartment.
2. **Disconnect Old Battery:** Carefully disconnect the old battery from the scooter's wiring. Note the orientation of the red and black wires for the SM connector.
3. **Remove Old Battery:** Gently remove the old battery.
4. **Install New Battery:** Place the new CPZZ 36V 7.5Ah battery into the compartment, aligning the screw holes at the bottom and top with the scooter's mounting points.
5. **Connect New Battery:** Connect the new battery to the scooter's wiring. Ensure the red and black wires are correctly aligned. If the SM connector's polarity does not match your scooter's original wiring, you may need to adjust it.

### 4.1 SM Connector Polarity Adjustment

Due to manufacturing variations, the wiring positive and negative terminal positions on the SM connector may

differ. If the red wire on your new battery corresponds to the black wire on your scooter's wiring, and vice-versa, you must manually switch the wire positions on the battery's SM connector.

## Helpful Tip

About the **SM2p connector**, due to different manufacturing batches, the wiring positive and negative terminal positions will be different.

Before installing the replacement battery, please make sure to compare the original battery of the scooter, and figure out the arrangement order of the red and black wire terminals, so as to avoid damage to both the scooter and the battery due to incorrect polarity connections.

### SM2p Connector

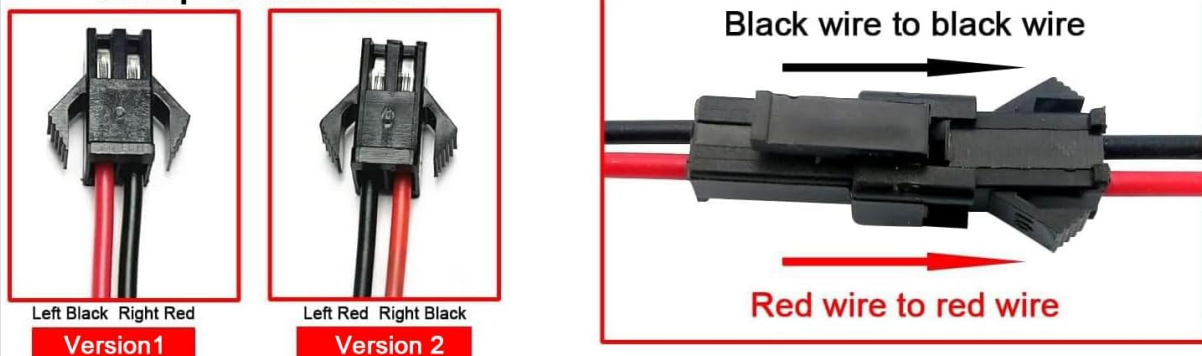

If the arrangement of the red and black wire is not consistent with the original battery, you can try to manually switch the wiring. The steps are as follows:

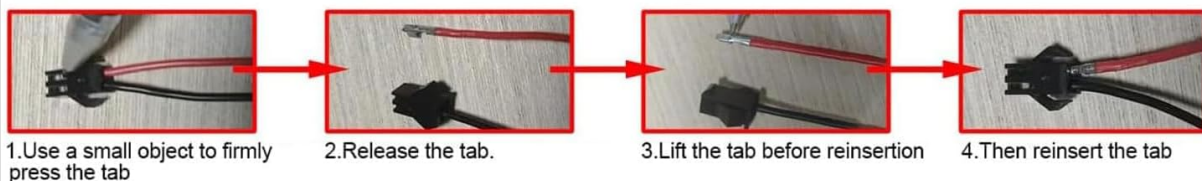

Alternatively, you can use an adapter to directly convert the wiring so that it matches and corresponds correctly.

Figure 4.1.1: Helpful tip for SM2p connector wiring adjustment.

### Steps to switch wiring:

1. Use a small, sturdy, preferably insulated tool (like a precision screwdriver) to gently press down on the metal spring tab of the wire you wish to remove from the SM male connector.
2. Carefully pull the wire out of the connector.
3. Repeat for the other wire.
4. Swap the positions of the red and black wires.
5. Lift the metal spring upward slightly on each wire terminal before reinserting them into the connector in the correct, swapped order.
6. Ensure the wires are securely seated.

Alternatively, you can use an adapter to directly convert the wiring to match your scooter's polarity.

Your browser does not support the video tag.

Video 4.1.2: Tutorial on how to replace SM adapter '+' and '-' wiring.

6. **Secure Cover:** Once the battery is connected and secure, reattach the bottom cover of the scooter.

## 5. CHARGING

To ensure optimal performance and battery life, follow these charging instructions:

- **First Use:** Please fully charge the battery before its first use. This helps to condition the battery for better long-term performance.
- **Charger:** Use a compatible 42V/2A charger.
- **Charging Time:** A full charge typically takes 3-4 hours.
- **Charging Environment:** Charge the battery in a well-ventilated area, away from flammable materials.
- **Monitoring:** Do not leave the battery unattended while charging for extended periods.

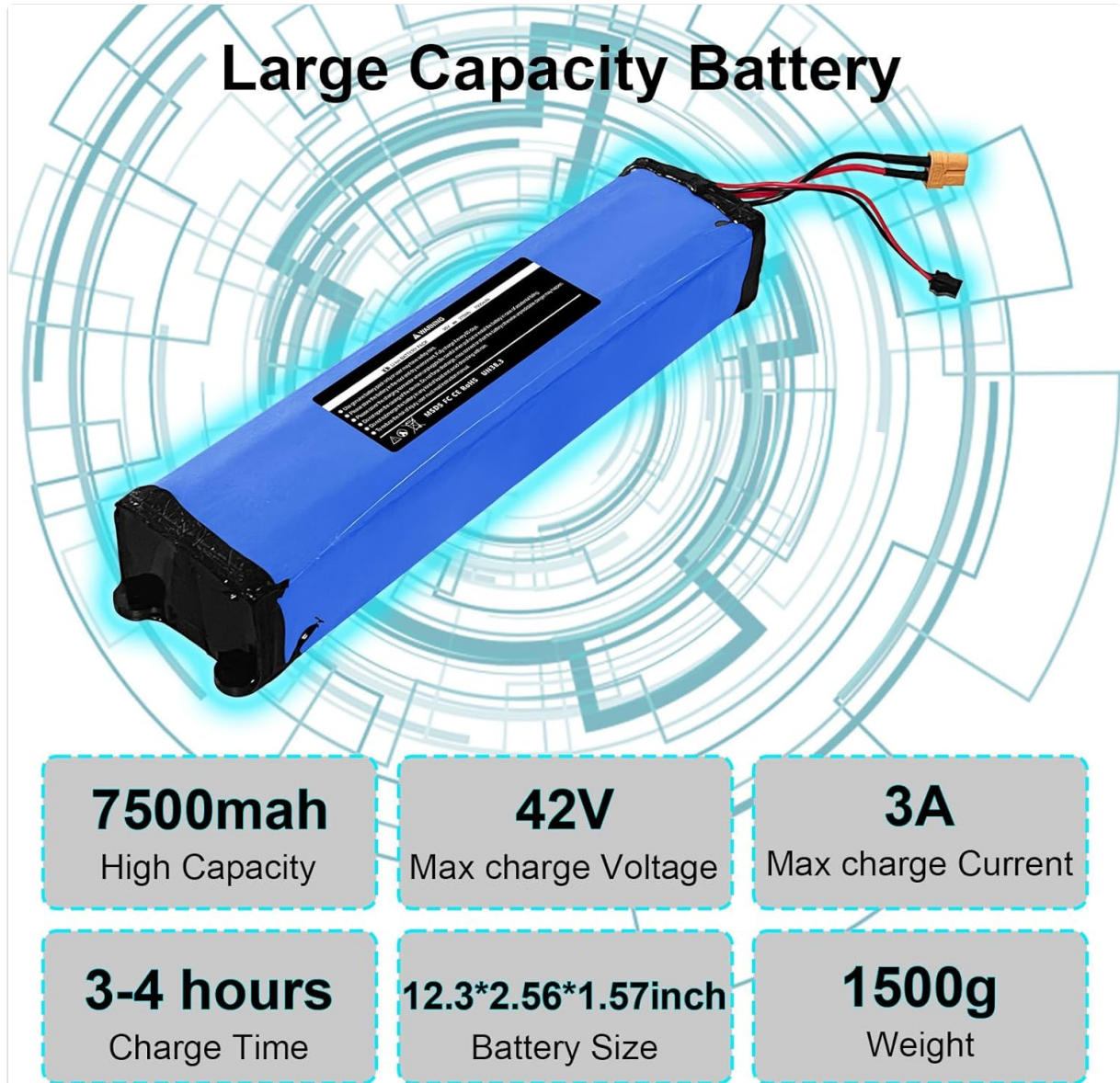

Figure 5.1: Detailed battery specifications including charging parameters.

## 6. OPERATION

Once installed and fully charged, the battery is ready for use with your electric scooter. Operate your scooter according to its manufacturer's instructions. The battery provides stable power output for consistent performance.

Your browser does not support the video tag.

Video 6.1: Overview of the 36V 7.5Ah Scooter Battery for Hiboy Electric Scooter.

## 7. MAINTENANCE

Proper maintenance extends the life of your battery:

- **Storage:** If storing the battery for an extended period, ensure it is charged to approximately 50-60% capacity. Store in a cool, dry place.
- **Regular Charging:** Avoid completely draining the battery frequently. Recharge it after each use or when the charge level is low.
- **Cleaning:** Keep the battery and its connectors clean and free from dust and debris. Use a dry cloth for cleaning.
- **Inspection:** Periodically inspect the battery for any physical damage or unusual signs.

## 8. TROUBLESHOOTING

If you encounter issues with your battery, consider the following:

- **Battery Not Charging:** Ensure the charger is correctly connected to both the battery and a power outlet. Verify the charger is functional. Check for any damage to the charging port or cable.
- **Scooter Not Powering On:** Confirm the battery is securely installed and all connectors are properly aligned. Check the SM connector polarity as described in the installation section.
- **Reduced Range/Performance:** This could indicate an aging battery (life cycle >85% capacity after 1500 cycles) or improper charging habits. Ensure the battery is fully charged before use.
- **Unusual Odor or Heat:** Immediately disconnect the battery and cease use. Contact customer support.

For persistent issues or concerns not addressed here, please contact CPZZ customer support.

## 9. SPECIFICATIONS

Parameter	Value
Brand	CPZZ
Model	36V 7.5Ah Battery for Hiboy S2/KS4
Voltage	36V DC
Capacity	7.5Ah (7500mAh)
Energy	270Wh
Max Charge Voltage	42V
Max Charge Current	3A
Charging Time	3-4 hours
Dimensions (L x W x H)	312.5 x 66 x 40 mm (12.3 x 2.59 x 1.57 inches)
Weight	1.5 kg (1500g)
Connectors	SM (male), XT60 (female)
Operating Temperature Range	-10°C to 45°C
Life Cycle	>85% capacity after 1500 cycles

Protections	Overcurrent, Overvoltage, Overdischarge, Overcharge, Short circuit, Temperature, Anti-reverse charging
-------------	--

## 10. WARRANTY AND SUPPORT

---

Every CPZZ product undergoes inspection before shipping to ensure quality. If you encounter any problems during the purchase process, installation, or use, please do not hesitate to contact us. Our customer support team is available to assist you with any questions or concerns.

For further assistance, please visit the [CPZZ Store on Amazon](#).