

## Manuals+

[Q & A](#) | [Deep Search](#) | [Upload](#)

Manuals.plus /

› [Mericonia](#) /

› Mericonia Farmhouse Buffet Sideboard Cabinet FL-D-01 User Manual

## Mericonia FL-D-01

# Mericonia Farmhouse Buffet Sideboard Cabinet FL-D-01 User Manual

Model: FL-D-01 | Brand: Mericonia

### IMPORTANT SAFETY INSTRUCTIONS

To ensure safe use of your Mericonia Farmhouse Buffet Sideboard Cabinet, please adhere to the following guidelines:

- **Anti-Tipping Device:** Always secure the cabinet to the wall using the provided wall connection fixture. This prevents accidental tipping, which can cause serious injury, especially to children or pets.
- **Assembly:** Read all assembly instructions carefully before beginning. Ensure all parts are present and undamaged.
- **Weight Distribution:** Distribute weight evenly across shelves. Avoid placing excessively heavy items on the top surface or on a single shelf.
- **Placement:** Place the cabinet on a flat, stable surface. Avoid placing it in areas with high humidity or direct sunlight to prevent material damage.

# Ample storage space



Image: Close-up view of the anti-tipping device installed on the back of the cabinet, ready to be secured to a wall.

## PRODUCT OVERVIEW

The Mericonia Farmhouse Buffet Sideboard Cabinet (Model FL-D-01) is a versatile storage solution designed to complement various home decors. Featuring a natural wood finish and distinctive fluted doors, it offers both aesthetic appeal and practical functionality for your kitchen, living room, or entryway.



Image: Front view of the assembled Mericonia Farmhouse Buffet Sideboard Cabinet in a natural wood finish, showcasing its fluted doors and open top shelves, styled in a home environment.

### Key Features

- **Ample Storage:** Equipped with two open shelves, four fluted doors, and adjustable interior shelves to accommodate items of various sizes.
- **Spacious Countertop:** The large top surface provides space for appliances like coffee makers, microwaves, or decorative items.
- **Elegant Design:** Features fluted door panels and a rebound door stopper mechanism for a modern farmhouse aesthetic.
- **Enhanced Stability:** Includes a wall connection fixture for added safety and stability.
- **Versatile Use:** Ideal for use as a buffet cabinet, coffee bar, entryway console, or living room storage.

### PRODUCT SPECIFICATIONS

Specification	Detail
Brand	Mericonia
Model Name	FL-D-01
Color	Natural
Product Dimensions (L x W x H)	46.5 inches x 14.8 inches x 31.5 inches
Item Weight	20 Pounds
Material	Engineered Wood
Number of Shelves	2 (Adjustable)
Special Features	Adjustable Shelf, Anti-Tipping, Removable Shelf
Mounting Type	Floor Mount
Assembly Required	Yes

# Product Dimensions



Adjustable height



Image: Diagram illustrating the overall product dimensions (46.4"W x 14.7"D x 31.5"H) and internal shelf dimensions, highlighting the adjustable height feature.

## SETUP AND ASSEMBLY

This cabinet requires assembly. Please follow the steps below carefully. It is recommended to have two people for assembly.

### Before You Begin:

- Clear a spacious area for assembly.
- Unpack all components and hardware. Verify against the parts list provided in your physical manual.
- Keep small parts out of reach of children.

### Assembly Steps:

1. **Frame Assembly:** Connect the main panels to form the cabinet frame. Ensure all cam locks and dowels are securely fastened.
2. **Shelf Installation:** Insert the adjustable shelf pins into the desired holes. Place the adjustable shelves onto the pins.
3. **Door Attachment:** Attach the fluted doors using the top and bottom door axis mechanism. Ensure the rebound door stoppers are correctly aligned for smooth operation.
4. **Back Panel:** Secure the back panel connectors. *Refer to the image below for proper installation of back panel clips.*
5. **Feet Installation:** Attach the metal support feet to the base of the cabinet.
6. **Wall Anchoring:** Install the anti-tipping device to the back of the cabinet and secure it to a wall stud using appropriate hardware. This step is crucial for safety.



Image: Close-up views of key assembly points: (1) Push-to-open mechanism, (2) Metal feet attachment, (3) Mid-level storage area, and (4) Adjustable shelf pin holes.



Image: Diagram illustrating the correct method for installing back panel connectors (D1, D2) by inserting clips into the designated gap and securing them.

## OPERATING INSTRUCTIONS

Your Mericonia Buffet Sideboard Cabinet is designed for straightforward use. Here are some guidelines for optimal functionality:

### Storage Utilization

- **Adjustable Shelves:** Customize the height of the interior shelves to fit various items, from tall bottles to stacks of plates.
- **Open Compartments:** Use the upper open shelves for frequently accessed items or decorative displays.
- **Countertop Space:** The robust top surface can support small kitchen appliances, serving dishes, or decor.

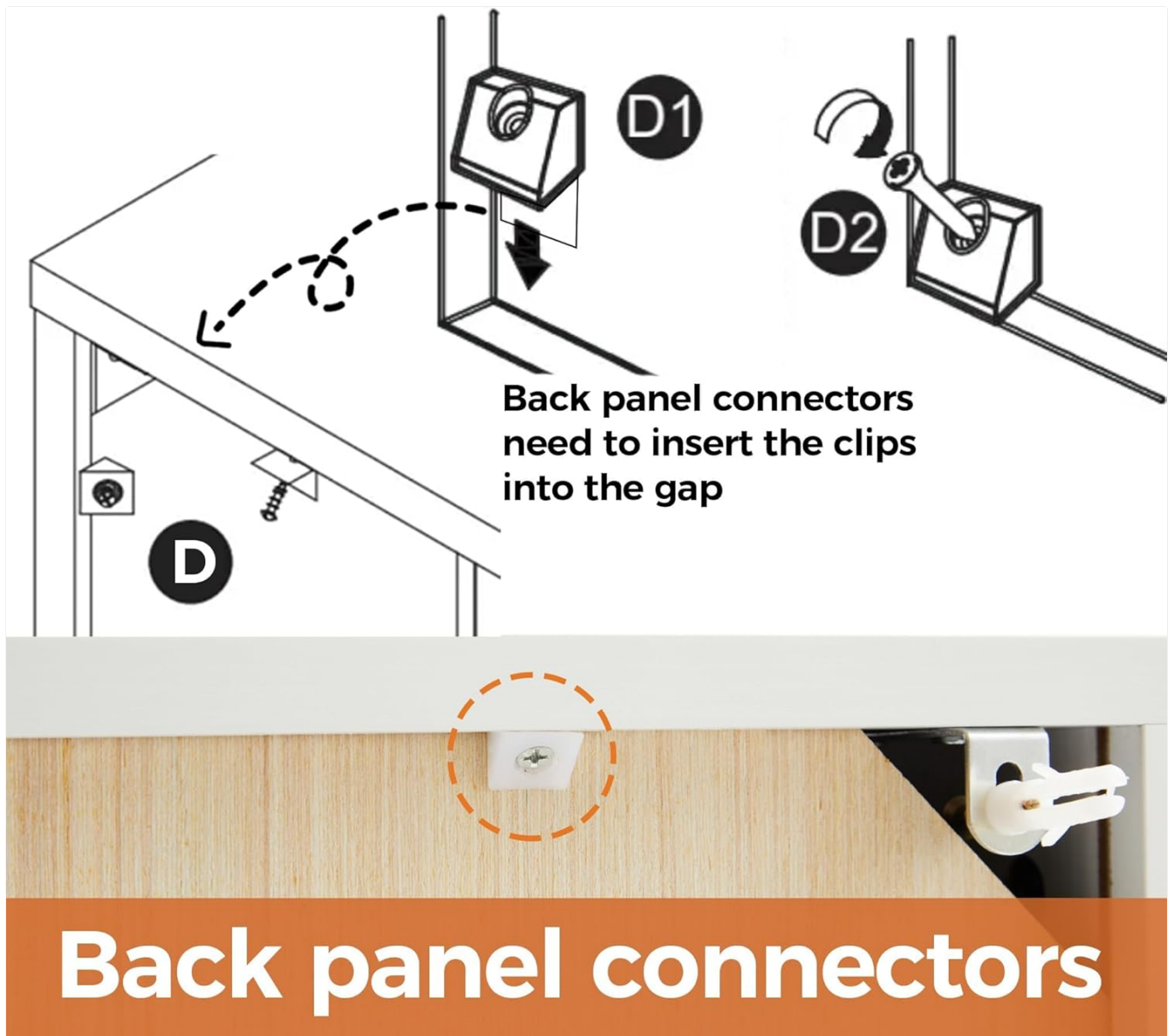

Image: The cabinet interior with doors open, demonstrating ample storage space for various kitchen or living room items such as dishes, bottles, and storage baskets.

## Door Operation

The fluted doors are equipped with a rebound door stopper mechanism. To open, gently push the door inward, and it will spring open slightly. To close, push the door until it clicks into place.

## MAINTENANCE

Proper care will extend the life and maintain the appearance of your cabinet.

### Cleaning

- Wipe surfaces with a soft, slightly damp cloth.
- Avoid using harsh chemicals, abrasive cleaners, or polishes that may damage the finish.
- For spills, clean immediately with a dry cloth to prevent moisture absorption.



Image: Close-up of water droplets on the cabinet's wood surface, demonstrating its water-resistant properties. Prompt cleaning of spills is still recommended.

## General Care

- Avoid placing hot items directly on the surface; use coasters or protective pads.
- Keep the cabinet away from extreme temperature changes or direct heat sources.
- Periodically check all fasteners and tighten if necessary to maintain structural integrity.

## TROUBLESHOOTING

If you encounter any issues with your cabinet, refer to the following common solutions:

### Uneven or Gapped Doors

If the door panels are not aligned correctly or have noticeable gaps after assembly, this can often be resolved by adjusting the hinge screws. Consult the detailed assembly instructions in your physical manual for specific hinge adjustment procedures.

### Cabinet Instability

If the cabinet feels wobbly or unstable, ensure all assembly fasteners are securely tightened. Pay particular attention to the small fasteners on the cabinet back panel; ensure they are firmly fixed and tightened at a 45-degree angle to enhance overall stability. Additionally, confirm that the anti-tipping device is properly installed and anchored to a wall stud.

## WARRANTY AND SUPPORT

Mericonia is committed to providing high-quality products. While specific warranty details may vary by region and purchase platform, we offer dedicated customer support for any inquiries or issues you may encounter.

### Customer Service

For assistance with assembly, missing parts, product defects, or any other concerns, please contact Mericonia customer service. You can typically find contact information on your purchase receipt, the product packaging, or by visiting the official Mericonia brand store online.

You can also visit the Mericonia Store for more information and support:

[Visit the Mericonia Store](#)

