

Manuals+

[Q & A](#) | [Deep Search](#) | [Upload](#)

Manuals.plus /

> [XYszpcgs](#) /

> XYszpcgs CT90Y Outdoor Motion Sensor Alarm User Manual

XYszpcgs CT90Y

XYszpcgs CT90Y Outdoor Motion Sensor Alarm User Manual

Model: CT90Y

1. INTRODUCTION

The XYszpcgs CT90Y Outdoor Motion Sensor Alarm is designed to provide security and deterrence for various outdoor and indoor environments. This device features motion detection, customizable sound recordings, adjustable volume, and multiple operating modes, all controllable via a remote. It is powered by solar energy and a built-in lithium battery, with USB charging as an alternative.

2. PRODUCT OVERVIEW

2.1 Device Components

Familiarize yourself with the main components of your motion sensor alarm:

- **Solar Charging Panel:** Located on top, for solar power generation.
- **Speaker:** Emits alarm sounds and voice messages.
- **Detection Window:** Infrared motion sensor.
- **Alarm Lights:** Flashing LED lights for visual deterrence.
- **Rotating Bracket:** For flexible mounting and adjustment.
- **Installation Bracket Groove:** For secure mounting.
- **Mode Switching Button:** On the back, for changing operating modes (short press).
- **Volume Adjustment Button:** On the back, for adjusting volume (short press).
- **Power Button:** On the back, long press for 3 seconds to turn on/off.

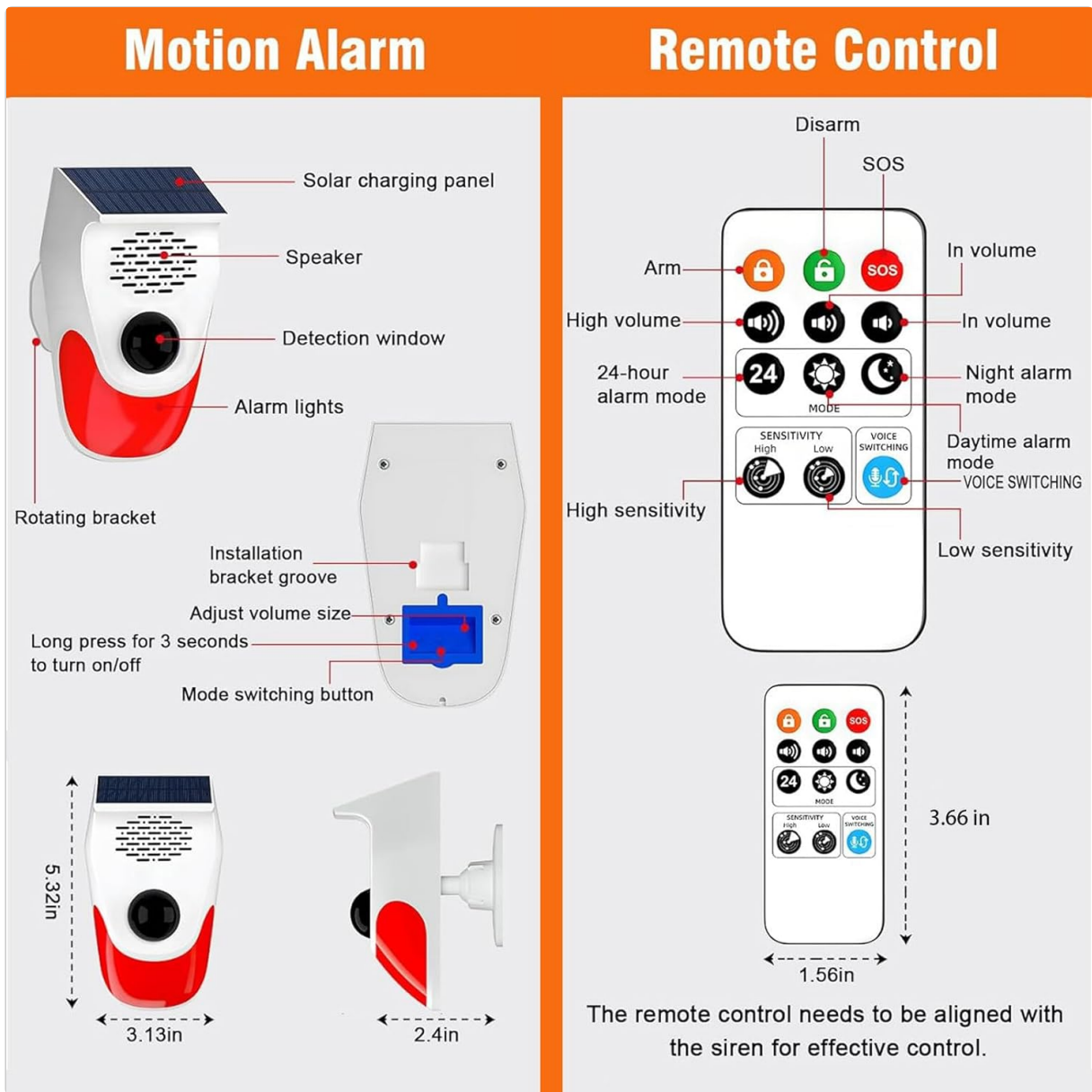

Figure 2.1: Motion Sensor Alarm Components and Remote Control Layout.

2.2 Remote Control Functions

The included remote control allows for convenient operation of the alarm:

- **Disarm Button (Green Unlock):** Deactivates the alarm, preventing voice broadcast upon motion detection.
- **Arm Button (Red Lock):** Activates the alarm, enabling voice broadcast upon motion detection.
- **SOS Button (Red SOS):** Triggers an emergency alarm.
- **Volume Up/Down Buttons:** Adjusts the alarm volume.
- **24-hour Mode Button:** Activates continuous operation.
- **Daytime Mode Button:** Activates operation only during daylight hours.
- **Nighttime Mode Button:** Activates operation only during nighttime hours.
- **Sensitivity High/Low Buttons:** Adjusts motion detection sensitivity.
- **Voice Switching Button:** Cycles through available voice recordings.

| Smart Remote

Easy to understand and operate.



Figure 2.2: Smart Remote Control Overview.

Your browser does not support the video tag.

Video 2.1: Official operation video demonstrating the features and functions of the Solar Motion Sensor Outdoor Alarm, including power on, disarm, arm, mode switching, volume adjustment, and voice switching.

3. SETUP

3.1 Initial Power On

Before first use, ensure the device is adequately charged. Long press the power button on the back of the device for 3 seconds to turn it on. You will hear a voice prompt "Welcome to use this system."

3.2 Charging the Device

The device supports two charging methods:

- **Solar Charging:** Position the device where the solar panel receives direct sunlight for at least 24 hours for a full charge. The alarm light will be slightly on during charging.
- **USB Charging:** Connect the device to a USB power source using the provided USB cable. Charging time is approximately 8 hours.



Figure 3.1: Solar and USB Charging Options.

3.3 Installation

Mount the device using the rotating bracket and installation groove. Ensure the motion sensor has a clear line of sight to the area you wish to monitor. The device can be wall-mounted. For optimal motion detection, consider mounting it at a height of approximately 6.5 feet (2 meters).



Figure 3.2: Example Installation Locations.

4. OPERATING MODES

The device offers three distinct working modes, switchable via the button on the back of the product or the remote control:

- **Mode 1: 24-hour Working Mode:** The alarm operates continuously, detecting motion and broadcasting voice messages both day and night.
- **Mode 2: Daytime Working Mode:** The alarm operates only during daylight hours. Motion detection and voice broadcast are active during the day but inactive at night.
- **Mode 3: Night Working Mode:** The alarm operates only during nighttime hours. Motion detection and voice broadcast are active at night but inactive during the day.



Figure 4.1: Three Working Modes.

5. SOUND AND VOICE CUSTOMIZATION

5.1 Adjusting Volume

The device features three adjustable volume levels, with a maximum output of 120dB. You can adjust the volume using the dedicated buttons on the remote control or by short pressing the volume adjustment button on the back of the device.



Figure 5.1: High Pitched Alarm and Volume Levels.

5.2 Switching Pre-loaded Voices

The alarm comes with 8 pre-loaded sounds, including gunshots, warning sounds, and dog barking. You can switch between these voices using the voice switching button on the remote control or by long pressing the voice switching button on the back of the device for 3 seconds.

5.3 Custom Voice Recording

The device allows you to customize up to 8 of your own sounds. To do this:

1. Connect the device to a computer using the included USB cable.
2. Upload MP3/WAV audio files to the device.
3. **Important:** The total size of all audio files (including pre-loaded and custom) must be less than 1.3 MB. Each voice message should not exceed one minute in length.

| *Easy Voice Replacement*



Figure 5.2: Easy Voice Replacement via USB.

6. MAINTENANCE

The XYszpcgs CT90Y alarm has an IP65 waterproof rating, making it resistant to dust and water splashes. This allows for reliable outdoor use in various weather conditions. However, it is recommended to avoid submerging the device in water.



Figure 6.1: IP65 Waterproof Feature.

7. TROUBLESHOOTING

- **Remote Control Range:** The infrared remote control has an effective operating range of approximately 16.4 feet (5 meters). It must be pointed directly at the alarm for effective control. If the remote is not responding, ensure you are within range and have a clear line of sight to the device.
- **Custom Sound Upload Issues:** If you encounter problems uploading custom sounds, verify that the total size of all audio files (including existing ones) does not exceed 1.3 MB. Also, ensure individual voice messages are not longer than one minute.
- **Motion Sensor Range:** The device detects motion within 110 degrees and up to 5 meters. The effective range can be affected by mounting height and environmental factors. If detection is inconsistent, try adjusting the mounting height or sensitivity settings.
- **Device Not Powering On:** Ensure the device is fully charged via solar or USB. Long press the power button for 3 seconds.

8. SPECIFICATIONS

Feature	Specification
Brand	XYszpcgs
Model Number	CT90Y
Power Source	Solar Powered, USB Charging
Battery	1000mAh Lithium-Ion (1 C battery included)
Motion Detection Range	110 degrees, up to 5 meters (16.4 feet)
Maximum Volume	120dB
Waterproof Rating	IP65
Operating Modes	24/7, Daytime, Nighttime
Custom Sound Capacity	Up to 8 MP3/WAV files, total size < 1.3 MB
Remote Control Range	16.4 feet (line of sight)
Product Dimensions	2.4"D x 3.13"W x 5.32"H
Item Weight	7.7 ounces (0.48 Pounds)
Temperature Range	-20°C to 50°C
UPC	729604233859

9. WARRANTY AND SUPPORT

For warranty information and technical support, please refer to the contact details provided with your purchase or visit the official XYszpcgs website. Keep your purchase receipt for warranty claims.
