



Manuals.plus /

› Spampur /

› Spampur Metal Pegboard Panels (16x12" - 4 Pcs) Instruction Manual

Spampur 16x12

Spampur Metal Pegboard Panels (16x12" - 4 Pcs) Instruction Manual

Brand: Spampur | Model: 16x12

1. PRODUCT OVERVIEW

The Spampur Metal Pegboard Panels are designed for versatile organization in various environments. Each panel is constructed from high-quality steel with a powder-coated finish, ensuring durability, scratch resistance, and ease of cleaning. Each 16 x 12 inch panel supports a weight capacity of up to 50 lbs. This set includes four individual pegboard panels, each featuring 1/4 inch holes with 1-inch spacing, making them compatible with standard pegboard hooks and accessories. The panels can be combined to create larger configurations, such as a 64 x 12 inch strip or a 32 x 24 inch wall, allowing for flexible customization to optimize wall space.

The pegboard system is suitable for a wide range of applications, including garages, workshops, kitchens, craft rooms, and offices, helping to maintain an organized and clutter-free space.

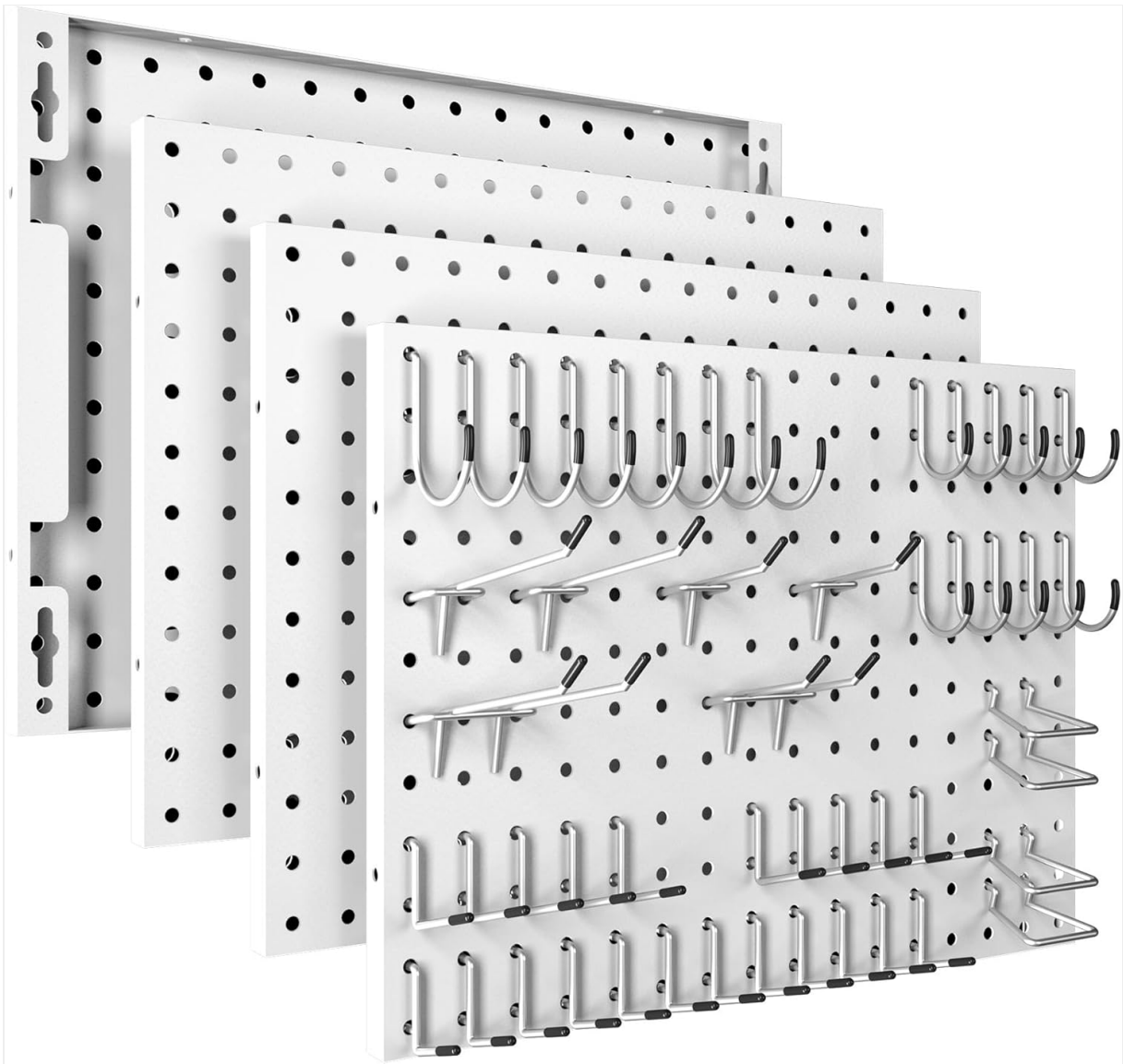

Image 1.1: Organized tools on Spampur Metal Pegboard Panels.

2. PACKAGE CONTENTS

Your package includes the following items:

- 4 x Metal Pegboard Panels (16 x 12 inches each)
- 50 x Assorted Pegboard Hooks
- Mounting Accessories (screws and expansion pipes)



Image 2.1: Included pegboard panels, hooks, and mounting hardware.

3. SETUP AND INSTALLATION

The pegboard panels are designed for easy installation. You will need a drill and a hammer for the installation process. The provided screw and expansion pipe installation kits facilitate secure mounting.

3.1 Panel Arrangement

Determine your desired layout for the pegboard panels. The four 16 x 12 inch panels can be arranged in various configurations, such as a long horizontal strip (64 x 12 inches) or a larger square (32 x 24 inches), to best suit your space and organizational needs.

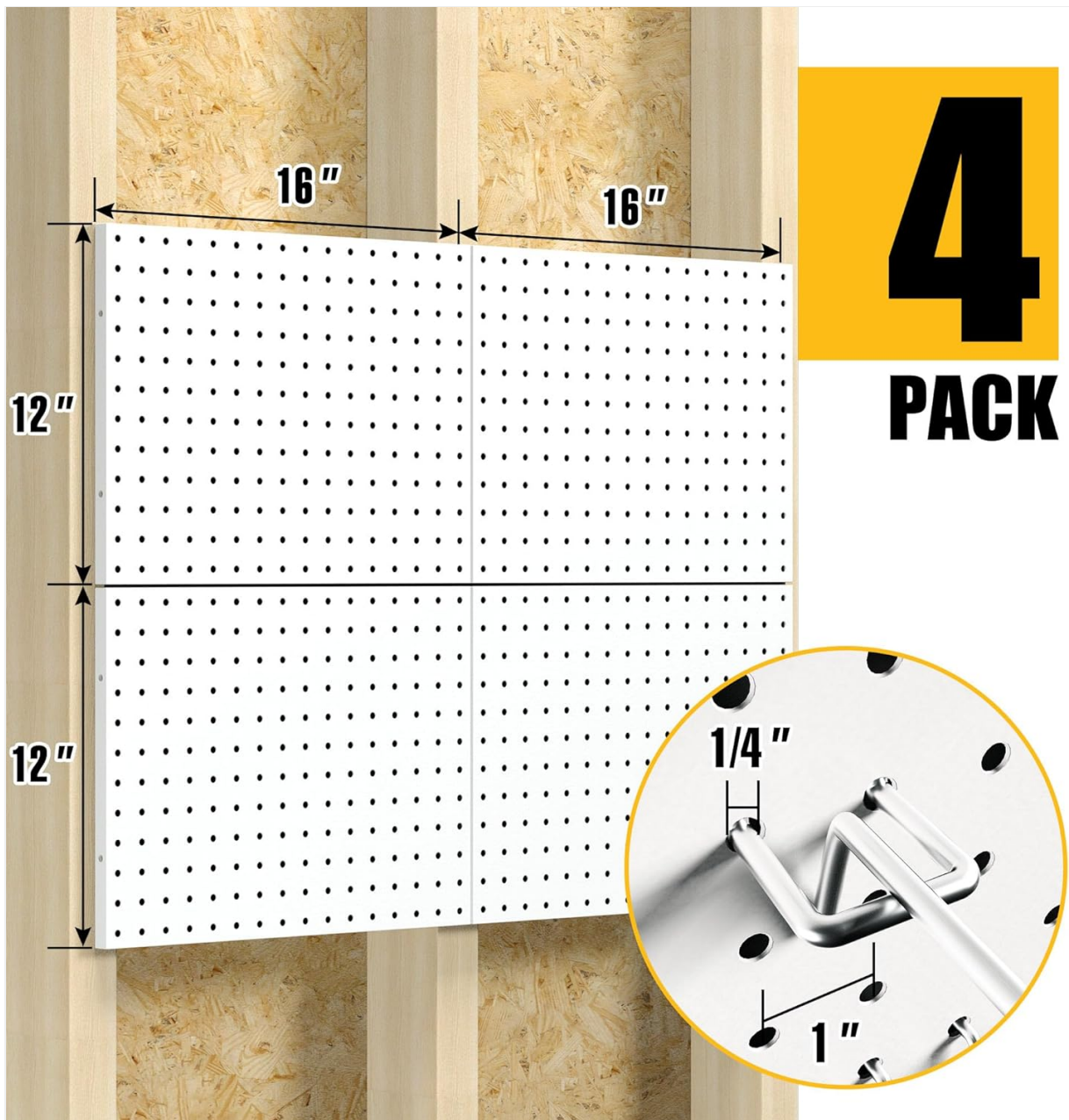
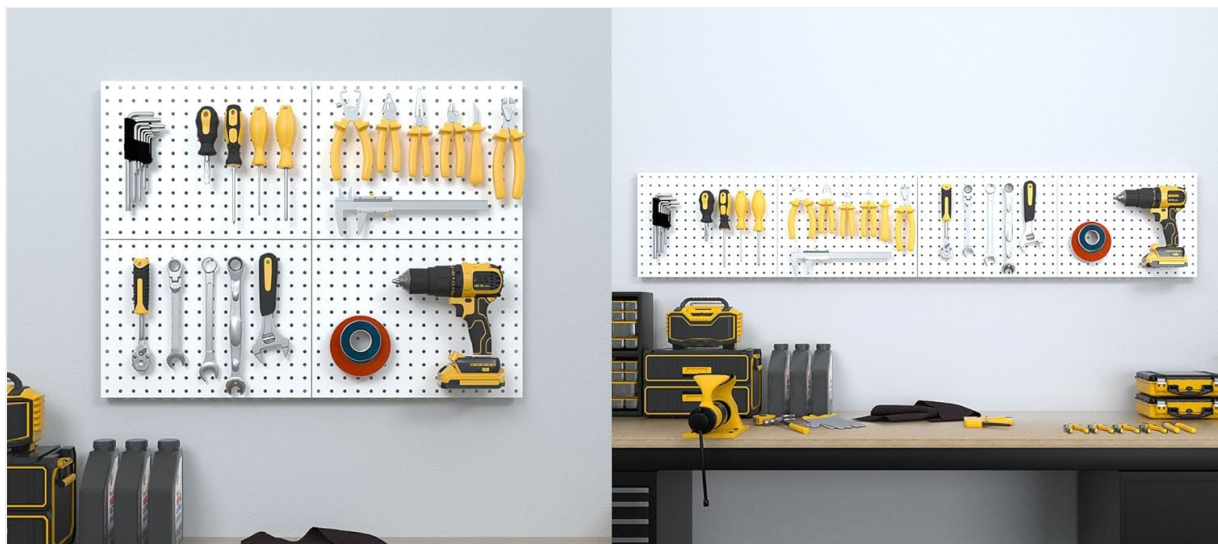

Image 3.1: Example of four panels arranged to form a larger pegboard area.

3.2 Mounting the Panels

Use the provided screws and expansion pipes to mount the panels securely to your wall. Ensure the panels are level and properly aligned before tightening all fasteners. For optimal stability, it is recommended to mount into wall studs where possible.



Flexible layout

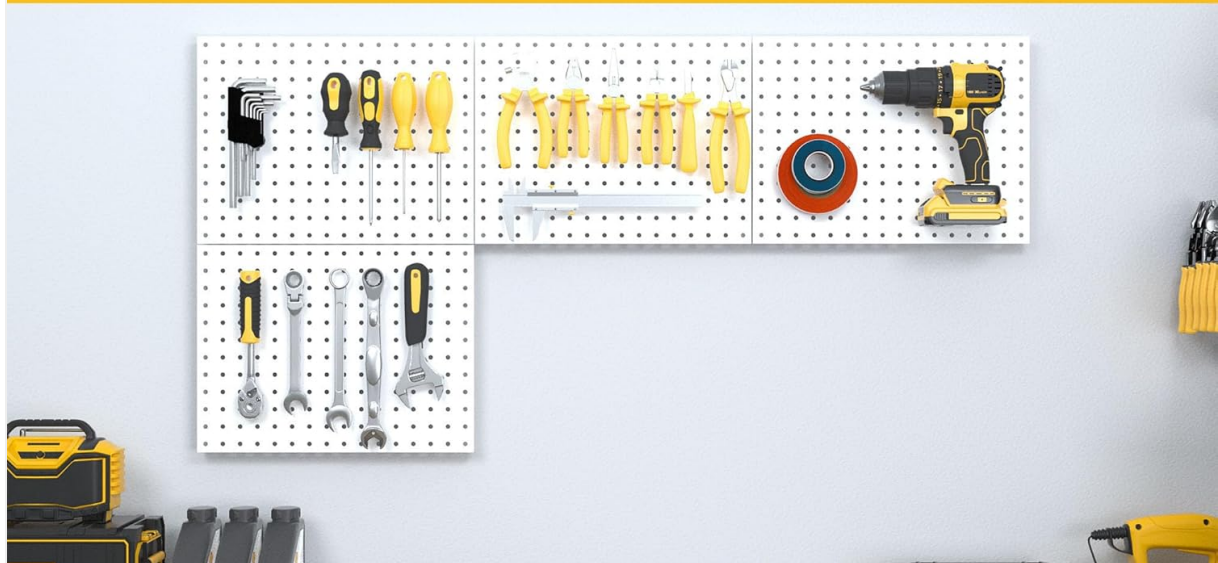

Image 3.2: Illustration of the two installation methods: hanging and drill-mounted.

3.3 Connecting Multiple Panels

If you are combining multiple panels, use the included screws to connect them together at the edges. This creates a seamless and sturdy larger pegboard surface.

Video 3.1: Official Spampur video demonstrating the installation and connection of the 4-pack metal pegboard panels.

4. OPERATING AND USAGE

Once installed, the pegboard provides a versatile platform for organizing various items. The 50 assorted hooks included in the package can be arranged to hold tools, craft supplies, kitchen utensils, and more.

4.1 Attaching Hooks

Insert the pegboard hooks into the 1/4 inch holes. The hooks are designed to fit securely, providing stable support for your items. Experiment with different hook types and placements to find the most efficient arrangement for your specific items.

Video 4.1: Official Spampur video demonstrating the anti-drop feature and installation of various pegboard hooks.

4.2 Maximizing Space

Utilize the entire surface of the pegboard to hang items, freeing up valuable counter or shelf space. Consider grouping similar items together for easy access and a tidy appearance.

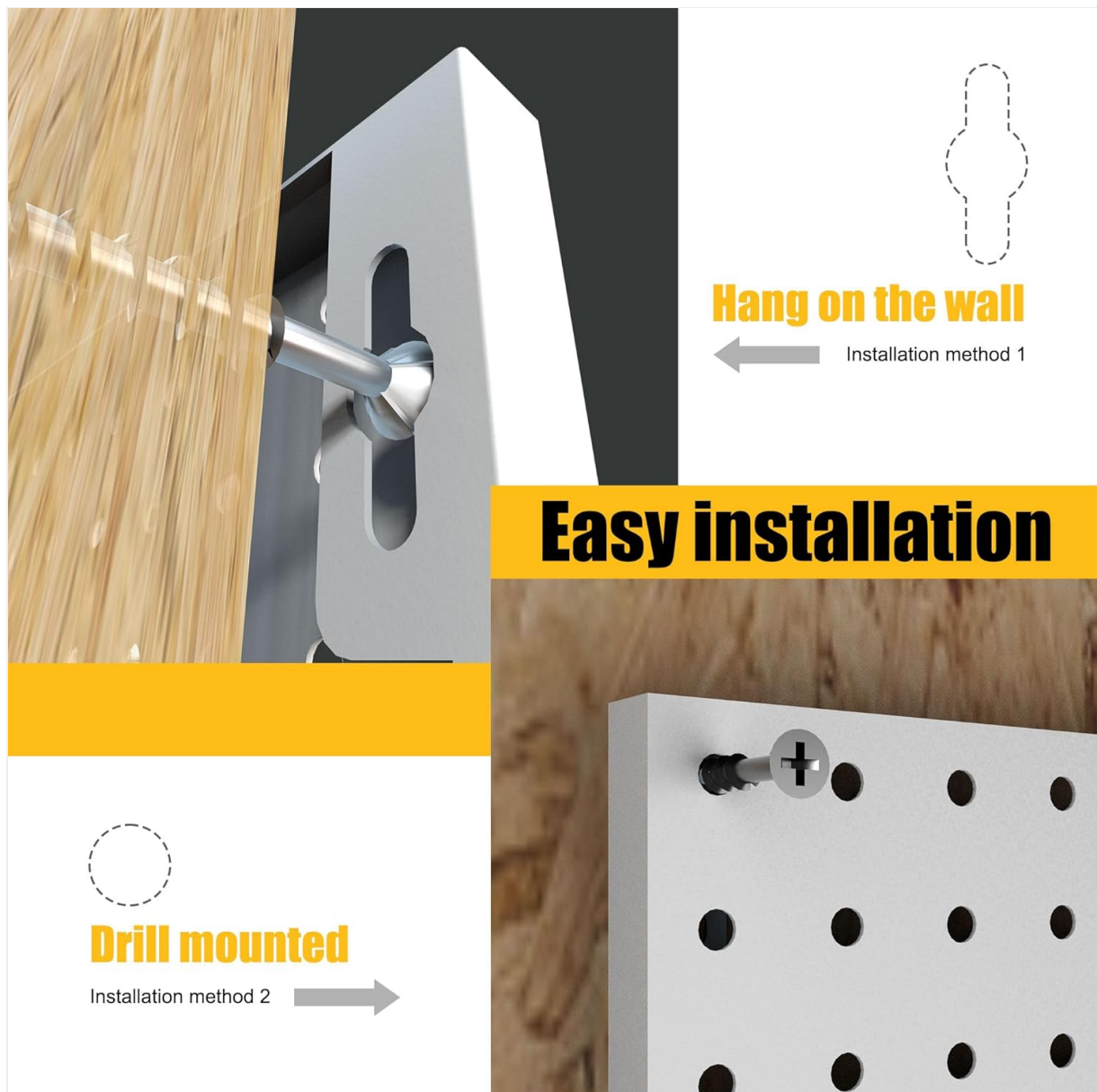
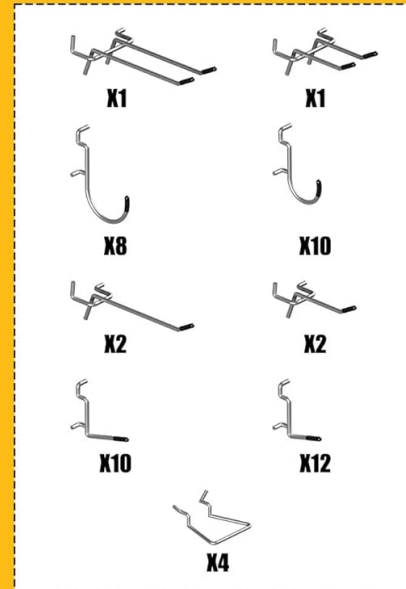
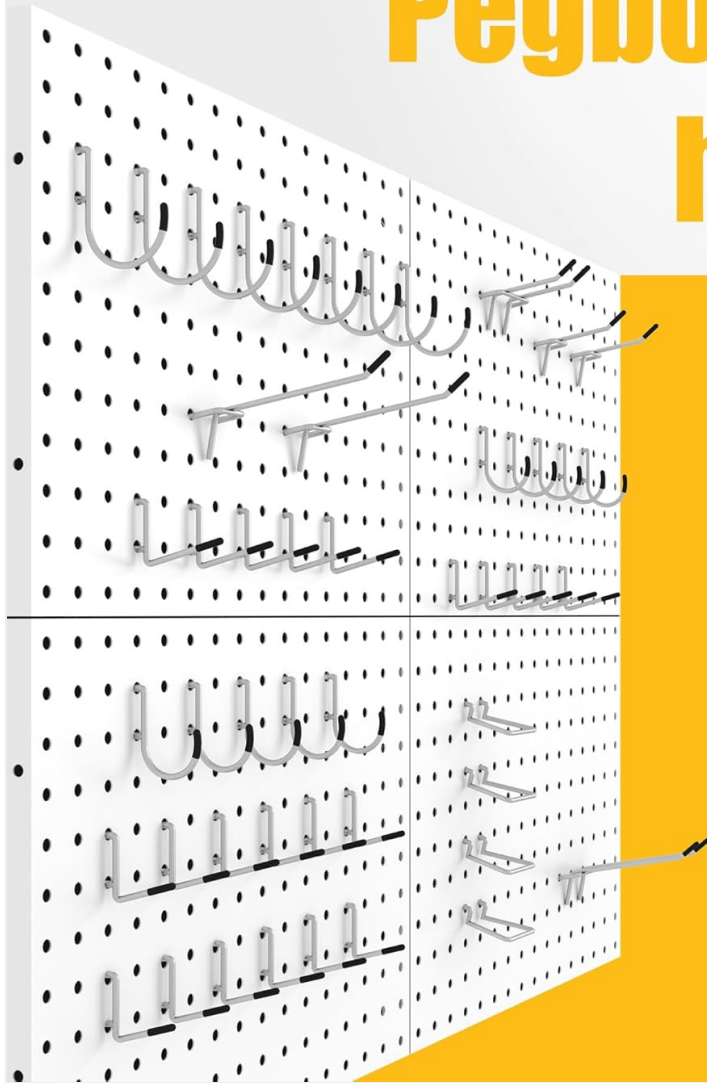

Image 4.1: Examples of pegboard use in a garage and office.

Pegboard with hooks kit



50 PCS

Image 4.2: Examples of pegboard use in a kitchen and craft room.

5. MAINTENANCE

To maintain the appearance and functionality of your Spampur Metal Pegboard Panels, follow these simple guidelines:

- **Cleaning:** Wipe the panels with a soft, damp cloth to remove dust and dirt. For tougher stains, a mild soap solution can be used, followed by thorough drying to prevent water spots.
- **Avoid Abrasives:** Do not use abrasive cleaners or scouring pads, as these can damage the powder-coated finish.
- **Inspect Hooks:** Periodically check the hooks for any signs of wear or damage. Replace any damaged hooks to ensure secure storage.

6. TROUBLESHOOTING

If you encounter any issues with your pegboard system, consider the following:

- **Loose Hooks:** While the pegboard holes are 1/4 inch, some standard 1/8 inch pegboard hooks may fit loosely. If hooks frequently fall off when removing items, consider using peg locks (not included) to

secure them in place.

- **Panel Stability:** Ensure all mounting screws are tightened securely. If mounting into drywall without studs, verify that appropriate anchors (expansion pipes) were used and installed correctly to support the weight.
- **Weight Capacity:** Each 16x12 inch panel has a maximum weight capacity of 50 lbs. Avoid exceeding this limit to prevent damage to the panel or mounting hardware.

7. SPECIFICATIONS

Feature	Detail
Brand	Spampur
Material	Iron (Steel with powder-coated finish)
Color	White
Panel Dimensions (each)	16 x 12 x 0.63 inches
Number of Panels	4
Peg Hole Diameter	1/4 inch
Peg Hole Spacing	1 inch
Maximum Weight Capacity (per panel)	50 Pounds
Mounting Type	Wall Mount
Included Hooks	50 assorted hooks
Item Weight (total)	8.8 Pounds

8. WARRANTY AND SUPPORT

Your purchase includes the metal pegboard panels, 50 hooks, and all necessary mounting accessories. If you have any questions or require a free replacement for any components, please contact Spampur customer service directly. We are committed to ensuring your satisfaction with our wall organization system.