

[Manuals.plus](#) /

› [LIVAUEAD](#) /

› LIVAUEAD Full Size Murphy Bed with Charging Station & Drawer - Instruction Manual

LIVAUEAD Murphy Bed

LIVAUEAD Full Size Murphy Bed with Charging Station & Drawer - Instruction Manual

1. INTRODUCTION

This manual provides comprehensive instructions for the assembly, operation, and maintenance of your LIVAUEAD Full Size Murphy Bed with Charging Station and Drawer. Designed for versatility, this furniture piece efficiently transforms from a compact cabinet into a comfortable full-size bed, making it ideal for guest rooms or multi-functional living spaces. It also includes a convenient built-in charging station and an integrated storage drawer.



This image illustrates the dual functionality of the Murphy bed, showcasing it both as a comfortable full-size bed and as a compact chest of drawers with an accessible storage drawer.

2. SAFETY INFORMATION

Please read and understand all safety warnings before assembly and use.

- Always keep the bed in the lowered position when in use.
- Do not allow children to play on or around the bed when it is in the raised (cabinet) position.
- Always assemble the bed according to the provided instructions.
- Do not exceed the maximum weight capacity of 661 lbs (300 kg).
- Use appropriate bedding materials for infants and young children to prevent suffocation hazards.
- Ensure all connections for the charging station are secure and follow electrical safety guidelines.

3. PACKAGE CONTENTS

Verify that all components are present before beginning assembly. If any parts are missing or damaged, please contact customer support.

- 1 x Murphy Bed Unit

- Installation Manual (this document)
- All necessary hardware (screws, bolts, cam locks, etc.)

4. ASSEMBLY INSTRUCTIONS

Assembly requires two adults and basic tools (screwdriver, hammer). Follow the step-by-step instructions provided in the separate installation manual included with your product. Do not use power tools as they may overtighten screws and damage the wood.

Key Assembly Considerations:

- **Part Identification:** Carefully identify all parts using the provided diagrams.
- **Hardware Organization:** Sort all hardware components before starting to ensure a smooth assembly process.
- **Orientation:** Pay close attention to the orientation of parts, especially drawer slides and bed frame components.
- **Weight:** The assembled unit is heavy (approximately 220 lbs). Plan for assistance when moving the unit.

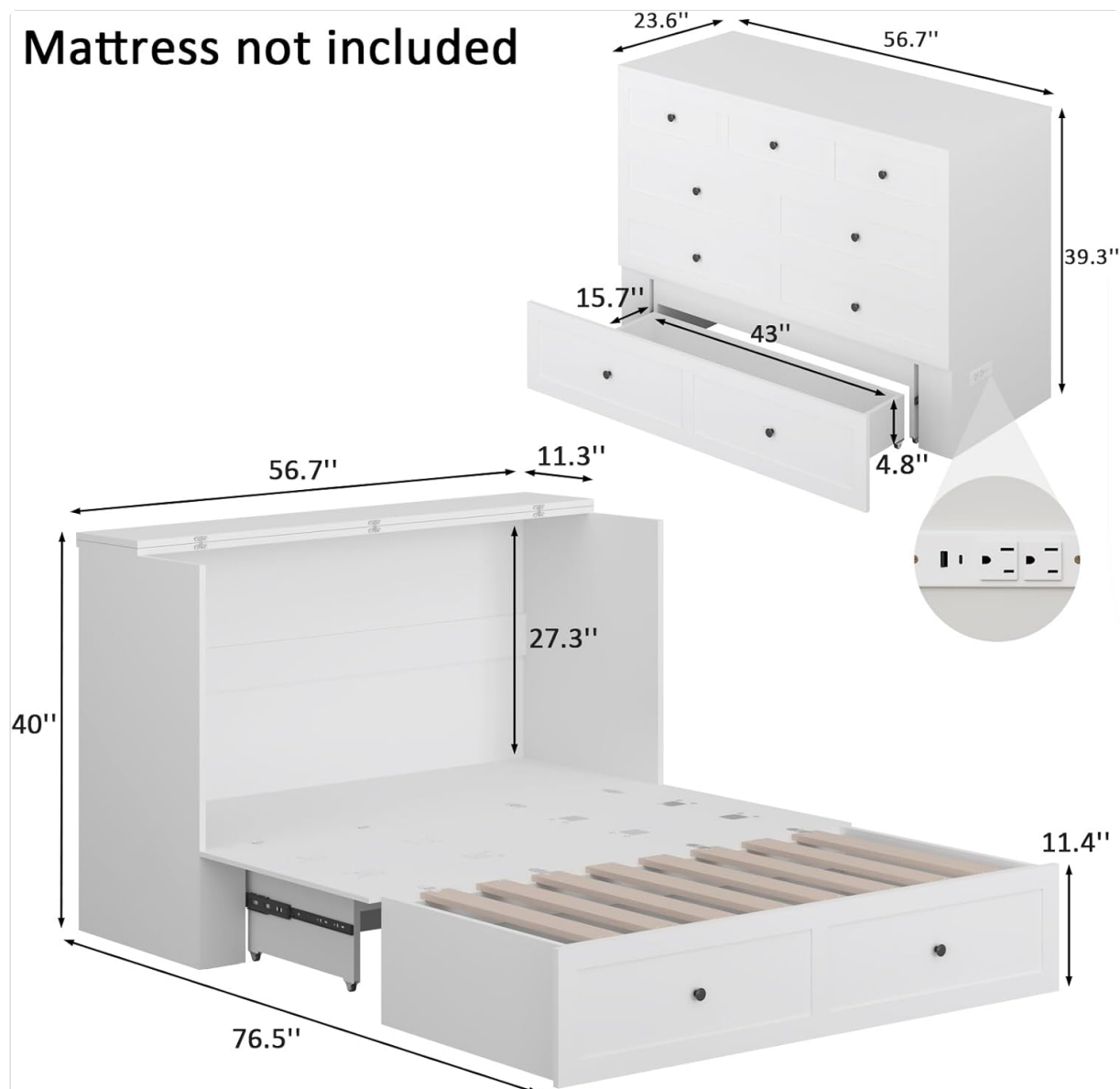

This diagram provides critical measurements for both the cabinet and bed forms, along with an exploded view of the drawer and a close-up of the integrated charging station, aiding in assembly and space planning.

5. OPERATING INSTRUCTIONS

Converting from Cabinet to Bed

1. Ensure the area around the cabinet is clear of obstructions.
2. Gently pull the bottom drawer outwards. This drawer acts as a support for the bed frame.
3. Unfold the bed platform from the cabinet. The platform will extend forward and rest on the extended drawer.
4. Adjust the bed frame to its fully extended position.
5. Place your mattress (not included) onto the bed frame.

Converting from Bed to Cabinet

1. Remove any bedding and the mattress from the bed frame.
2. Lift the bed platform and fold it back into the cabinet.
3. Push the bottom drawer back into the cabinet until it is fully closed.
4. Ensure the cabinet is securely closed.

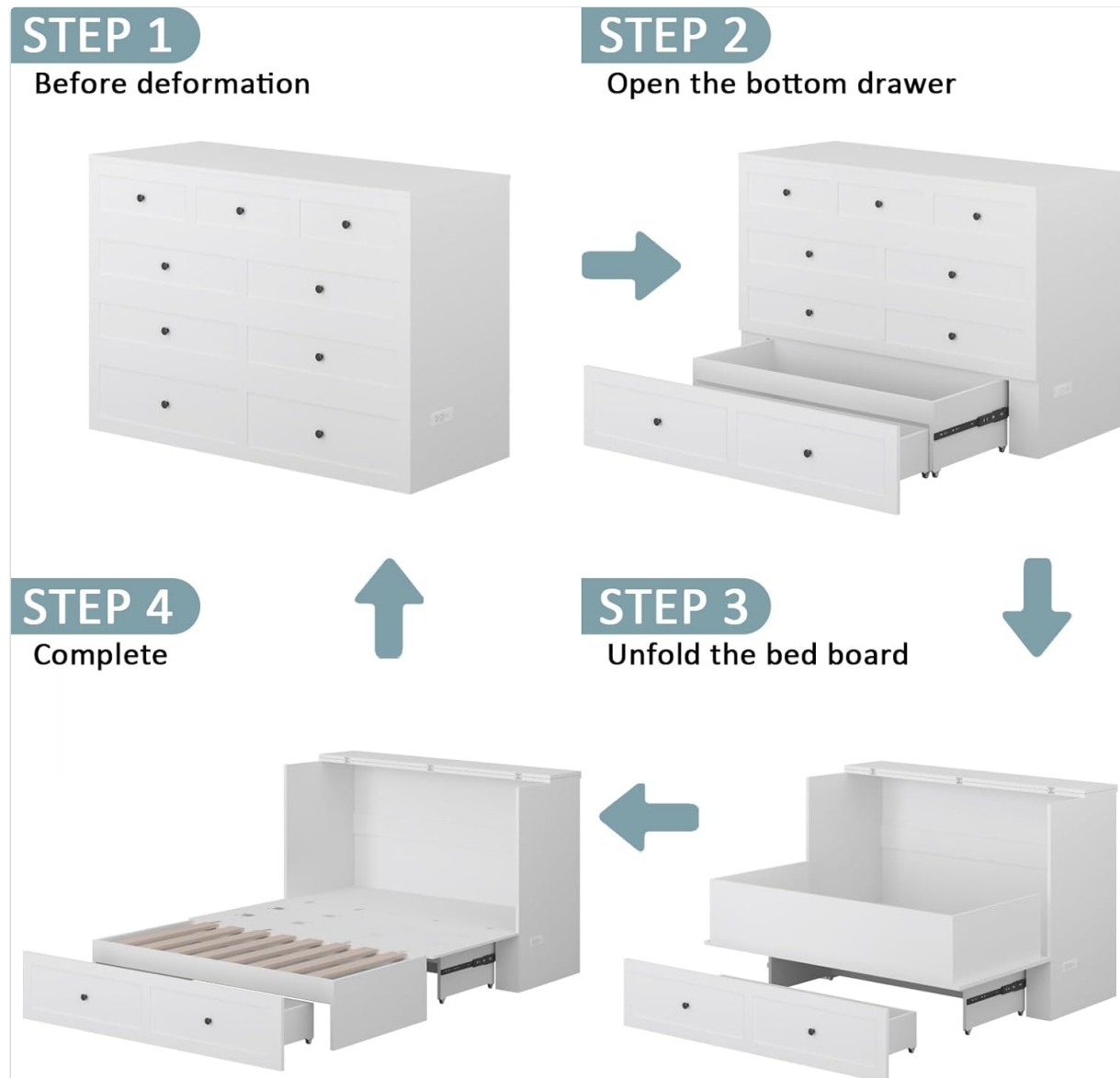

This image visually breaks down the conversion process into four clear steps: starting from the cabinet, opening the bottom drawer, unfolding the bed board, and the final complete bed configuration.

Using the Charging Station

The built-in charging station is located on the right side of the unit. It includes 2 AC outlets, 1 USB port, and 1 Type-C port, with a 4.6 ft power cord. Plug the power cord into a standard wall outlet. You can then connect your electronic devices for charging.

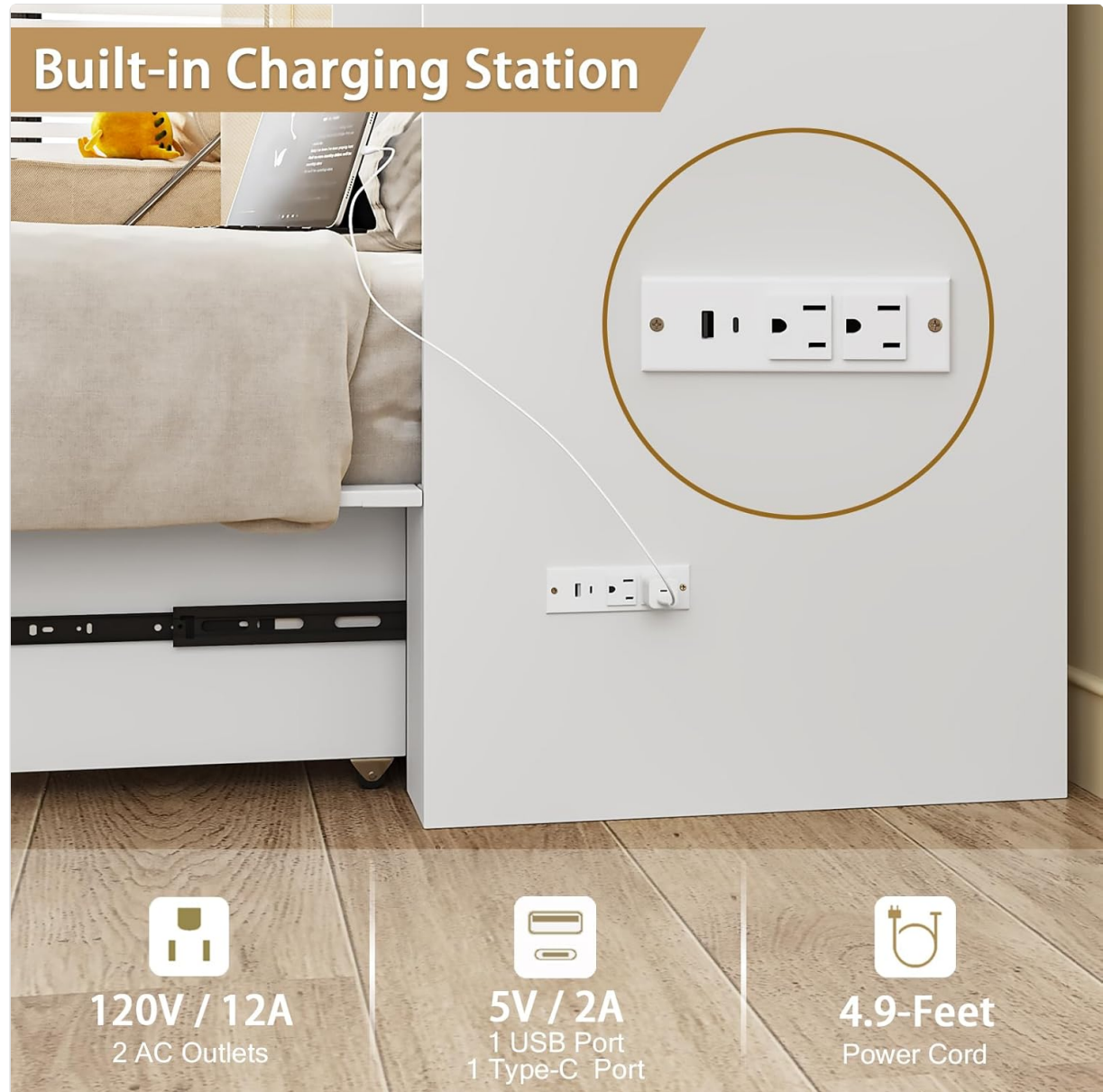

This image highlights the convenience of the integrated charging station, showing its various ports and electrical ratings for easy device charging.

Utilizing the Storage Drawer

The spacious drawer located at the bottom of the unit provides ample storage for linens, clothing, or other items. It can also accommodate a 3-inch tri-fold full-size mattress when the bed is folded into a dresser (mattress not included).

Stable platform & Large storage space



This image demonstrates the practical storage capacity of the integrated drawer, suitable for bedding or other personal items.

6. MAINTENANCE AND CARE

Cleaning

Wipe surfaces with a soft, damp cloth. Avoid harsh chemicals or abrasive cleaners that may damage the finish.

General Care

- Regularly check all screws and connections to ensure they remain tight. Retighten as necessary to maintain stability.
- Avoid placing hot items directly on the surface. Use coasters or protective pads.
- Keep the unit away from direct sunlight and excessive moisture to prevent warping or discoloration.

7. TROUBLESHOOTING

Difficulty during Assembly

If you encounter difficulties, re-read the specific step in the installation manual. Ensure all parts are correctly oriented and that you are using the correct hardware for each step. A second person can often help identify issues.

Bed feels unstable

Verify that all screws and bolts are securely tightened. Ensure the bottom drawer is fully extended and locked into place when the bed is in use, as it provides crucial support.

Charging Station not working

Check that the power cord is securely plugged into both the unit and a functional wall outlet. Test the outlet with another device to ensure it has power.

8. SPECIFICATIONS

Product Dimensions (Full Size)

- **Cabinet Dimensions:** 46.9"W x 21.6"D x 31.5"H
- **Bed Dimensions (Extended):** 76.3"L x 56.7"W x 40"H

General Specifications

- **Brand:** LIVAUEAD
- **Model:** Murphy Bed
- **Size:** Full
- **Color:** White
- **Finish Type:** Painted
- **Weight Capacity:** 661 lbs
- **Item Weight:** 220 pounds
- **Assembly Required:** Yes
- **Charging Station:** 2 AC outlets, 1 USB port, 1 Type-C port, 4.6 ft power cord (120V/12A, 5V/2A)
- **Compatible Mattress Size:** Full (3-inch tri-fold mattress recommended for storage)

9. WARRANTY AND SUPPORT

For warranty information, replacement parts, or technical assistance, please contact LIVAUEAD customer support. Refer to your purchase documentation for specific contact details or visit the official LIVAUEAD website.

Online Support: [Visit the LIVAUEAD Store on Amazon](#)