

## SONOFF ZBM5-1C-120W

# SONOFF ZBM5-1C-120W Zigbee Smart Light Switch User Manual

Model: ZBM5-1C-120W

## 1. PRODUCT OVERVIEW

The SONOFF ZBM5-1C-120W is a Zigbee-based smart wall switch designed for controlling home lighting. It offers remote control capabilities via a smartphone application, voice control through compatible smart assistants, and integration into smart home scenes. This switch supports both wiring configurations: with or without a neutral wire, providing flexibility for various electrical setups. A SONOFF Zigbee Hub is required for its smart functionalities.

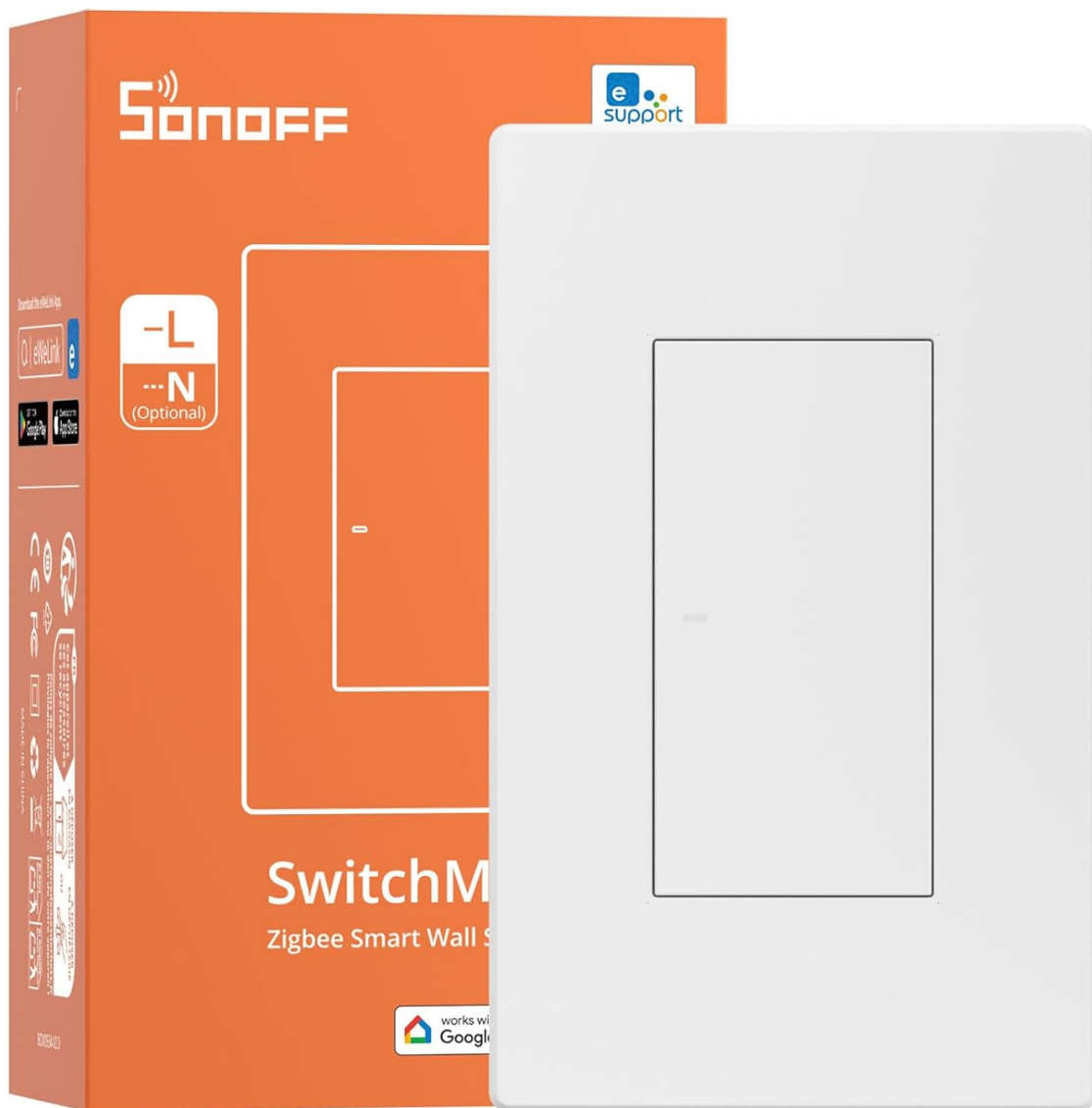

Image 1.1: SONOFF ZBM5-1C-120W Zigbee Smart Light Switch and its packaging.

## 2. SAFETY INFORMATION

**WARNING: Risk of electric shock. Installation should be performed by a qualified electrician or service personnel. Ensure power is OFF at the circuit breaker before installation or maintenance.**

- Do not install with wet hands.
- Do not use in excessively humid environments or expose to water.
- Ensure the device is securely mounted before operation.
- Adhere to all local electrical codes and regulations.

## 3. PACKAGE CONTENTS

The product package includes:

- 1 x SONOFF ZBM5-1C-120W Smart Wall Switch

## 4. SETUP AND INSTALLATION

### 4.1 Wiring Instructions

The ZBM5-1C-120W smart switch is designed to be compatible with both neutral wire and no-neutral wire electrical systems. Always ensure the power is turned off at the circuit breaker before beginning any wiring.

1. **Power Off:** Turn off the main power supply at your circuit breaker to prevent electric shock.
2. **Disassemble:** Carefully pry off the switch module and power module from the mounting plate using a small screwdriver.
3. **Identify Wiring:** Determine if your electrical circuit has a neutral wire. This is crucial for selecting the correct wiring method.



Image 4.1: Wiring diagram for both neutral and no-neutral configurations.

# Neutral Wire **Optional**

There's always a way to adapt wiring to your home.

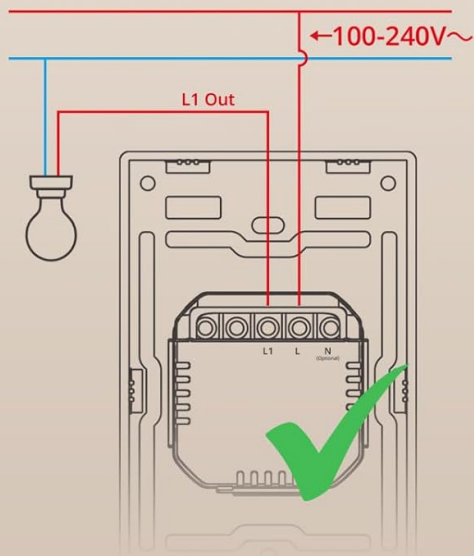

**No Neutral**



$\geq 3W$

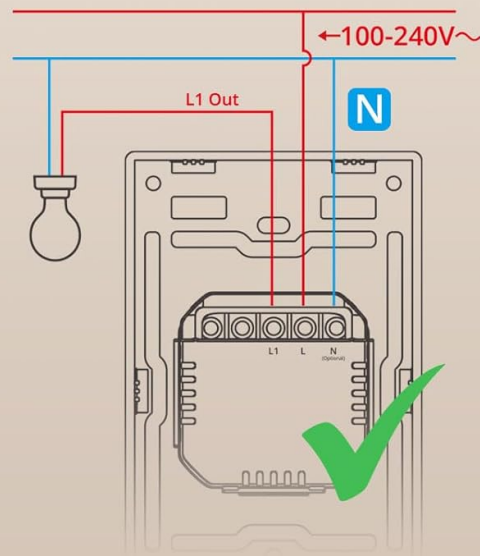

**With Neutral**



**Zigbee router**

Image 4.2: Detailed diagram for neutral wire optional wiring.

- **No Neutral Wire Required:** Connect the Live (L) wire to the 'L' terminal and the Load (L1 Out) wire to the 'L1 Out' terminal. For this configuration, the connected load must be at least 3W.
  - **With Neutral Wire Required:** Connect the Live (L) wire to the 'L' terminal, the Load (L1 Out) wire to the 'L1 Out' terminal, and the Neutral (N) wire to the 'N' terminal. This configuration supports smart lights as a load.
4. **Secure Wiring:** Tighten the screw terminals to ensure secure connections for all wires.
  5. **Mounting:** Place the power module into the mounting box and secure it with screws.
  6. **Install Switch Module:** Snap the switch module back onto the power module.
  7. **Power On:** Restore power at the circuit breaker. The device will take approximately 10 seconds to power on and stabilize for the first time.

## 4.2 App Pairing

To enable smart features, the SONOFF ZBM5-1C-120W must be paired with a compatible SONOFF Zigbee Hub via the eWeLink app.

1. **Download eWeLink App:** Download and install the eWeLink app from your device's app store.
2. **Open App and Scan:** Open the eWeLink app, tap "+" or "Add Device", then select "Scan" to scan the QR

code on the device for instructions.

3. **Initiate Pairing:** Follow the in-app instructions. Typically, this involves long-pressing the button on the switch for 5 seconds until the LED indicator flashes slowly.
4. **Select Zigbee Gateway:** In the app, select your SONOFF Zigbee gateway (e.g., ZBBridge-P).
5. **Complete Addition:** Wait for the app to detect and add the device. Once added, you can control the switch via the app.

### 4.3 Installation Video Guide

Your browser does not support the video tag.

*Video 4.1: This video provides a step-by-step guide on how to install the SONOFF ZBM5 Zigbee Wall Switch, covering wiring and initial setup.*

## 5. OPERATING INSTRUCTIONS

### 5.1 Remote Control via eWeLink App

Once paired with your SONOFF Zigbee Hub, you can control the ZBM5-1C-120W switch from anywhere using the eWeLink app on your smartphone. The app allows you to turn lights on or off, view the switch status, and manage advanced settings.



*Image 5.1: Remote control of the smart switch via the eWeLink app.*

### 5.2 Voice Control

Integrate your ZBM5-1C-120W with voice assistants like Amazon Alexa or Google Home for hands-free control. After binding your voice assistant account to the eWeLink app, you can use simple voice commands to manage your lights.



# Effortless Control with Your Voice

You can control the switch when you're busy with a simple voice command



works  
with



works with  
Google Home

Alexa, turn off the light.

\*The device must be added to a compatible SONOFF hub, and after binding a third-party account in the eWeLink app, voice control through a smart speaker will be enabled.

*Image 5.2: Voice control of smart lighting using a smart speaker.*

## 5.3 Timers and Scene Automation

Utilize the eWeLink app to set schedules for your lights or create smart scenes. For example, you can configure lights to turn on automatically when a Zigbee sensor detects motion, or set a timer for lights to turn off at a specific time.

# Smart Scenes for a Convenient Life

Work with the Zigbee sensor to automatically turn lights on or off for you.

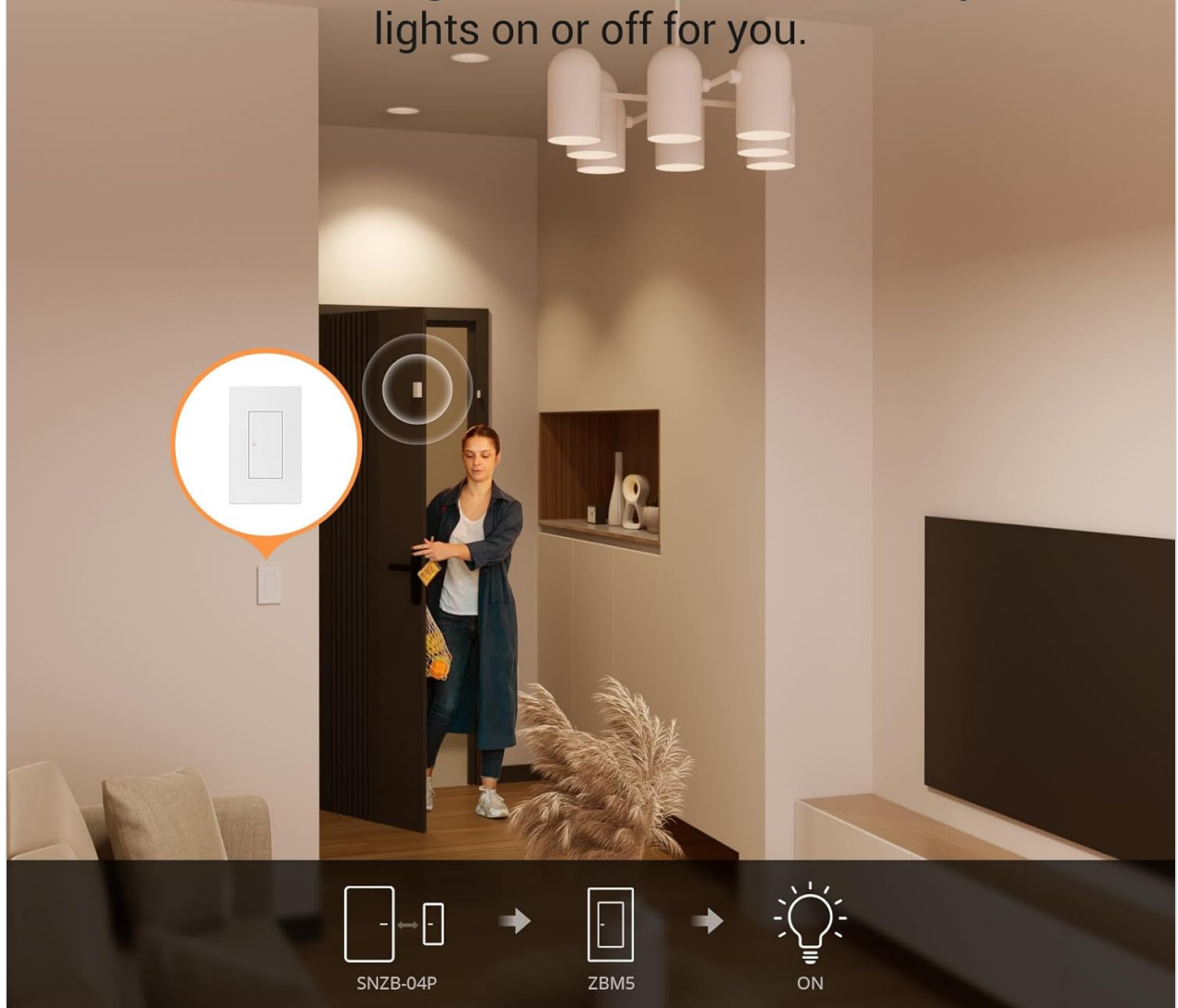

Image 5.3: Smart scene automation example.

# Schedule Lights On

🕒 18:00 → 📱 Turn ON



*Image 5.4: Setting a schedule for lights to turn on.*

## 5.4 Open-Source Platform Compatibility

The ZBM5-1C-120W can be integrated into open-source platforms like Home Assistant via Zigbee2MQTT or ZHA, allowing for seamless control and automation with devices from various manufacturers.



# A Piece of Open-Source Platform Solution

Easily integrate your device into open-source platforms via Zigbee2MQTT or ZHA, creating a smart home solution that works seamlessly with devices from various manufacturers.

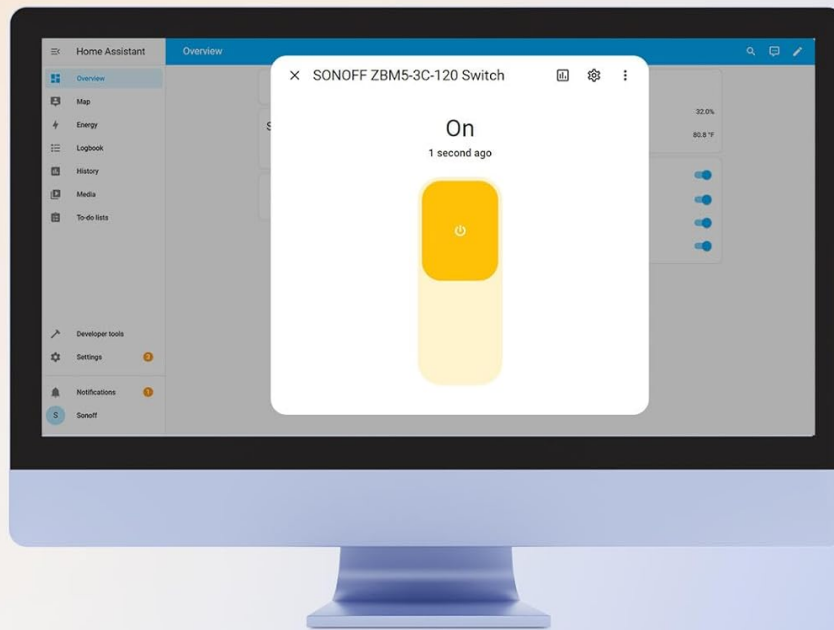

\*Functionality varies when added via Zigbee2MQTT or ZHA.

Image 5.5: Integration with Home Assistant via Zigbee2MQTT.

## 5.5 Detach Relay Feature

The detach relay feature allows smart lights to remain powered even when the wall switch is turned off, ensuring they stay online and responsive to smart commands. This feature is supported only in neutral-required mode.

### Detach Relay For Wiring Smart Bulb

With the detach relay enabled, smart lights won't lose power when the wall switch is turned off, allowing them to remain smart at all times.

\*Supports connecting smart lights only in the neutral required mode.

#### Enable "Detach Relay"

Smart Bulb  
Not affected by external switches, **not** offline.

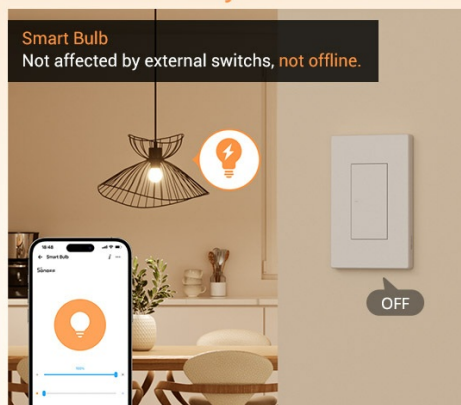

#### Normal Situation

Smart Bulb  
Offline

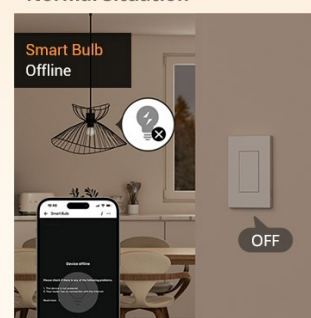

## 5.6 Product Features Video

Your browser does not support the video tag.

*Video 5.2: This video highlights the key features and benefits of the SONOFF Zigbee Smart Switch, including remote control, timing, and smart scene capabilities.*

## 6. MAINTENANCE

- **Cleaning:** Use a soft, dry cloth to clean the switch. Do not use abrasive cleaners or solvents.
- **Firmware Updates:** Regularly check the eWeLink app for available firmware updates to ensure optimal performance and security.
- **Environmental Conditions:** Avoid exposing the switch to extreme temperatures, direct sunlight, or high humidity.

## 7. TROUBLESHOOTING

- **Device Not Pairing:**
  - Ensure the SONOFF Zigbee Hub is powered on and within range.
  - Confirm the switch is in pairing mode (LED indicator flashing slowly).
  - Check the eWeLink app for any error messages or specific pairing instructions.
  - Verify that the Zigbee hub's firmware is up to date.
- **No Response from Switch:**
  - Check if the main power supply to the switch is on.
  - Verify the switch is still connected to the Zigbee hub in the eWeLink app.
  - If using a no-neutral setup, ensure the connected load meets the minimum 3W requirement.
  - For open-source platforms like Home Assistant, ensure Zigbee2MQTT or ZHA configurations are correct and up-to-date, as some users have reported state synchronization issues.
- **Voice Control Issues:**
  - Confirm that your voice assistant account is correctly linked to the eWeLink app.
  - Check the internet connection of your smart speaker and Zigbee hub.
  - Ensure the device name in the eWeLink app is recognized by your voice assistant.

## 8. SPECIFICATIONS

| Feature | Detail |
|---------|--------|
|---------|--------|

| Feature              | Detail                    |
|----------------------|---------------------------|
| Model                | ZBM5-1C-120               |
| Product Dimensions   | 4.72 x 2.91 x 1.55 inches |
| Weight               | 1.1 Pounds                |
| Operation Mode       | ON-OFF                    |
| Current Rating       | 10 Amps                   |
| Operating Voltage    | 120 Volts                 |
| Contact Type         | Normally Closed           |
| Connector Type       | Crimp                     |
| Brand                | SONOFF                    |
| Switch Type          | Push Button               |
| Terminal             | Screw                     |
| Material             | Plastic                   |
| Manufacturer         | SONOFF                    |
| Date First Available | November 19, 2024         |

### 4 Steps to Use

Easily set up. Download the APP, scan the QR code to connect with the gateway and controll

Download the eWeLink App.

Q | eWeLink

GET IT ON Google Play

Download on the App Store

1

2

3

4

\*Requires the compatible SONOFF Zigbee hub.

Image 8.1: Detailed product specifications for the ZBM5 series.

## Zigbee Hub Compatibility

### ✔ Supported Zigbee Hub



iHost



NSPanel Pro



ZBBridge-U



ZBBridge-P



ZBDongle-E/P



ZBBridge-P



ZBBridge-U



NSPanel Pro



iHost



ZBBridge



ZHA



Zigbee2MQTT

|                |   |   |   |   |   |   |   |
|----------------|---|---|---|---|---|---|---|
| On/Off         | ✓ | ✓ | ✓ | ✓ | ✓ | ✓ | ✓ |
| Smart scene    | ✓ | ✓ | ✓ | ✓ | ✓ | ✓ | / |
| Detach relay   | ✓ | ✓ | ✓ | ✓ | ✗ | ✗ | ✓ |
| Power on state | ✓ | ✓ | ✓ | ✓ | ✗ | ✓ | ✓ |
| OTA            | ✓ | ✓ | ✓ | ✓ | ✗ | ✓ | ✓ |

### ✗ Unsupported Zigbee Hub



Echo Show 2nd



Echo 4th Gen



Echo Plus 2nd

Image 8.2: Dimensions of the SONOFF ZBM5 smart switch.

## 9. WARRANTY AND SUPPORT

For warranty information and technical support, please refer to the official SONOFF website or contact their customer service directly. You can also visit the [SONOFF Store on Amazon](#) for additional resources.